

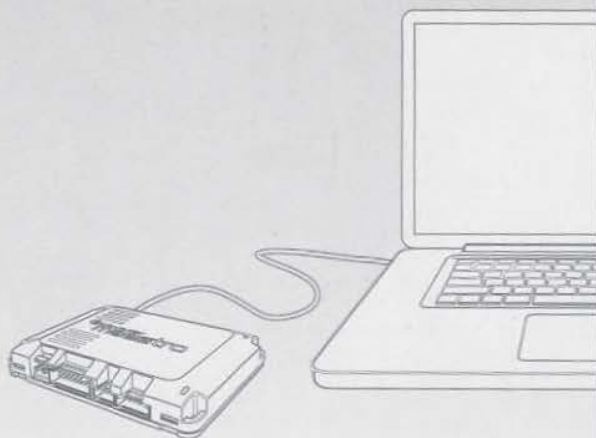

SW | AR | AR | SW HD

QUICK START GUIDE



FOLLOW THE WEB PROGRAMMING
STEPS INSIDE PRIOR TO INSTALLATION.



WEB PROGRAMMING

1- INSTALL THE WEBLINK DESKTOP APPLICATION

Go to www.idatalinkmaestro.com/plugin, select your software version (Mac or PC) and follow the installation steps. Be sure to review the system requirements before installing.

2- REGISTER A WEBLINK ACCOUNT

Once installed, complete the Weblink registration process and log into Weblink.

3- CONNECT THE MODULE TO YOUR COMPUTER

Use the included USB cable to connect your iDatalink Maestro module to your computer.

4- WEBLINK PROGRAMMING

Follow the programming steps until your module is flashed, then download your install guide and owner's manual if applicable.

5- COMPLETE VEHICLE-SPECIFIC INSTALLATION

Follow the steps in your install guide and complete the installation. ADS recommends having your iDatalink Maestro device installed by a certified technician. **Additional accessories may be required and sold separately.**



TECHNICAL SUPPORT

877.212.6169

idatalinkmaestro.com

LIMITED 1-YEAR WARRANTY

Automotive Data Solutions Inc. ("ADS") warrants to the original purchaser of the product that the following components product shall be free of defects in material and workmanship under normal use and circumstances for the period of one (1) year from the date of original installation.

"Authorized Dealer" is defined by ADS as a company who qualifies to purchase products directly from ADS, or one of its approved distributors. Thus, products not sold nor installed by an Authorized Dealer are not covered by this warranty. This includes, but is not limited to, ADS products sold on Amazon.com, eBay.com, Walmart.com and Newegg.com. To find an authorized retailer near you, visit <http://maestro.idatalink.com/find-product>.

In the event of any product malfunction during the Warranty period, the original purchaser must return to the Authorized Dealer where it was originally purchased with the original proof of purchase. If a malfunction is detected, the Authorized Dealer will elect to repair or replace the product at its discretion. Labor costs may be applicable and are at the discretion of the Authorized Dealer.

ADS is not responsible for any damages whatsoever, including but not limited to any consequential damages, incidental damages, damages for loss of time, loss of earnings, commercial loss, loss of economic opportunity and the like that may or may not have resulted from the installation or operation of an iDatalink Maestro product.



TECHNICAL SUPPORT

877.212.6169

idatalinkmaestro.com

FORD AND LINCOLN VEHICLES
(SEE DETAILS INSIDE)

INSTALL GUIDE

F02C-RR-DS-(APX-S8-F01)-EN

RETAINS STEERING WHEEL CONTROLS AND MORE!



**HEAD UNIT
ADAPTER READY**

PRODUCTS REQUIRED

iDatalink Maestro RR Radio Replacement Interface
iDatalink Maestro APX-S8-F01 Dash Kit
Kenwood APX radios

PROGRAMMED FIRMWARE: F02C-RR-DS

WELCOME

Congratulations on the purchase of your iDatalink Maestro RR Radio replacement solution. You are now a few simple steps away from enjoying your new car radio with enhanced features.

Before starting your installation, please ensure that your iDatalink Maestro module is programmed with the correct firmware for your vehicle and that you carefully review the install guide.

Please note that Maestro RR will only retain functionalities that were originally available in the vehicle.

NEED HELP?

1 866 427-2999

maestro.support@idatalink.com

ADDITIONAL INFORMATION AND ACCESSORIES

Installation, product information, vehicle specific videos.

[VIDEO HELP](#)



Last flash information, steering control configuration, vehicle information.

[VERIFY FLASH](#)



Software to program module.

[WEBLINK](#)



HEAD UNIT ADAPTER:
ACC-HU-KEN1

MIC1
(Factory microphone interface module)

PAD1
(Level matching circuit for vehicles equipped with factory amplifiers)

VID1
(Composite video noise filter for backup camera)

NAV4
(Navigation antenna adapter)

Radar Detectors



[Radar Installation Guides](#)

APX-S8-F01 COMPONENTS

QUICK START GUIDE



3MVHB
for mounting RR/RR2 module.



SM5-16P*4
4x (M5 16mm screw)



SM5-6P*10
10x (M5 6mm screw)



SM5-8P*4, NM5*4, WM5-SPLIT*4
4x (M5 8mm bolt, nut and washer)



GND



Maestro panel removal tool



2x 2mm, 1x 5mm SPACER

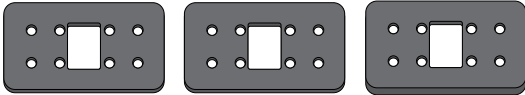

FLOATING SCREEN ADAPTER BRACKET

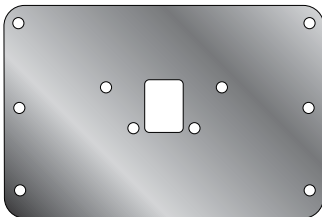

SCREEN BRACKETS
LEFT (L)



RIGHT (R)

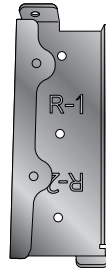

RADIO CHASSIS BRACKETS 2
(EURO PLATFORM)

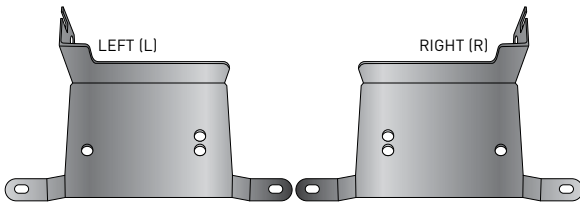

MAIN HARNESS HRN-S8-F01

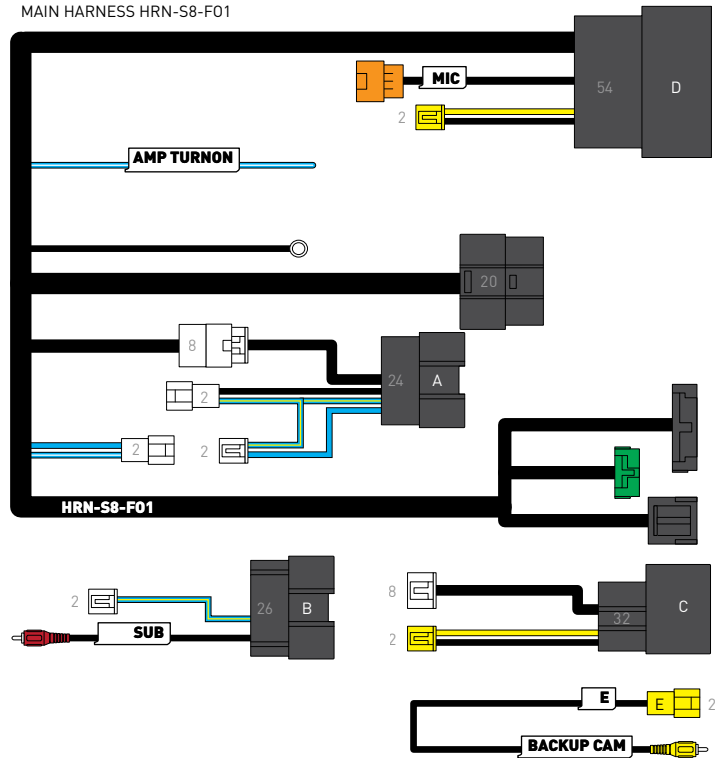

AM/FM ANTENNA ADAPTER

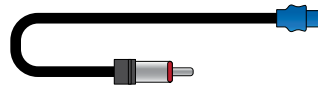

USB ADAPTERS
USBA-USBC, USBC-USBC



USB HUB ADAPTERS

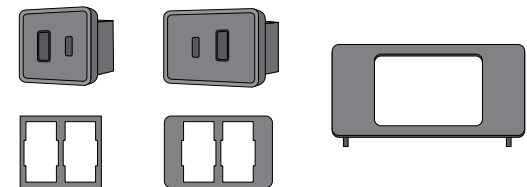

RADIO CHASSIS BRACKETS 1
LEFT (L)

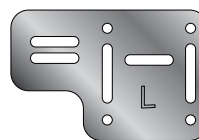

RIGHT (R)



VEHICLE LIST

NOTE: This installation is quite difficult. Although this guide offers step-by-step instructions, we strongly recommend professional installation.

MAKE	MODEL*	TRIM 8" RADIO	YEAR	DASH DISASSEMBLY	INSTALL TYPE	NOTE
FORD	C-Max		13-18	D-01	01	8" modular radio install only.
	Edge		11-14	D-02	01	
	Edge		15-20	D-03	01	
	Escape	without amplifier	13-19	D-19	04	8" modular radio install only.
	Escape	with amplifier	13-16	D-19	03	8" modular radio install only.
	Expedition		15-19	D-04	01	18-19: amplifier not retained
	Explorer		11-19	D-05	01	
	F150		13-14	D-06	01	
	F150		15-20	D-07	01	18-20: amplifier not retained
	Super Duty		13-16	D-08	01	
	Super Duty		17-20	D-07	01	20: amplifier not retained
	Super Duty		21	D-07	02	
	Flex		13-19	D-09	01	
	Focus		12-14	D-10	01	8" modular radio install only.
	Focus	without amplifier	15-18	D-11	04	8" modular radio install only.
	Focus	with amplifier	15-18	D-11	03	8" modular radio install only.
	Fusion		13-20	D-12	01	17-20: amplifier not retained
	Mustang		15-23	D-13	01	21-23: amplifier not retained
LINCOLN	MKC		15-19	D-14	01	
	MKT		13-17	D-15	01	
	MKX		11-15	D-02	01	
	MKX		16-18	D-16	01	17-18: amplifier not retained
	MKZ		15-20	D-17	01	17-20: amplifier not retained
	Nautilus		19-20	D-16	01	Amplifier not retained
	Navigator		15-17	D-18	01	

* Click on your model to go to the related dash disassembly instruction page.

DASH DISASSEMBLY P1/2

DD-01

1. Using the provided panel tool, remove the upper trim by pulling upward.

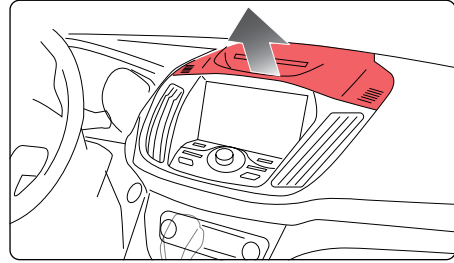

2. Remove the two (2) 7mm screws from the radio bezel.

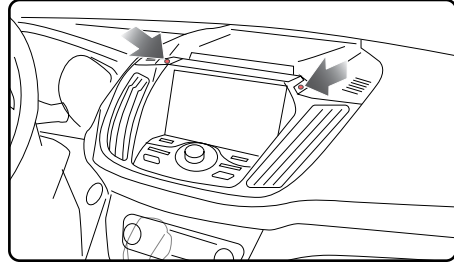

3. Unclip and remove the radio bezel by prying with a plastic panel tool. Unplug the connector from the panel and set it aside.

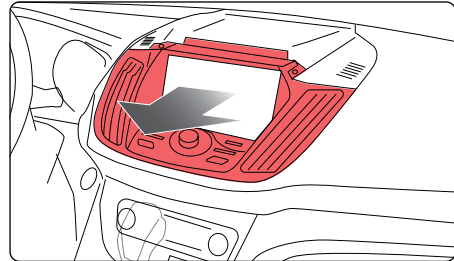

4. Remove four (4) 7mm screws securing the screen. Unplug and remove the screen.

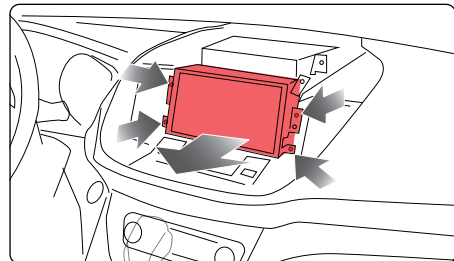

5. Remove two (2) 7 mm screws securing the radio module. Unplug and remove the radio.

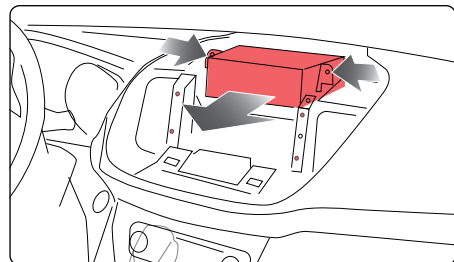

6. Remove (4) 7mm screws securing the radio mounting hardware.

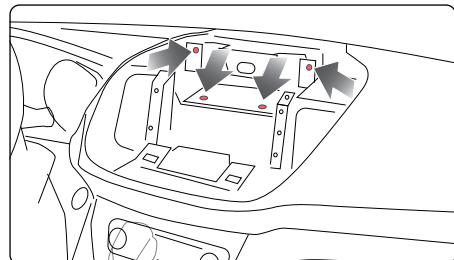

DASH DISASSEMBLY P2/2

DD-01

7. Remove the factory USB by pressing on the back the housing to release clips, disconnect and remove.

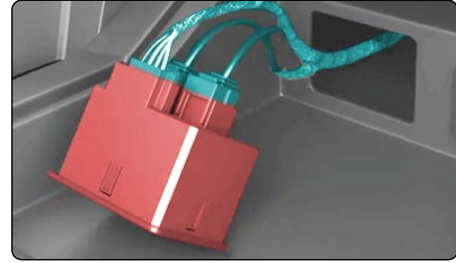

8. Screen bracket position: #2.
Radio chassis brackets: S8-F01-11, S8-F01-12.

Go to: **ASSEMBLY RADIO CHASSIS** and follow instructions.

Then go to: **ASSEMBLY (8" SCREEN)** and follow instructions.

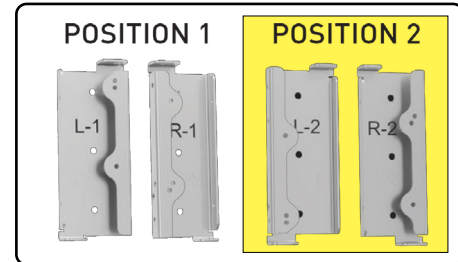

9. Go to **INSTALL AND CONNECT** (INSTALL TYPE-01) and **WIRING DIAGRAM** (INSTALL TYPE-01) and follow instructions.

DASH DISASSEMBLY P1 /2

DD-02

1. Using the provided panel tool, carefully pry out the trim panels on either side of the center console and radio.

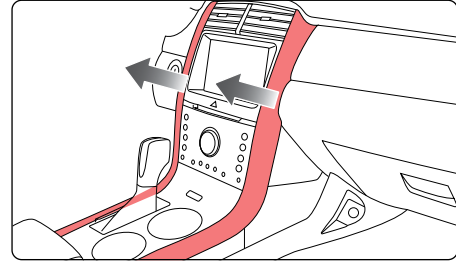

2. Remove the four (4) screws securing the shifter trim panel.
Unclip and remove the shifter trim panel.

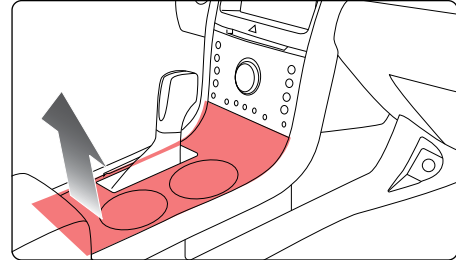

3. Remove the six (6) 7mm screws securing the radio and climate bezel.
Using the provided panel tool, carefully pry out the bezel from the dash.

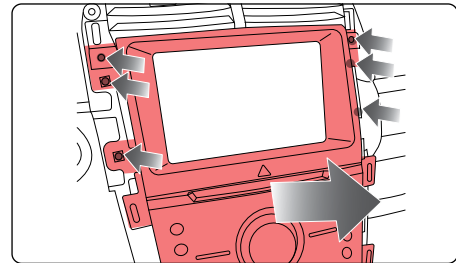

4. Remove the four (4) 7mm screws securing the radio display, disconnect and remove.

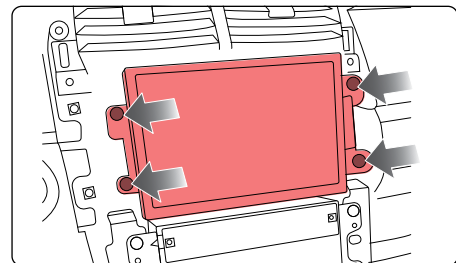

5. Remove the four (4) 7mm screws securing the radio chassis, disconnect and remove.

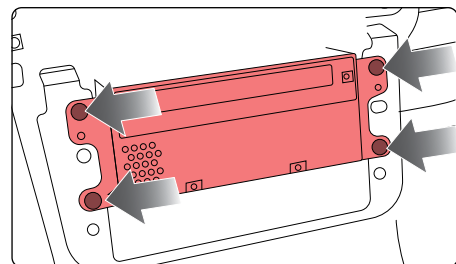

6. Remove the factory USB by pressing on the back the housing to release clips, disconnect and remove.

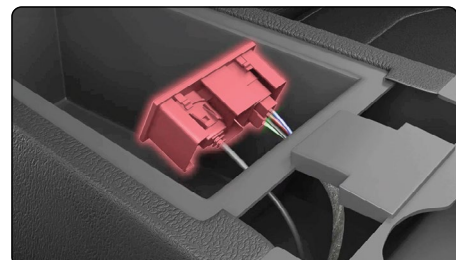

DASH DISASSEMBLY P2/2

DD-02

7. Screen bracket position: #1.

Radio chassis brackets: S8-F01-11, S8-F01-12.

Go to: **ASSEMBLY RADIO CHASSIS** and follow instructions.

Then go to: **ASSEMBLY (8" SCREEN)** or **(10" SCREEN)** and follow instructions.

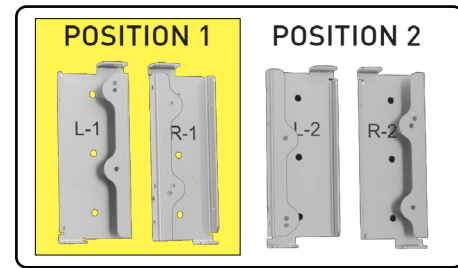

8. Go to **INSTALL AND CONNECT** (INSTALL TYPE-01) and **WIRING DIAGRAM** (INSTALL TYPE-01) and follow instructions.

DASH DISASSEMBLY P1 /3

DD-03

1. Using the provided panel tool, carefully pry out the trim panels on either side of the center console.

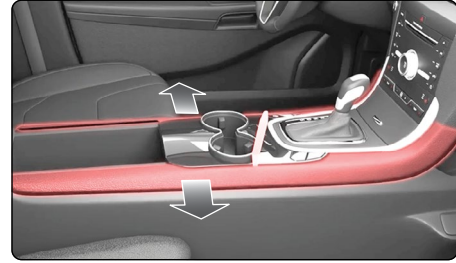

2. Engage the parking brake and place the shifter into the drive gear. Remove the upper console trim.

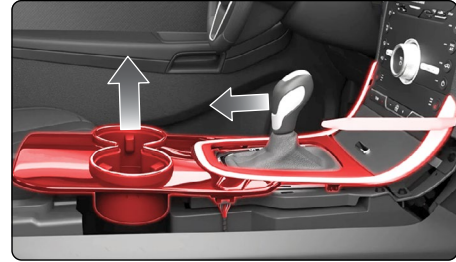

3. Disconnect the two (2) wiring harnesses from the center console trim.

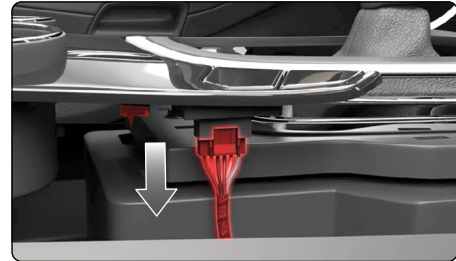

4. Pull down the shift boot and remove the two (2) Phillips screws securing the shifter.



5. Pull up on the shifter to remove it.



6. Remove the four (4) 7mm screws securing the front storage pocket. Remove the pocket.



DASH DISASSEMBLY P2 /3

DD-03

7. Disconnect the USB cables and wiring harness.



8. Factory USB hub need to be replaced with suitable USB media hub from S8-F01 dash kit.

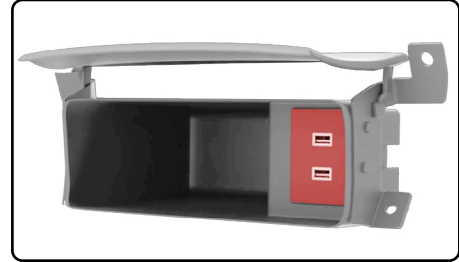

9. Remove the factory USB housing from the pocket by pressing the four (4) tabs using a small pick tool.

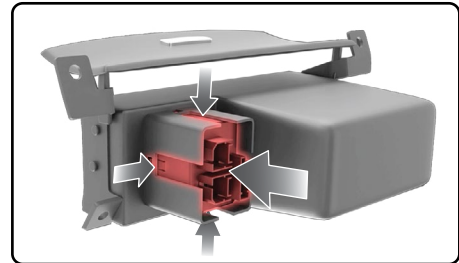

10. Install the correct sized USB housing provided with the S8-F01 kit..

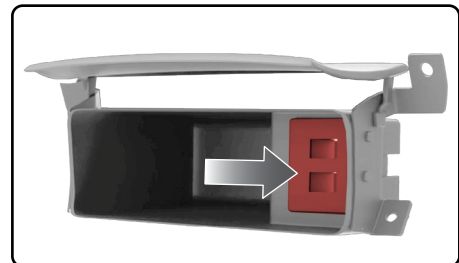

11. Remove the five (5) 7mm screws securing the shifter carriage.



12. Remove the shifter carriage and disconnect the harness.



DASH DISASSEMBLY P3/3

13. Place the transmission back into park.
Remove the two (2) 7mm screws securing the radio bezel.



14. Pull outward on the bezel. Disconnect the two (2) wiring harnesses from the back of the bezel.



15. Remove the four (4) 7mm screws securing the radio display. Then, disconnect and remove.

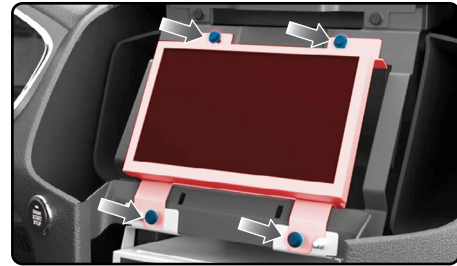

16. Remove the two (2) 7mm screws securing the CD player (or radio module). Then, disconnect the wiring harness and remove.



17. Screen bracket position: #1.
Radio chassis brackets: S8-F01-11, S8-F01-12.
Go to: **ASSEMBLY RADIO CHASSIS** and follow instructions.
Then go to: **ASSEMBLY (8" SCREEN)** or **(10" SCREEN)** and follow instructions.

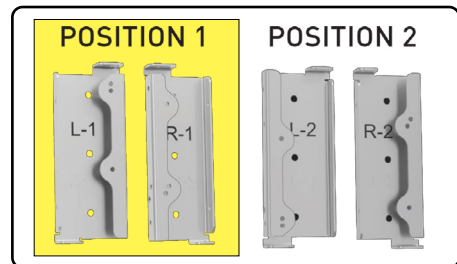

18. Go to **INSTALL AND CONNECT** (INSTALL TYPE-01) and **WIRING DIAGRAM** (INSTALL TYPE-01) and follow instructions.

DASH DISASSEMBLY P1/2

DD-04

1. Unclip and remove the trim panel at the bottom of the climate control panel.

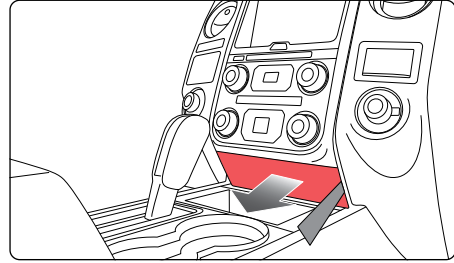

2. Remove two (2) 7mm screws behind the trim panel.

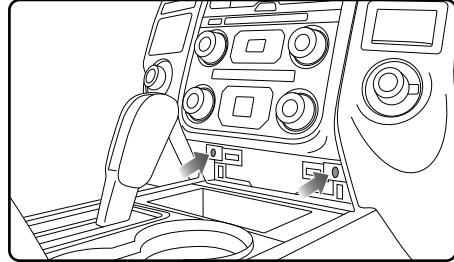

3. Unclip and remove the radio and climate control panel, starting from the bottom. Unplug the connectors.

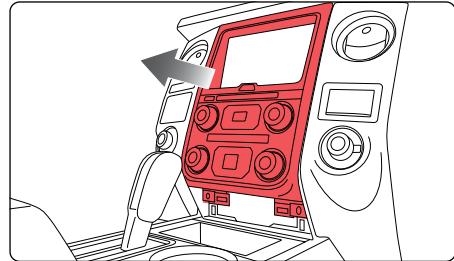

4. Remove four (4) screws holding the radio.

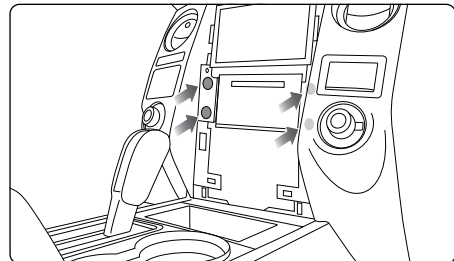

5. Remove and unplug the radio.

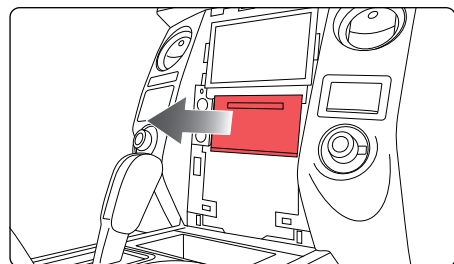

6. Remove two (2) 7mm screws holding the screen and brackets in dash. Remove and unplug the screen.

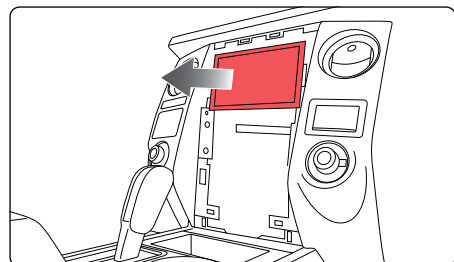

DASH DISASSEMBLY P2/2

DD-04

7. Remove the factory USB by pressing on the back the housing to release clips, disconnect and remove.

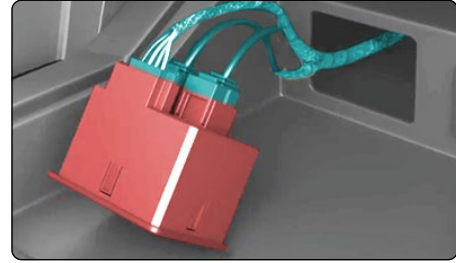

8. Screen bracket position: #2.
Radio chassis brackets: S8-F01-11, S8-F01-12.

Go to: **ASSEMBLY RADIO CHASSIS** and follow instructions.

Then go to: **ASSEMBLY (8" SCREEN)** or **(10" SCREEN)** and follow instructions.

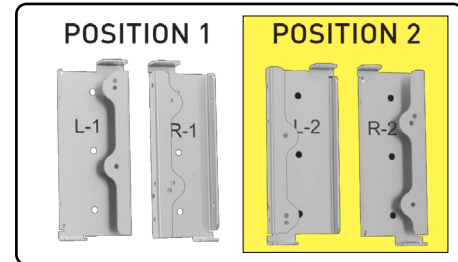

9. Go to **INSTALL AND CONNECT** (INSTALL TYPE-01) and **WIRING DIAGRAM** (INSTALL TYPE-01) and follow instructions.

DASH DISASSEMBLY P1/1

1. Using the provided panel tool, carefully pry out the trim panels on either side of the radio.



2. Remove the four (4) 7mm screws securing the radio and climate bezel. Carefully pull outward on the radio and climate control bezel to release the clips securing it. Disconnect the wiring harness from the back of the bezel.



3. Remove the four (4) 7mm screws securing the screen. Then, disconnect and remove.

Remove the four (4) 7mm screws securing the CD player. Then, disconnect the wiring harness and remove.

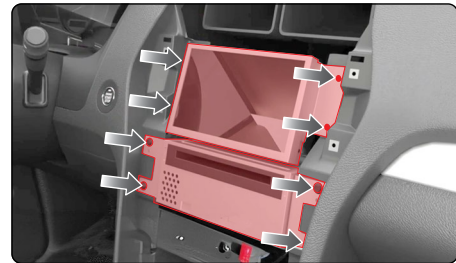

4. To remove the factory USB hub, press on the back of the housing to remove clips. Then, disconnect the USB cables and wiring harness.

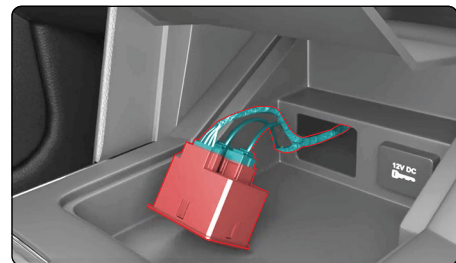

5. Screen bracket position: #1.

Radio chassis brackets: S8-F01-11, S8-F01-12.

Go to: **ASSEMBLY RADIO CHASSIS** and follow instructions.

Then go to: **ASSEMBLY (8" SCREEN)** or **(10" SCREEN)** and follow instructions.

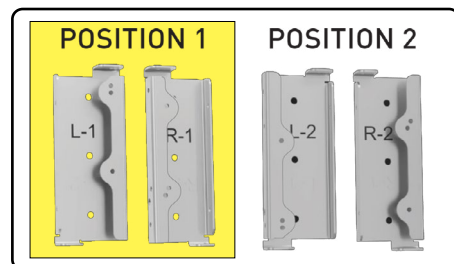

6. Go to **INSTALL AND CONNECT** (INSTALL TYPE-01) and **WIRING DIAGRAM** (INSTALL TYPE-01) and follow instructions.

DASH DISASSEMBLY P1 /2

DD-06

1. On passenger side of the vehicle, open the glove box and push the side tabs toward each other to release glove box.

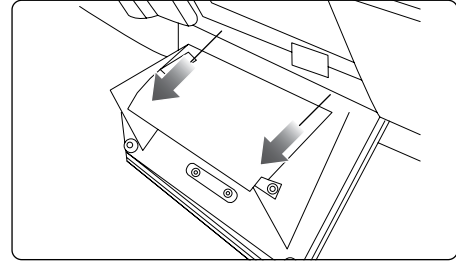

2. Extract the three (3) 8mm bolts to release the airbag.

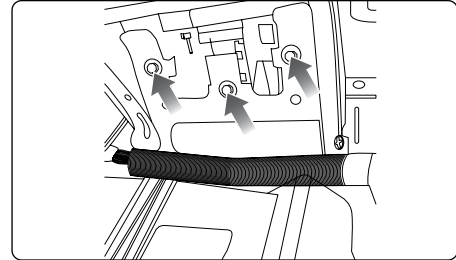

3. Without disconnecting the airbag, push it out far enough to expose the copper-plated 7mm screw on the left side of the airbag and extract it.

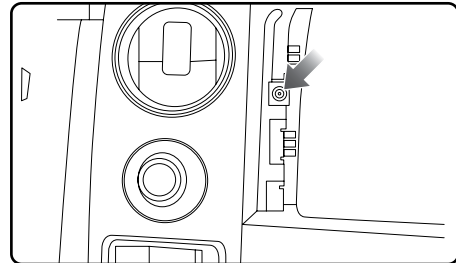

4. Remove the instrument cluster cover by removing (2) 7mm screws. Remove both side vent covers.

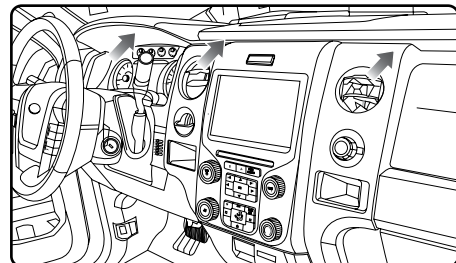

5. Remove two (2) 7mm screws from the top of the radio bezel.

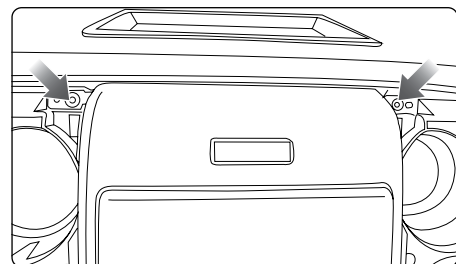

6. Remove two (2) 7mm screws from the bottom of the radio bezel. Remove the radio bezel.

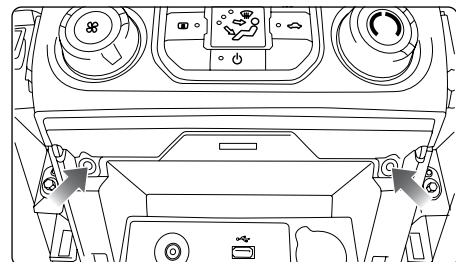

DASH DISASSEMBLY P2 /2

7. Remove four (4) 7mm screws from the factory display.
Disconnect and remove.
8. Remove four (4) 7mm screws from the radio chassis.
Disconnect and remove.
9. Remove the factory USB by pressing on the back the housing to release clips, disconnect and remove.
10. Screen bracket position: #1.
Radio chassis brackets: S8-F01-11, S8-F01-12.
Go to: **ASSEMBLY RADIO CHASSIS** and follow instructions.
Then go to: **ASSEMBLY (8" SCREEN)** or **(10" SCREEN)** and follow instructions.
11. Go to **INSTALL AND CONNECT (INSTALL TYPE-01)** and **WIRING DIAGRAM (INSTALL TYPE-01)** and follow instructions.

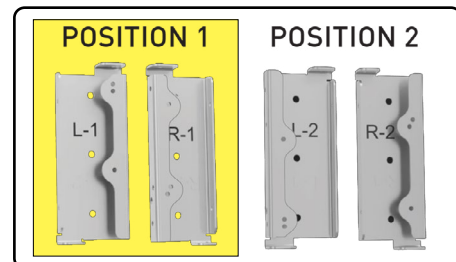
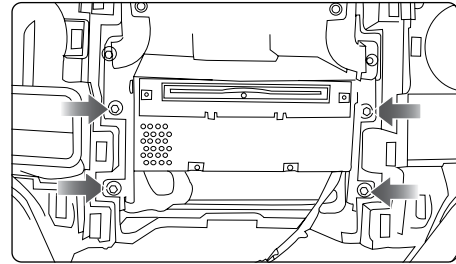
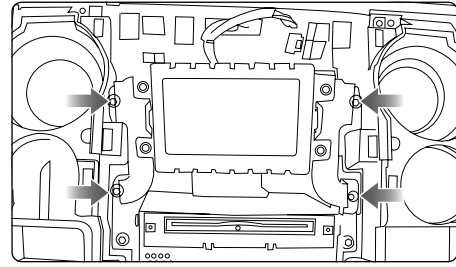

DASH DISASSEMBLY P1 /2

DD-07

1. Using the provided panel tool, carefully pry up the center channel grille to release the clips.

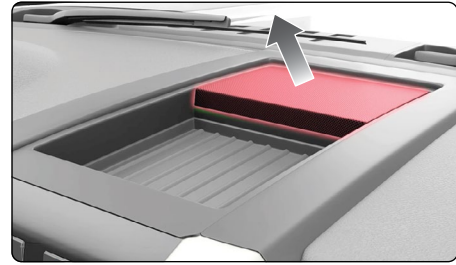

2. Remove the two (2) 7mm screws securing the dash storage tray.

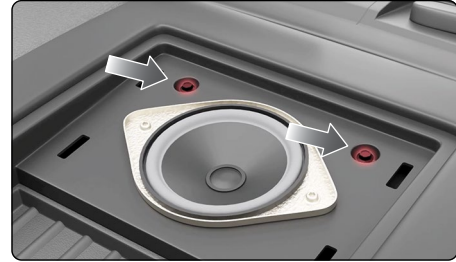

3. Using panel tool, release the clips securing the dash storage tray. If equipped, disconnect center speaker wire harness.

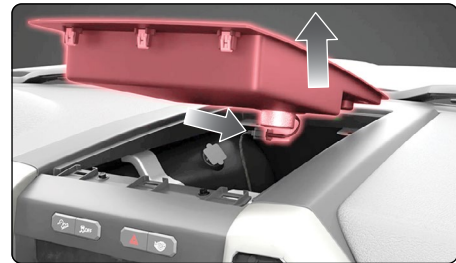

4. Remove the two (2) 7mm screws securing the radio and climate bezel.

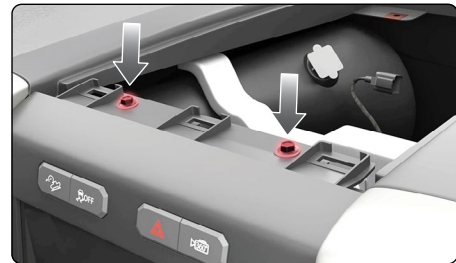

5. Carefully pull outward on radio and climate control bezel to release the clips securing it, disconnect and remove.



6. Remove the six (6) 7mm screws securing the 8" radio display, disconnect and remove.

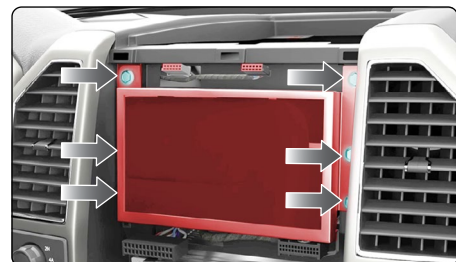

DASH DISASSEMBLY P2/2

7. Remove the four (4) 7mm screws securing the CD player, disconnect and remove.

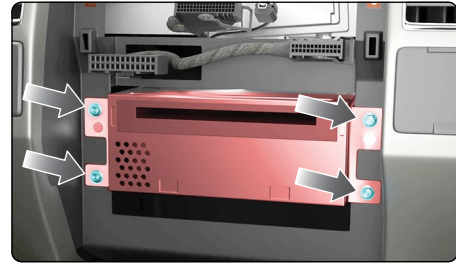

8. Remove Factory USB by pressing on the back the housing to release clips, disconnect and remove.

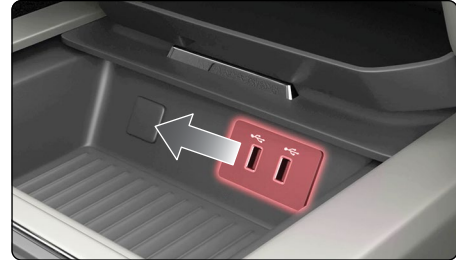

9. Screen bracket position: #2.
Radio chassis brackets: S8-F01-11, S8-F01-12.

Go to: **ASSEMBLY RADIO CHASSIS** and follow instructions.

Then go to: **ASSEMBLY (8" SCREEN)** or **(10" SCREEN)** and follow instructions.

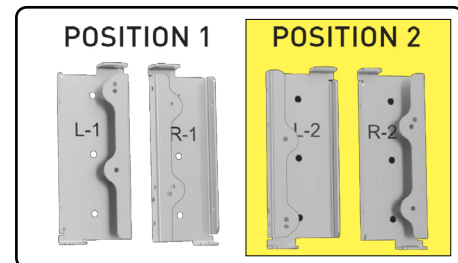

10. Go to **INSTALL AND CONNECT** (INSTALL TYPE-01) and **WIRING DIAGRAM** (INSTALL TYPE-01) and follow instructions.

2021 Ford Super Duty:

Go to **INSTALL AND CONNECT** (INSTALL TYPE-02) and **WIRING DIAGRAM** (INSTALL TYPE-02) and follow instructions.

DASH DISASSEMBLY P1/2

DD-08

1. Unclip the two (2) panels at the bottom of the factory bezel.

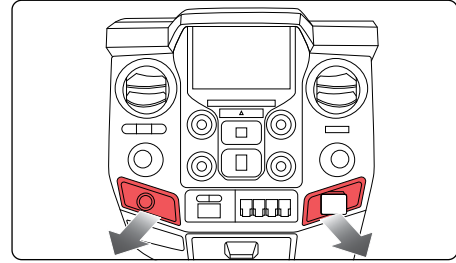

2. Remove two (2) 7mm screws behind the panels.

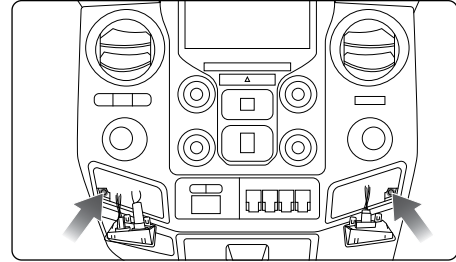

3. Unclip and remove the radio and climate control panel. Unplug the connectors.

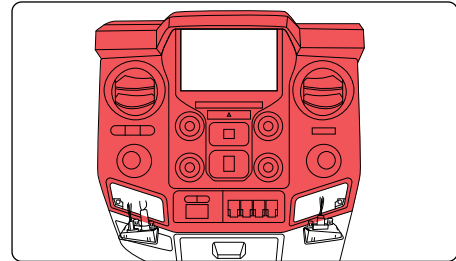

4. Remove four (4) screws holding the screen frame. Remove and unplug the OEM screen.

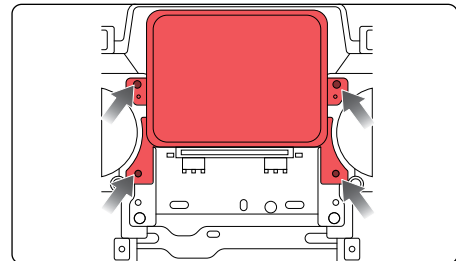

5. Remove two (2) screws holding the radio body. Remove and unplug the OEM radio.

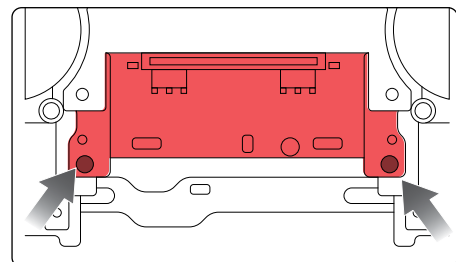

6. Remove the factory USB by pressing on the back the housing to release clips, disconnect and remove.



DASH DISASSEMBLY P2/2

DD-08

7. Screen bracket position: #1.

Radio chassis brackets: S8-F01-11, S8-F01-12.

Go to: **ASSEMBLY RADIO CHASSIS** and follow instructions.

Then go to: **ASSEMBLY (8" SCREEN)** or **(10" SCREEN)** and follow instructions.

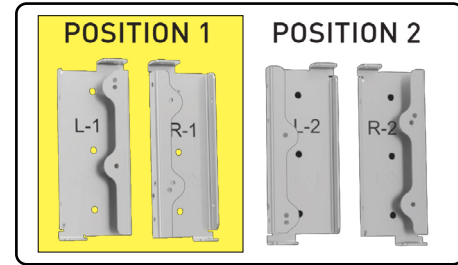

8. Go to **INSTALL AND CONNECT** (INSTALL TYPE-01) and **WIRING DIAGRAM** (INSTALL TYPE-01) and follow instructions.

DASH DISASSEMBLY P1/2

DD-09

1. Unclip and remove the shifter bezel.

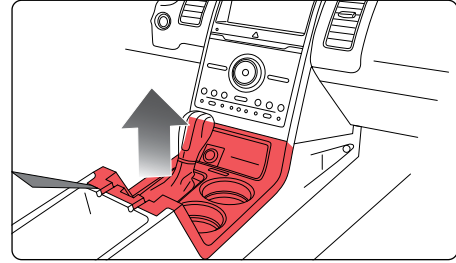

2. Unclip and remove the trim above the radio and glove box.

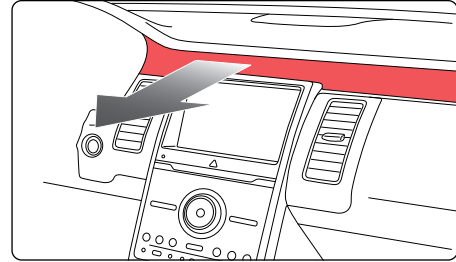

3. Remove two (2) 7mm screws behind the trim.

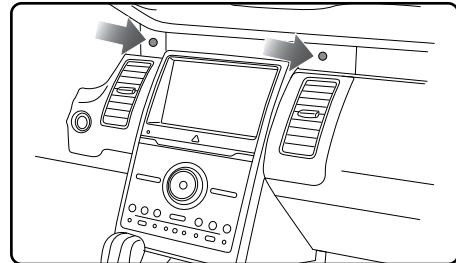

4. Remove the panels on each side of the center console, exposing (1) 7mm screw on each side. Remove the two (2) screws.

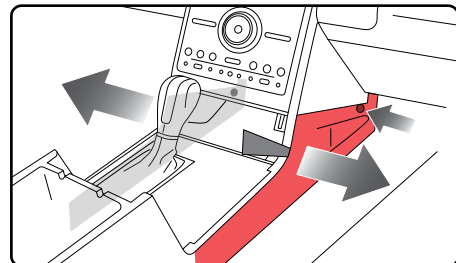

5. Remove the two (2) screws at the bottom of the radio bezel. Unclip, remove and unplug the radio bezel.

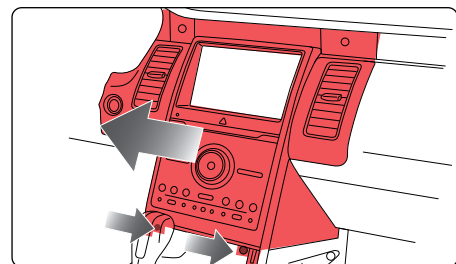

6. Remove four (4) screws holding the screen frame, remove and unplug the OEM screen.

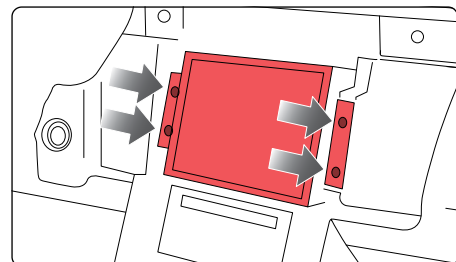

DASH DISASSEMBLY P2/2

DD-09

7. Remove four (4) screws holding the radio body, remove and unplug the radio.

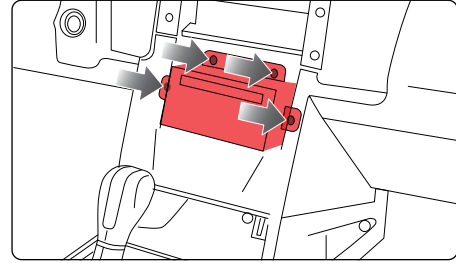

8. Remove Factory USB by pressing on the back the housing to release clips, disconnect and remove.

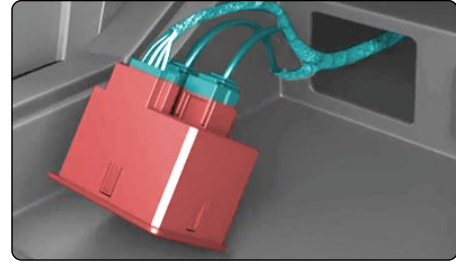

9. Screen bracket position: #1.
Radio chassis brackets: S8-F01-11, S8-F01-12.

Go to: **ASSEMBLY RADIO CHASSIS** and follow instructions.

Then go to: **ASSEMBLY (8" SCREEN)** or **(10" SCREEN)** and follow instructions.

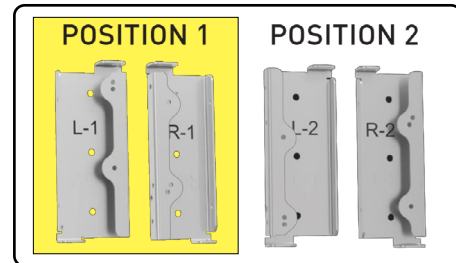

10. Go to **INSTALL AND CONNECT** (INSTALL TYPE-01) and **WIRING DIAGRAM** (INSTALL TYPE-01) and follow instructions.

DASH DISASSEMBLY P1/2

DD-10

1. Pry off center cap at the bottom of the factory radio bezel to expose two (2) screws..

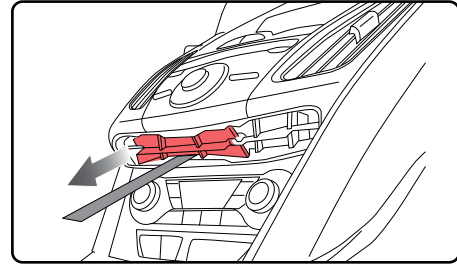

2. Remove two (2) Torx T25 screws..

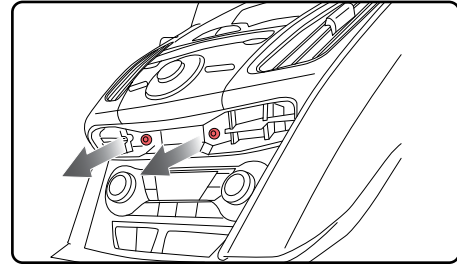

3. Starting at the bottom, pull the bezel forward and use the panel removal tool to release the bezel from the dash. Disconnect the plug on the back of the bezel and put it to the side.

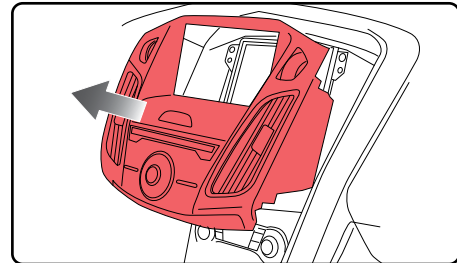

4. Remove four (4) Torx T25 screws holding the screen frame, and two (2) Torx T25 holding the radio body.

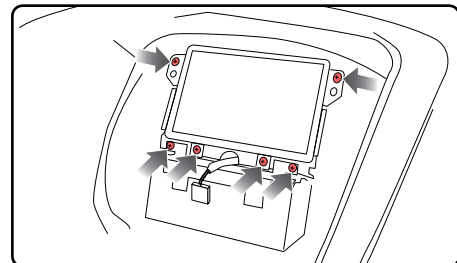

5. Remove both the screen assembly and the radio body, disconnecting the plugs in the process.

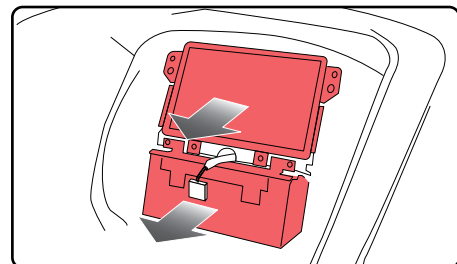

6. Remove Factory USB by pressing on the back the housing to release clips, disconnect and remove.



DASH DISASSEMBLY P2 /2

DD-10

7. Screen bracket position: #2.

Radio chassis brackets: S8-F01-13, S8-F01-14.

Go to: **ASSEMBLY RADIO CHASSIS** and follow instructions.

Then go to: **ASSEMBLY (8" SCREEN)** and follow instructions.

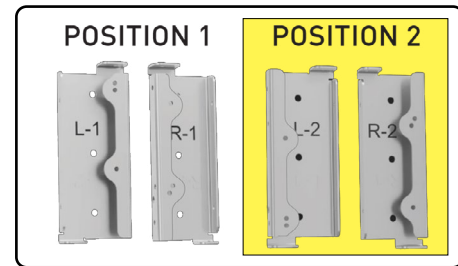

8. Go to **INSTALL AND CONNECT** (INSTALL TYPE-01) and **WIRING DIAGRAM** (INSTALL TYPE-01) and follow instructions.

DASH DISASSEMBLY P1 /2

DD-11

1. Unclip and remove the trim panel at the bottom of the factory bezel (this panel contains the airbag light).

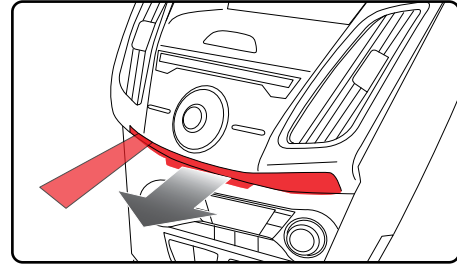

2. Remove the trim around the shifter console by prying it up and unclipping it.

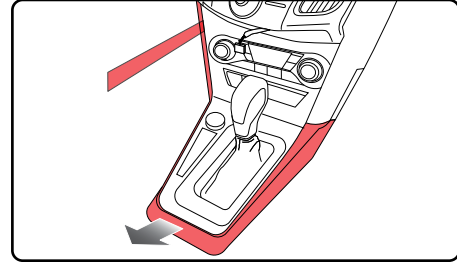

3. Remove three (3) phillips screws holding the shifter surround and climate controls.

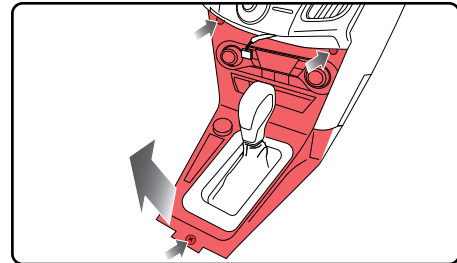

4. Remove two (2) Torx T25 screws at the bottom of the bezel.

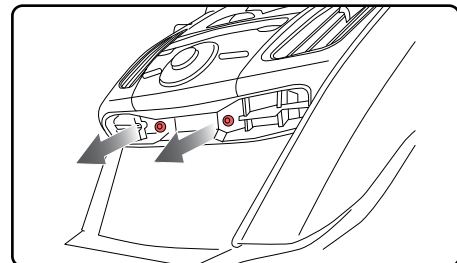

5. Starting at the bottom, pull the bezel forward and use the panel removal tool to release the bezel from the dash. Disconnect the plug on the back of the bezel and put it to the side.

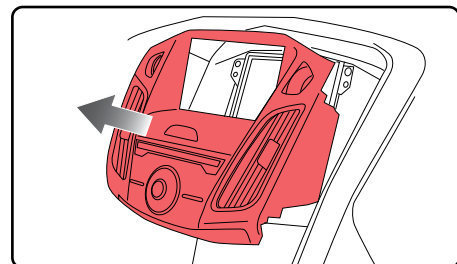

6. Remove four (4) Torx T25 screws holding the screen frame, and two (2) Torx T25 holding the radio body.

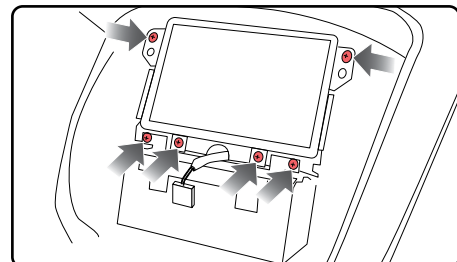

DASH DISASSEMBLY P2/2

DD-11

7. Remove both the screen assembly and the radio body, disconnecting the plugs in the process. Remove the screws holding the screen frame in place and remove the screen frame.

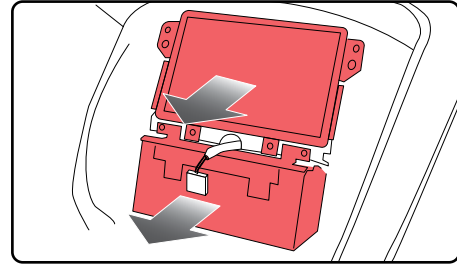

8. Remove Factory USB by pressing on the back the housing to release clips, disconnect and remove.

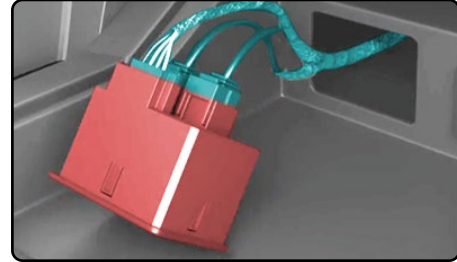

9. Screen bracket position: #2.
Radio chassis brackets: S8-F01-13, S8-F01-14.
Go to: **ASSEMBLY RADIO CHASSIS** and follow instructions.
Then go to: **ASSEMBLY (8" SCREEN)** and follow instructions.

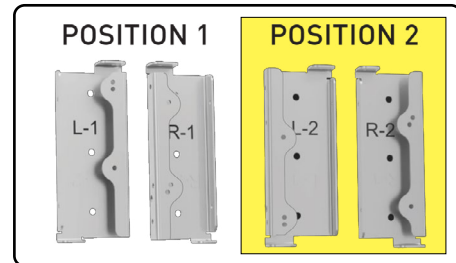

10. Vehicle with amplifier:
Go to **INSTALL AND CONNECT** (INSTALL TYPE-03) and **WIRING DIAGRAM** (INSTALL TYPE-03) and follow instructions.
Vehicle without amplifier:
Go to **INSTALL AND CONNECT** (INSTALL TYPE-04) and **WIRING DIAGRAM** (INSTALL TYPE-04) and follow instructions.

DASH DISASSEMBLY P1 / 2

DD-12

1. Unclip and remove the shifter trim panel.

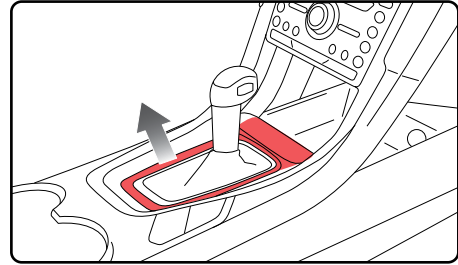

2. Unclip and remove the U-shaped trim at the rear of shifter.

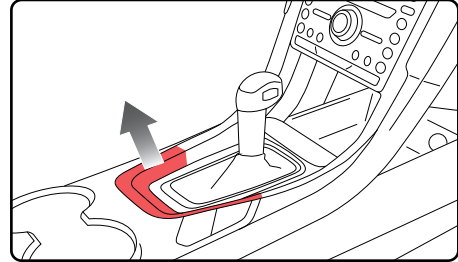

3. (2017 and subsequent models ONLY): unclip and remove the side panels of the center console. Remove the screws exposed.

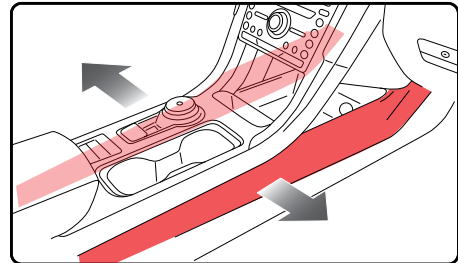

4. Unclip and remove the trim surrounding the center dash.

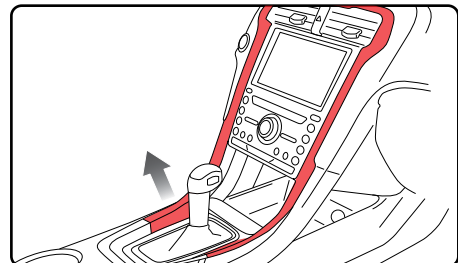

5. Remove two (2) 7mm screws holding the radio and control panel. Unclip, remove and unplug the radio and control panel.

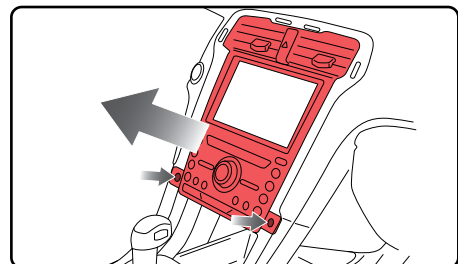

6. Remove four (4) 7mm screws holding the OEM screen. Remove and unplug the screen.

Remove two (2) 7mm screws holding OEM the radio. Remove and unplug the radio.

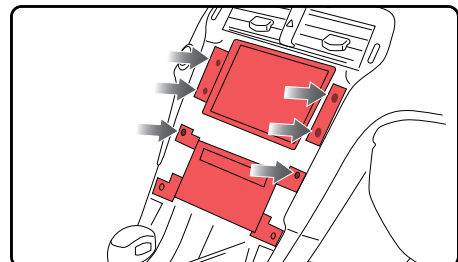

DASH DISASSEMBLY P2/2

DD-12

7. Remove Factory USB by pressing on the back the housing to release clips, disconnect and remove.

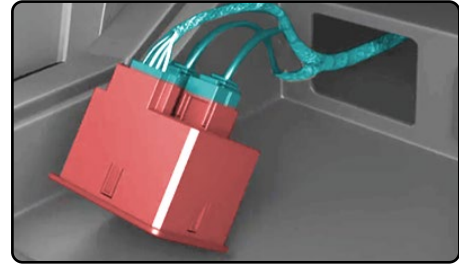

8. Screen bracket position: #2.
Radio chassis brackets: S8-F01-11, S8-F01-12.

Go to: **ASSEMBLY RADIO CHASSIS** and follow instructions.

Then go to: **ASSEMBLY (8" SCREEN)** or **(10" SCREEN)** and follow instructions.

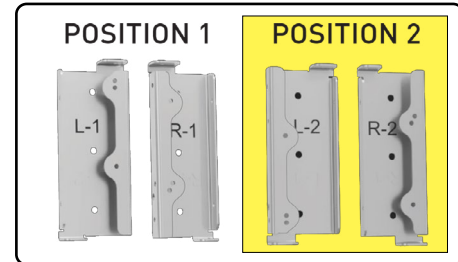

9. Go to **INSTALL AND CONNECT** (INSTALL TYPE-01) and **WIRING DIAGRAM** (INSTALL TYPE-01) and follow instructions.

DASH DISASSEMBLY P1/4

DD-13

STEPS 1, 2 AND 3 ARE TO BE DONE BOTH SIDES OF CENTER CONSOLE.

1. Using supplied panel tool carefully pry outward on the larger center console trim panel.
2. Remove the two (2) 7mm screws located behind panel.
3. Remove smaller forwardmost trim panel.
4. Engage parking brake. Turn key to on position and place the shifter into drive.
5. Pry upward on the shifter trim to release the clips securing it, then disconnect the wiring harness.
6. Remove small Phillips screws located at the front of the shifter.

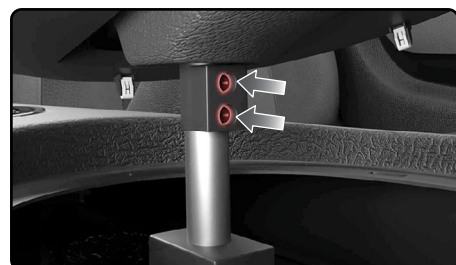
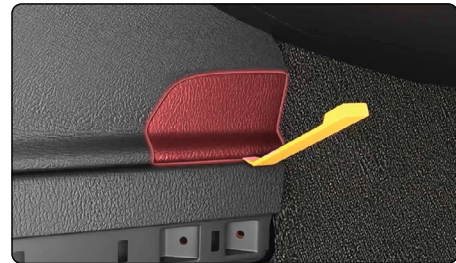

DASH DISASSEMBLY P2/4

DD-13

7. Lift up to remove the shifter. Then place shifter back into park and turn key off.



8. Using a panel tool, pry upward on the back of the center console to release the clips then slide backwards to release the front clips.

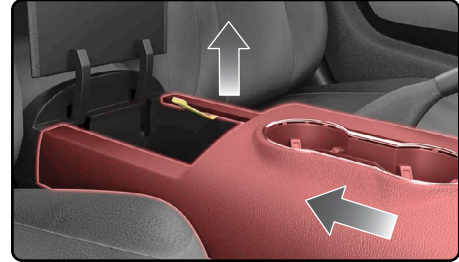

9. Remove tray pad below the radio to expose two (2) 7mm screws.



10. Remove the screws and tray.



11. Open the Glove box and using the supplied panel tool, pry outward on the passenger side trim panel to the right of the compartment.



12. Remove upper dash trim panel by prying outward with the panel tool.



DASH DISASSEMBLY P3/4

DD-13

13. Remove the small trim plate at the base of the radio bezel.



14. Remove two (2) 7mm screws behind the small trim plate.

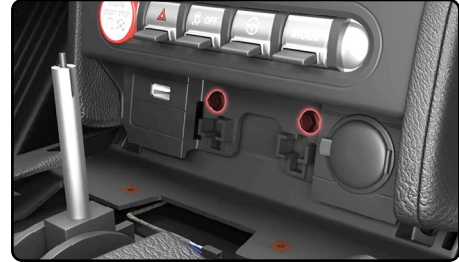

15. Remove the two (2) 7mm screws at the top of the radio bezel.
Disconnect and remove.



16. Remove the four (4) 7mm screws securing the radio screen, disconnect and remove.



17. Remove the four (4) 7mm screws securing the CD player/ radio module in place, disconnect and remove.

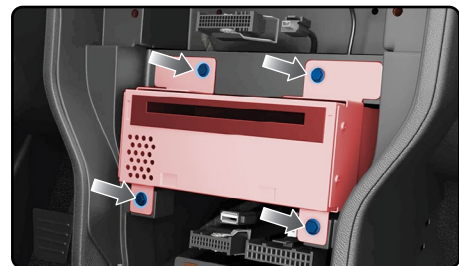

18. To remove the USB hub press the four locking tabs from the back, then disconnect and remove USB hub.

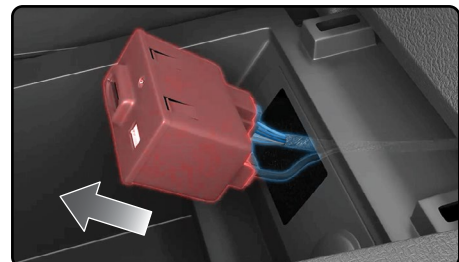

DASH DISASSEMBLY P4/4

DD-13

19. Screen bracket position: #2.

Radio chassis brackets: S8-F01-11, S8-F01-12.

Go to: **ASSEMBLY RADIO CHASSIS** and follow instructions.

Then go to: **ASSEMBLY (8" SCREEN)** or **(10" SCREEN)** and follow instructions.

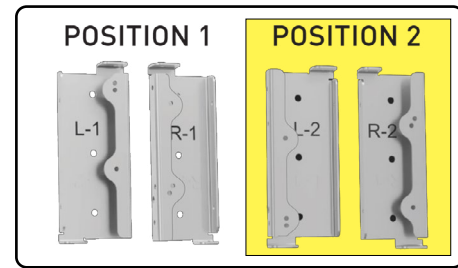

20. Go to **INSTALL AND CONNECT** (INSTALL TYPE-01) and **WIRING DIAGRAM** (INSTALL TYPE-01) and follow instructions.

DASH DISASSEMBLY P1 / 2

DD-14

1. Using the provided panel tool, remove the trim panel below radio.



2. Remove panel exposed, above previously removed panel.

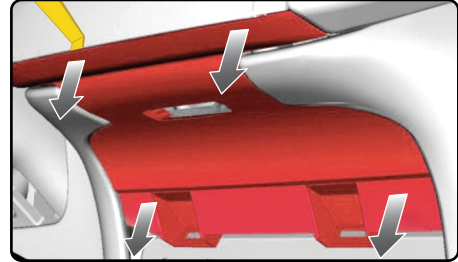

3. Unclip the center top dash panel. Disconnect and remove.



4. Remove four (4) 7mm bolts securing the radio fascia panel. Unplug and remove the panel.

Remove screen from fascia.

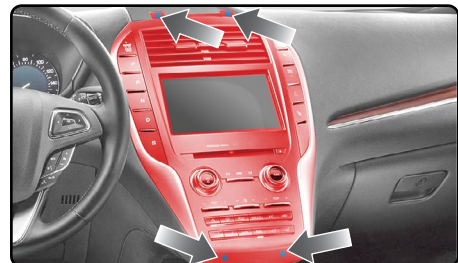

5. Remove two (2) 7 mm screws securing the CD player. Unplug and remove.



6. (If present) Remove the factory USB by pressing on the back the housing to release clips, disconnect and remove.



DASH DISASSEMBLY P2 /2

DD-14

7. Screen bracket position: #2.

Radio chassis brackets: S8-F01-11, S8-F01-12.

Go to: **ASSEMBLY RADIO CHASSIS** and follow instructions.

Then go to: **ASSEMBLY (8" SCREEN)** and follow instructions.

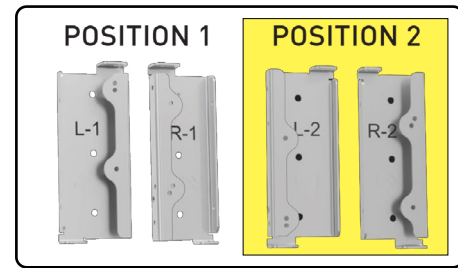

8. Go to **INSTALL AND CONNECT** (INSTALL TYPE-01) and **WIRING DIAGRAM** (INSTALL TYPE-01) and follow instructions.

DASH DISASSEMBLY P1 /2

DD-15

1. Open the center console top door, then using a panel tool release the cup holder assembly, disconnect and remove.

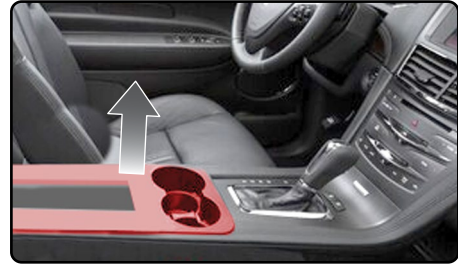

2. Carefully remove left and right center console trim mouldings.



3. Remove the two (2) 7mm screws securing the shifter bezel then, from the bottom release the clips securing the boot to the shifter.
Disconnect the trim panel and remove, leaving shifter and boot.



4. Remove the four (4) 7mm screws securing the radio hvac control panel, disconnect and remove.



5. Remove the four (4) 7mm screws securing the CD player in dash, disconnect and remove.

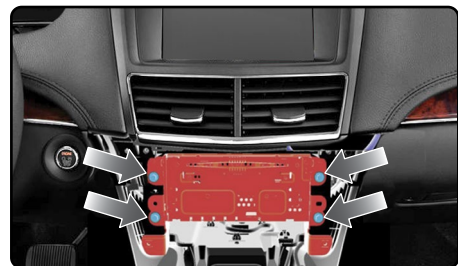

6. With a plastic panel tool carefully pry up the center top dash panel and remove.



DASH DISASSEMBLY P2/2

7. Remove four (4) screws holding the bezel around the screen and remove.

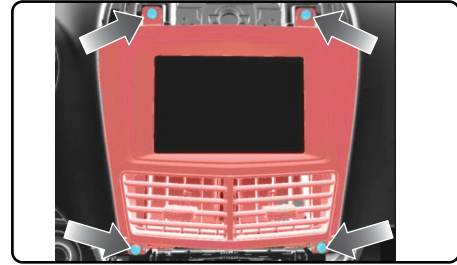

8. Remove four (4) 7mm screws holding radio screen into dash, disconnect and remove.

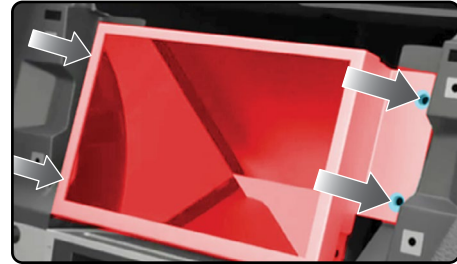

9. (If present) Remove the factory USB by pressing on the back the housing to release clips, disconnect and remove.

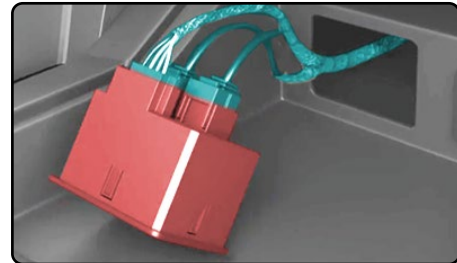

10. Screen bracket position: #1.

Radio chassis brackets: S8-F01-11, S8-F01-12.

Go to: **ASSEMBLY RADIO CHASSIS** and follow instructions.

Then go to: **ASSEMBLY (8" SCREEN)** or **(10" SCREEN)** and follow instructions.

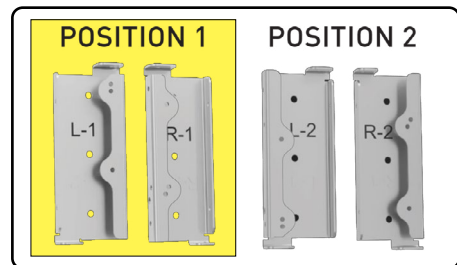

11. Go to **INSTALL AND CONNECT** (INSTALL TYPE-01) and **WIRING DIAGRAM** (INSTALL TYPE-01) and follow instructions.

DASH DISASSEMBLY P1 /2

DD-16

1. Open center console armrest.
Unclip and cup holder assembly, disconnect and remove.
2. Using panel tool release clips securing side console panels and remove.
3. Open media cubby, locate USB hub.
4. Using a panel tool remove the USB hub, disconnect and remove.
5. Remove large side panels on center console.
6. Remove the six (6) bolts securing the media cubby into dash, disconnect and remove.

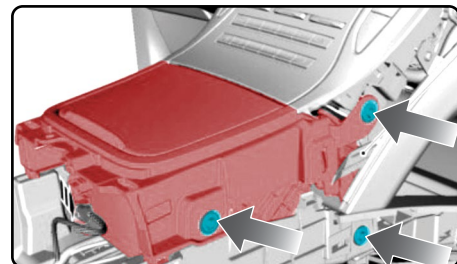

DASH DISASSEMBLY P2 /2

7. Using panel tool release clips securing center channel speaker grill above radio and remove.



8. Remove the 4 bolts, and 6 screws holding center radio bezel, then disconnect and remove.



9. Remove the four (4) 7mm screws securing the radio display, disconnect and remove.

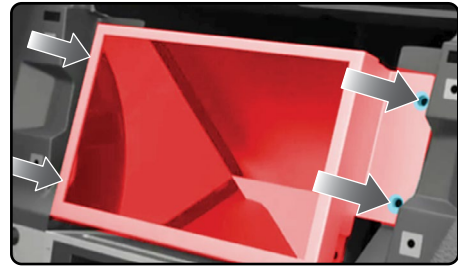

10. Remove two (2) bolts securing bracket in front of CD player. Remove the 2 bolts remaining securing the CD player, disconnect and remove.

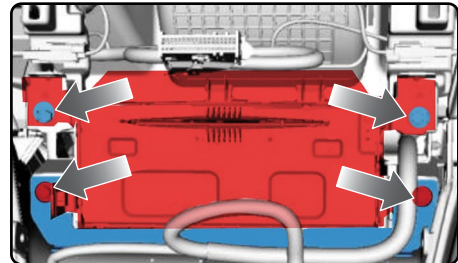

11. Screen bracket position: #1.

Radio chassis brackets: S8-F01-11, S8-F01-12.

Go to: **ASSEMBLY RADIO CHASSIS** and follow instructions.

Then go to: **ASSEMBLY (8" SCREEN)** or **(10" SCREEN)** and follow instructions.

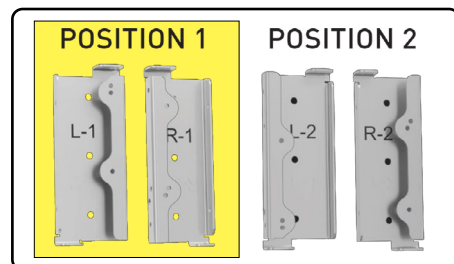

12. Go to **INSTALL AND CONNECT** (INSTALL TYPE-01) and **WIRING DIAGRAM** (INSTALL TYPE-01) and follow instructions.

DASH DISASSEMBLY P1/2

DD-17

1. Release the clips and remove the finish strips on each side of the top of center console.



2. Using panel tool release and remove the top center dash panel.



3. On both sides of the center console disconnect and remove the side panels of the center console.



4. Open center console armrest lid and remove the four (4) bolts securing the trim/cup holder panel.



5. Remove eight (8) bolts securing the center dash/radio bezel in place. Disconnect and remove.



6. Remove the 2 bolts securing the CD player in the dash, disconnect and remove.



DASH DISASSEMBLY P2/2

DD-17

7. Remove 4 screws securing Screen/sync module to radio bezel.



8. (If present) Using a panel tool remove the USB hub, disconnect and remove.

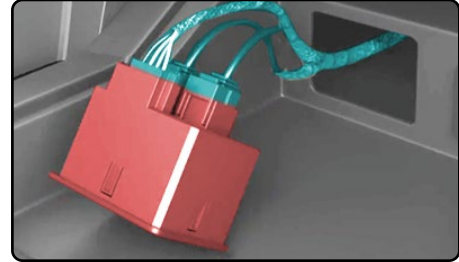

9. Screen bracket position: #2.

Radio chassis brackets: S8-F01-11, S8-F01-12.

Go to: **ASSEMBLY RADIO CHASSIS** and follow instructions.

Then go to: **ASSEMBLY (8" SCREEN)** or **(10" SCREEN)** and follow instructions.

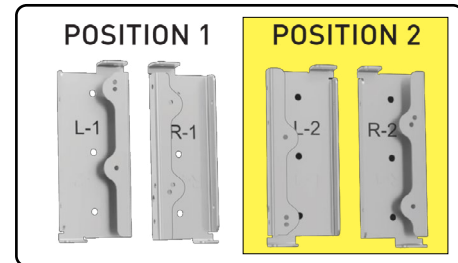

10. Go to **INSTALL AND CONNECT** (INSTALL TYPE-01) and **WIRING DIAGRAM** (INSTALL TYPE-01) and follow instructions.

DASH DISASSEMBLY P1 /2

DD-18

1. Open center console.
Remove gear selector trim bezel.
2. Remove cup holder and console top.
3. Using a panel tool and pushing from the back, remove the USB hub.
4. Remove the two (2) 7mm bolts at the bottom of the radio control panel, then pull back to release clips, disconnect and remove.
5. Remove the four (4) screws securing the CD mechanism into the dash, disconnect and remove.
6. Remove the two (2) bolts securing the screen in place, disconnect and remove.

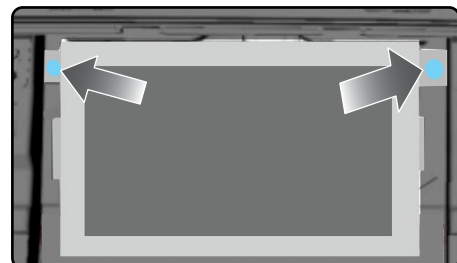
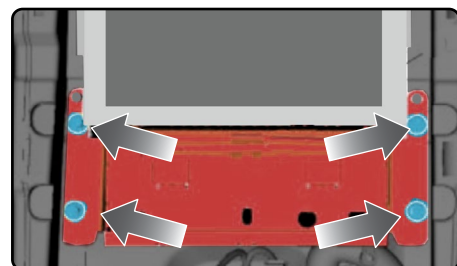
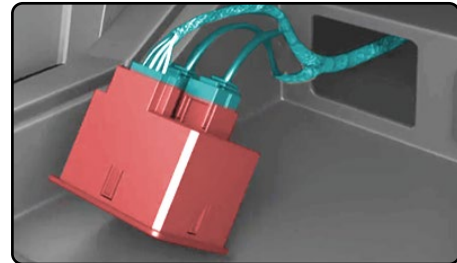

DASH DISASSEMBLY P2/2

DD-18

7. Screen bracket position: #2.

Radio chassis brackets: S8-F01-11, S8-F01-12.

Go to: **ASSEMBLY RADIO CHASSIS** and follow instructions.

Then go to: **ASSEMBLY (8" SCREEN)** or **(10" SCREEN)** and follow instructions.

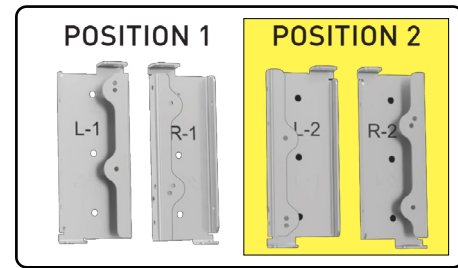

8. Go to **INSTALL AND CONNECT** (INSTALL TYPE-01) and **WIRING DIAGRAM** (INSTALL TYPE-01) and follow instructions.

DASH DISASSEMBLY P1/2

DD-19

1. Using the provided panel tool, remove the upper trim by pulling upward.

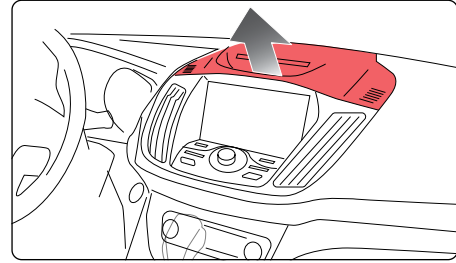

2. Remove the two (2) 7mm screws from the radio bezel.

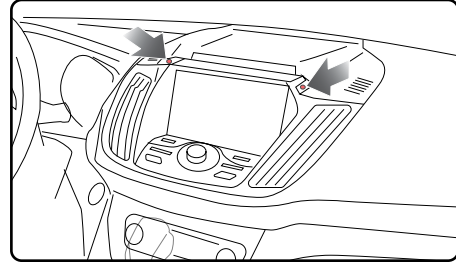

3. Unclip and remove the radio bezel by prying with a plastic panel tool. Unplug the connector from the panel and set it aside.

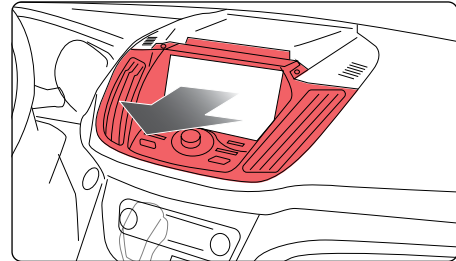

4. Remove four (4) 7mm screws securing the screen. Unplug and remove the screen.

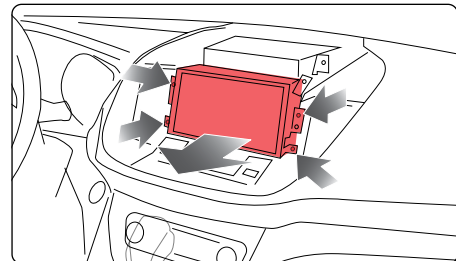

5. Remove two (2) 7 mm screws securing the radio module. Unplug and remove the radio.

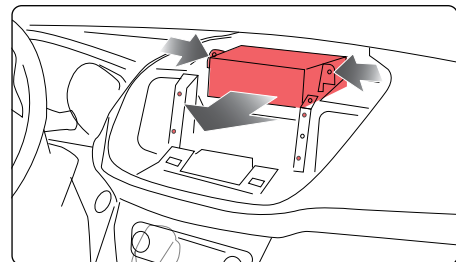

6. Remove (4) 7mm screws securing the radio mounting hardware.

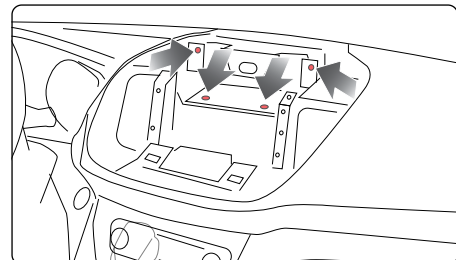

DASH DISASSEMBLY P2 /2

DD-19

7. Remove the factory USB by pressing on the back the housing to release clips, disconnect and remove.

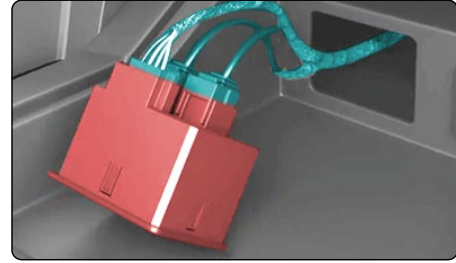

8. Screen bracket position: #2.
Radio chassis brackets: S8-F01-11, S8-F01-12.

Go to: **ASSEMBLY RADIO CHASSIS** and follow instructions.

Then go to: **ASSEMBLY (8" SCREEN)** and follow instructions.

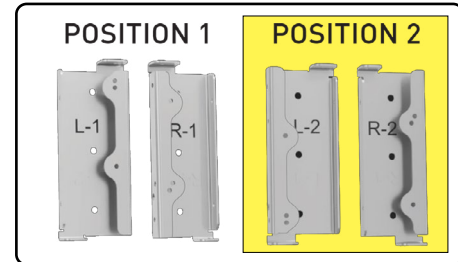

9. Vehicle with amplifier:
Go to **INSTALL AND CONNECT** (INSTALL TYPE-03) and **WIRING DIAGRAM** (INSTALL TYPE-03) and follow instructions.

Vehicle without amplifier:

Go to **INSTALL AND CONNECT** (INSTALL TYPE-04) and **WIRING DIAGRAM** (INSTALL TYPE-04) and follow instructions.

ASSEMBLY (RADIO CHASSIS) P1 /2

THESE STEPS CAN ONLY BE DONE AFTER DASH DISASSEMBLY.

1. Remove the six (6) Phillips screws securing the CD player/radio module brackets (may differ from image shown).
2. Insert the supplied radio chassis brackets between the factory brackets and the radio chassis.
3. Using the supplied hardware, secure the brackets to the radio chassis.

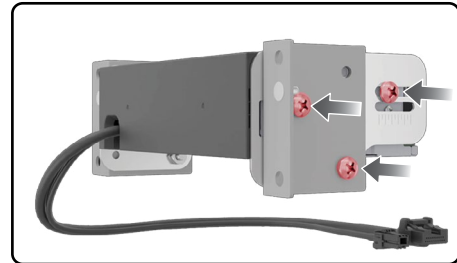
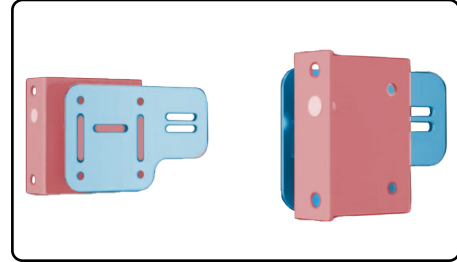
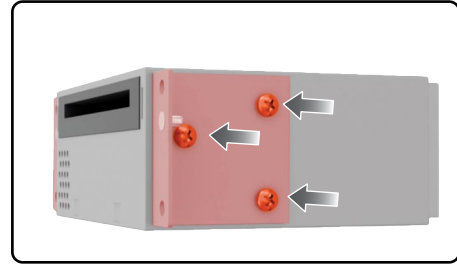

ASSEMBLY (8" SCREEN) P2A/2

THESE STEPS CAN ONLY BE DONE AFTER DASH DISASSEMBLY.

1. Remove the four (4) T15 Torx screws securing the brackets to the factory screen. Remove the brackets (may differ from image shown, they can be placed vertically/horizontally).
2. Align the APX-F8-F01 screen brackets to the holes on the factory brackets. Secure them with the four (4) T15 Torx screws from the factory screen.
3. Place the 8" aftermarket screen onto the APX-F8-F01 brackets.
4. Secure the screen with the six (6) supplied Phillips screws.

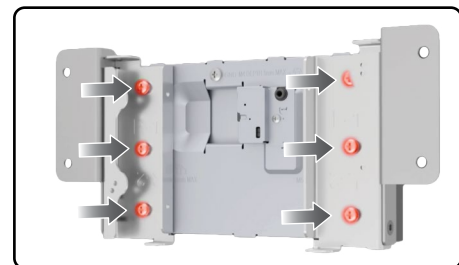
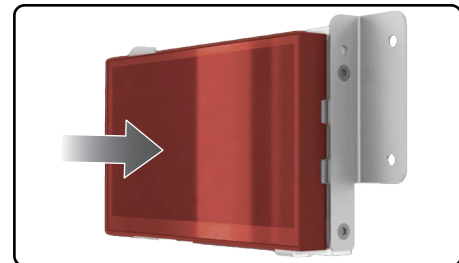
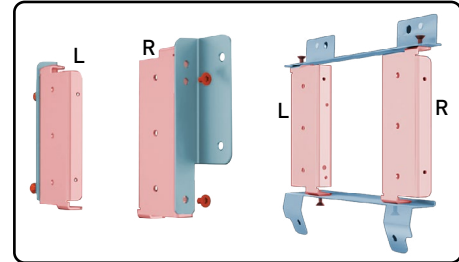
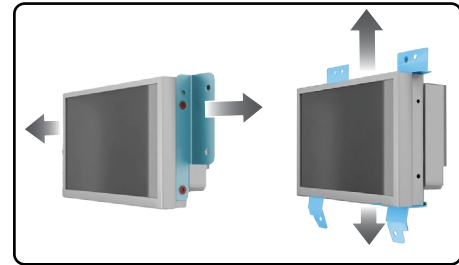

GO TO **INSTALL AND CONNECT** SECTION

ASSEMBLY (10" FLOATING SCREEN) P2B /2

THESE STEPS CAN ONLY BE DONE AFTER DASH DISASSEMBLY.

1. Remove the four (4) T15 Torx screws securing the brackets to the factory screen. Remove the brackets (may differ from image shown, they can be placed vertically/horizontally).
2. Align the APX-F8-F01 screen brackets to the holes on the factory brackets. Secure them with the four (4) T15 Torx screws from the factory screen.
3. Place the included 10" adapter plate onto S8-F01 brackets.
4. Secure the screen plate with the six (6) supplied Phillips screws.
5. Use the included plastic spacers to offset the distance between the floating screen and dash.
6. Align the 10" bracket provided with the radio. Secure it with 4 bolts and washers provided with S8-F01.

GO TO **INSTALL AND CONNECT** SECTION

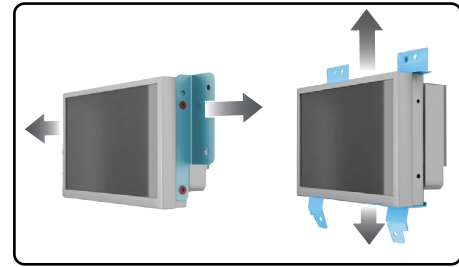

10"

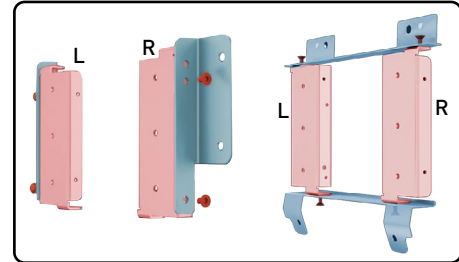

10"

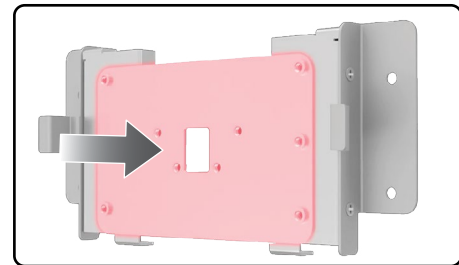

10"

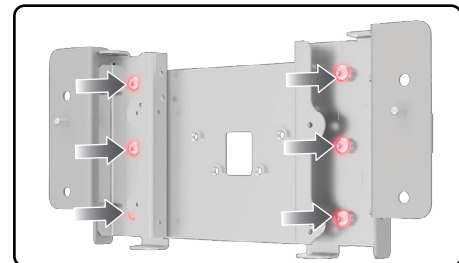

10"

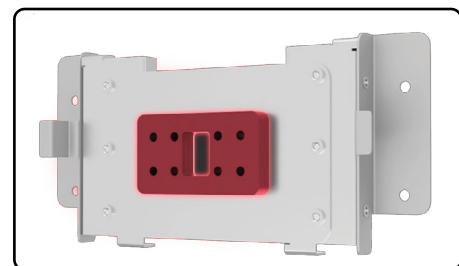

10"

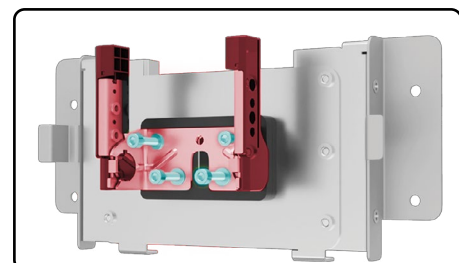

10"

FLOATING SCREEN INSTALLATION EXAMPLE P1/1

1. Install bracket assembly in dash et secure it with the 7mm screws removed earlier.

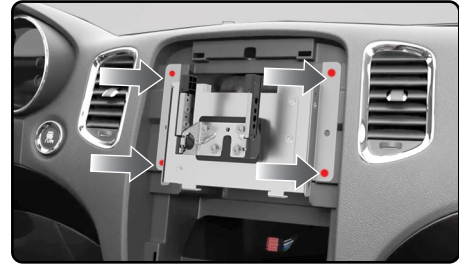

2. Reinstall the radio bezel (reconnect if applicable).



3. Connect the display cables to the back of the screen. Then, attach the black ground wire from the S8-F01 harness to the back of the screen using the single Phillips screw.

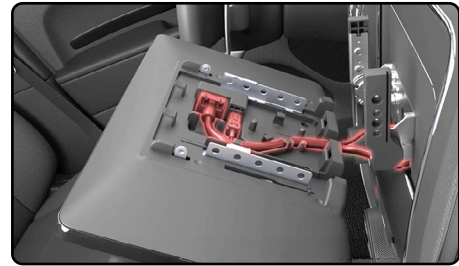

4. Secure the screen to the bracket with the hardware supplied with the radio.



5. Slide the back cover in to place and secure it with the two (2) Phillips screws provided with the radio.

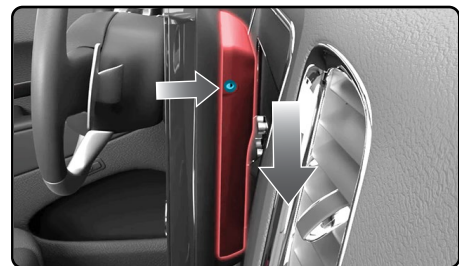

INSTALL AND CONNECT P1 /2

INSTALL TYPE-01

1. Connect A 24-pin adapter to main harness. Connect the S8-F01 T-harness to the main factory wiring harness and SYNC harness.

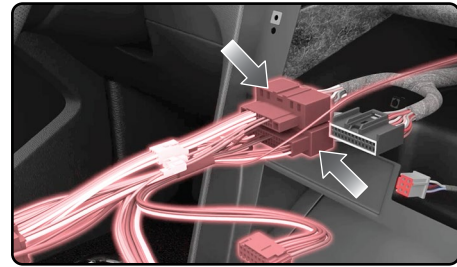

2. Connect the Maestro module to the S8-F01 T-harness. Connect the 4-Pin black data cable provided with the Maestro module to the BLACK 4-pin port on the Maestro module. Connect the 3-pin audio cable (the data and 3.5mm audio cables are provided with the Maestro module).

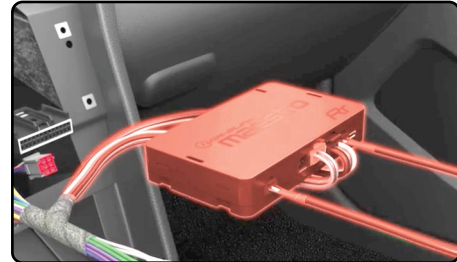

If the vehicle is equipped with premium sound (with amplifier)

3. Disconnect the white 4-pin connectors. Then, connect the PAD1 (sold separately) in line.

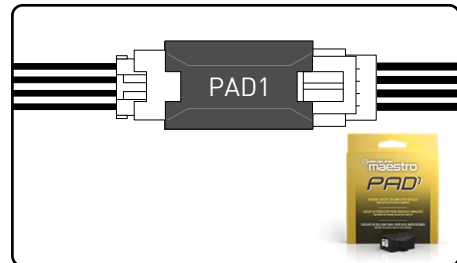

Connect the provided (subwoofer 26 pin) S8-F01-B harness to the main vehicle harness, then connect the white 2-pin plug to the main S8-F01 harness.

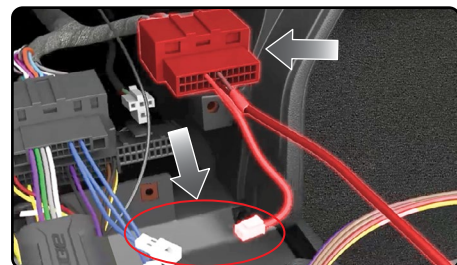

4. You will need to install the Bluetooth microphone and GPS antenna to their recommended locations by the radio manufacturer OR use the optional MIC1 and NAV4 to retain the factory Microphone and GPS antenna (if equipped).

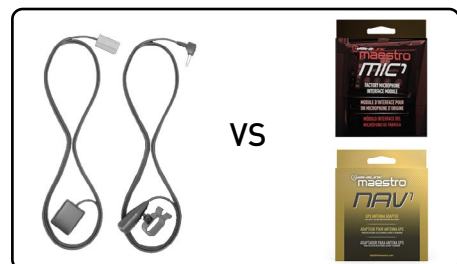

5. Press the S8-F01 T-harness and Maestro module into the lower dash cavity. Then, connect the supplied antenna adapter to the factory antenna connection.

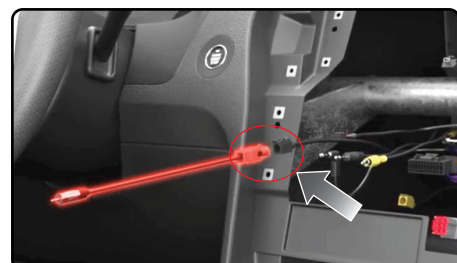

INSTALL AND CONNECT P2 /2

INSTALL TYPE-01

6. Locate suitable USB media hub replacement and route USB cables through center console to lower dash cavity (may differ from image).

Note: Do not use USB-A connection.

7. Make all connections to the back of the aftermarket radio (use head unit adapter OR cut connector from the S8-F01 harness and connect the wires as shown in the wiring diagram). Make sure to connect the 4-pin data cable to the iDatalink I/F port and 3.5mm audio cable to the iDatalink I/F port.

Secure USB with metal clip.

8. Press the radio chassis into the dash cavity and secure it with the four (4) 7mm screws removed earlier.

If installing 10" floating screen, refer to : **FLOATING SCREEN INSTALLATION EXAMPLE PAGE.**

9. Connect the display cables to the back of the screen. Then, attach the black ground wire from the S8-F01 harness to the back of the screen using the single Phillips screw.

10. Place the screen into the dash and secure it with the four (4) 7mm screws removed earlier.

11. Reinstall (clip / fix) the radio bezel into place as it was originally.

Put everything that was disassembled back into place, using reverse order of the removal steps.

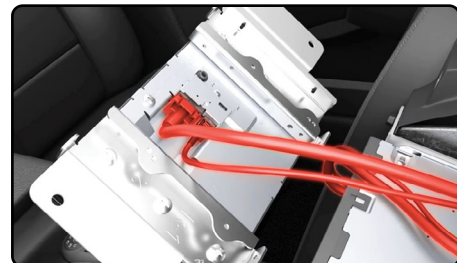
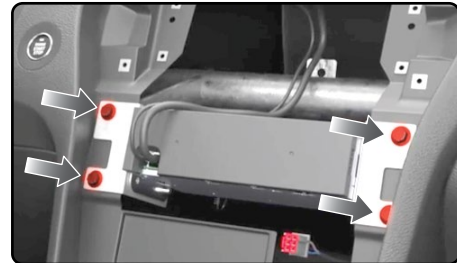
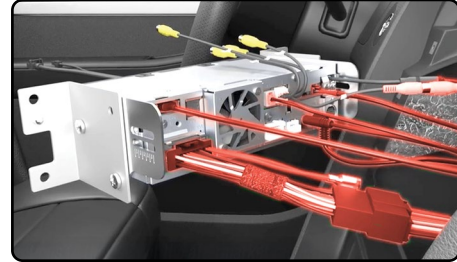
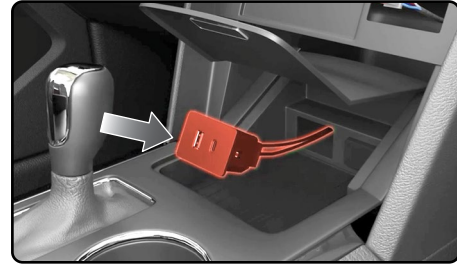

8"

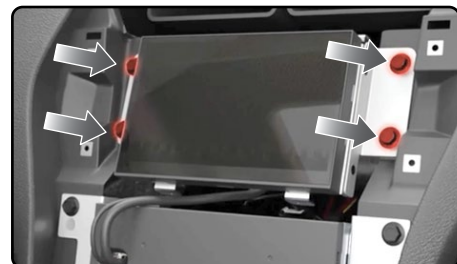

8"

WIRING DIAGRAM

INSTALL TYPE-01

SOME CABLES INCLUDED WITH MAESTRO MODULE ARE NOT USED

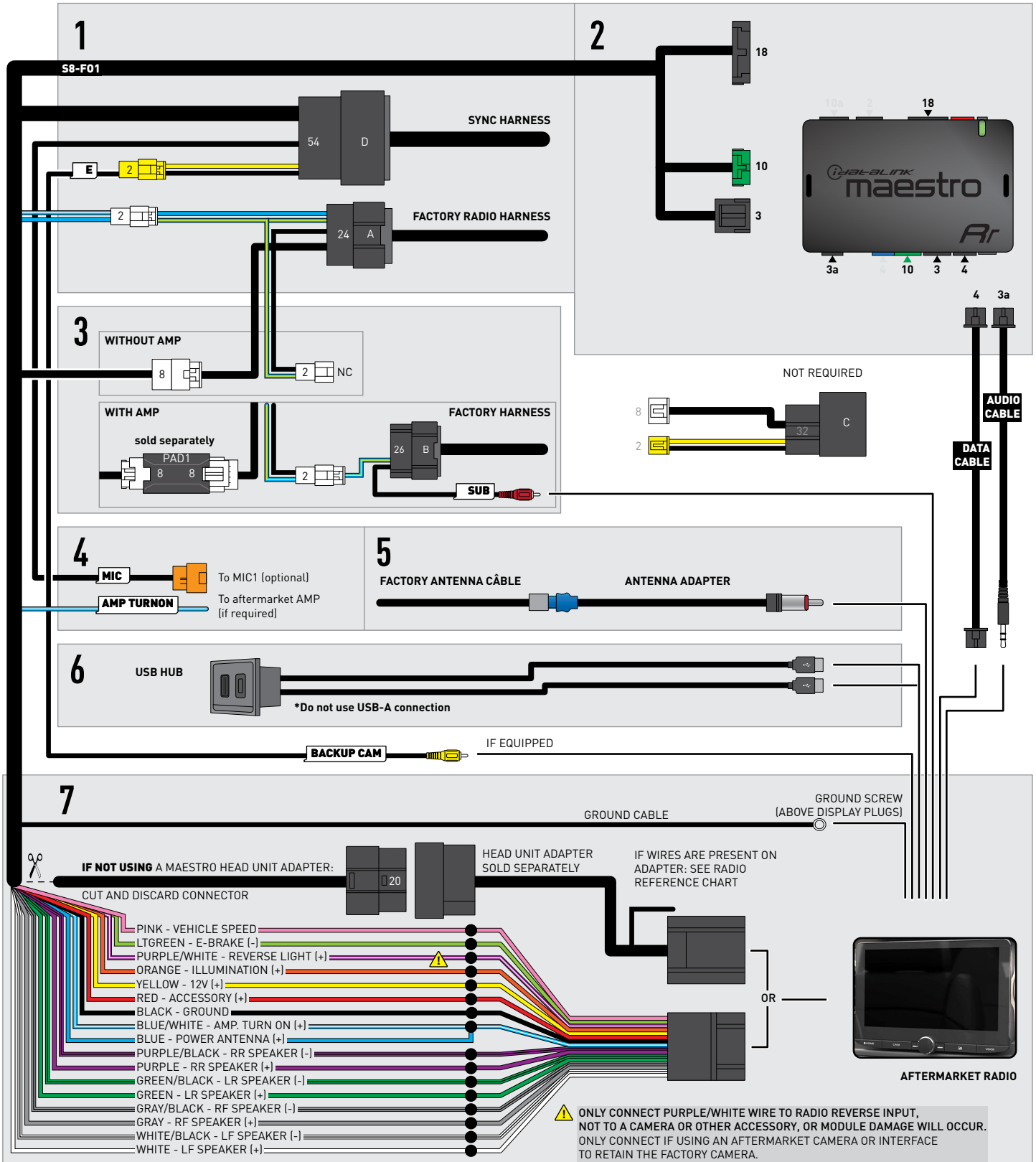

INSTALL AND CONNECT P1 /2

INSTALL TYPE-02

1. Connect C 32-pin adapter to main harness. Connect S8-F01 T-harness to the main factory wiring harness and SYNC harness.

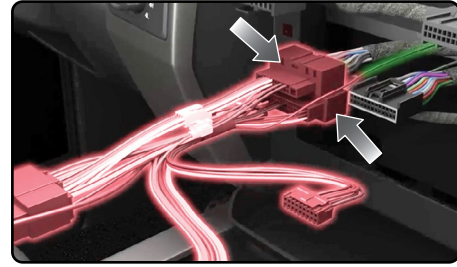

2. Connect the Maestro module to the S8-F01 T-harness. Connect the 4-Pin black data cable provided with the Maestro module to the BLACK 4-pin port on the Maestro module. Connect the 3-pin audio cable (the data and 3.5mm audio cables are provided with the Maestro module).

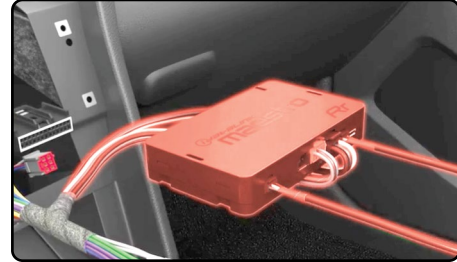

3. You will need to install the Bluetooth microphone and GPS antenna to their recommended locations by the radio manufacturer OR use the optional MIC1 and NAV4 to retain the factory Microphone and GPS antenna (if equipped).

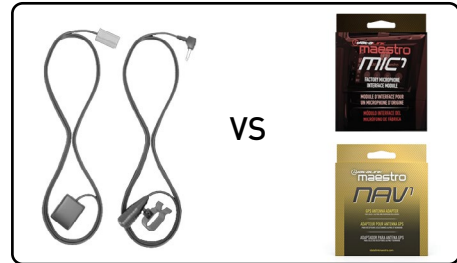

4. Press the S8-F01 T-harness and Maestro module into the lower dash cavity. Then, connect the supplied antenna adapter to the factory antenna connection.

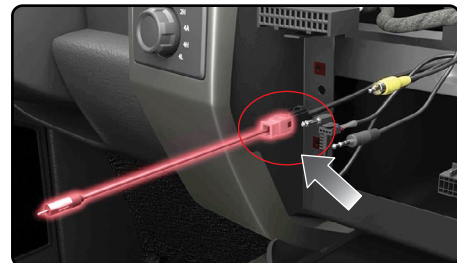

5. Locate suitable USB media hub replacement and route USB cables through center console to lower dash cavity.

Note: Do not use USB-A connection.



6. Make all connections to the back of the aftermarket radio (use head unit adapter OR cut connector from the FL-CH2 harness and connect the wires as shown in the wiring diagram). Make sure to connect the 4-pin data cable to the iDatalink I/F port and 3.5mm audio cable to the iDatalink I/F port.

Secure USB with metal clip.



INSTALL AND CONNECT P2 /2

INSTALL TYPE-02

7. Press the radio chassis into the dash cavity and secure it with the four (4) 7mm screws removed earlier.

If installing 10" floating screen, refer to : **FLOATING SCREEN INSTALLATION EXAMPLE PAGE.**

8. Connect the display cables to the back of the screen. Then, attach the black ground wire from the S8-F01 harness to the back of the screen using the single Phillips screw.

9. Place the screen into the dash and secure it with the 7mm screws removed earlier.

10. Reconnect the wire harnesses to factory radio bezel and clip back into place. Secure it with the two (2) 7mm screws removed earlier.

11. Put everything that was disassembled back into place, using reverse order of the removal steps.

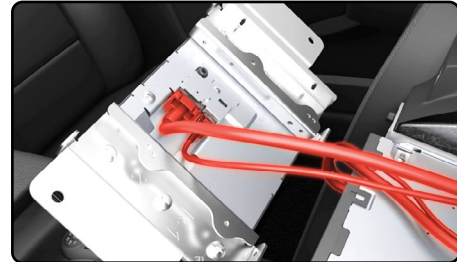
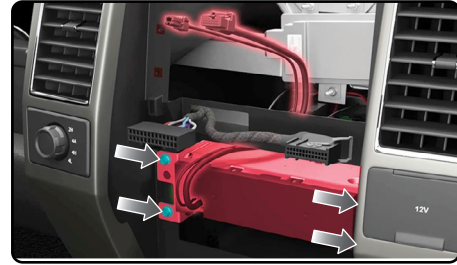

8"

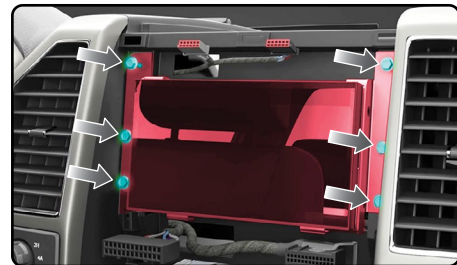

8"



WIRING DIAGRAM

INSTALL TYPE-02

SOME CABLES INCLUDED WITH MAESTRO MODULE ARE NOT USED

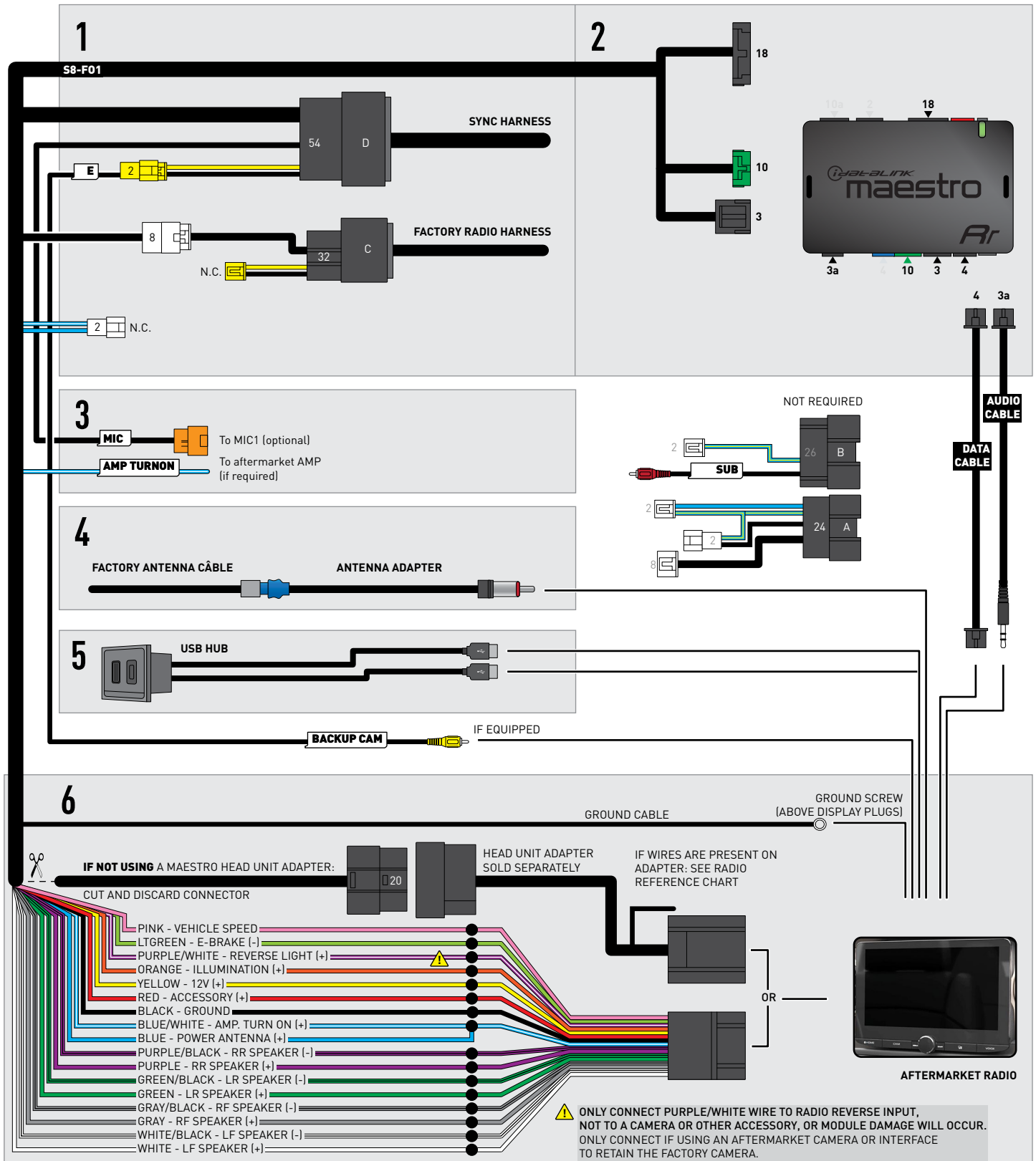

INSTALL AND CONNECT P1 /2

INSTALL TYPE-03

1. Connect A 24-pin adapter to main harness. Connect the S8-F01 T-harness to the main factory wiring harness and SYNC harness.

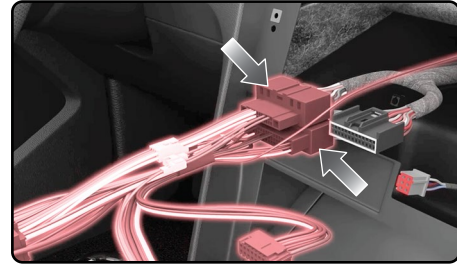

2. Connect the Maestro module to the S8-F01 T-harness. Connect the 4-Pin black data cable provided with the Maestro module to the BLACK 4-pin port on the Maestro module. Connect the 3-pin audio cable (the data and 3.5mm audio cables are provided with the Maestro module).

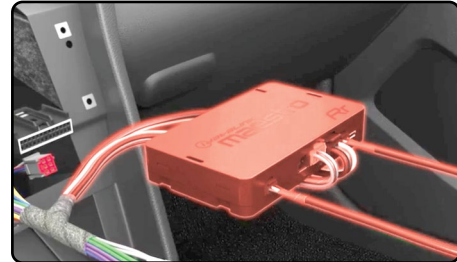

3. Modifications: 24-pin S8-F01 A adapter and audio cable

Cut and isolate (tape) GREEN, GREEN/BLACK, PURPLE and PURPLE/BLACK wires near 8-pin white connector (S8-F01-A adapter).

Cut and remove 3.5mm connector (audio cable, included with Maestro module).

Connect green wire to white of audio cable. Connect purple to red of audio cable. Connect green/black and purple/black to black wire of audio cable.

Disconnect the white 4-pin connectors. Then, connect the PAD1 (sold separately) in line.

Connect 2-pin white (A 24-pin adapter) to B 26-pin sub adapter. Connect to vehicle harness.

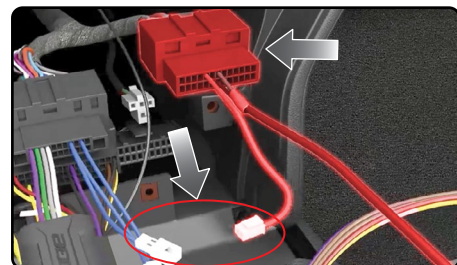
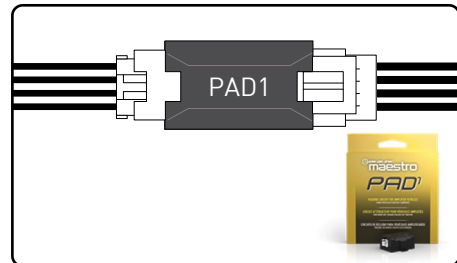

4. You will need to install the Bluetooth microphone and GPS antenna to their recommended locations by the radio manufacturer OR use the optional MIC1 and NAV4 to retain the factory Microphone and GPS antenna (if equipped).

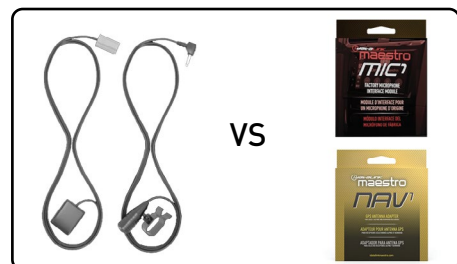

5. Press the S8-F01 T-harness and Maestro module into the lower dash cavity. Then, connect the supplied antenna adapter to the factory antenna connection.

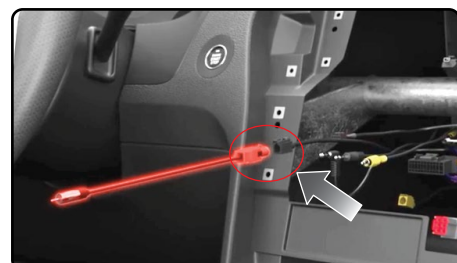

INSTALL AND CONNECT P2 /2

INSTALL TYPE-03

6. Locate suitable USB media hub replacement and route USB cables through center console to lower dash cavity (may differ from image).

Note: Do not use USB-A connection.

7. Make all connections to the back of the aftermarket radio (use head unit adapter OR cut connector from the S8-F01 harness and connect the wires as shown in the wiring diagram). Make sure to connect the 4-pin data cable to the iDatalink I/F port and 3.5mm audio cable to the iDatalink I/F port.

8. Secure USB with metal clip. Press the radio chassis into the dash cavity and secure it with the four (4) 7mm screws removed earlier.

If installing 10" floating screen, refer to : **FLOATING SCREEN INSTALLATION EXAMPLE PAGE.**

9. Connect the display cables to the back of the screen. Then, attach the black ground wire from the S8-F01 harness to the back of the screen using the single Phillips screw.

10. Place the screen into the dash and secure it with the four (4) 7mm screws removed earlier.

11. Reinstall (clip / fix) the radio bezel into place as it was originally.

Put everything that was disassembled back into place, using reverse order of the removal steps.

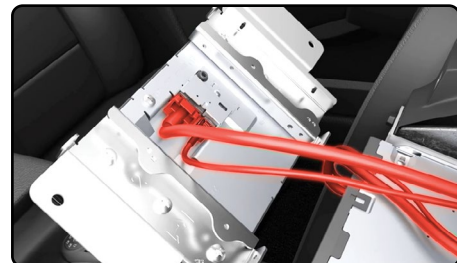
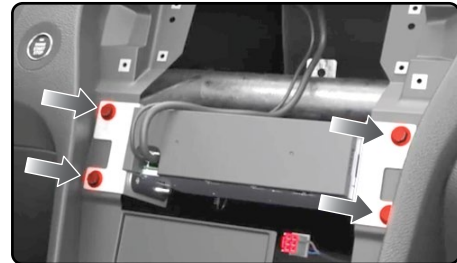
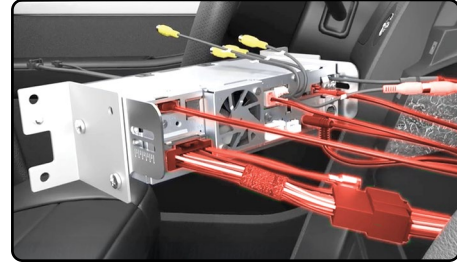
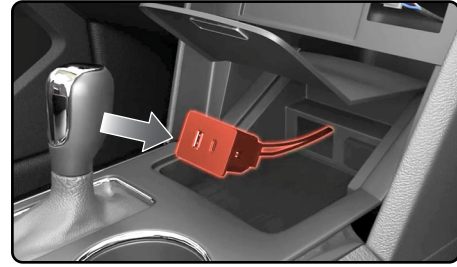

8"

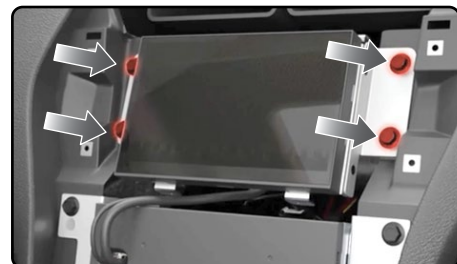

8"

WIRING DIAGRAM

INSTALL TYPE-03

SOME CABLES INCLUDED WITH MAESTRO MODULE ARE NOT USED

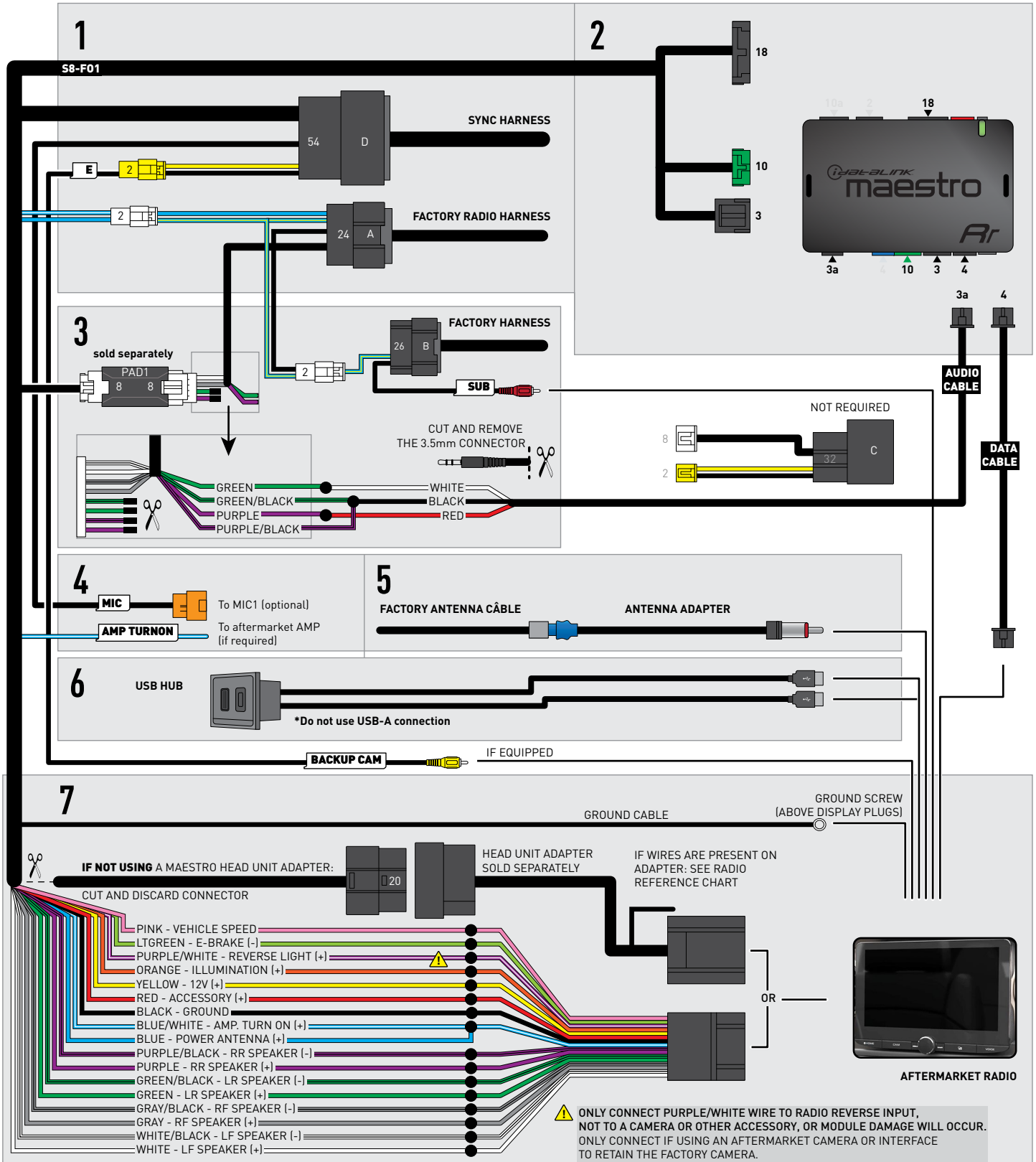

INSTALL AND CONNECT P1 /2

INSTALL TYPE-04

1. Connect A 24-pin adapter to main harness. Connect S8-F01 T-harness to the main factory wiring harness and SYNC harness.
2. Connect the Maestro module to the S8-F01 T-harness. Connect the 4-Pin black data cable provided with the Maestro module to the BLACK 4-pin port on the Maestro module. Connect the 3-pin audio cable (the data and 3.5mm audio cables are provided with the Maestro module).
3. You will need to install the Bluetooth microphone and GPS antenna to their recommended locations by the radio manufacturer OR use the optional MIC1 and NAV4 to retain the factory Microphone and GPS antenna (if equipped).
4. Press the S8-F01 T-harness and Maestro module into the lower dash cavity. Then, connect the supplied antenna adapter to the factory antenna connection.
5. Locate suitable USB media hub replacement and route USB cables through center console to lower dash cavity. (Do not use USB-A connection).
6. Make all connections to the back of the aftermarket radio (use head unit adapter OR cut connector from the FL-CH2 harness and connect the wires as shown in the wiring diagram). Make sure to connect the 4-pin data cable to the iDatalink I/F port and 3.5mm audio cable to the iDatalink I/F port.

Secure USB with metal clip.

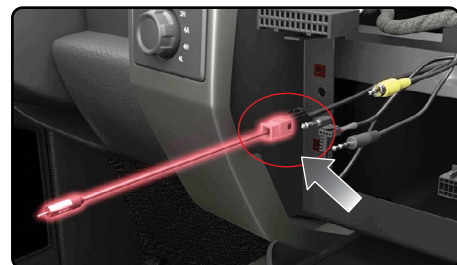
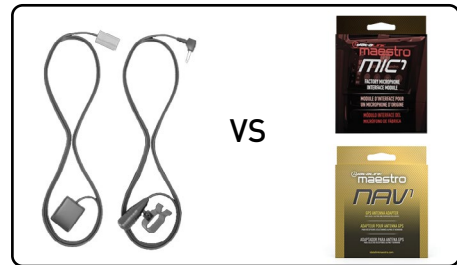
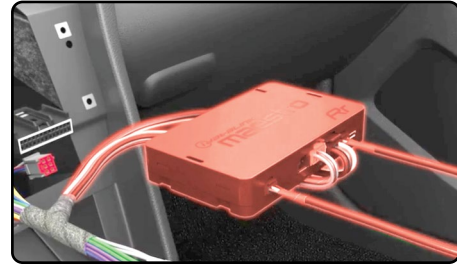
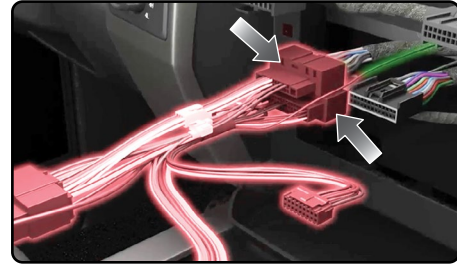

INSTALL AND CONNECT P2 /2

INSTALL TYPE-04

7. Press the radio chassis into the dash cavity and secure it with the four (4) 7mm screws removed earlier.

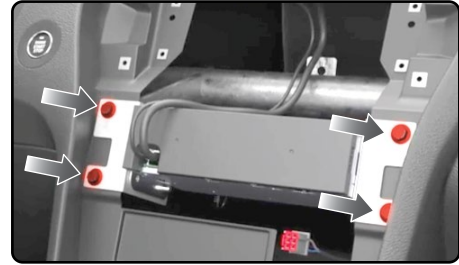

8. Connect the display cables to the back of the screen. Then, attach the black ground wire from the S8-F01 harness to the back of the screen using the single Phillips screw.

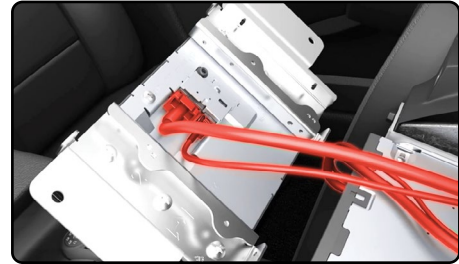

8"

9. Place the screen into the dash and secure it with the 7mm screws removed earlier.

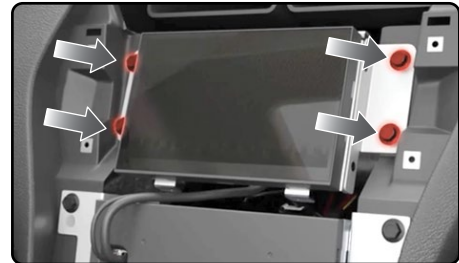

8"

10. Reinstall (clip / fix) the radio bezel into place as it was originally.
Put everything that was disassembled back into place, using reverse order of the removal steps.

WIRING DIAGRAM

INSTALL TYPE-04

SOME CABLES INCLUDED WITH MAESTRO MODULE ARE NOT USED

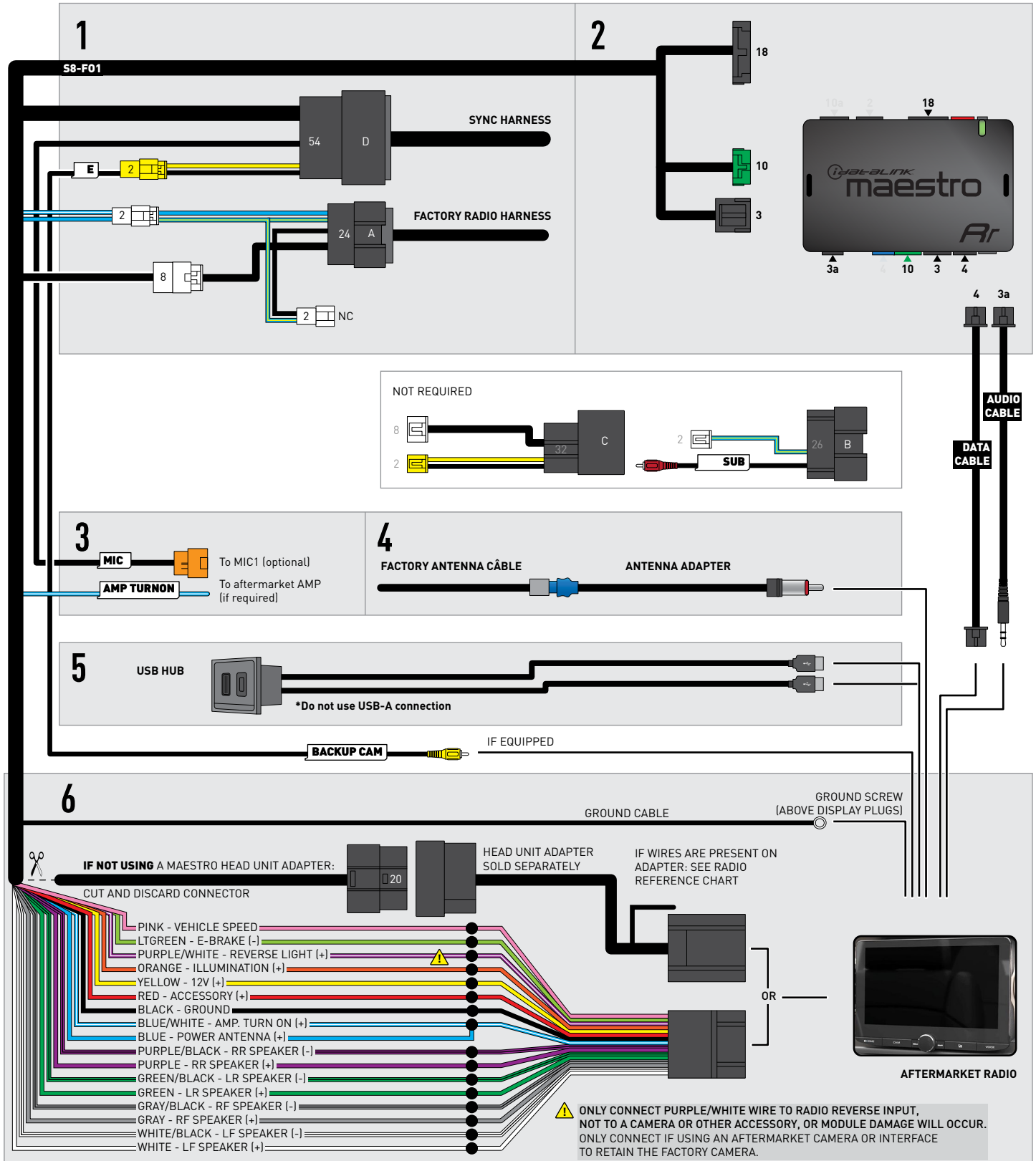

RADIO WIRE REFERENCE CHART

S8-F01 T-harness Wire Description	Polarity	Wire Color on Maestro T-Harness	Wire Color on Kenwood cable
Illumination	(+)	Orange	Orange/White
Reverse Light*	(+)	Purple/White	Purple/White
E-Brake	(-)	Lt Green	Lt Green
VSS (vehicle speed sensor)	(DATA)	Pink	Pink
Power Antenna	(+)	Blue	Blue

***Note:** REVERSE LIGHT purple/white wire is a low current positive output used to trigger the radio only. Do NOT connect to anything other than the radio's reverse input.

If no camera is installed/desired, do not connect the radio's reverse wire. If installing an aftermarket camera, do NOT connect power for the camera to the Maestro's purple/white wire or module damage will occur.

Head unit adapter wiring (optional accessory, sold separately)

ACC-HU-KEN1 Wire Description	Polarity	Wire Color on Adapter	Kenwood Radio
CAM	(+)	Green/Red	Refer to camera/radio manual
CAM	(-)	Green/White	Refer to camera/radio manual
Steering Wheel Controls	(DATA)	Blue/Yellow	n/a

DIAGNOSTIQUE DU MODULE



DEL 1 État du module / État de la programmation	État de la DEL	DIAGNOSTIQUE
● ou ●	Clignotement ROUGE ou VERT	La DEL clignote 1 ou plusieurs fois, en rouge ou en vert, lorsqu'on appuie sur un bouton du volant : Réaction normale.
●	Clignote ROUGE 1 fois	Le module n'est pas programmé. Programmer le module en utilisant Weblink Desktop, vous devez vous connecter. Ne <u>PAS</u> utiliser le MODE DEMO.
●	Clignote ROUGE 2 fois	Problème détecté. Consulter le tableau de dépannage.
●	Clignote VERT 1 fois	Suite à l'allumage de l'autoradio : Réaction normale.
●	ÉTEINT	Inactif : État normal.

TROUBLESHOOTING TABLE

PROBLEM	SOLUTION
Gauges do not work, radio shows OBD2 Error 1 or Error 2.	If anything else is connected to the OBD2 or CAN wires of vehicle (programmer, throttle controller, insurance tracker, etc.) try unplugging it to see if gauges work. If gauges work without it installed, call tech support for options. Reset the RR.
The light on the Maestro is blinking RED TWICE and the radio IS turning on.	Ensure the 4-pin data cable is connected between the radio and the RR, and that it is plugged into the black port on the Maestro RR. The red and blue ports on the RR should be empty. Make sure the correct radio model and serial number were entered during the flash. Verify the radio's serial number entered during the flash matches what is listed on the radio screen. This can be found in the settings of the radio, listed as Device Id, Device Number, or Serial Number.
The light on the Maestro is blinking RED TWICE but radio is NOT turning on.	If radio is not turning on, ensure the screen cables are fully connected and seated. Test red and yellow wires for DC voltage at radio using a multimeter. Contact support if no voltage on red or yellow.

MAESTRO RR RESET PROCEDURE:

Turn the key to the OFF position, then disconnect all connectors from the module.

Press and hold the module's programming button and connect all the connectors back to the module. Wait, the module's LED will flash RED rapidly (this may take up to 10 seconds).

Release the programming button. Wait, the LED will turn solid GREEN for 2 seconds to show the reset was successful.

TECHNICAL ASSISTANCE

Phone: 1-866-427-2999

Email: maestro.support@idatalink.com

IMPORTANT: To ensure proper operation, the aftermarket radio needs to have the latest firmware from the manufacturer. Please visit the radio manufacturer's website and look for any updates pertaining to your radio.