

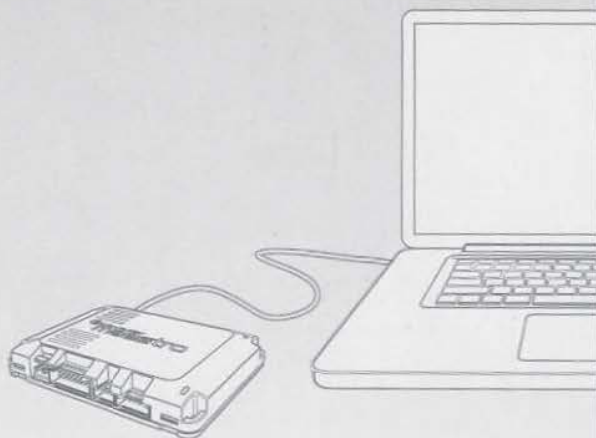

SW | AR | AR | SW (HD)

QUICK START GUIDE



FOLLOW THE WEB PROGRAMMING
STEPS INSIDE PRIOR TO INSTALLATION.



WEB PROGRAMMING

1- INSTALL THE WEBLINK DESKTOP APPLICATION

Go to www.idatalinkmaestro.com/plugin, select your software version (Mac or PC) and follow the installation steps. Be sure to review the system requirements before installing.

2- REGISTER A WEBLINK ACCOUNT

Once installed, complete the Weblink registration process and log into Weblink.

3- CONNECT THE MODULE TO YOUR COMPUTER

Use the included USB cable to connect your iDatalink Maestro module to your computer.

4- WEBLINK PROGRAMMING

Follow the programming steps until your module is flashed, then download your install guide and owner's manual if applicable.

5- COMPLETE VEHICLE-SPECIFIC INSTALLATION

Follow the steps in your install guide and complete the installation. ADS recommends having your iDatalink Maestro device installed by a certified technician. **Additional accessories may be required and sold separately.**



TECHNICAL SUPPORT

877.212.6169

idatalinkmaestro.com

LIMITED 1-YEAR WARRANTY

Automotive Data Solutions Inc. ("ADS") warrants to the original purchaser of the product that the following components product shall be free of defects in material and workmanship under normal use and circumstances for the period of one (1) year from the date of original installation.

"Authorized Dealer" is defined by ADS as a company who qualifies to purchase products directly from ADS, or one of its approved distributors. Thus, products not sold nor installed by an Authorized Dealer are not covered by this warranty. This includes, but is not limited to, ADS products sold on Amazon.com, eBay.com, Walmart.com and Newegg.com. To find an authorized retailer near you, visit <http://maestro.idatalink.com/find-product>.

In the event of any product malfunction during the Warranty period, the original purchaser must return to the Authorized Dealer where it was originally purchased with the original proof of purchase. If a malfunction is detected, the Authorized Dealer will elect to repair or replace the product at its discretion. Labor costs may be applicable and are at the discretion of the Authorized Dealer.

ADS is not responsible for any damages whatsoever, including but not limited to any consequential damages, incidental damages, damages for loss of time, loss of earnings, commercial loss, loss of economic opportunity and the like that may or may not have resulted from the installation or operation of an iDatalink Maestro product.



TECHNICAL SUPPORT

877.212.6169

idatalinkmaestro.com

FORD AND LINCOLN VEHICLES
(SEE DETAILS INSIDE)

INSTALL GUIDE

F01-RR2-DS3-(APX-S8-F02)-EN

RETAINS STEERING WHEEL CONTROLS AND MORE!

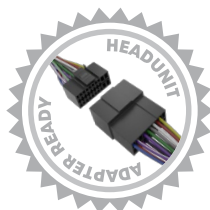

**REQUIRED:
HEAD UNIT
ADAPTER**

PRODUCTS REQUIRED

iDatalink Maestro RR2 Radio Replacement Interface
iDatalink Maestro APX-S8-F02 Dash Kit
Kenwood APX radios

PROGRAMMED FIRMWARE: F01-RR2-DS3

WELCOME

Congratulations on the purchase of your iDatalink Maestro RR2 Radio replacement solution. You are now a few simple steps away from enjoying your new car radio with enhanced features.

Before starting your installation, please ensure that your iDatalink Maestro module is programmed with the correct firmware for your vehicle and that you carefully review the install guide.

Please note that Maestro RR2 will only retain functionalities that were originally available in the vehicle.

NEED HELP?

1 866 427-2999

maestro.support@idatalink.com

ADDITIONAL INFORMATION AND ACCESSORIES

Installation, product information, vehicle specific videos.

[VIDEO HELP](#)



Last flash information, steering control configuration, vehicle information.

[VERIFY FLASH](#)



Software to program module.

[WEBLINK](#)



Configuring the RR2's Programmable Outputs

[Maestro RR2 Programmable Outputs Guide](#)

HEAD UNIT ADAPTER (REQUIRED):

ACC-HU-KEN1

APX compatible radios:

Kenwood and JVC

Factory microphone interface module (optional)

MIC1

Radar Detectors



[Radar Installation Guides](#)

APX-S8-F02 COMPONENTS

QUICK START GUIDE



3MVHB
for mounting RR/RR2 module.



SM5-16P*4
4x (M5 16mm screw)



SM5-6P*10
10x (M5 6mm screw)



SM5-8P*4, NM5*4, WM5-SPLIT*4
4x (M5 8mm bolt, nut and washer)



GND



Maestro panel removal tool



FLOATING SCREEN ADAPTER BRACKET
APX-S8-F01-91

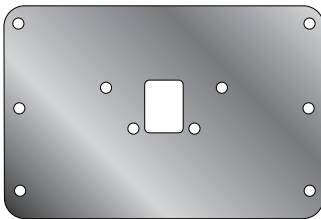

SCREEN BRACKETS

S8-F02-11
LEFT (L)

S8-F02-12
RIGHT (R)

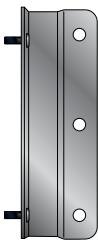

MAIN HARNESS HRN-S8-F02

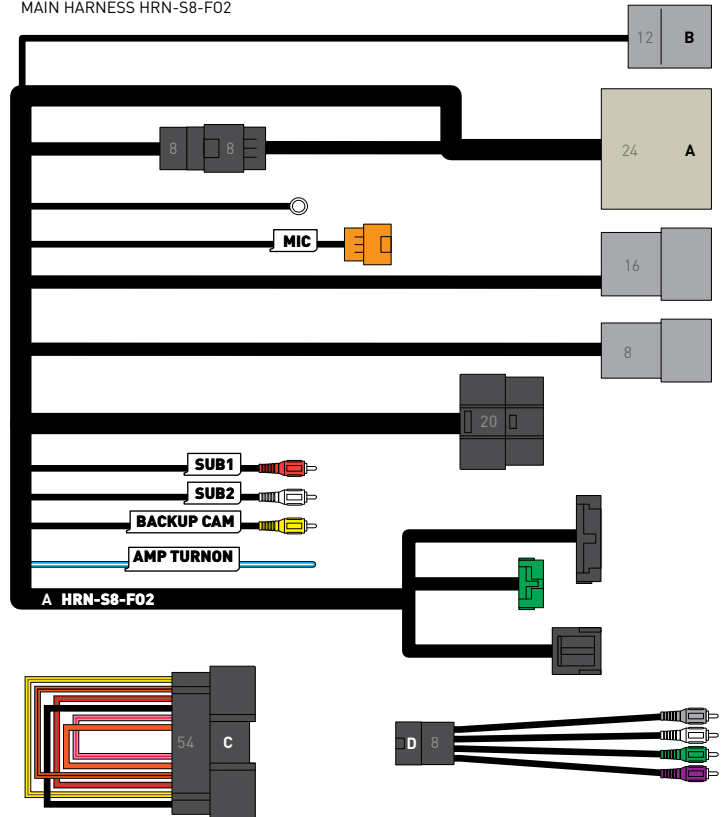

Mini USB to USB-C ADAPTER



AM/FM ANTENNA ADAPTER

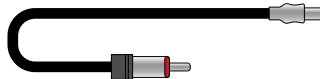

RADIO CHASSIS BRACKETS

S8-F02-11
LEFT (L)

S8-F02-12
RIGHT (R)

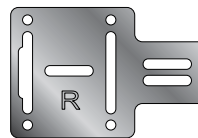
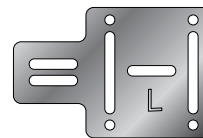

VEHICLE LIST

NOTE: This installation is quite difficult. Although this guide offers step-by-step instructions, we strongly recommend professional installation.

| MAKE | MODEL* | TRIM 8" RADIO | YEAR | INSTALL TYPE | NOTE |
|---------|-------------------------|-------------------------|-------|--------------|---|
| FORD | F150 | with factory navigation | 09-12 | 01 | SYNC location: above radio, under storage tray. |
| | Flex | with factory navigation | 09-12 | 01 | SYNC location: in center console. |
| | Fusion | with factory navigation | 10-12 | 01 | SYNC location: at rear of console. |
| | Mustang | with factory navigation | 10-14 | 01 | SYNC location: behind glove box. |
| LINCOLN | MKS | with factory navigation | 09-12 | 01 | SYNC location: in center console. |
| | MKT | with factory navigation | 10-12 | 01 | SYNC location: in center console. |
| | MKZ | with factory navigation | 10-12 | 01 | SYNC location: rear of console. |
| MERCURY | Milan | with factory navigation | 10-11 | 01 | SYNC location: rear of console. |

* Click on your model to go to the related dash disassembly instruction page.

DASH DISASSEMBLY P1 /3

F150

1. Open, unclip and remove the glove box

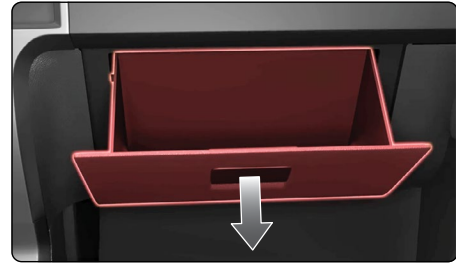

2. Remove (3) 10 mm bolts securing the air bag.



3. Using a panel tool, gently release the clips holding the air bag in place.

DO NOT disconnect the air bag with the battery connected.



4. This should expose (1) 7mm bolt securing the panel to the right of the radio bezel.

Remove the 7mm bolt, then unclip, disconnect and remove the panel.



5. Using a panel tool, remove the plastic trim panel at the top of the dash bezel.



6. Remove the two (2) 7mm screws, securing the top of the radio bezel.



DASH DISASSEMBLY P2/3

F150

7. Using a panel tool, gently release the clips securing the USB and auxiliary input panel.
- Disconnect the harnesses.

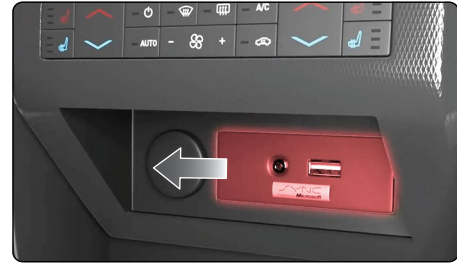

8. Remove the single (1) 7mm screw securing the lower part of the dash bezel.



9. Using a panel tool, gently release the clips securing the left dash trim. Release it just enough for the radio bezel to slip past it.



10. Using a panel tool, unclip the radio bezel, then unplug and remove it.



11. Remove the four (4) 7mm screws securing the factory display. Remove and disconnect the display.

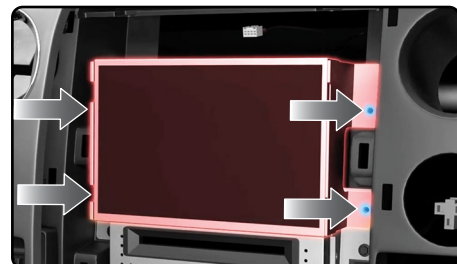

12. Remove the four (4) 7mm screws securing the factory CD player. Remove and disconnect the CD player.

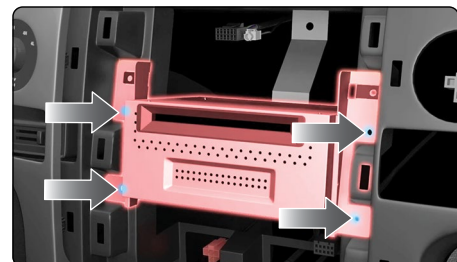

DASH DISASSEMBLY P3/3

F150

13. Remove the rubber mat located on top of dash.
Remove the two (2) 7mm screws.
Remove top storage tray to access the SYNC module.
-



14. Disconnect the 54-pin SYNC connector.

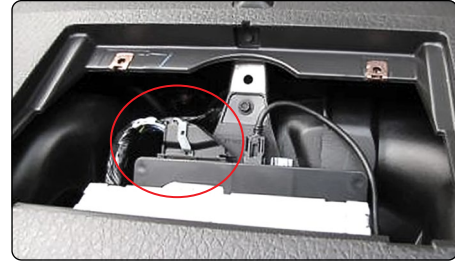

DASH DISASSEMBLY P1/3

Front center console disassembly (1-7)

1. Lift the storage compartment lid. Unclip and remove the trim around the shifter.
2. Unclip and remove the top of the center console and cupholders. Disconnect.
3. Unclip the side panels on the center console. This will expose (1) 7mm screw on each side securing the bottom of the radio bezel. Remove these screws.
4. Position the front seats forward.

Locate and remove the rear lower bolt cover (each side of the console). Remove the bolts.
5. Position the front seats rearward.

Pull the middle and rear of each center console trim panel outward to release the clips. Pull the front of each trim panel downward to unclip.

Position a piece of cardboard between each trim panel and the floor console.

Remove left trim panel and cardboard simultaneously. Disconnect if required.

Remove right trim panel and cardboard simultaneously. Disconnect if required.

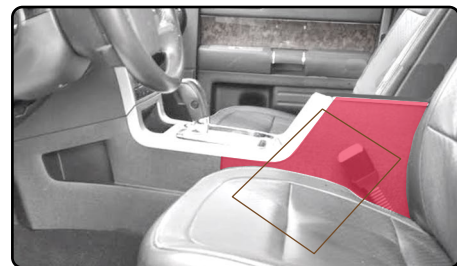
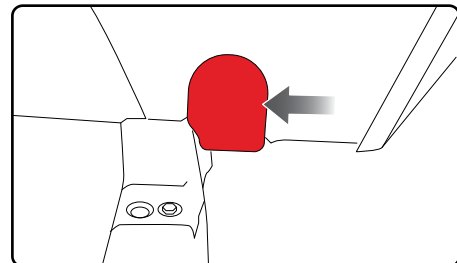
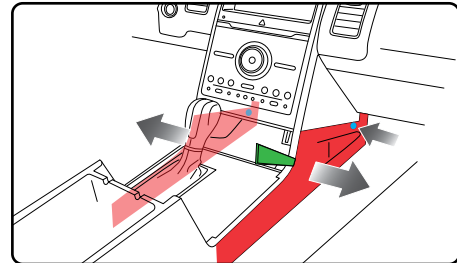
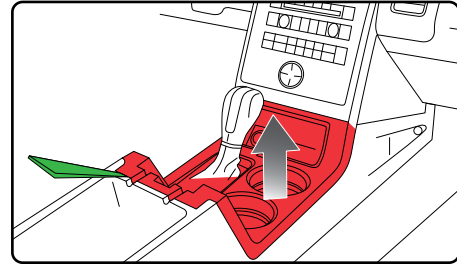
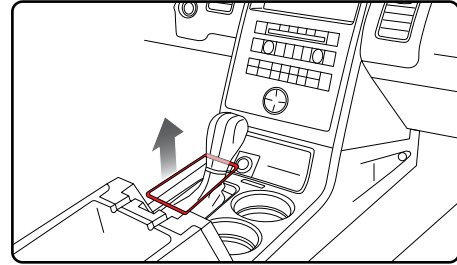

DASH DISASSEMBLY P2 /3

6. Remove the four (4) console lower bolts.
Remove the two (2) console upper bolts.
7. If console removal is required to access the SYNC plug, disconnect the center console harness connector to right of the shifter area.
8. Disconnect the 54-pin SYNC connector.
9. Using a panel tool, unclip and remove the trim panel that runs along the dash above the radio.
10. Remove (2) 7mm screws from the top of the radio bezel.
Remove and disconnect the bezel.
11. Remove the four (4) 7mm screws securing the factory display.
Remove and disconnect the display.

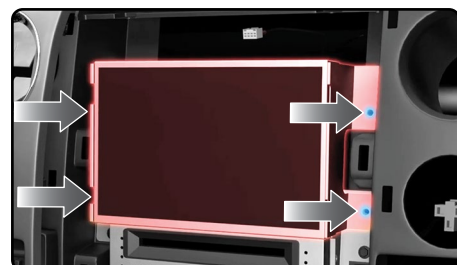
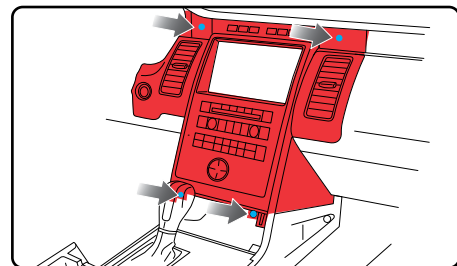
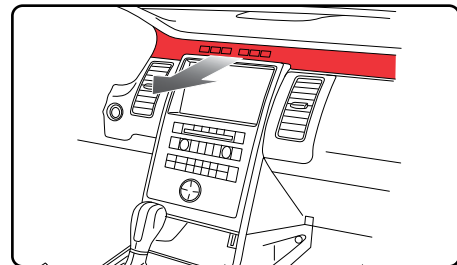
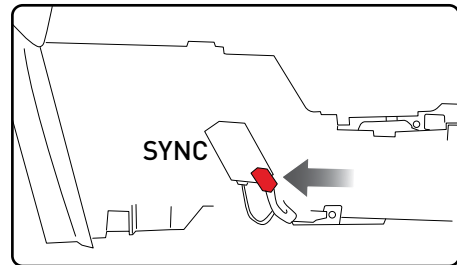
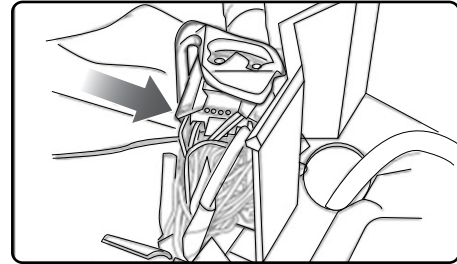
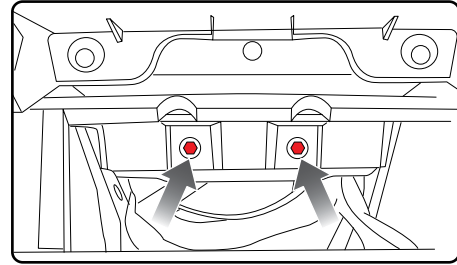

DASH DISASSEMBLY P3 /3

FLEX

- 12.** Remove the four (4) 7mm screws securing the factory CD player.
Remove and disconnect the CD player.

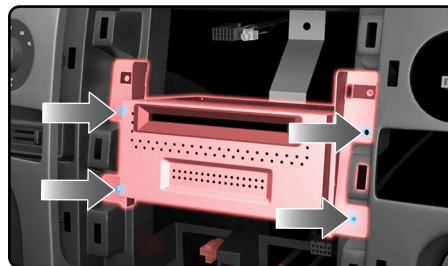

DASH DISASSEMBLY P1/2

1. Remove (2) 7mm screws from the pocket on top of the dash. Remove the panel.

Note: In some trims, there is a safety strap fixed behind the panel (a) that prevents the removal of the top plate/pocket/vents. It's not necessary to remove this unless you want to take the pocket/vents out for ease of install.

2. [OPTIONAL] To completely remove the vents: looking from the floorboard up into the dash (driver side) locate and remove (1) 10mm bolt securing top pocket with a strap.

Otherwise, use a panel tool to loosen the vents enough to gain access to the top of the radio bezel.

3. Remove (2) 7mm screws securing the top of the radio bezel.

4. Using a panel tool, pry upward to release and remove the plastic trim around the shifter.

5. Unclip and remove the top of the center console, starting from the back.

6. Using a panel tool, pry outward to release the radio bezel from the dash, then unplug and remove it.

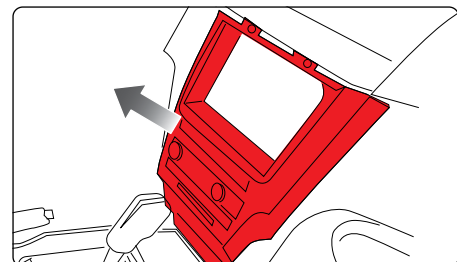
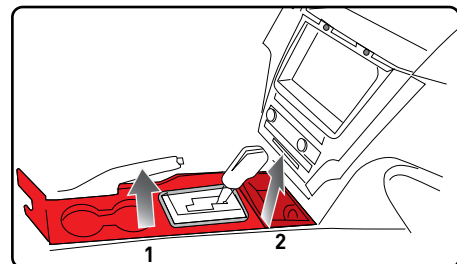
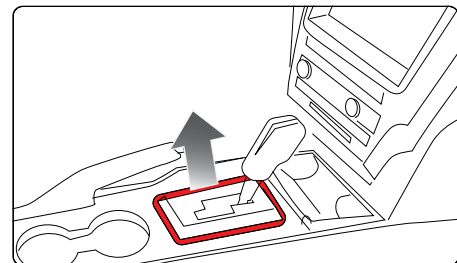
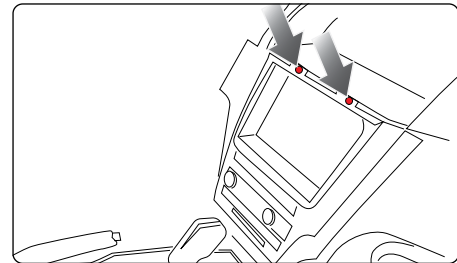
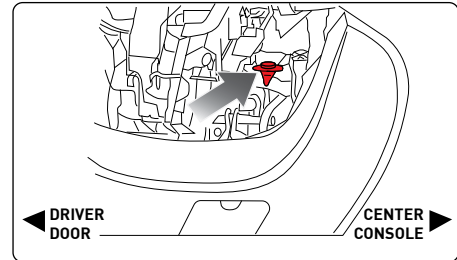
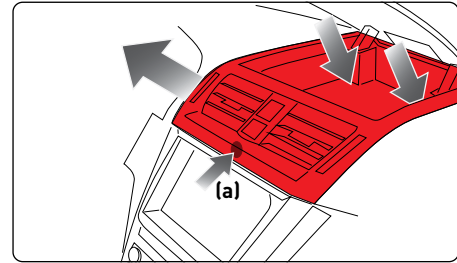

DASH DISASSEMBLY P2 /2

7. Remove the four (4) 7mm screws securing the factory display.
Remove and disconnect the display.
8. Remove the four (4) 7mm screws securing the factory CD player.
Remove and disconnect the CD player.
9. Using a plastic panel tool, pry out on lower rear console trim at floor. Once bottom is free, lower the panel toward the floor to clear the top tabs.
Unplug the 54-pin SYNC connector (facing passenger seat).

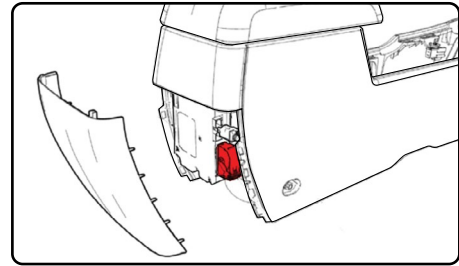
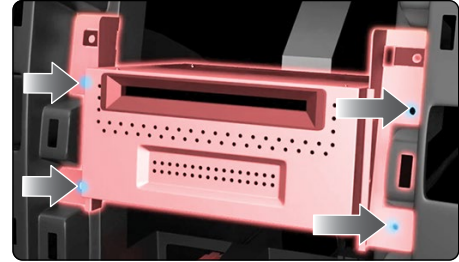

DASH DISASSEMBLY P1 /2

MUSTANG

1. Using a panel tool, unclip and remove the trim around the shifter.



2. Place the shifter into the furthest back position and engage parking brake.

Using a panel tool, gently release the clips holding the center console panel in place. Remove and disconnect.

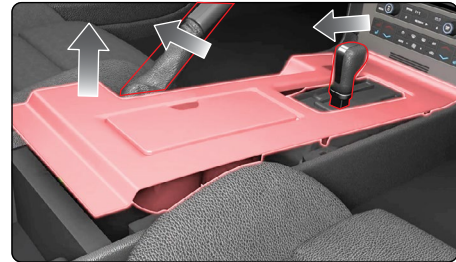

3. Remove (2) 7mm screws securing the radio trim bezel.



4. Using a panel tool, release the clips securing the radio bezel. Disconnect and remove the bezel.



5. Remove the four (4) 7mm screws securing the factory display.

Remove and disconnect the display.

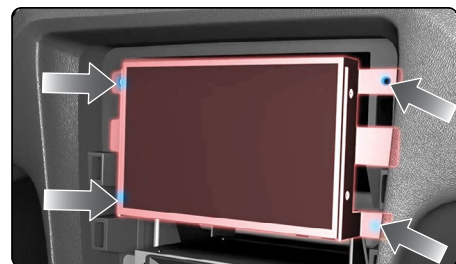

6. Remove the four (4) 7mm screws securing the factory CD player.

Remove and disconnect the CD player.

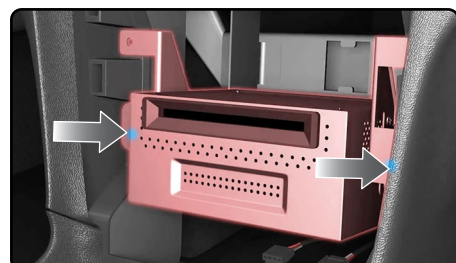

DASH DISASSEMBLY P2 /2

MUSTANG

7. Remove the four (4) screws under the glove box.

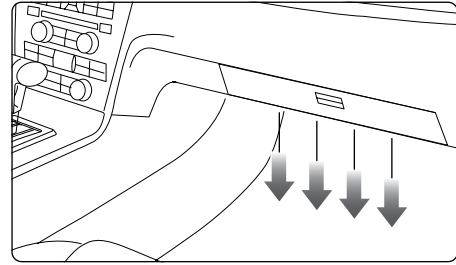

8. Open, unclip and remove the glove box.

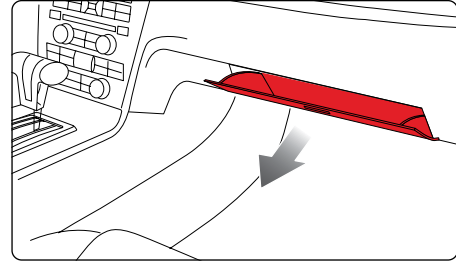

9. Locate the SYNC module behind the glove box..
Unplug the 54-pin SYNC connector.

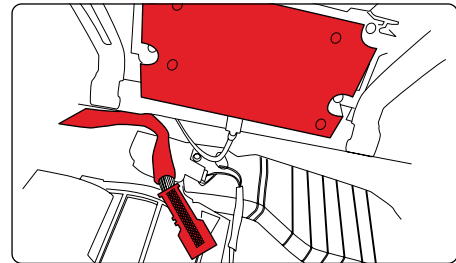

DASH DISASSEMBLY P1 /3

1. Using a panel tool, unclip and remove the dash trim.



2. Remove the four (4) screws and pull the panel to remove.

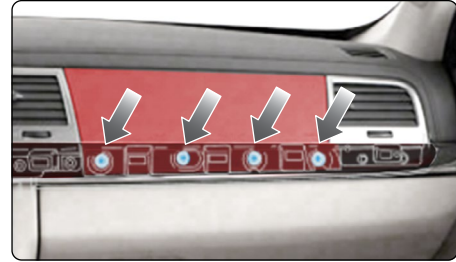

3. Using a plastic panel removal tool, pry up the left and right side top console edge trim.

Start at the rear and work toward the radio controls.

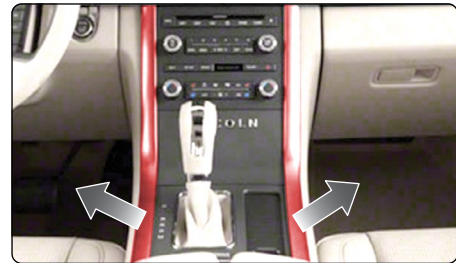

4. Remove the ten screws holding the radio/HVAC assemblies in place.

Remove the radio/HVAC (and cover plate at bottom), and set aside.

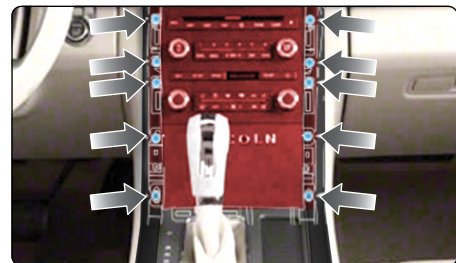

5. Remove the two (2) HVAC module screws, then remove and disconnect the module.

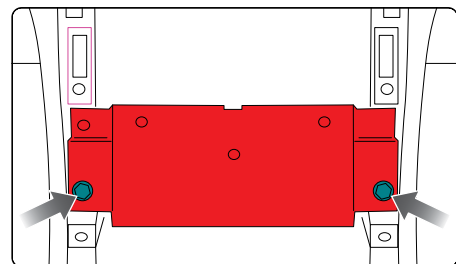

6. Remove the five (5) screws securing the radio screen trim panel..
Using a panel tool, unclip and remove the trim panel.

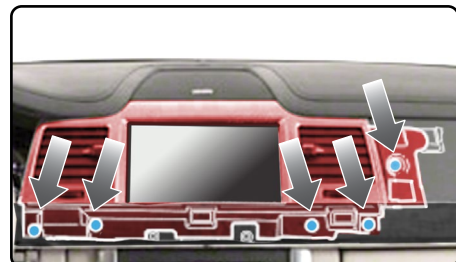

DASH DISASSEMBLY P2 /3

- 7.** Remove the four (4) screws holding the radio screen
Unplug and remove the screen.

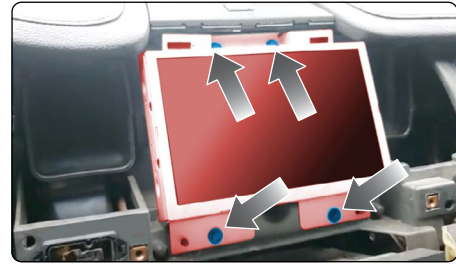

Center console disassembly

- 8.** Apply the parking brake. Place the selector lever in the NEUTRAL position. Position the front seats to the full rearward and downward positions.



- 9.** Pull the middle and rear of the side floor console lower trim panels (left and right) outward to release the retaining clips.

Position a piece of cardboard between the trim panels and the floor console.

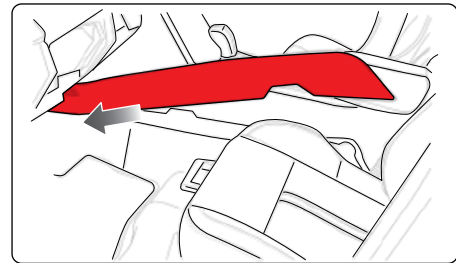

- 10.** Position the front seats forward. Remove the two (2) rear floor console bolts.

Position the front seats rearward. Remove the two (2) pushpin retainers and the four (4) floor console bolts.



- 11.** Remove the shifter lever bezel.

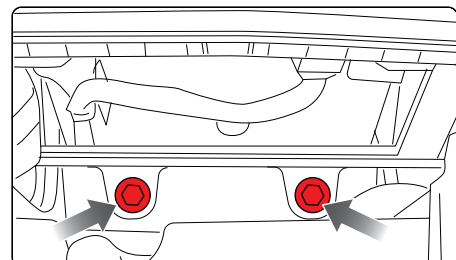

- 12.** Remove the two (2) floor console to instrument panel bolts.

DASH DISASSEMBLY P3/3

MKS

13. Lift rear of center console.

Unplug 54-pin SYNC connector from module.

If unable to access harness, further disassembly is required:

Remove the floor console rear panel by pulling straight back to disengage the clips. Disconnect the electrical connectors

Remove the left and right floor console upper trim panels. Using a suitable tool such as a trim removal tool, disengage the clips.

Remove the four (4) screws securing the APIM bracket. Remove the bracket and APIM as an assembly.

Unplug 54-pin SYNC connector from module.

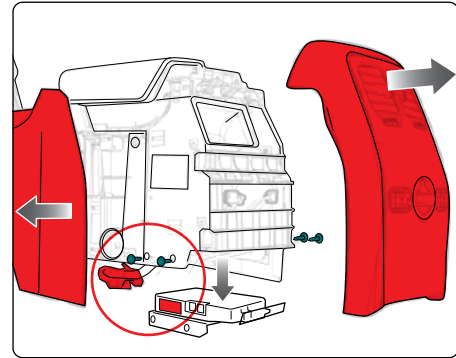

DASH DISASSEMBLY P1 /3

Center console disassembly

(steps 1-3 : vehicles with long console that extends to rear seat area)

1. Using a plastic panel tool, pry the rear panel off the far rear console. Pry toward the rear on the top of it, then lift up to release the lower retaining tabs.

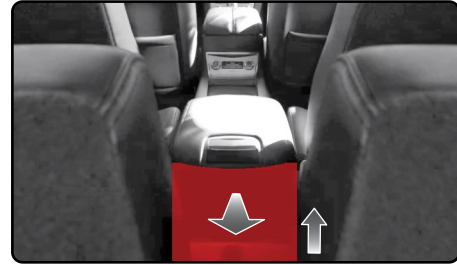

2. Remove the rear upper finish panel by lifting upward to release the clips. Pull toward rear of the vehicle and disconnect the electrical connector.

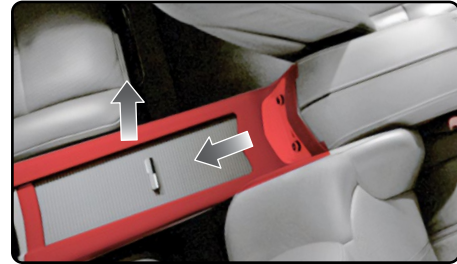

3. Using a plastic panel tool, detach the left and right side trim panels by pulling away from the console and disconnecting/releasing the electrical connectors.

Remove the four (4) rear to front section screws. Remove the four (4) floor console bolts.

Remove the rear floor console section.

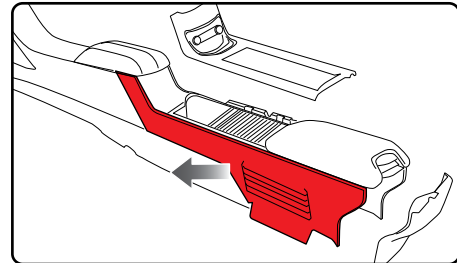

4. Remove the rear control panel/back of console. Pry outward with a plastic panel tool to remove, then disconnect the electrical connectors (short center console only).



5. Lift the cup holder panel and disconnect the electrical connector.

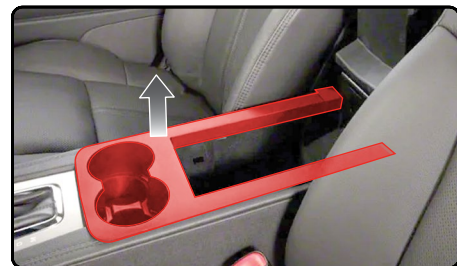

6. Remove the left and right side molding by prying upward with a plastic panel tool.

Release the front clips by prying toward rear of vehicle. Lower the molding from the upper panel and remove.

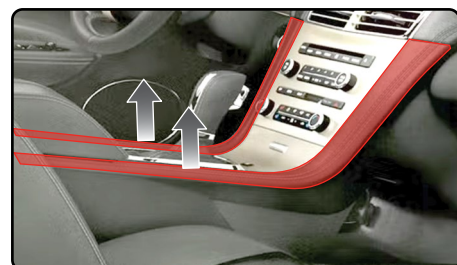

DASH DISASSEMBLY P2 /3

7. Remove the shift selector lever knob by using a plastic panel tool to lower the trim.

Loosen the two (2) screws in the shifter knob.

Lift to remove.



8. Remove the two (2) screws from the shifter trim panel, pry the rear portion up and pull toward the rear to release clips from the radio bezel.

Disconnect the electrical connector(s).



9. Position the front seats all the way to the front, then remove the two (2) rear floor console bolts.

Position the front seats to the rear, then remove the two (2) front and two (2) center floor console bolts.

10. Unclip and remove the left and right side trim panels.



11. Lift the center console enough to access SYNC module and disconnect the 54-pin flip latch connector facing the passenger side.

OPTIONAL (entirely remove the console): to clear the shifter, shift vehicle into NEUTRAL and chock the vehicle wheels in place to prevent rolling. Disconnect any electrical connectors. Remove.

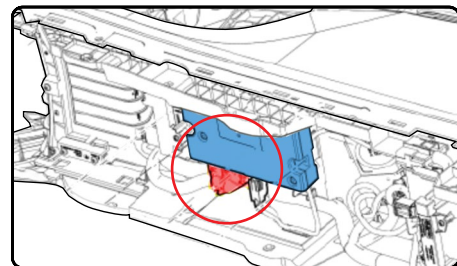

RADIO REMOVAL

12. Remove the four (4) screws securing the radio/HVAC controls in place.

Remove and disconnect the electrical connectors.



DASH DISASSEMBLY P3 /3

- 13.** Using a plastic panel removal tool, remove the top speaker cover.

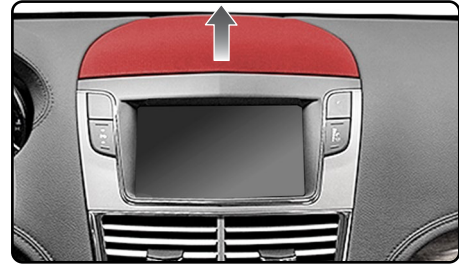

- 14.** Remove the four (4) screws holding the radio screen trim panel in and pull to release the clips.

Remove the four (4) screws holding the screen in, disconnect the electrical connectors, and remove the screen.



DASH DISASSEMBLY P1 /2

1. Lower the glove box door, remove the damper (pull outward) and then squeeze the glove box sides inward to lower the glove box out of the dash.

Remove and set aside.



2. Remove the four (4) screws holding the trim in place from behind. Use a plastic panel removal tool to remove the trim once all screws are removed.

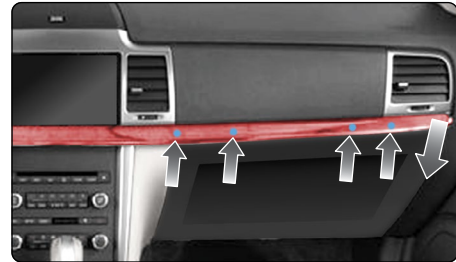

3. Using a panel tool, pry upward to release the left and right trim panels along the radio controls/HVAC area. Start at the bottom/back and work up to the radio area.



4. Remove the four (4) screws holding the radio/HVAC assembly into the dash, then remove and unplug.



5. Remove the three (3) screws holding the screen bezel in place and use a plastic panel tool to remove the trim



6. Remove the four (4) screws holding the screen in place, then unplug and remove it.



DASH DISASSEMBLY P2/2

MKZ

7. Using a plastic panel tool, pry out on lower rear console trim at floor. Once bottom is free, lower the panel toward the floor to clear the top tabs.

Unplug the 54-pin SYNC connector (facing passenger seat).

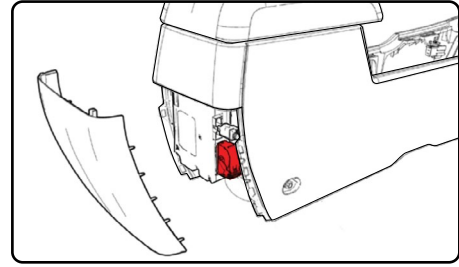

DASH DISASSEMBLY P1/2

1. Remove (2) 7mm screws from the pocket on top of the dash. Remove the panel.

Note: In some trims, there is a safety strap fixed behind the panel (a) that prevents the removal of the top plate/pocket/vents. It's not necessary to remove this unless you want to take the pocket/vents out for ease of install.

2. [OPTIONAL] To completely remove the vents: looking from the floorboard up into the dash (driver side) locate and remove (1) 10mm bolt securing top pocket with a strap.

Otherwise, use a panel tool to loosen the vents enough to gain access to the top of the radio bezel.

3. Remove (2) 7mm screws securing the top of the radio bezel.

4. Using a panel tool, pry upward to release and remove the plastic trim around the shifter.

5. Unclip and remove the top of the center console, starting from the back.

6. Using a panel tool, pry outward to release the radio bezel from the dash, then unplug and remove it.

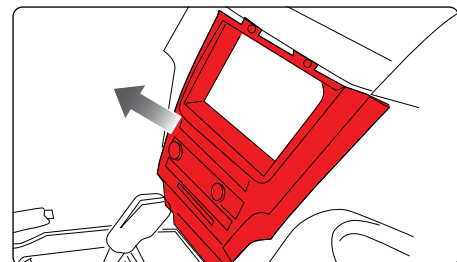
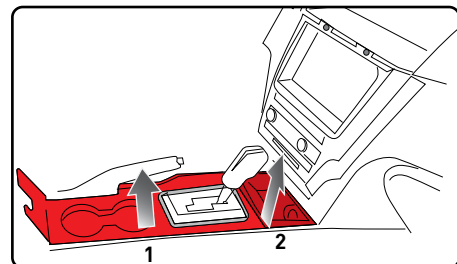
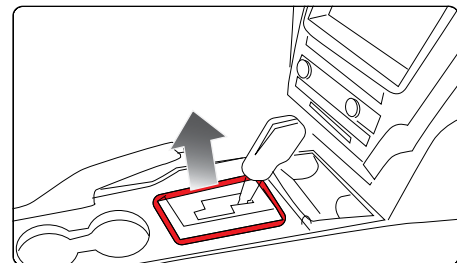
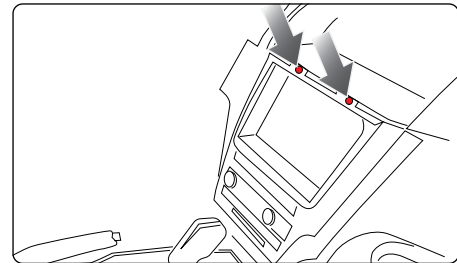
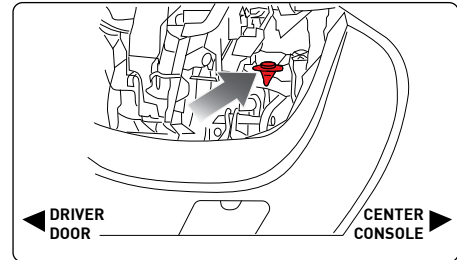
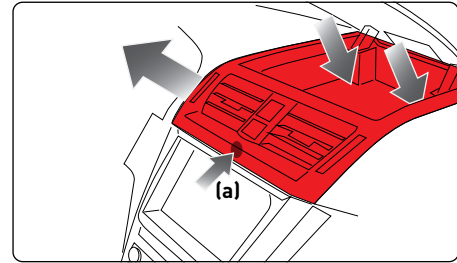

DASH DISASSEMBLY P2 /2

- 7.** Remove the four (4) 7mm screws securing the factory display.
Remove and disconnect the display.



- 8.** Remove the four (4) 7mm screws securing the factory CD player.
Remove and disconnect the CD player.

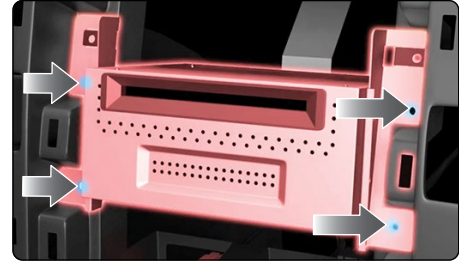

- 9.** Using a plastic panel tool, pry out on lower rear console trim at floor. Once bottom is free, lower the panel toward the floor to clear the top tabs.

Unplug the 54-pin SYNC connector (facing passenger seat).

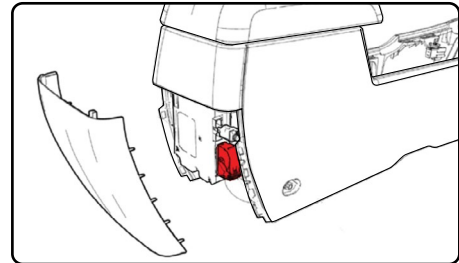

ASSEMBLY (RADIO SCREEN) P1/1

THESE STEPS CAN ONLY BE DONE AFTER DASH DISASSEMBLY.

1. Remove the screws securing the brackets to the factory screen. Remove the brackets (may differ from image shown).

If using 8" screen:

2. Attach L bracket (S8 F02-11) and R bracket (S8-F02-12) to the back of the radio screen using 6 screws from bag labeled (SM5-6P x 10).

3. Attach factory screen brackets to L/R brackets using split lock washers (WM5-SPLIT x4) and nuts (NM5 x 4).

If using a compatible floating screen:

2. Assemble the screen bracket (APX-S8-F01-91) to the two side brackets using 6 screws from bag labeled (SM5-6P x 10).

3. Attach factory screen brackets to L/R brackets using split lock washers (WM5-SPLIT x4) and nuts (NM5 x 4).

4. Mount the radio screen bracket (provided with radio) to the APX-S8-F01-91 bracket using four screws (SM5-6P x 10).

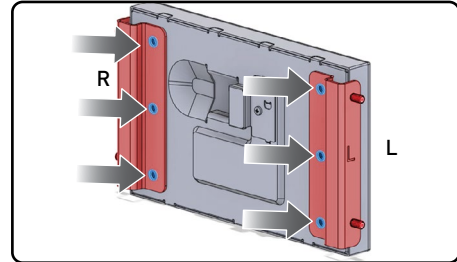
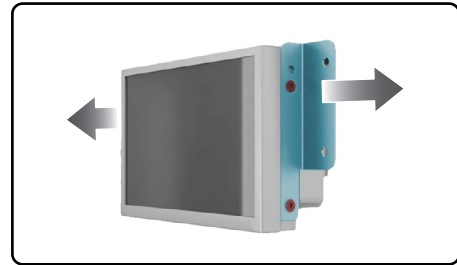

8"

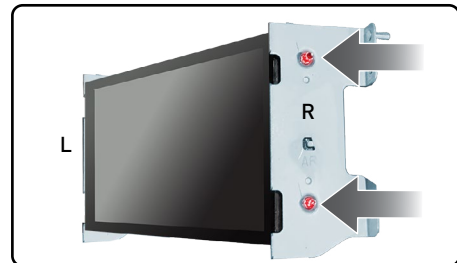

8"

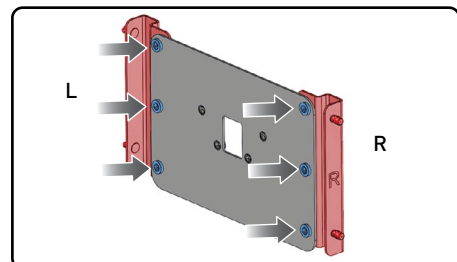

10"
FL

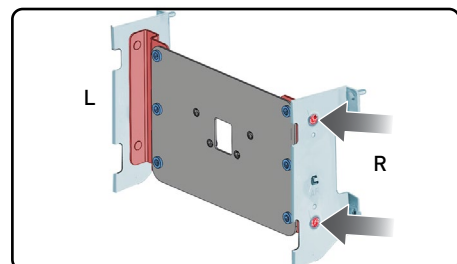

10"
FL

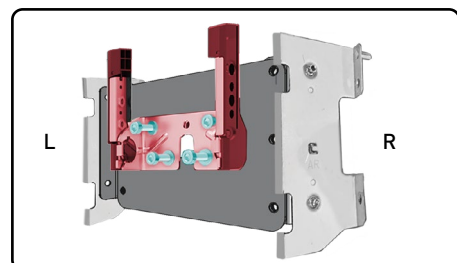

10"
FL

ASSEMBLY (RADIO CHASSIS) P1 /1

THESE STEPS CAN ONLY BE DONE AFTER DASH DISASSEMBLY.

1. Remove the Phillips screws securing the CD player/radio module brackets (may differ from image shown).

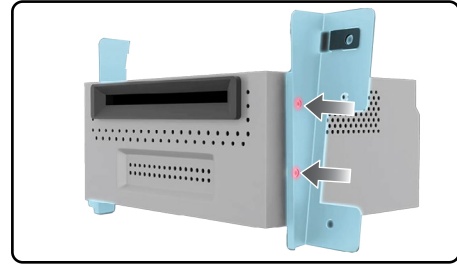

2. FORD FLEX ONLY:

It's required to drill one screw hole in each of the factory brackets before assembling on the radio chassis. Mark and drill the factory brackets using the front of the slotted section of the S8F02-11 & S8F02-12 brackets as a template.

A #2 or 7/32" drill bit will work for the M5 screws used.

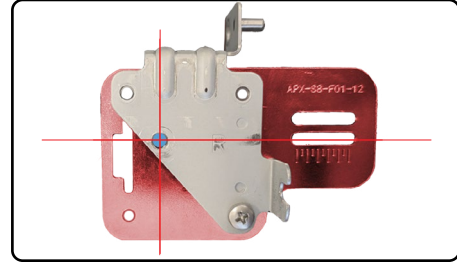

3. Place factory radio chassis brackets on top of left (S8F02-11) and right (S8F02-12) brackets.

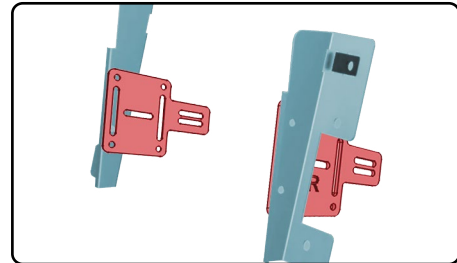

4. Secure to radio chassis using the four included screws (SM5-8P x 4).

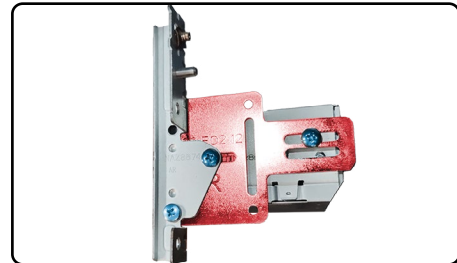

5. Some factory bracket models require the use of a bolt washer and nut (on each side) to secure the assembly (SM5-8P, WM5-SPLIT and NM5, included).

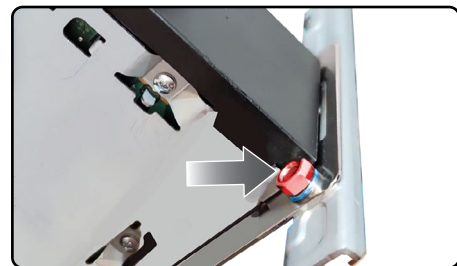

INSTALL AND CONNECT P1 /2

INSTALL TYPE-01

1. Connect 24-pin, 16-pin and 8-pin (if present in vehicle) gray connectors of A-S8-F02 T-harness to the radio factory harness in vehicle.

Connect B-S8-F02 12-pin gray connector to factory camera harness.

2. Connect the Maestro module to the S8-F02 T-harness. Connect the 4-Pin black data cable provided with the Maestro module to the BLACK 4-pin port on the Maestro module. Connect the 3-pin audio cable (the data and 3.5mm audio cables are provided with the Maestro module).

If the vehicle is equipped with factory amplifier

3. Disconnect the black 8-pin connectors on A-S8-F02 harness. Then, connect to 8-pin black RCA (D-S8-F02) harness. Connect RCA's to aftermarket radio.

4. Connect 54-pin C-S8-F02 to SYNC harness in vehicle (refer to disassembly section for SYNC module location).

5. You will need to install the Bluetooth microphone and GPS antenna to their recommended locations by the radio manufacturer OR use the optional MIC1 and NAV4 to retain the factory Microphone and GPS antenna (if equipped).

6. Press the S8-F02 T-harness and Maestro module into the lower dash cavity. Then, connect the supplied antenna adapter to the factory antenna connection.

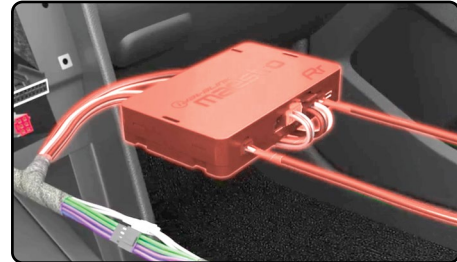
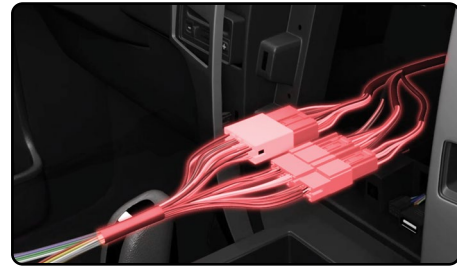

INSTALL AND CONNECT P2 /2

INSTALL TYPE-01

7. Route the USB-C cable from USB hub to radio. Connect.



8. Make all connections to the back of the aftermarket radio (use head unit adapter OR cut connector from the S8-F02 harness and connect the wires as shown in the wiring diagram). Make sure to connect the 4-pin data cable to the iDatalink I/F port and 3.5mm audio cable to the iDatalink I/F port.

Secure USB with metal clip.



9. Press the radio chassis into the dash cavity and secure it with the screws removed earlier.

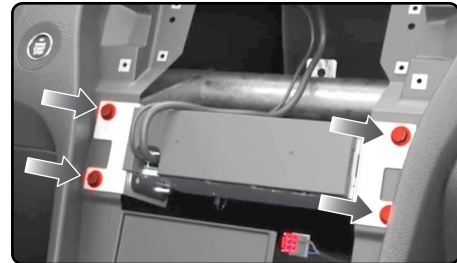

If installing 10" floating screen, refer to next page.

10. Connect the display cables to the back of the screen. Then, attach the black ground wire from the S8-F02 harness to the back of the screen using the single Phillips screw.

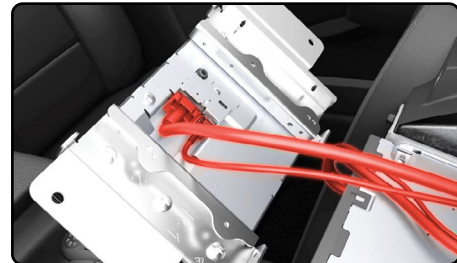

8"

11. Place the screen into the dash and secure it with the screws removed earlier.

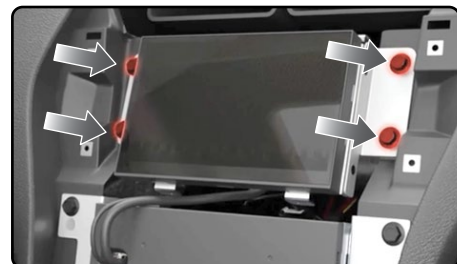

8"

12. Reinstall (clip / fix) the radio bezel into place as it was originally.

Put everything that was disassembled back into place, using reverse order of the removal steps.

FLOATING SCREEN INSTALLATION EXAMPLE P1/1

1. Install bracket assembly in dash et secure it with the screws removed earlier.

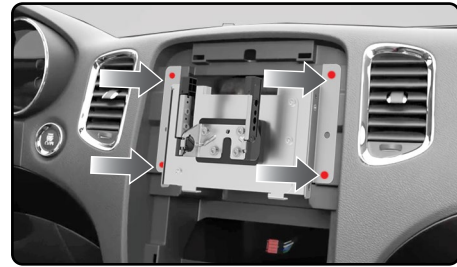
10"
FL

2. Reinstall the radio bezel (reconnect if applicable).

10"
FL

3. Connect the display cables to the back of the screen. Then, attach the black ground wire from the S8-F02 harness to the back of the screen using the single Phillips screw.

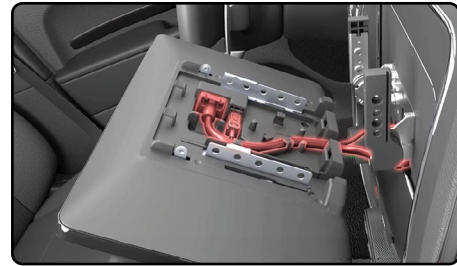
10"
FL

4. Secure the screen to the bracket with the hardware supplied with the radio.

10"
FL

5. Slide the back cover in to place and secure it with the two (2) Phillips screws provided with the radio.

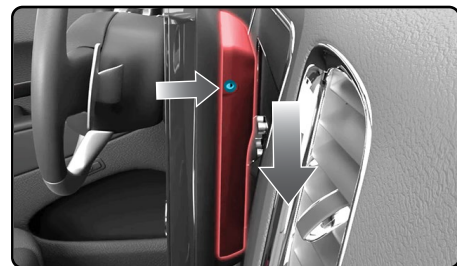
10"
FL

WIRING DIAGRAM

INSTALL TYPE-01

SOME CABLES INCLUDED WITH MAESTRO MODULE ARE NOT USED

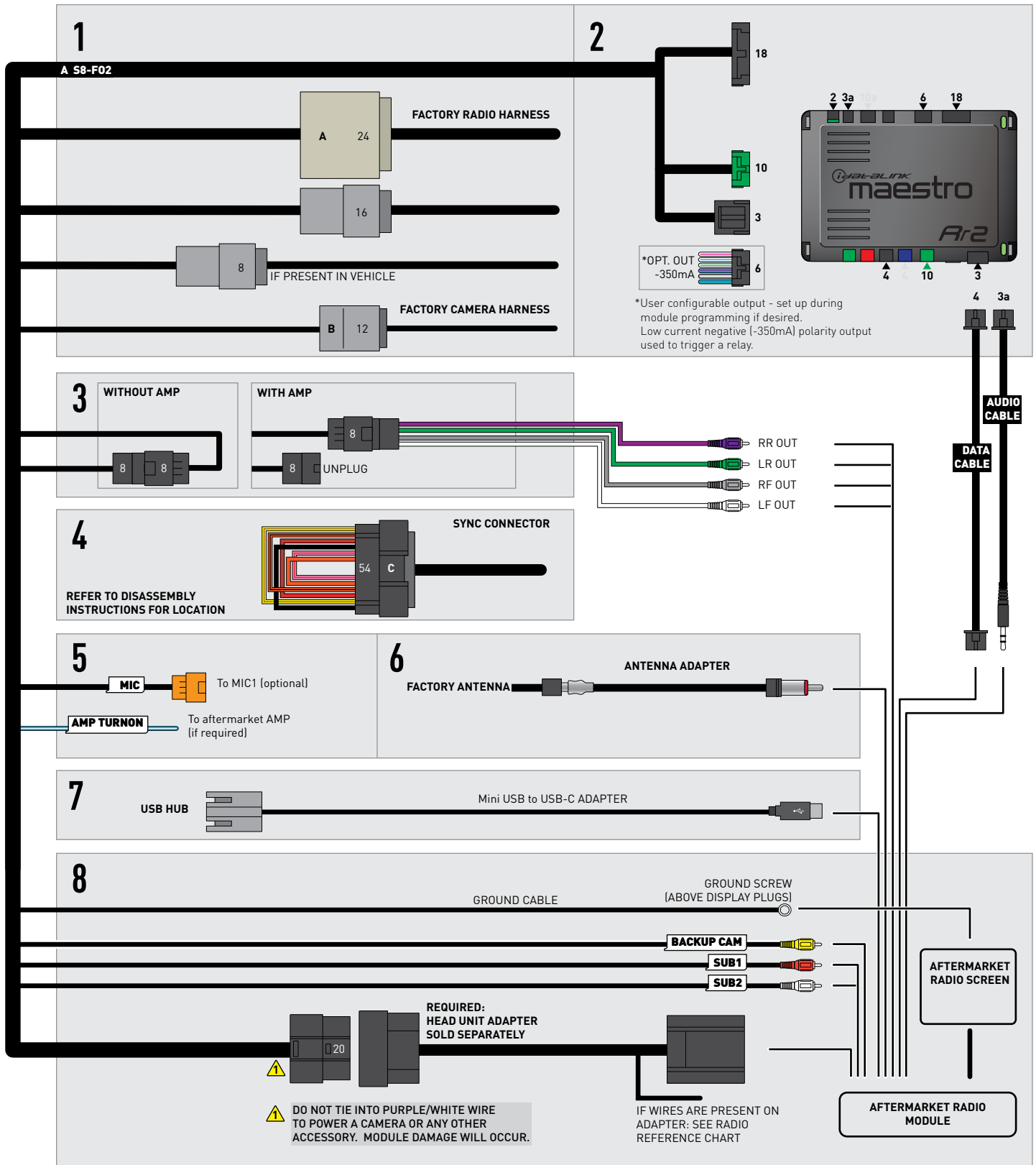

RADIO WIRE REFERENCE CHART

| S8-F02 T-harness Wire Description | Polarity | Wire Color on Maestro T-Harness | Wire Color on Kenwood cable |
|--------------------------------------|----------|------------------------------------|--------------------------------|
| Illumination | (+) | Orange | Orange/White |
| Reverse Light* | (+) | Purple/White | Purple/White |
| E-Brake | (-) | Lt Green | Lt Green |
| VSS (vehicle speed sensor) | (DATA) | Pink | Pink |
| Power Antenna | (+) | Blue | Blue |

***Note:** REVERSE LIGHT purple/white wire is a low current positive output used to trigger the radio only. Do NOT connect to anything other than the radio's reverse input.

If no camera is installed/desired, do not connect the radio's reverse wire. If installing an aftermarket camera, do NOT connect power for the camera to the Maestro's purple/white wire or module damage will occur.

Head unit adapter wiring (required accessory, sold separately)

| ACC-HU-KEN1 Wire Description | Polarity | Wire Color on Adapter | Kenwood Radio |
|---------------------------------|----------|-----------------------|------------------------------|
| CAM | (+) | Green/Red | Refer to camera/radio manual |
| CAM | (-) | Green/White | Refer to camera/radio manual |
| Steering Wheel Controls | (DATA) | Blue/Yellow | n/a |

MODULE DIAGNOSTICS

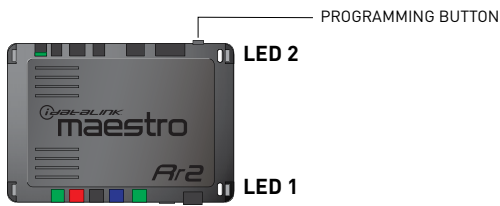

| LED 1 Module/Firmware status | LED 2 Bluetooth activity | LED STATUS | DIAGNOSTIC |
|------------------------------------|-----------------------------|-----------------------|--|
| ● or ● | | RED or GREEN flashing | LED flashes 1 or more times, either red or green, when a steering wheel button is pressed : normal operation. |
| ● | | 1 RED flash | Module has no firmware. Flash module using Weblink Desktop and log in. Do <u>NOT</u> use DEMO MODE. |
| ● | | 2 RED flashes | Problem detected. Consult troubleshooting table. |
| ● | | 1 GREEN flash | After radio boots up : Normal operation. |
| | ● | 3 GREEN flashes | Bluetooth is activated. Turns off after one minute: Normal operation. |
| ● | ● | OFF | Normal operation (inactive). |

TROUBLESHOOTING TABLE

| PROBLEM | SOLUTION |
|--|--|
| Gauges do not work, radio shows OBD2 Error 1 or Error 2. | If anything else is connected to the OBD2 or CAN wires of vehicle (programmer, throttle controller, insurance tracker, etc.) try unplugging it to see if gauges work. If gauges work without it installed, call tech support for options. Reset the RR. |
| The light on the Maestro is blinking RED TWICE and the radio IS turning on. | Ensure the 4-pin data cable is connected between the radio and the RR, and that it is plugged into the black port on the Maestro RR. The red and blue ports on the RR should be empty. Make sure the correct radio model and serial number were entered during the flash. Verify the radio's serial number entered during the flash matches what is listed on the radio screen. This can be found in the settings of the radio, listed as Device Id, Device Number, or Serial Number. |
| The light on the Maestro is blinking RED TWICE but radio is NOT turning on. | If radio is not turning on, ensure the screen cables are fully connected and seated. Test red and yellow wires for DC voltage at radio using a multimeter. Contact support if no voltage on red or yellow. |

MAESTRO RR RESET PROCEDURE:

Turn the key to the OFF position, then disconnect all connectors from the module.

Press and hold the module's programming button and connect all the connectors back to the module. Wait, the module's LED will flash RED rapidly (this may take up to 10 seconds).

Release the programming button. Wait, the LED will turn solid GREEN for 2 seconds to show the reset was successful.

TECHNICAL ASSISTANCE

Phone: 1-866-427-2999

Email: maestro.support@idatalink.com

IMPORTANT: To ensure proper operation, the aftermarket radio needs to have the latest firmware from the manufacturer. Please visit the radio manufacturer's website and look for any updates pertaining to your radio.