

JBL® STADIUM SPEAKER



Car Audio Speaker

Haut-parleur audio automobile

Altavoz de audio para automóvil

Alto-falante automotivo

Fahrzeuglautsprecher

Diffusore Car Audio

Autoluidspreker

Bilstereohøytaler

Autokaiutin

Автомобильный динамик

Bilhögtalare

Bilhøjtaler

カーオーディオ・スピーカー

Głośnik samochodowy

카오디오 스피커

车载扬声器

汽車音響喇叭

Speaker Audio Mobil

Araba Ses Hoparlörü



Installation manual

Manuel d'installation

Manual de instalación

Manual de instalação

Installationshandbuch

Manuale d'installazione

Installatiehandleiding

Installasjonsveiledning

Asennusopas

Руководство по установке

Installationsanvisning

Installationsmanual

設置マニュアル

Instrukcja instalacji

설치 설명서

安裝手冊

安裝手冊

Panduan instalasi

Kurulum kılavuzu

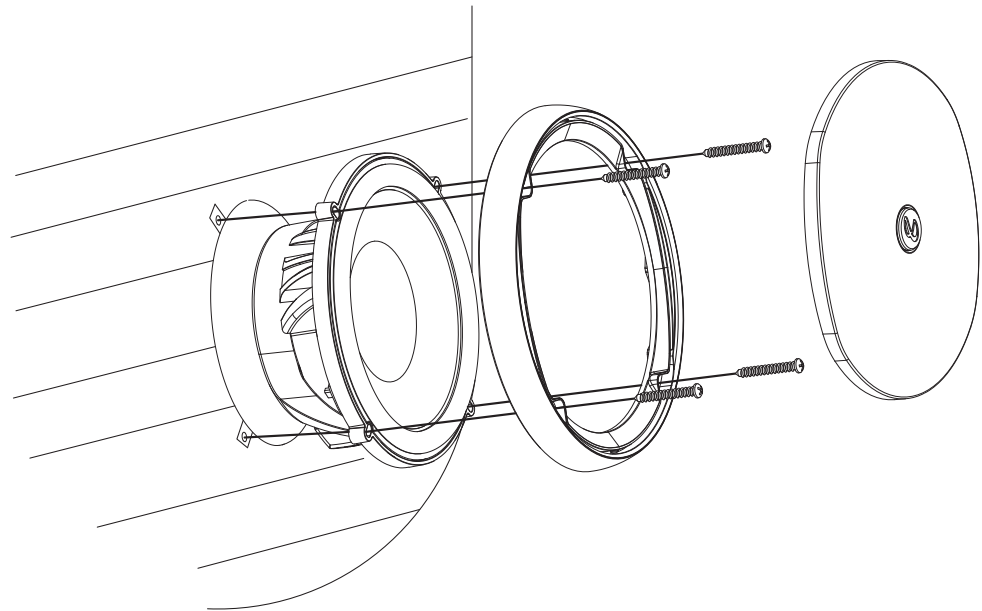
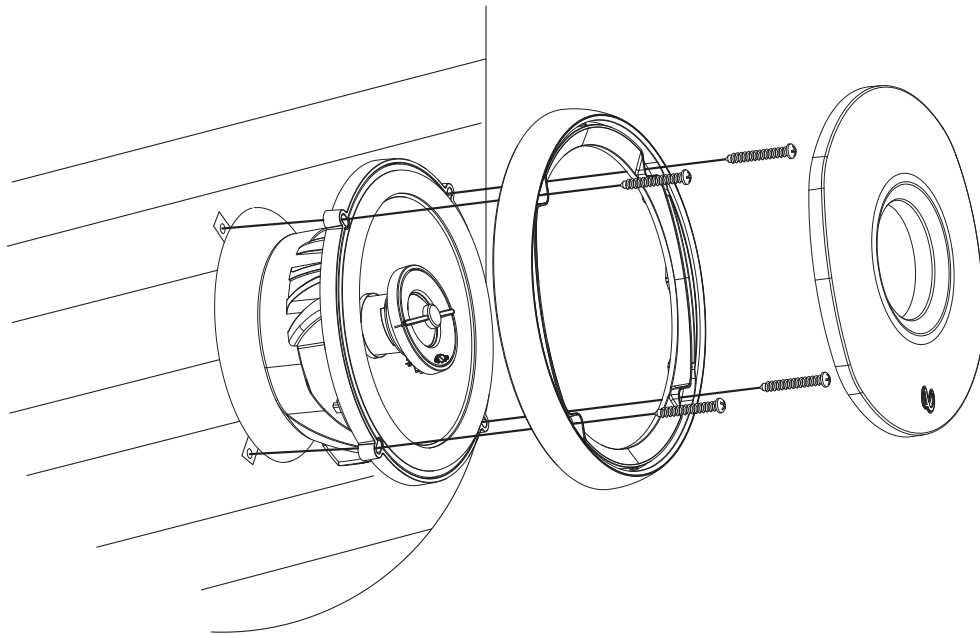
[illegible]

[illegible]

Diagram illustrating the components of the JBL Studio 500 speaker system, including the number of each part required:

- 2X JBL logo (top left)
- 2X JBL logo (middle left)
- 1X Square panel (bottom left)
- 8X Screws (bottom left)
- 8X Gaskets (bottom left)
- 2X Spiral gaskets (top center)
- 2X Oval gaskets (bottom center)
- 2X Large circular speaker components (right)

[illegible]

Stadium GTO620, Stadium GTO600C

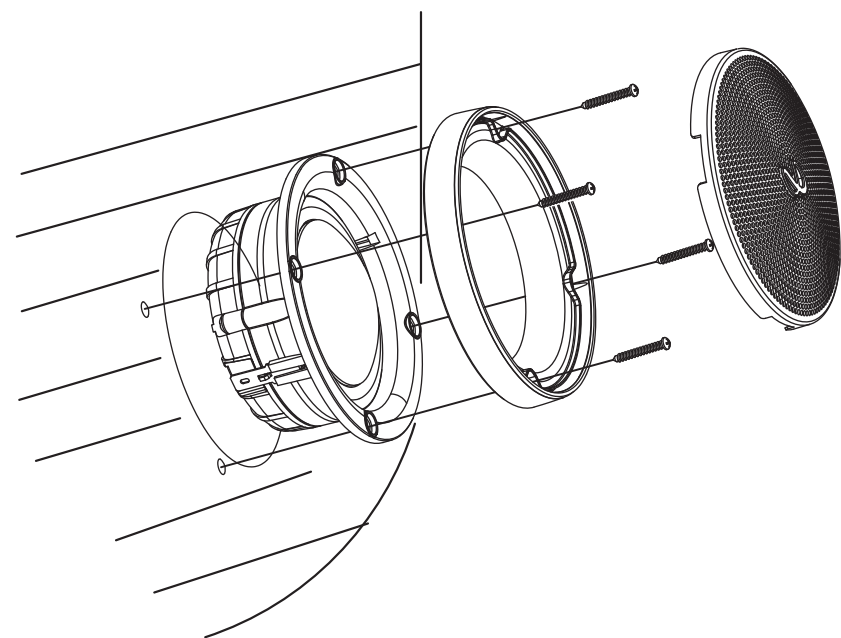
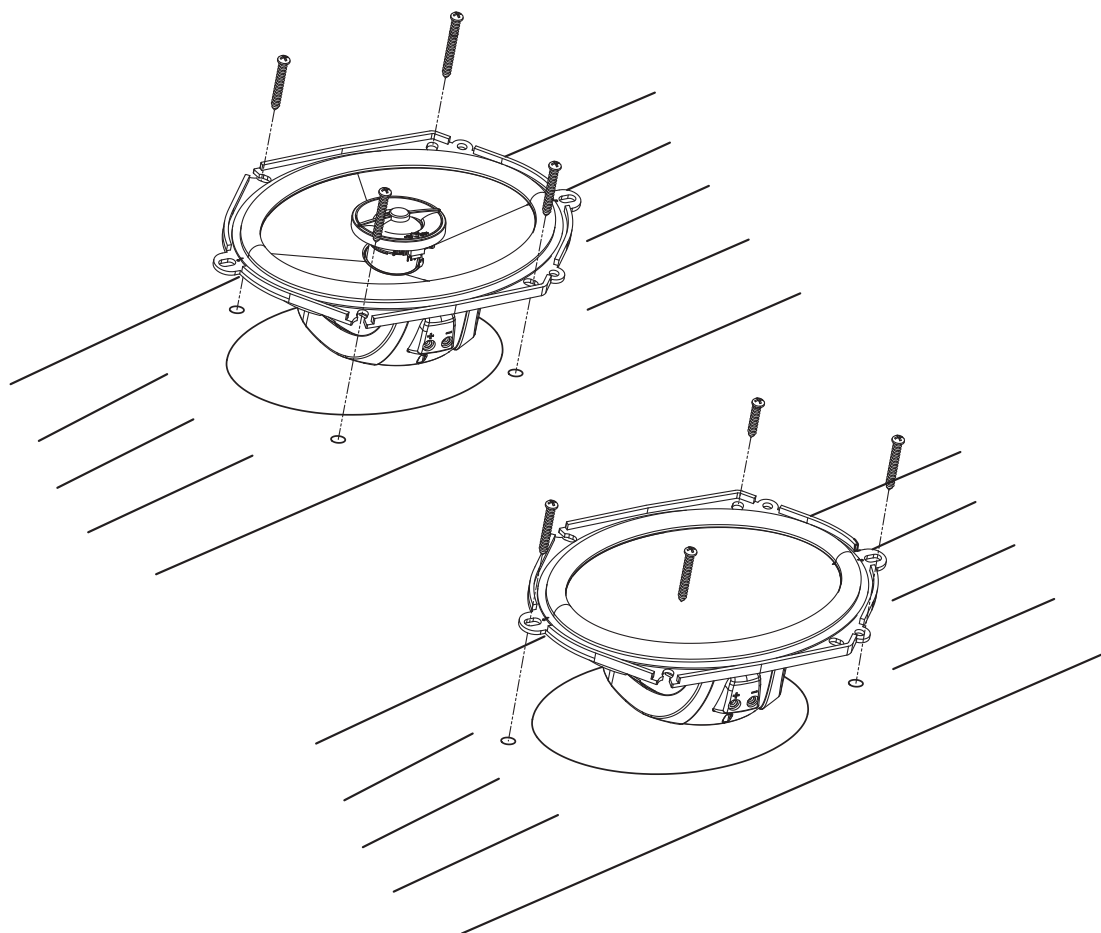
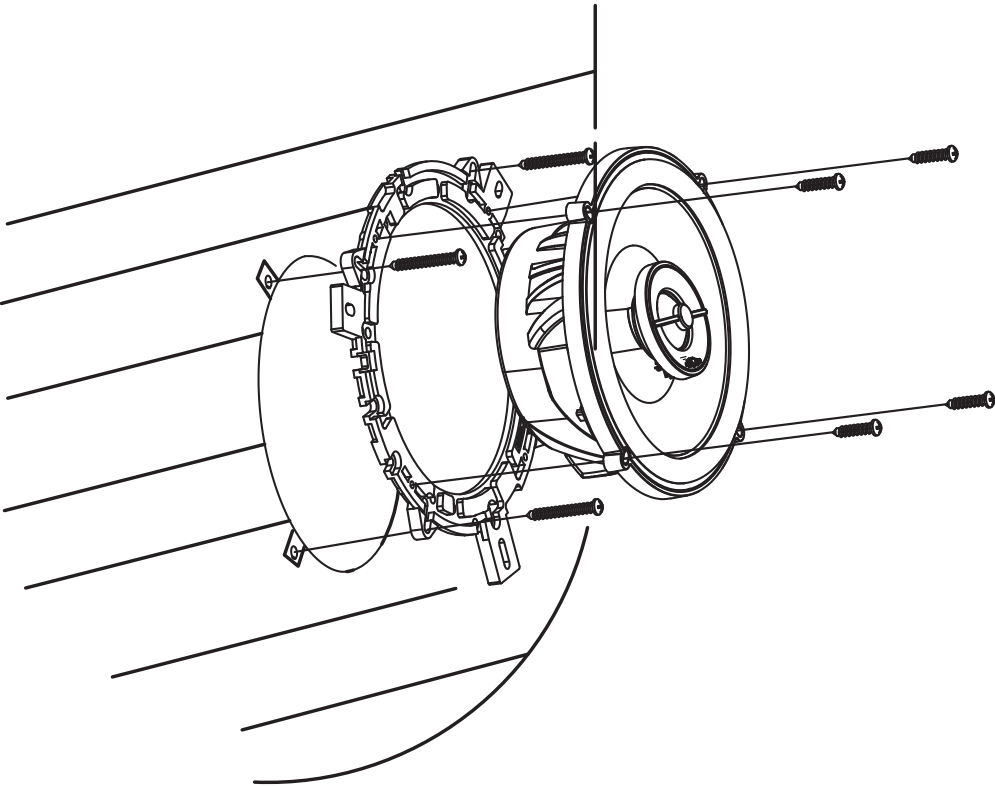

Stadium GTO960C

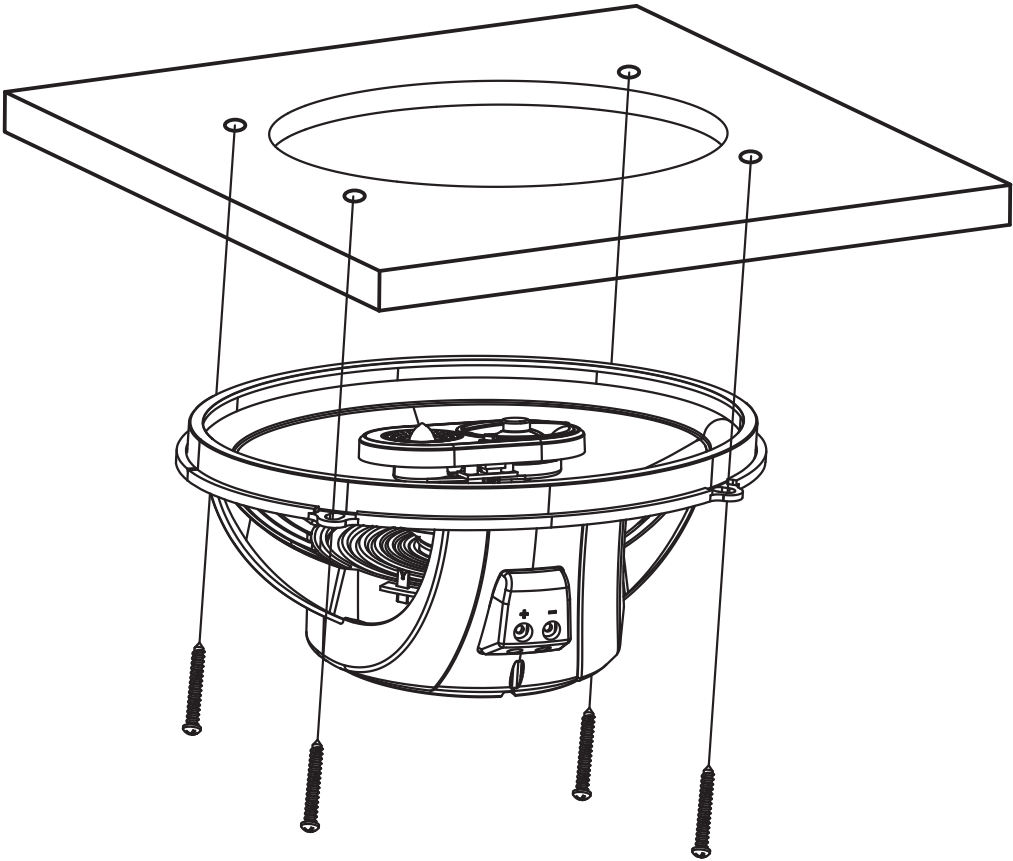

Stadium GTO600C, Stadium GTO860C
Stadium GTO960C, Stadium GTO750T

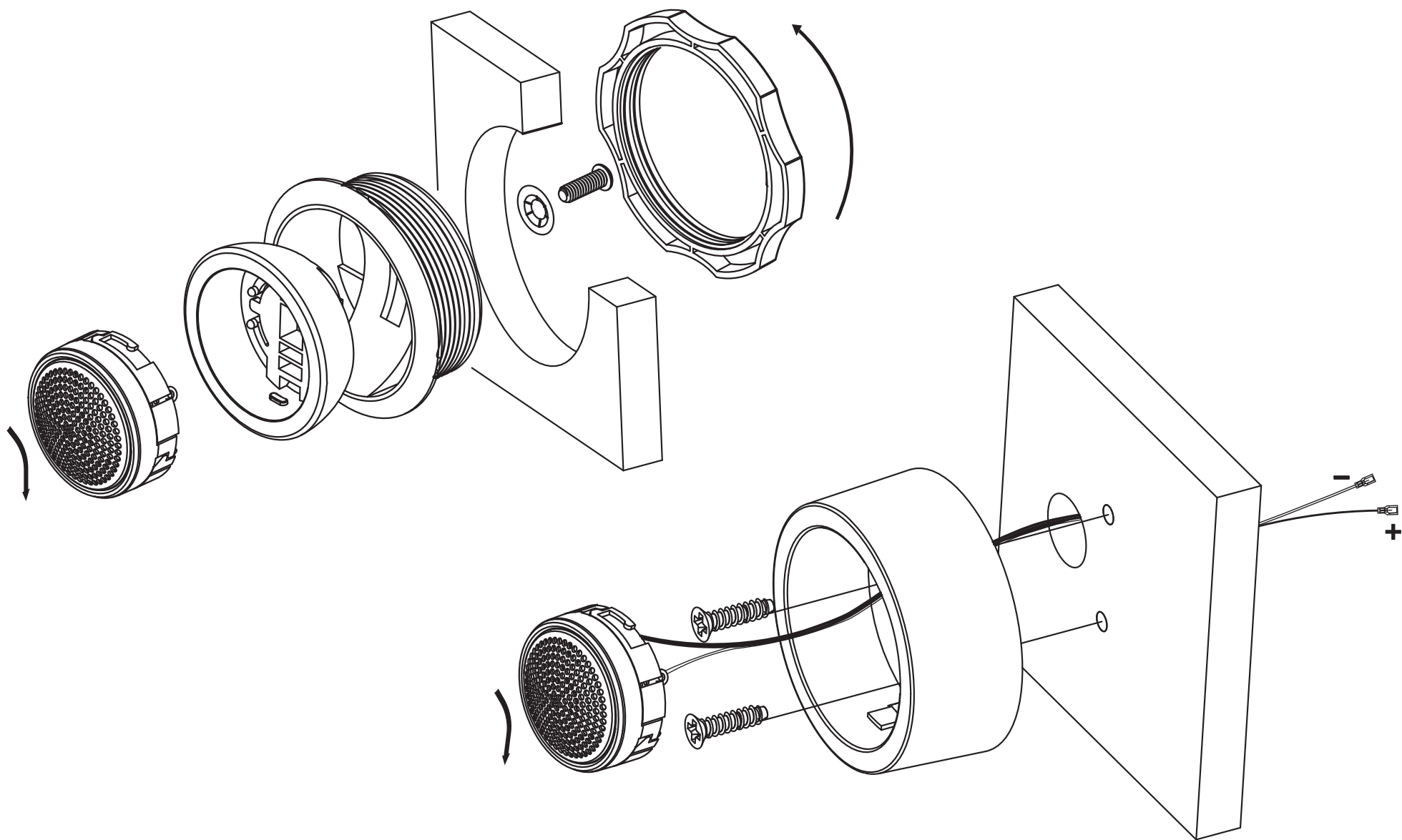

Stadium GTO20M

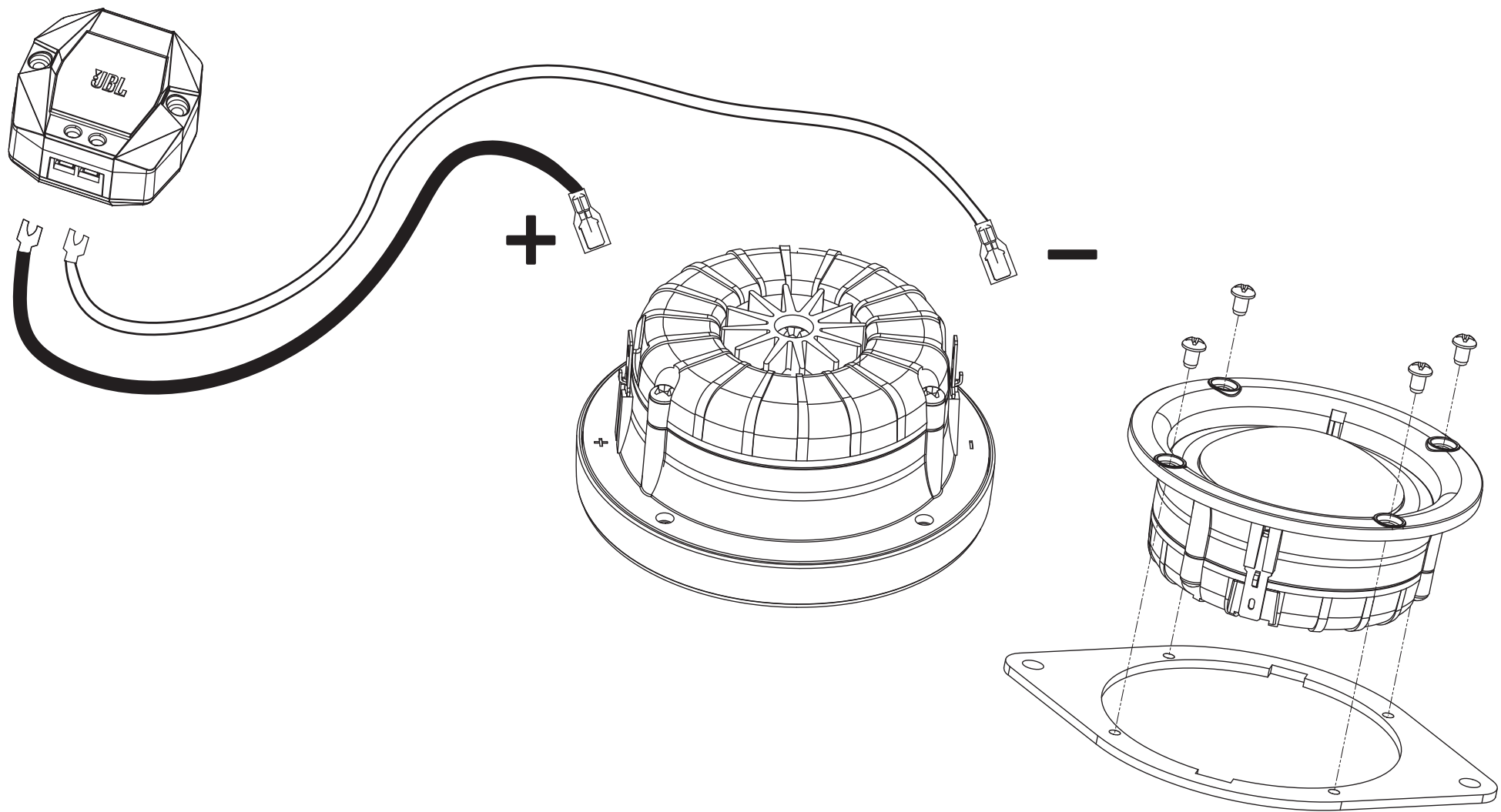

Stadium GTO620, Stadium GTO600C, Stadium GTO20M
Stadium GTO860, Stadium GTO960C, Stadium GTO860C

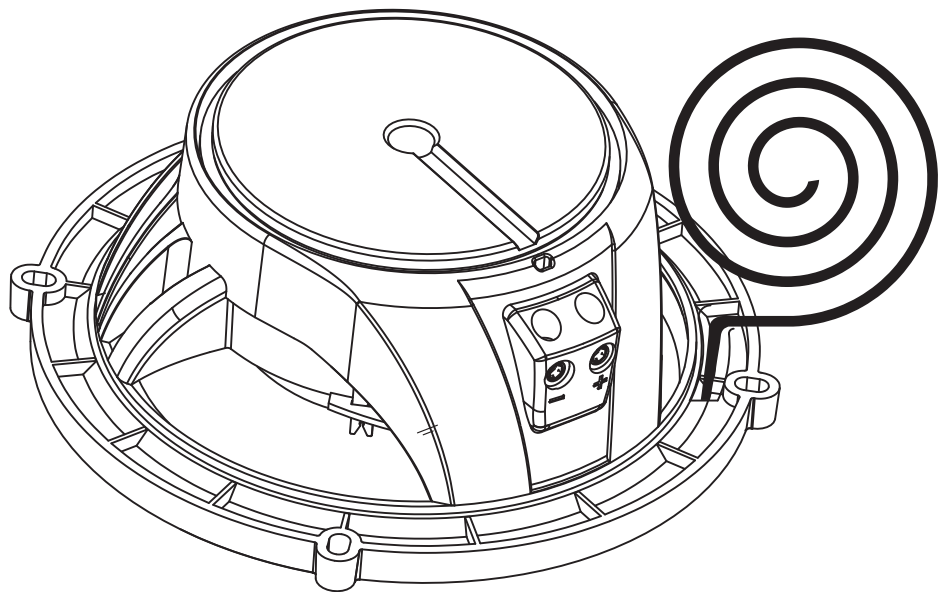

Stadium GTO620, Stadium GTO600C,
Stadium GTO860, Stadium GTO960C, Stadium GTO860C

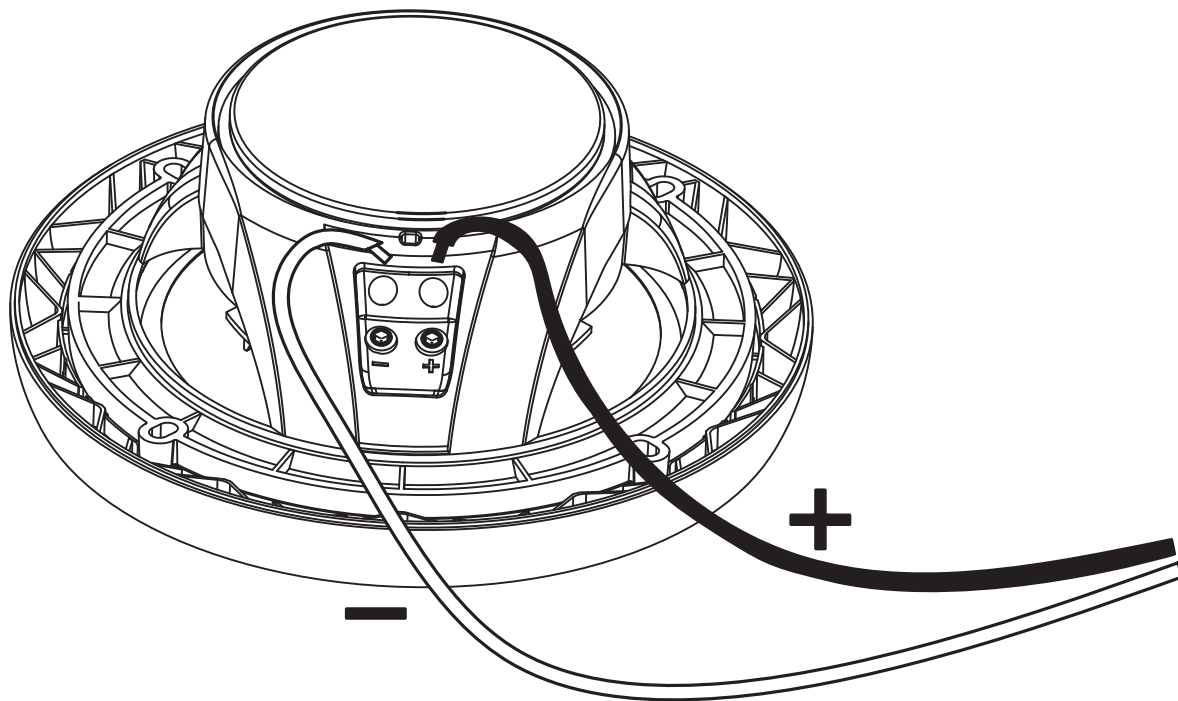

Stadium GTO600C, Stadium GTO960C, Stadium GTO860C

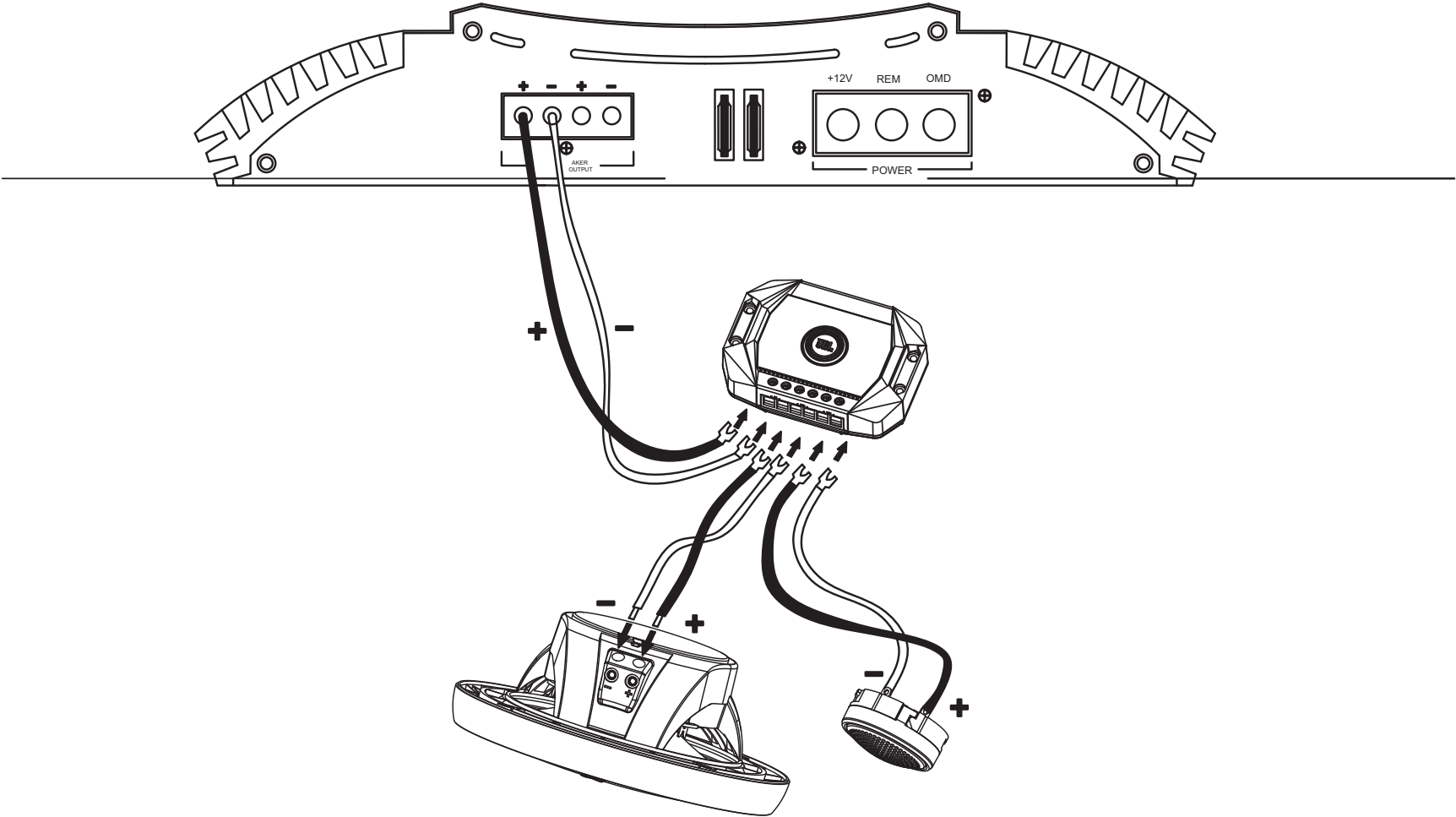

Stadium GTO750T

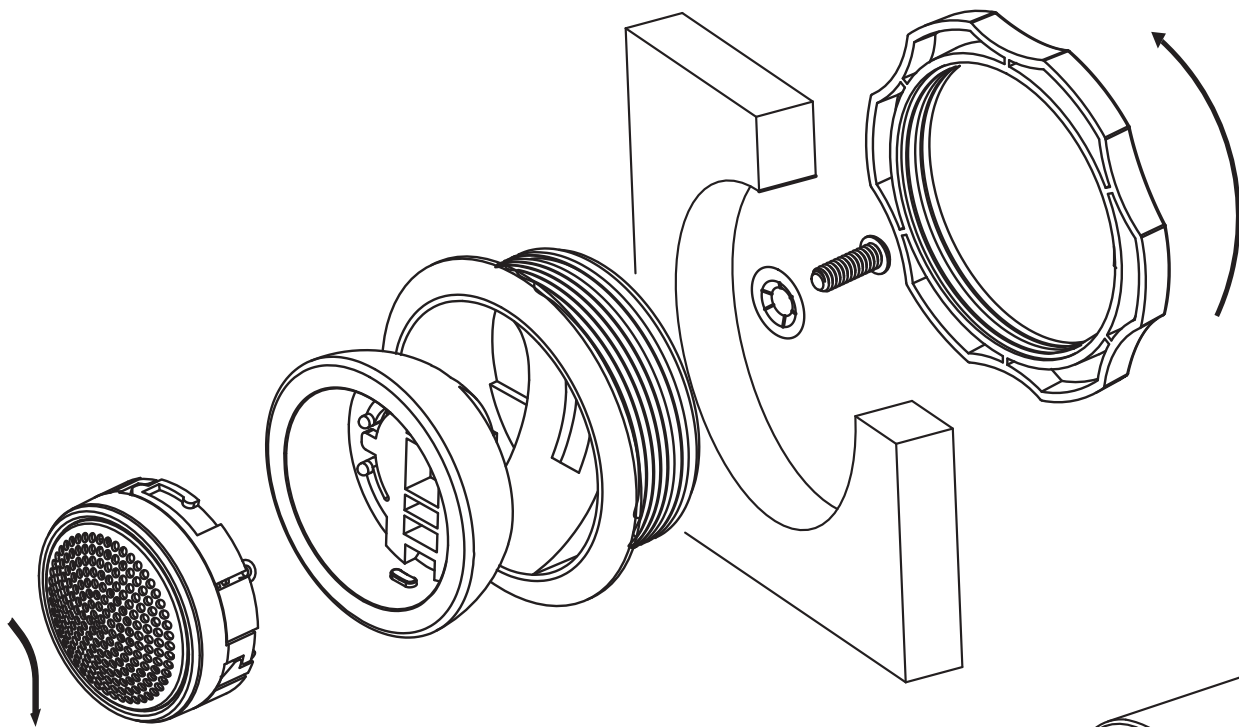

Stadium GTO750T

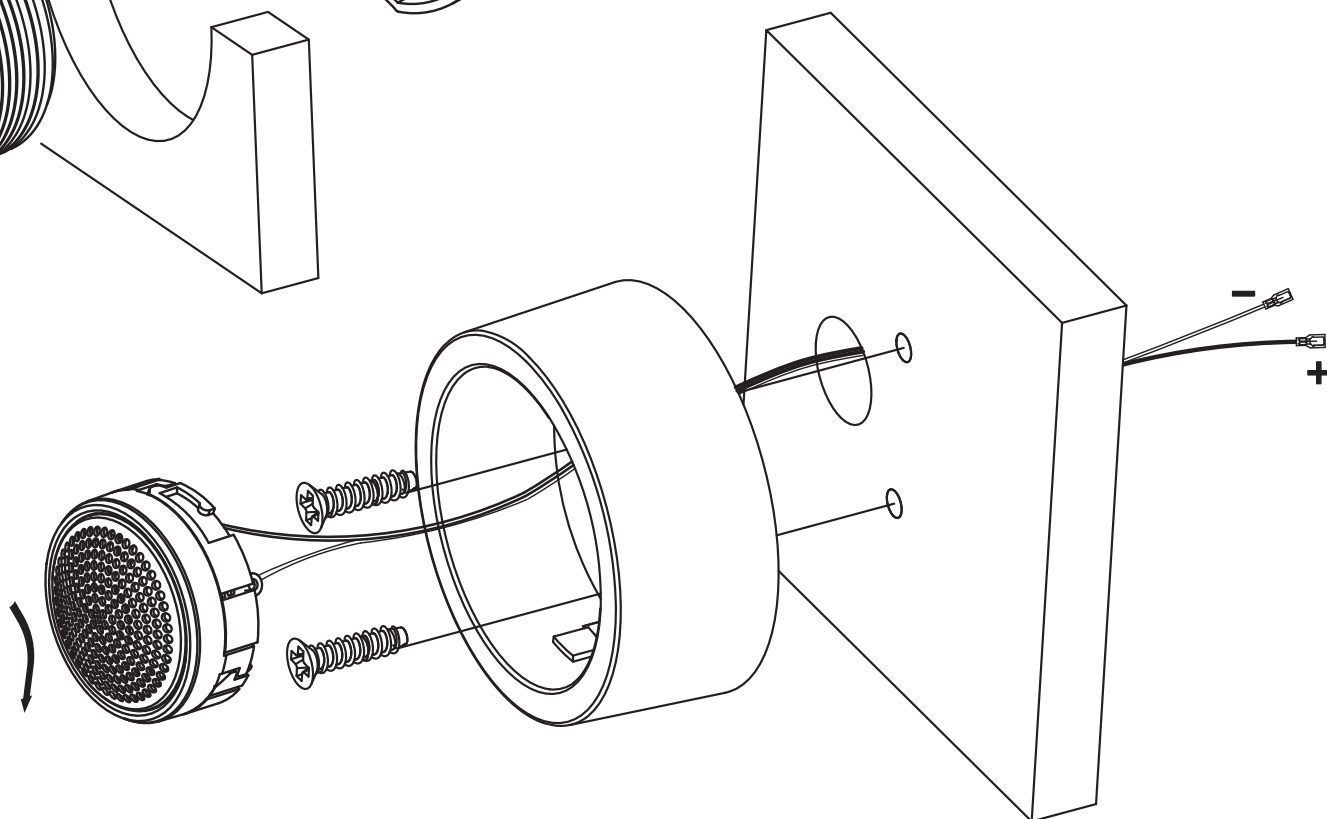
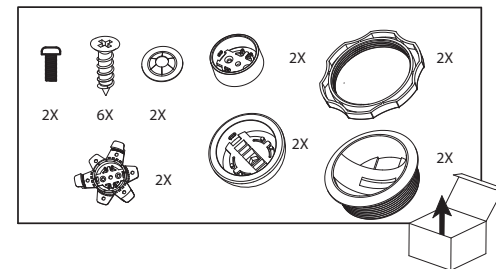

Stadium GTO750T

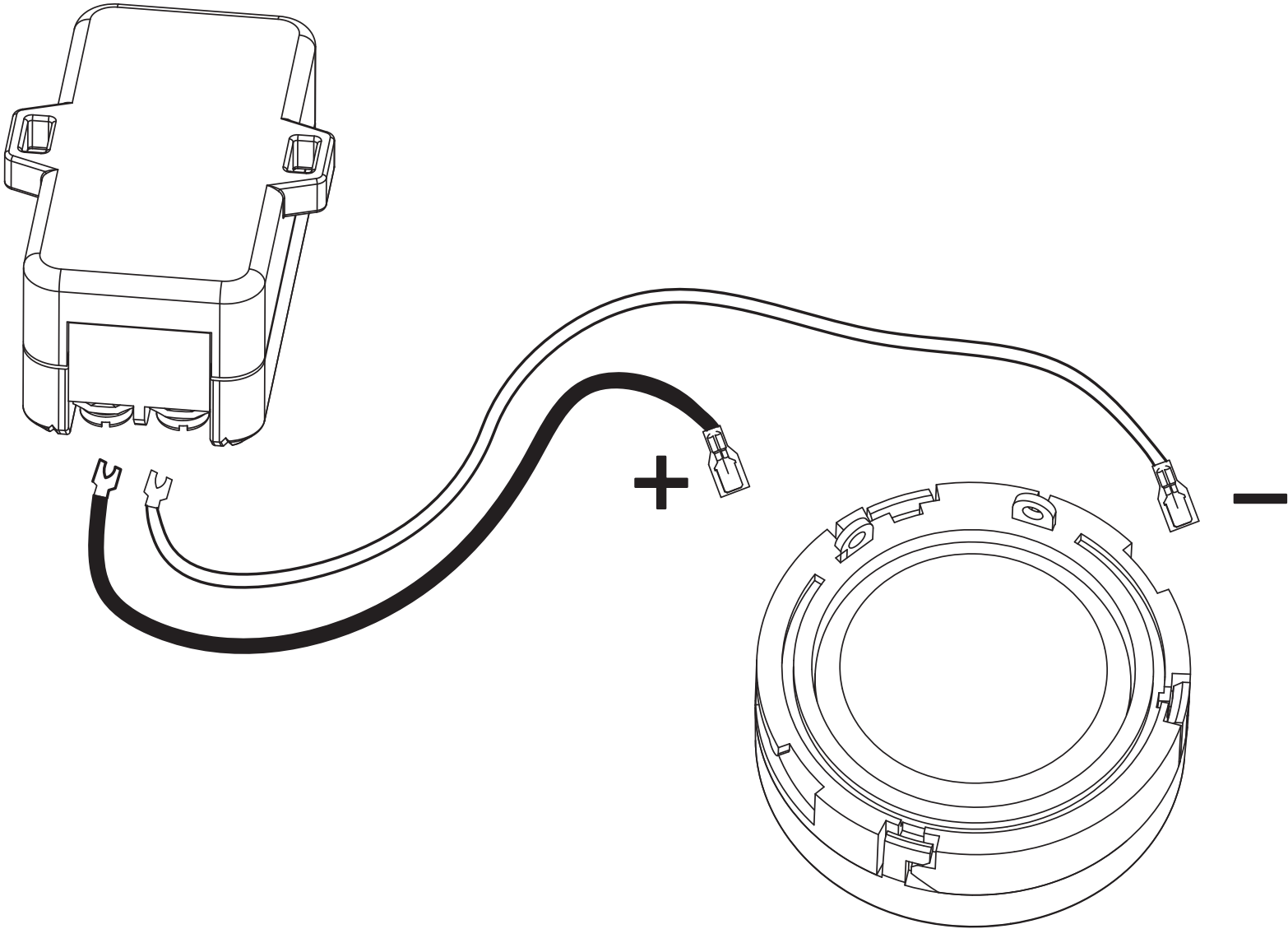

Stadium GTO930

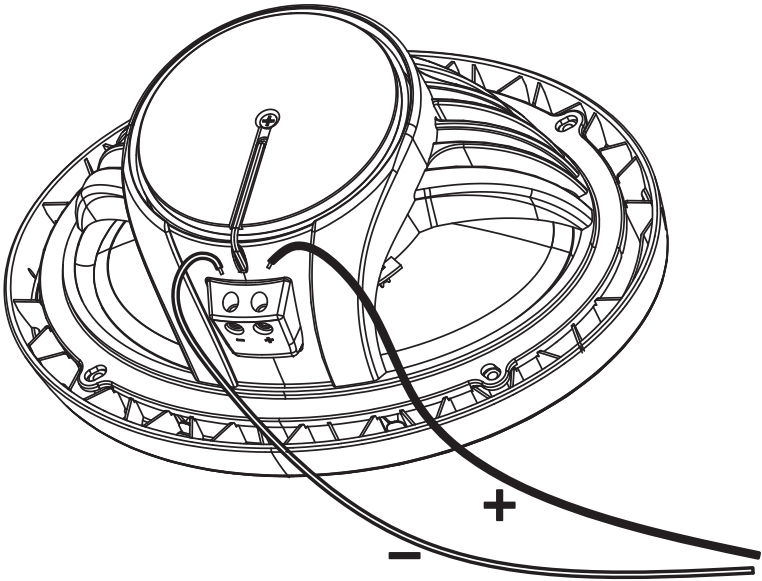
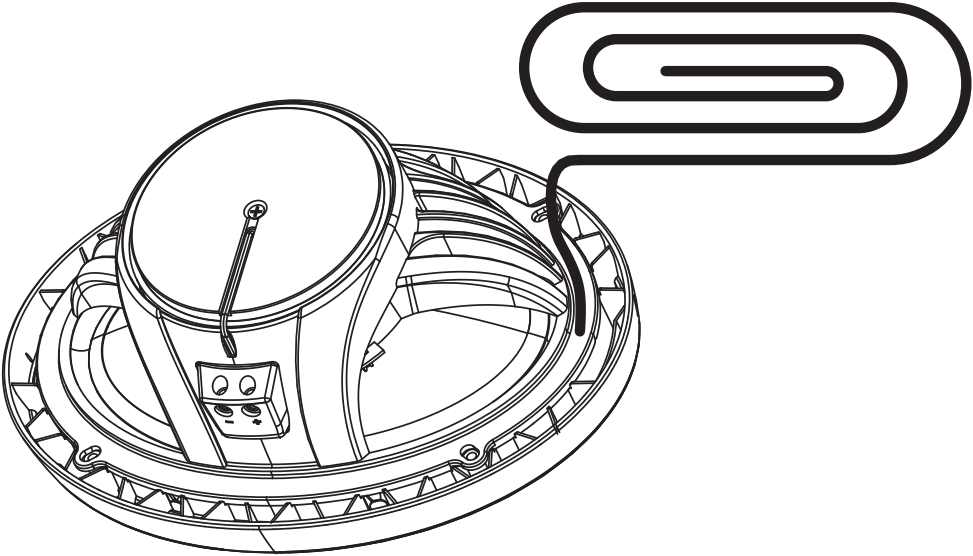
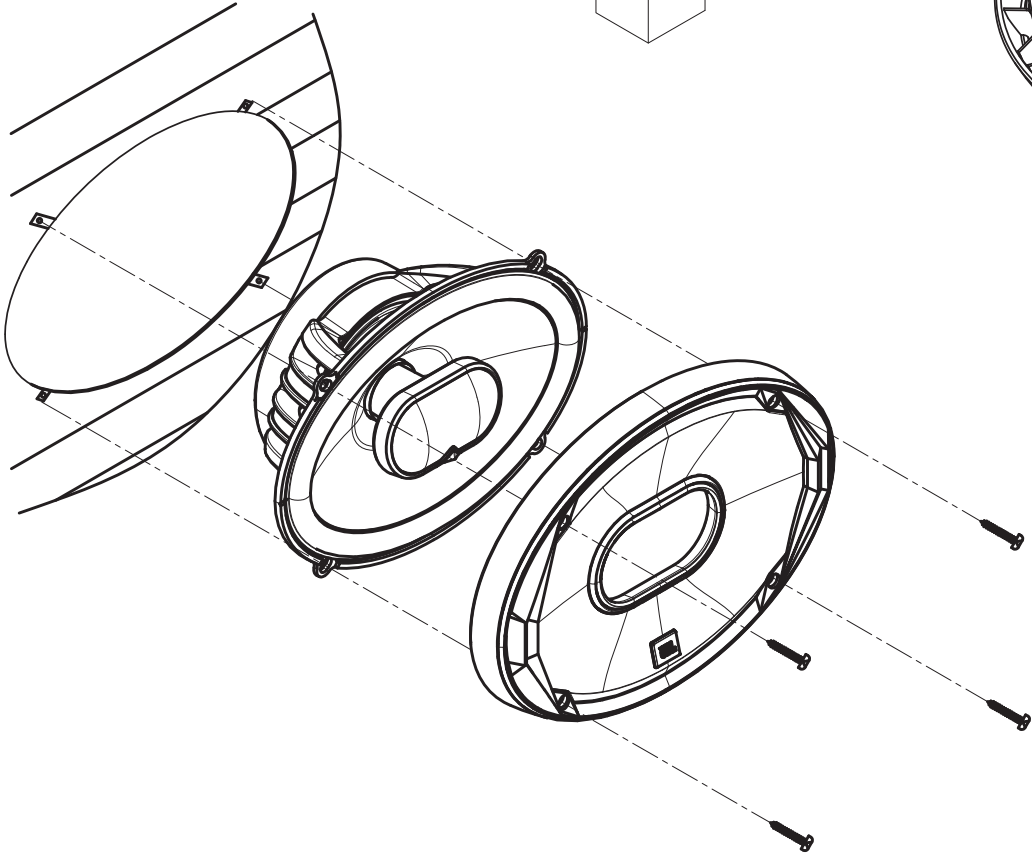
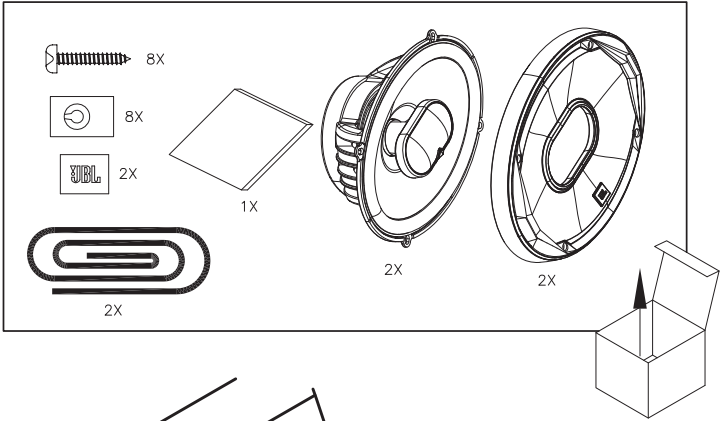

Stadium GTO20M

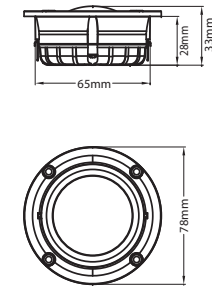

Stadium GTO620

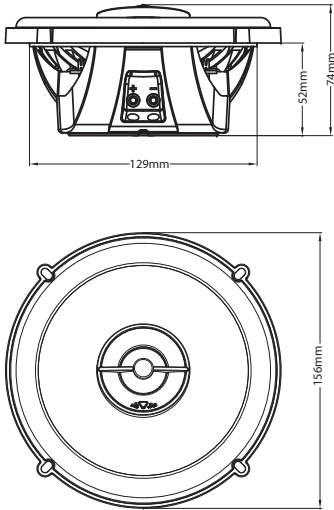

Stadium GTO860

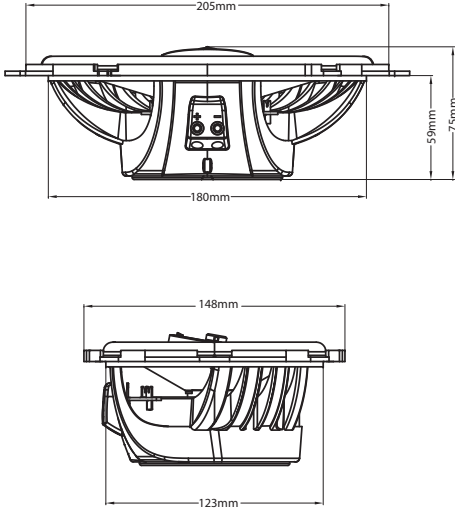

Stadium GTO930

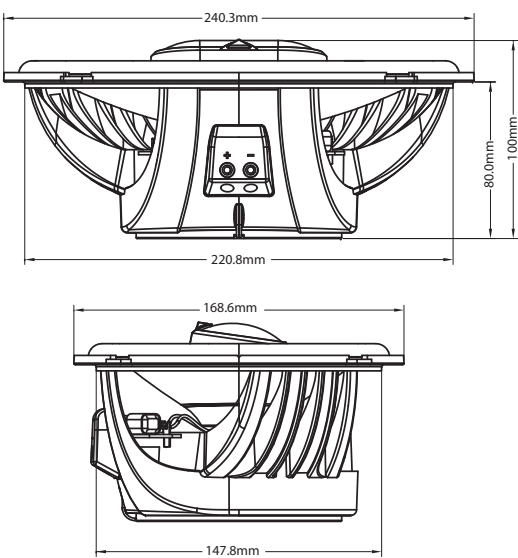

Stadium GTO750T

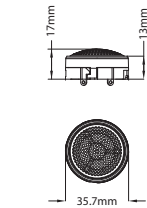

Stadium GTO600C

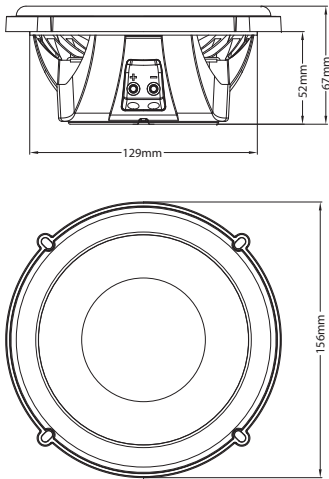

Stadium GTO960C

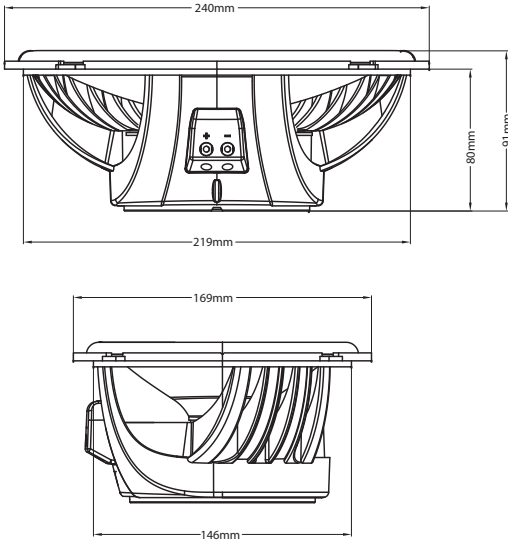

Stadium GTO860C

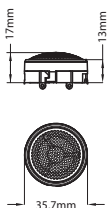
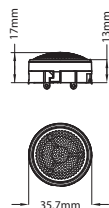
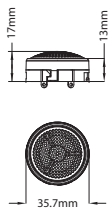
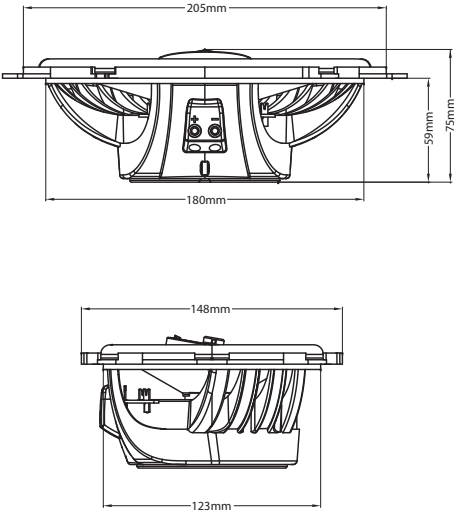

SPECIFICATIONS	Stadium GTO620	Stadium GTO930	Stadium GTO860	Stadium GTO600C	Stadium GTO860C	Stadium GTO960C	Stadium GTO20M	Stadium GTO750T
Type	6-1/2" (160mm) two-way multielement speaker	6" x 9" three-way multielement speaker	6" x 8" two-way multi-element speaker	6-1/2" (160mm) two-way component system with gap switchable crossover	6" x 8" two-way component system with gap-switchable crossover	6" x 9" two-way component system with gap-switchable crossover	2" (50mm) dome midrange with bandpass crossover enclosure	3/4" (19mm) tweeter with in-line HIGH-PASS FILTER in enclosure
Continuous power handling	75W	110W	100W	100W	100W	135W	65W	50W
Peak power handling	225W	330W	300W	300W	300W	405W	195W	150W
Frequency response	45Hz-23kHz	35Hz-30kHz	40Hz-23kHz	45Hz-25kHz	40Hz-25kHz	35Hz-25kHz	500Hz-7kHz	2K-25kHz
Nominal impedance	2.5ohm	2.5ohm	2.5ohm	2.5ohm	2.5ohm	2.5ohm	2.5ohm	2.5ohm
Sensitivity (2.83V/1m)	95dB	96dB	94dB	93dB	93dB	94dB	90dB	93dB

SPECIFICATIONS	Stadium GTO620	Stadium GTO930	Stadium GTO860	Stadium GTO600C	Stadium GTO860C	Stadium GTO960C	Stadium GTO20M	Stadium GTO750T
BL (Tm)	4.09	6.1	3.85	4.10	3.97	5.72	4.12	NA
DCR (ohms)	2.30	2.30	2.30	2.30	2.30	2.30	2.42	NA
Mms (g)	12.45	24	14.39	13.50	16.72	27.88	1.26	NA
Sd (cm2)	128.68	236	164.88	128.68	164.88	227.37	19.63	NA
Cms (µm/N)	351.00	404	404.00	333.00	349.00	353.00	53.00	NA
Vas (l)	8.17	31.5	15.43	7.73	13.34	25.60	0.03	NA
Fs (Hz)	76.00	51	66.01	75.12	65.84	50.77	615.78	NA
Qes	0.82	0.5	0.92	0.86	1.00	0.61	0.70	NA
Qms	10.45	13.4	4.05	10.29	4.14	9.21	6.50	NA
Qts	0.76	0.48	0.75	0.80	0.80	0.57	0.63	NA
Crossover Point	5.5kHz	3.3kHz	4.5kHz	5.5kHz	5.0kHz	5.5kHz	500Hz/6.5kHz	3.5kHz

ESPECIFICACIONES	Stadium GTO620	Stadium GTO930	Stadium GTO860	Stadium GTO600C	Stadium GTO860C	Stadium GTO960C	Stadium GTO20M	Stadium GTO750T
Tipo	Altavoz multielemento de dos vías de 6-1/2" (160 mm)	Altavoz multielemento de tres vías de 6" x 9"	Altavoz multielemento de dos vías de 6" x 8"	Sistema de componentes de dos vías de 6-1/2" (160 mm) con corte de frecuencias conmutable	Sistema de componentes de dos vías de 6" x 8" con corte de frecuencias conmutable	Sistema de componentes de dos vías de 6" x 9" con corte de frecuencias conmutable	Altavoz domo de gama media con caja de corte Bandpass de 2" (50 mm)	Altavoz de agudos de 3/4" (19 mm) con filtro High-Pass integrado
Gestión de potencia máxima continua	75W	110W	100W	100W	100W	135W	65W	50W
Gestión de potencia pico	225W	330W	300W	300W	300W	405W	195W	150W
Intervalo de frecuencias	45Hz-23kHz	35Hz-30kHz	40Hz-23kHz	45Hz-25kHz	40Hz-25kHz	35Hz-25kHz	500Hz-7kHz	2K-25kHz
Impedancia nominal	2.5ohm	2.5ohm	2.5ohm	2.5ohm	2.5ohm	2.5ohm	2.5ohm	2.5ohm
Sensibilidad (2.83V/1m)	95dB	96dB	94dB	93dB	93dB	94dB	90dB	93dB

SPÉCIFICATIONS	Stadium GTO620	Stadium GTO930	Stadium GTO860	Stadium GTO600C	Stadium GTO860C	Stadium GTO960C	Stadium GTO20M	Stadium GTO750T
Type	Haut-parleur coaxial deux voies 160 mm (6-1/2")	Haut-parleur coaxial trois voies 152 mm x 229mm (6" x 9")	Haut-parleur coaxial trois voies 152 mm x 203 mm (6" x 8")	Kit éclaté deux voies de 160 mm (6-1/2") avec filtre sélectionnable	Kit éclaté deux voies de 152 mm x 203 mm (6" x 8") avec filtre sélectionnable	Kit éclaté deux voies de 152 mm x 203 mm (6" x 9") avec filtre sélectionnable	Médium à dôme de 50 mm (2") avec filtre passe-bande intégré	Tweeter de 19 mm (3/4") avec filtre passe-haut intégré
Puissance admissible continue	75W	110W	100W	100W	100W	135W	65W	50W
Puissance admissible crête	225W	330W	300W	300W	300W	405W	195W	150W
Réponse en fréquence	45Hz-23kHz	35Hz-30kHz	40Hz-23kHz	45Hz-25kHz	40Hz-25kHz	35Hz-25kHz	500Hz-7kHz	2K-25kHz
Impédance nominale	2.5ohm	2.5ohm	2.5ohm	2.5ohm	2.5ohm	2.5ohm	2.5ohm	2.5ohm
Sensibilité (2.83V/1m)	95dB	96dB	94dB	93dB	93dB	94dB	90dB	93dB

English

Spanish

French



HARMAN International Industries, Inc.
8500 Balboa Boulevard, Northridge, CA 91329 USA

© 2017 HARMAN International Industries, Incorporated. All rights reserved.
JBL is a trademark of HARMAN International Industries, Incorporated, registered in the United States and/or other countries.

Features, specifications and appearance are subject to change without notice.

© 2017 HARMAN International Industries, Incorporated. Все права защищены.
JBL является торговой маркой Harman International Industries, Incorporated, зарегистрированной в США и/или других странах.

Функции, характеристики и внешний вид описываемых компонентов могут быть изменены без предварительного уведомления.



Торговая марка	: JBL
Назначение товара	: Автомобильная акустическая система
Изготовитель	: Харман Интернешнл Индастриз Инкорпорейтед, США, 06901 Коннектикут, г.Стэмфорд, Атлантик Стрит 400, офис 1500
Страна происхождения	: Китай
Импортер в Россию	: ООО "ХАРМАН РУС СиАйЭс", Россия, 127018, г.Москва, ул. Двинцев, д.12, к 1
Гарантийный период	: 1 год
Информация о сервисных центрах	: www.harman.com/ru тел. +7-800-700-0467
Срок службы	: 3 года
	Товар не подлежит обязательной сертификации
Дата производства	: Дата изготовления устройства определяется по двум буквенным обозначениям из второй группы символов серийного номера изделия, следующих после разделительного знака «-». Кодировка соответствует порядку букв латинского алфавита, начиная с января 2010 года: 000000-MY0000000, где «М» - месяц производства (А - январь, В - февраль, С - март и т.д.) и «Y» - год производства (А - 2010, В - 2011, С - 2012 и т.д.).

TR04192_B



www.jbl.com



Stadium Speakers

High performance multi-element speakers and component systems engineered to deliver world-class JBL performance and superior fit into most factory speaker locations.



Ultimate Car Audio by JBL.

JBL – speaker of choice for the world's top recording studios, concert events and movie theaters, delivers a world class listening experience to car audio with the new Stadium speakers. Unmistakably JBL. The high output 2 ohm design extracts every watt of power from the amplifier or head unit enabling the patented Plus One™ woofers to deliver an impressive wallop for mega volume aficionados. Sophisticated crossovers coupled with soft dome tweeters produce smooth as silk highs with extraordinary detail even at the highest volume levels. An optional midrange speaker with bandpass crossover provides seamless integration with woofer and tweeter, transforming a two-way component system into a three-way system for another magnitude of sound. Rigorous OEM-level reliability testing provides peace of mind when it's time to crank it up for that inimitable JBL adrenalin surge.

Features

- ▶ Eight Models to Accommodate All Applications/ Environments
- ▶ JBL Patented Plus One™ Glass Fiber Woofers with Rubber Surrounds
- ▶ Oversized (35mm) Woofer Voice Coils
- ▶ Edge-driven Soft Dome Tweeters
- ▶ 3-way Upgradability
- ▶ High Output 2 Ohm Design
- ▶ Harman Standard Reliability Testing
- ▶ Competitively Tuned
- ▶ Stadium Speakers by JBL



Stadium Speakers

High performance multi-element speakers and component systems engineered to deliver world-class JBL performance and superior fit into most factory speaker locations.

Features and Benefits

Eight Models to Accommodate All Applications/Environments

Stadium GT0620 – 6-1/2" (160mm) two-way multi-element speaker

Stadium GT0930 – 6" x 9" three-way multi-element speaker

Stadium GT0860 – 6" x 8" two-way multi-element speaker

Stadium GT0600C – 6-1/2" (160mm) two-way component system with gap switchable crossover

Stadium GT0860C – 6" x 8" two-way component system with gap switchable crossover

Stadium GT0960C – 6" x 9" two-way component system with gap switchable crossover

Stadium GT020M – 2" (50mm) dome midrange with bandpass crossover

Stadium 7.5T – 3/4" (19mm) tweeter with in-line HIGH-PASS FILTER

JBL Patented Plus One™ Glass Fiber Woofers with Rubber Surrounds

Plus One™ glass fiber woofer cones are lighter and stiffer with up to 25 percent more active cone-area than the competition. The result is remarkably accurate sound with high SPL performance. The hi-roll rubber surrounds allow the woofer cone to move freely and emit bolder bass.

Oversized (35mm) Woofer Voice Coils

Oversized voice coils with extra copper and surface area serves to dissipate the heat for improved reliability, enabling maximum power handling with low distortion.

Edge-driven Soft Dome Tweeters

Home theater quality soft dome tweeters deliver broader and smoother high frequency response. A push-button tweeter level control (+0 dB flat and +3 dB) provides custom tuning of high frequencies in most multi-element speakers.

3-way Upgradability

Crossovers on component systems are gap-switchable to accommodate a midrange upgrade. The optional midrange includes a bandpass crossover to convert a two-way system into a three-way system with perfect tonal balance and is designed to fit into many factory three-way applications.

High Output 2 Ohm Design

High output 2 ohm design with low impedance voice coils extracts every watt from the amplifier, delivering peak power with ease. Lower impedance also compensates for any added resistance in thin factory-installed wiring.

Harman Standard Reliability Testing

JBL speakers have to go through environmental testing that would destroy other speakers. JBL freezes them, bakes them, shakes them, blasts them with ultraviolet light and drives them at full power for days at a time.

Competitively Tuned

JBL employs second order filters for tweeters and sophisticated two-way crossovers for multi-element speakers and component systems resulting in higher power handling and added flexibility and accuracy when tuning speakers. A higher quality crossover allows JBL's wizards to consider speaker acoustic characteristics as well as specifications when tuning the JBL sound.

Stadium Speakers by JBL

The modern exterior design and premium finishes of Stadium speakers further reflect the quality of JBL engineering. In short, they look as good as they sound.



HARMAN International Industries, Incorporated
8500 Balboa Boulevard, Northridge, CA 91329 USA
www.jbl.com



Stadium Speakers

High performance multi-element speakers and component systems engineered to deliver world-class JBL performance and superior fit into most factory speaker locations.

What's in the Box

Stadium GTO620

2 x Speakers
2 x Grilles
2 x Plastic multi-hole adapter rings
2 x Foam gaskets
16 x Screws
8 x Speed clips
2 x JBL logo badges
2 x Brand stickers
Owner's manual

Stadium GTO930

2 x Speakers
2 x Grilles
2 x Foam gaskets
8 x Screws
8 x Speed clips
2 x JBL logo badges
2 x Brand stickers
Owner's manual

Stadium GTO860

2 x Speakers
2 x Spacers
2 x Foam gaskets
8 x Screws
8 x Speed clips
2 x JBL logo badges
2 x Brand stickers
Owner's manual

Stadium GTO600C

2 x Speakers
2 x Grilles
2 x Plastic multi-hole adapter rings
2 x Foam gaskets
2 x Crossovers
2 x Tweeters
2 x Flush-mount cups
2 x Threaded flush-mount adapters
2 x Surface-mount cups

2 x Starfish tweeter mounts
2 x Washers
32 x Screws
16 x Speed clips
1 x Allen head bit (2.5mm)
2 x JBL logo badges
2 x Brand stickers
2 x Plastics locking nuts
Owner's manual

Stadium GTO860C

2 x Speakers
2 x Spacers
2 x Foam gaskets
2 x Crossovers
2 x Tweeters
2 x Flush-mount cups
2 x Threaded flush-mount adapters
2 x Plastics locking nuts
2 x Surface-mount cups
2 x Starfish tweeter mounts
8 x Screws
8 x Speed clips
1 x Allen head bit (2.5mm)
2 x JBL logo badges
2 x Brand stickers
Owner's manual

Stadium GTO960C

2 x Speakers
2 x Grilles
2 x Spacers
2 x Foam gaskets
2 x Crossovers
2 x Tweeters
2 x Flush-mount cups
2 x Threaded flush-mount adapters
2 x Plastic locking nuts
2 x Surface-mount cups
2 x Starfish tweeter mounts

2 x Washers
24 x Screws
16 x Speed clips
1 x Allen head bit (2.5mm)
2 x JBL logo badges
2 x Brand stickers
Owner's manual

Stadium GTO20M

2 x Midrange driver
2 x Grilles
2 x Crossovers
2 x Cables (50mm)
2 x Custom Fit Mounting Adapters
2 x Foam gaskets
20 x Screws
4 x Speed clips
1 x Allen head bit (2.5mm)
2 x JBL logo badges
2 x Brand stickers
Owner's manual

Stadium GTO750T

2 x Tweeters
2 x Flush-mount cups
2 x Threaded flush-mount adapters
2 x Plastic locking nuts
2 x Surface-mount cups
2 x Starfish tweeter mounts
2 x Washers
8 x Screws



HARMAN International Industries, Incorporated
8500 Balboa Boulevard, Northridge, CA 91329 USA
www.jbl.com



Stadium Speakers

High performance multi-element speakers and component systems engineered to deliver world-class JBL performance and superior fit into most factory speaker locations.



Technical Specifications

Stadium GTO620

Power Handling: 75Wrms, 225W peak
Sensitivity (@ 2.83V): 95dB
Frequency Response: 45Hz – 23kHz
Voice Coil Diameter: 1-3/16 in. (30mm)
Impedance: 2.5 ohms

Stadium GTO930

Power Handling: 110Wrms, 330W peak
Sensitivity (@ 2.83V): 96dB
Frequency Response: 35Hz – 30kHz
Voice Coil Diameter: 1-7/16 in. (35.5mm)
Impedance: 2.5 ohms

Stadium GTO860

Power Handling: 100Wrms, 300W peak
Sensitivity (@ 2.83V): 94dB
Frequency Response: 40Hz – 23kHz
Voice Coil Diameter: 1-3/16 in. (30mm)
Impedance: 2.5 ohms

Stadium GTO600C

Power Handling: 100Wrms, 300W peak
Sensitivity (@ 2.83V): 93dB
Frequency Response: 45Hz – 25kHz
Voice Coil Diameter: 1-3/16 in. (30mm)
Impedance: 2.5 ohms

Stadium GTO860C

Power Handling: 100Wrms, 300W peak
Sensitivity (@ 2.83V/1m): 93dB
Frequency Response: 40Hz – 25kHz
Voice Coil Diameter: 1-3/16 in. (30mm)
Impedance: 2.5 ohms

Stadium GTO960C

Power Handling: 135Wrms, 405W peak
Sensitivity (@ 2.83V): 94dB
Frequency Response: 35Hz – 25kHz
Voice Coil Diameter: 1-7/16 in. (35mm)
Impedance: 2.5 ohms

Stadium GTO20M

Power Handling: 65Wrms, 195W peak
Sensitivity (@ 2.83V): 90dB
Frequency Response: 500Hz – 7kHz
Voice Coil Diameter: 1-3/4 in. (44mm)
Impedance: 2.5 ohms

Stadium GTO750T

Power Handling: 50Wrms, 150W peak
Sensitivity (@ 2.83V): 93dB
Frequency Response: 2k – 25kHz
Voice Coil Diameter: 13/16 in. (44mm)
Impedance: 2.5 ohms



HARMAN International Industries, Incorporated
8500 Balboa Boulevard, Northridge, CA 91329 USA
www.jbl.com

© 2017 HARMAN International Industries, Incorporated. All rights reserved. JBL is a trademark of HARMAN International Industries, Incorporated, registered in the United States and/or other countries. Features, specifications and appearance are subject to change without notice.