

JL AUDIO®
A Garmin Brand



Stealthbox®

INSTALLATION GUIDE
for the

SBX-J-JLTAILGT/12TW3

SKU# 94790

2018-Up Jeep Wrangler JL

Enclosure Type: Sealed

Driver Type: 12TW3-D4

Nominal Impedance: 2 ohms

Continuous Power Handling: 400 watts (RMS method)

! IMPORTANT

- Installation requires appropriate tools and safety equipment. Professional installation is recommended.
- If you prefer to perform your own installation, please read this installation guide completely before beginning.
- Before cutting or drilling, check for potential obstacles behind mounting surfaces.
- Mount this product securely to prevent damage or injury in severe conditions.

INSTALLATION
DIFFICULTY:

1 OUT OF 5

ESTIMATED TIME:
1 HOUR



INCLUDED HARDWARE

BOM ID	Qty	SKU	Description
1	2	155436	M6 x 65mm Torx Button Head Screw
2	2	155437	M6 Flat Washer, 18mm OD
3	2	155438	M6 Retaining Washer
4	2	155440	M6 Male-Female Hex Standoff
5	4	155439	M6 x 14mm Torx Button Head Screw
6	2	155441	Bracket
-	1	194157	Vibra-Tite 132 (not shown)
-	1	150249	Foam Tape Strip (not shown)
-	1	155442	6" T30 Torx Head Screwdriver Bit (not shown)
-	1	155411	Vehicle Harness (not shown)

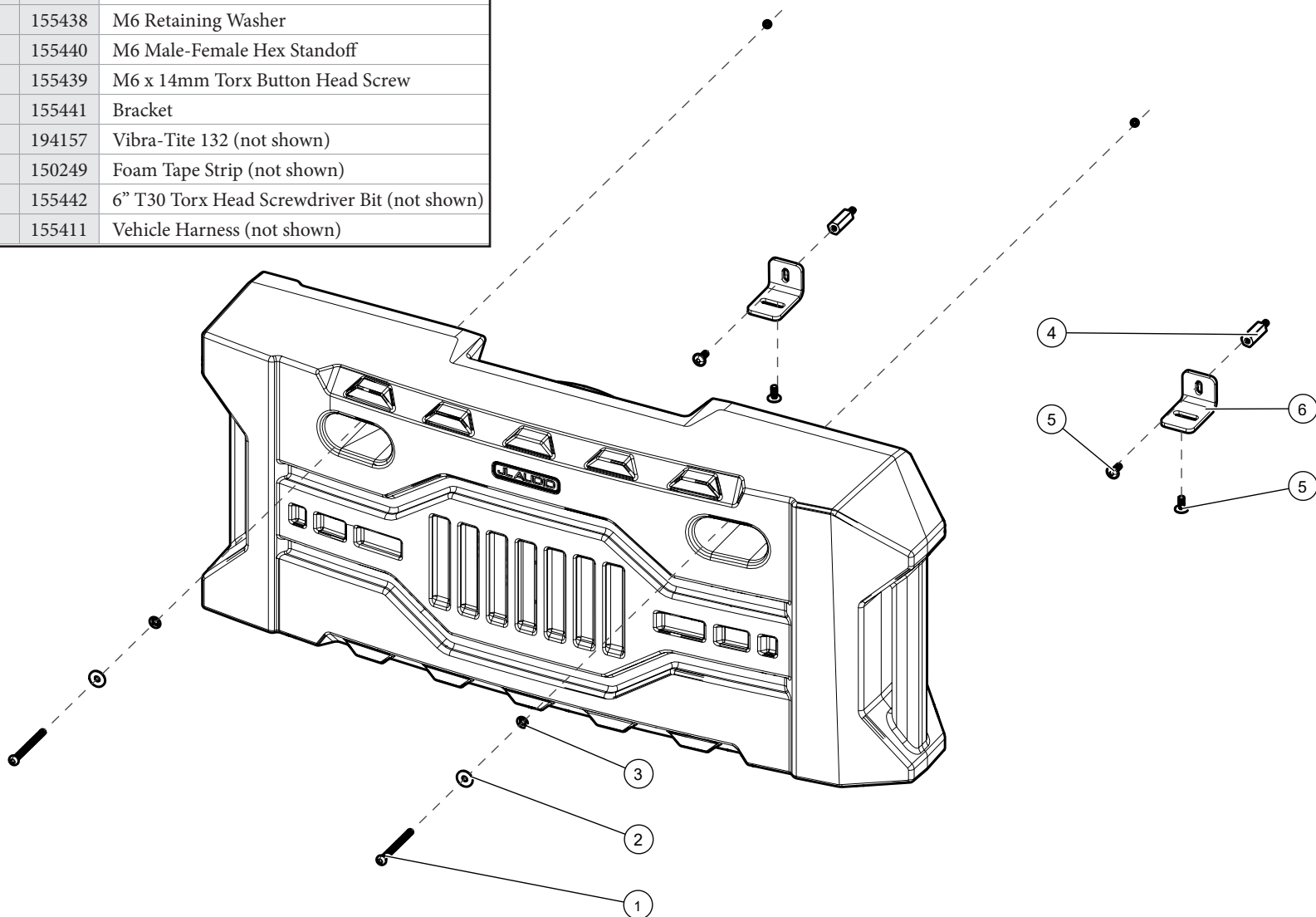



STEP 1

Open the tailgate and empty the rear portion of the cargo area.



STEP 2

Carefully unclip and remove the upper cover panel from the tailgate.



STEP 3

Carefully unclip and remove the main tailgate panel from the tailgate.



STEP 4

On the back of the main tailgate panel, locate the two small dimples near the bottom edge.

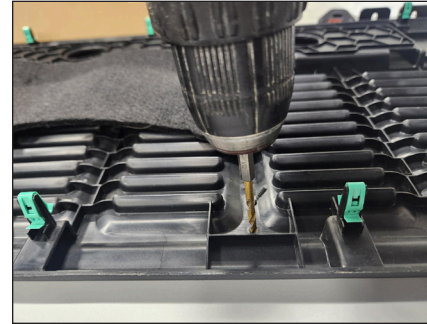

STEP 5

Using a 1/8" drill bit, carefully drill through each dimple.

Using a step bit, carefully enlarge each hole to 5/8".

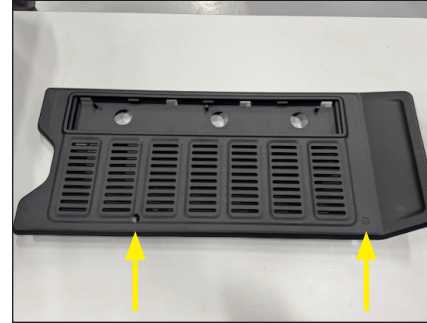

STEP 6

Pictured is the main tailgate panel with both holes enlarged.



STEP 7

Apply Vibra-Tite 132 to each M6 Male-Female Hex Standoff, and thread them into the indicated factory threaded holes in the tailgate.

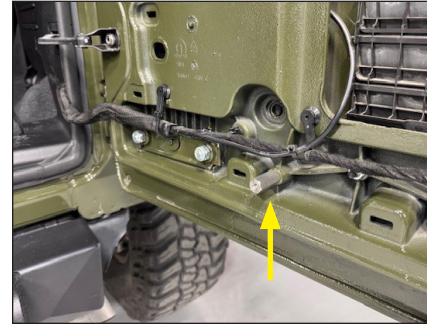

STEP 8

Fully tighten both of the M6 Male-Female Hex Standoffs.



STEP 9

Carefully reinstall the main tailgate panel.



STEP 10

Slide an M6 Flat Washer, then an M6 Retaining Washer over each of the two M6 x 65mm Torx Button Head Screws. Apply Vibra-Tite 132 to each screw, then loosely thread them into the indicated factory threaded holes in the tailgate.



STEP 11

Apply Vibra-Tite 132 to two M6 x 14mm Torx Button Head Screws, pass them through the vertical slot in each Bracket, and thread them into the M6 Male-Female Hex Standoffs.



STEP 12

Align each Bracket, as shown, and hand-tighten both M6 x 14mm Torx Button Head Screws.



STEP 13

Carefully place the enclosure onto the Brackets, and guide the M6 x 65mm Torx Button Head Screws through each enclosure keyway as described in the following steps. A 6" T30 Torx Head Screwdriver Bit is included for easy access to these fasteners.

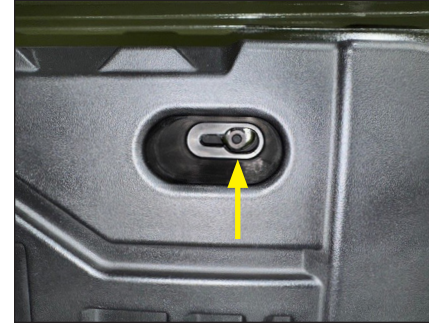

STEP 14

Allow each M6 x 65mm Torx Button Head Screw to pass through the indicated large slots in the enclosure.



STEP 15

Slide the enclosure to the right until it fully aligns with the tailgate. The M6 x 65mm Torx Button Head Screws should be positioned in the indicated narrow slots in the enclosure.



STEP 16

Align the slots in the Brackets with the bottom enclosure inserts, then carefully remove the enclosure from the tailgate. Fully tighten the two M6 x 14mm Torx Button Head Screws installed in **Step 12**. Reinstall the enclosure. Apply Vibra-Tite 132 to two M6 x 14mm Torx Button Head Screws, then pass them through each Bracket, into the enclosure inserts, and fully tighten. Fully tighten the two M6 x 65mm Torx Button Head Screws.

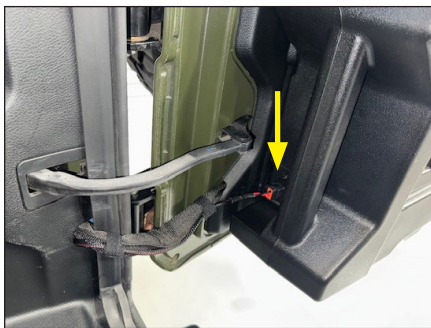
**STEP 17**

Plug the Harness into the connector on the side of the enclosure, secure it to the factory tailgate harness with the two attached hook and loop straps, and route the Harness as necessary.

**STEP 18**

The 6" T30 Torx Head Screwdriver Bit can be stored in the factory tool kit.

**STEP 19**

Be sure the rearmost section of the cargo area is empty before closing the tailgate.

CONGRATULATIONS!

You have completed the installation for this model! Enjoy your new Stealthbox®!

MID/HIGH FREQUENCY DRIVER FITMENT

A variety of JL Audio coaxial and component systems will fit in the factory speaker locations of your vehicle.

Location / OEM Speaker Size		Suggested JL Audio Speaker Models	
		Coaxial Models	Component Models
Dash	Upper / 3-1/2-inch	C2-350x	CF-350mt, C7-350cm ⁽²⁾
	Lower / 4-inch	C1-400x, C2-400x	C7-350cm ^(1,2)
Roll Bar	Outer / 3-1/2-inch	C2-350x	CF-350mt, C7-350cm ⁽²⁾
	Inner / 4-inch	C1-400x, C2-400x	C7-350cm ^(1,2)

1 - Installation may require adaptor, 2 - Component driver only

JL AUDIO® | How we play.®



(954) 443-1100

www.jlaudio.com

Please review the warranty information included with each product for details. Warranty is valid only if the product was purchased from an Authorized JL Audio Dealer. Authorized dealer status can be verified with the Dealer Locator on www.jlaudio.com. International Warranty: Please contact your country's JL Audio distributor for specific warranty details. © Garmin Ltd. or its subsidiaries. All rights reserved. • Garmin, JL Audio, Stealthbox, and How we play, are trademarks of Garmin Ltd. or its subsidiaries and are registered in one or more countries, including the U.S. The JL Audio logo, the How we play logo, the Stealthbox logo, and the SBX logo are trademarks of Garmin Ltd. or its subsidiaries. Product images shown are for illustrative purposes only and may differ from the actual product. Due to continuous product development, all specifications are subject to change without notice.

JLA-SKU# 011790 • ver. 06.10.2025 • 10369 NORTH COMMERCE PARKWAY • MIRAMAR, FLORIDA • 33025 • USA



011790