



# Stealthbox®

INSTALLATION GUIDE  
for the

**SB-F-EXPED4G/10TW1**

**SKU# 94688**

**2018 & Up Ford Expedition & Expedition MAX**

**Enclosure Type:** Sealed

**Driver Type:** 10TW1-2

**Nominal Impedance:** 2 ohms

**Continuous Power Handling:** 300 watts (RMS method)

SB-F-EXPED4G/10TW1 INSTR\_SKU# 011556

### ! IMPORTANT

- Installation requires appropriate tools and safety equipment. Professional installation is recommended.
- If you prefer to perform your own installation, please read this installation guide completely before beginning.
- Before cutting or drilling, check for potential obstacles behind mounting surfaces.
- Mount this product securely to prevent damage or injury in severe conditions.

INSTALLATION  
DIFFICULTY:

2 <sup>OUT OF</sup> 5

ESTIMATED TIME:  
1 HOUR



Continued on Next Page

INCLUDED HARDWARE

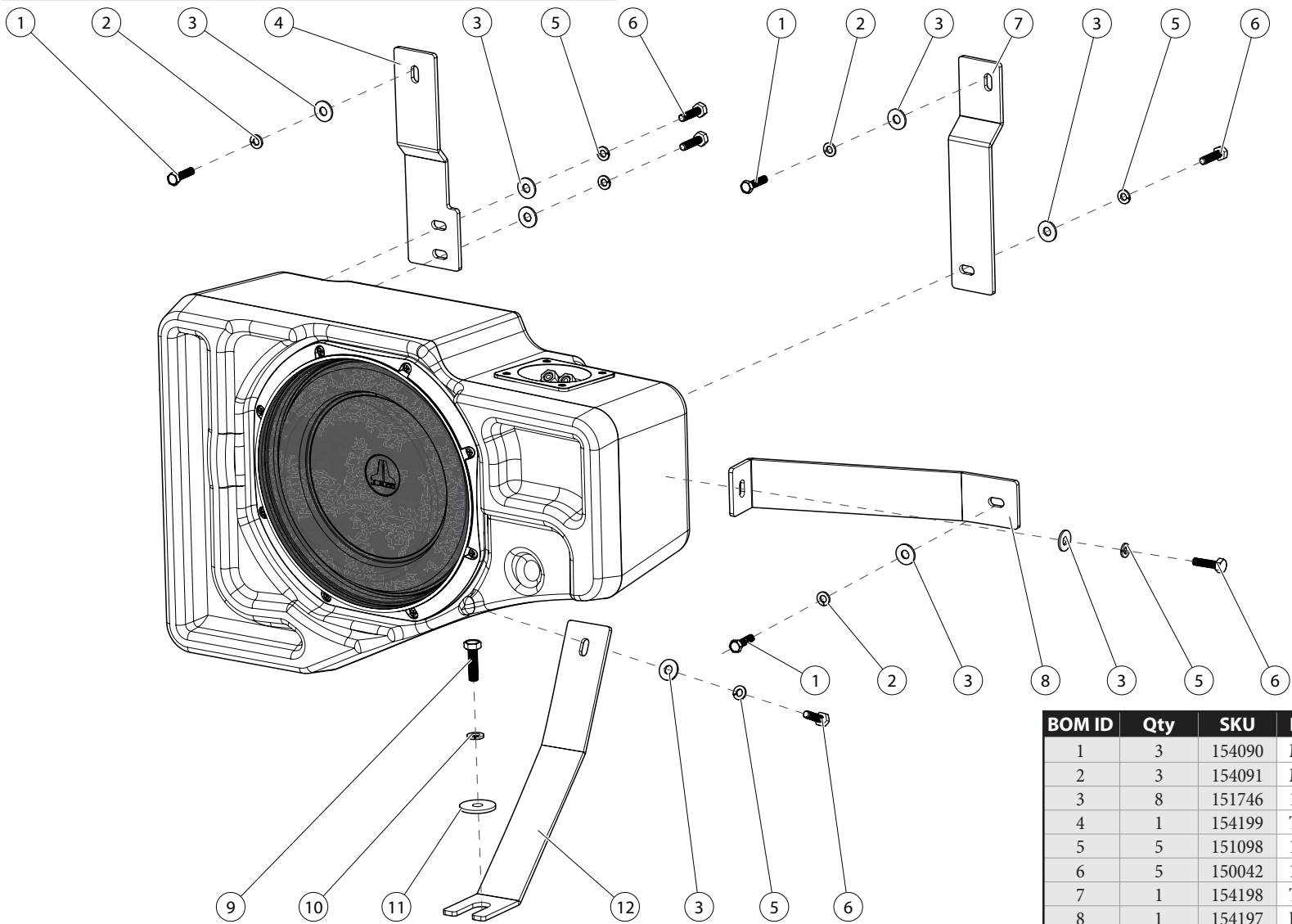

BOM ID	Qty	SKU	Description
1	3	154090	M6 x 1mm, 20mm Hex Head Screw
2	3	154091	M6 Split Lock Washer
3	8	151746	1/4" Flat Washer
4	1	154199	Top Rear Bracket
5	5	151098	1/4" Split Lock Washer
6	5	150042	1/4 - 20 x 1" Hex Head Screw
7	1	154198	Top Front Bracket
8	1	154197	Front Bracket
9	1	154233	M8 x 1.25mm, 25mm Hex Head Screw
10	1	154234	M8 Split Lock Washer
11	1	153997	5/16" ID, 1-1/4" OD Flat Washer
12	1	154196	Bottom Bracket
13*	1	150249	Foam Tape (not shown)

## POWER RECOMMENDATION

JL Audio recommends high quality amplifiers such as the JL Audio XD300/1v2. The diagram below shows the recommended crossover settings for the XD300/1v2. For a detailed description of the amplifier settings, consult the owner's manual for the amplifier. If another amplifier is being used, please reference this illustration and use similar settings on that amplifier.

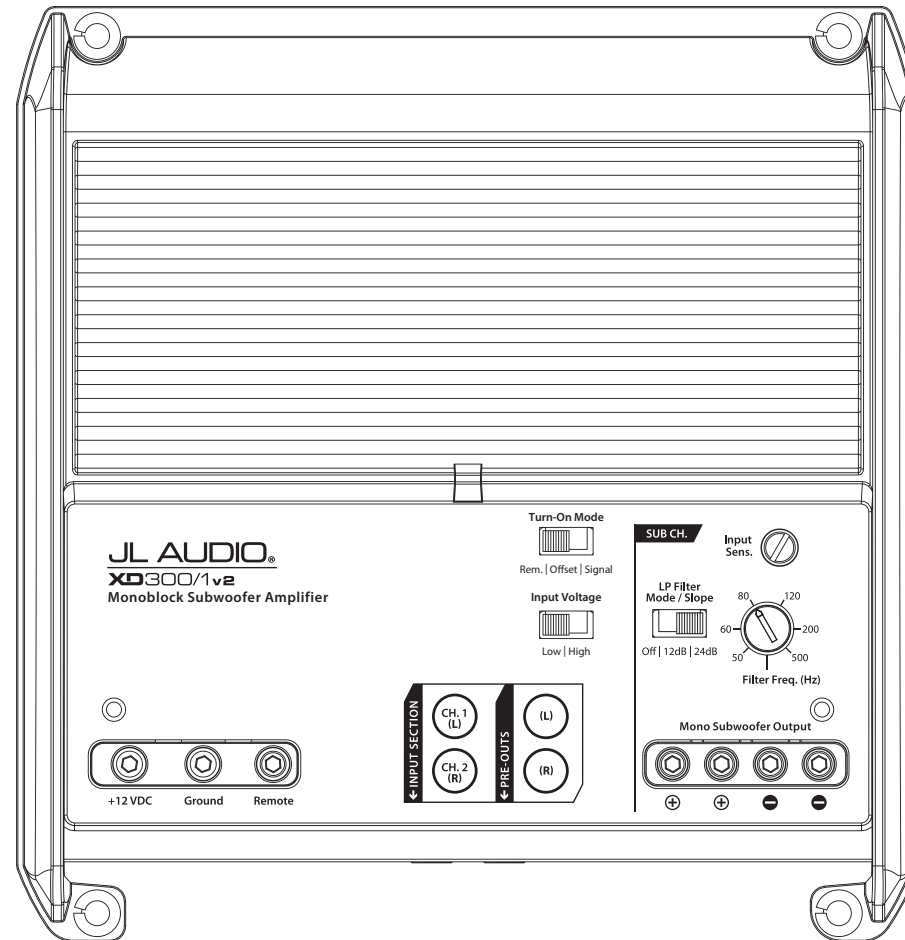

## CONNECTIONS

Using quality power, signal, and speaker wire is essential in ensuring the performance of your Stealthbox®. JL Audio recommends using a 4 AWG power kit such as the XD-PCS4-1B for your Stealthbox® amplifier. Other kits are available should you be using more than one amplifier. Signal wire such as the JL Audio Premium Audio Interconnect Cables should be used to provide signal for both channels of the amplifier. JL Audio recommends using 12 AWG speaker wire for subwoofers such as our XC-BCS12-25.



### STEP 1

Empty the cargo area and the rear seat on the driver's side.



### STEP 2

Carefully unclip and remove the upper cargo trim panel.



### STEP 3

Carefully unclip and remove the lower cargo sill panel.



### STEP 4

Fold up the cargo floor to access the storage pocket retaining screws, and remove the screws.

Remove the jack mounting screw, and remove the jack from the vehicle.



### STEP 5

Disconnect the wiring harness from the front of the storage pocket, then remove the pocket from the vehicle.



### STEP 6

Remove the rear seat bolts from the driver's side rear seat.



### STEP 7

From inside the vehicle, carefully unclip the screw covers from the rear seat brackets.



### STEP 8

Remove the front seat bolts from the driver's side rear seat.

Tilt the rear seat backward. Remove the two center seat bolts and the one seat belt bolt. Disconnect the seat belt harness, then remove the rear seat from the vehicle.



#### STEP 9

Open the upper seat belt bolt cover, then remove the seat belt bolt.



#### STEP 10

Carefully unclip and remove the rear door sill panel and the seat belt trim panel on the driver's side.

Remove the seat belt bolt.



#### STEP 11

Remove the screws from the side panel on the driver's side.



#### STEP 12

Carefully unclip and remove the C-pillar and D-pillar, then unclip and remove the side panel from the vehicle.

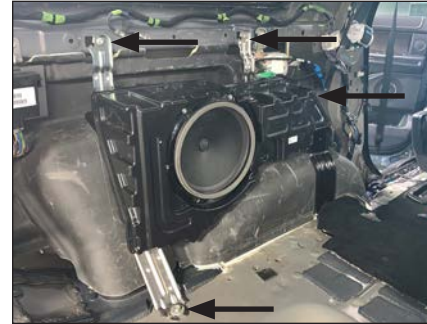

#### STEP 13

Remove the factory subwoofer enclosure mounting screws.



#### STEP 14

Disconnect and remove the factory subwoofer.



#### STEP 15

Slide a 1/4" Split Lock Washer and a 1/4" Flat Washer over a 1/4 - 20 x 1" Hex Head Screw. Pass the assembly through the slot in the Bottom Bracket, into the threaded insert on the back of the enclosure, as shown, and hand tighten.

See the illustration on **Page 2** for more detail.



#### STEP 16

Repeat the process from **STEP 15** for the Top Front Bracket and Top Rear Bracket, as shown.

See the illustration on **Page 2** for more detail.



**STEP 17**

Place the Stealthbox® into position, as shown. Slide an M8 Split Lock Washer and a 5/16" ID, 1-1/4" OD Flat Washer over an M8 x 1.25 mm, 25 mm Hex Head Screw, then loosely thread the assembly into the indicated factory hole to help hold the enclosure in place. Align the Top Front Bracket and Top Rear Bracket to the factory holes in the vehicle, then carefully remove the enclosure to fully tighten all four 1/4 - 20 x 1" Hex Head Screws.

**STEP 18**

Apply Foam Tape to the landings of the Top Front Bracket, Top Rear Bracket, and Bottom Bracket where they will contact the vehicle, then reinstall the enclosure and the M8 assembly. Slide an M6 Split Lock Washer and a 1/4" Flat Washer over an M6 x 1 mm, 20 mm Hex Head Screw, pass the assembly through the slot in the Top Front Bracket, and into the factory hole. Repeat the process for the Top Rear Bracket.

**STEP 19**

Apply Foam Tape to the slotted end of the Front Bracket where it will contact the vehicle. Slide a 1/4" Split Lock Washer and a 1/4" Flat Washer over a 1/4 - 20 x 1" Hex Head Screw. Pass the assembly through the slot in the opposite end of the Front Bracket and into the threaded insert in the front of the enclosure. Repeat the M6 assembly process to secure the Front Bracket to the vehicle.

**STEP 20**

Align the Stealthbox®, as shown, then fully tighten the three M6 x 1 mm, 20 mm Hex Head Screws and the M8 x 1.25 mm, 25 mm Hex Head Screw.

Connect speaker cable to the terminal cup on the top of the enclosure, and route the cable as necessary.

**STEP 21**

Reinstall the side panel, side panel screws, D-pillar, and C-pillar.

**STEP 22**

Reinstall the seat belt bolt, seat belt trim panel, and rear door sill panel.

**STEP 23**

Reinstall the rear seat belt bolt and cover.

**STEP 24**

Reinstall the rear seat, seat belt harness, seat belt bolt, seat bolts, and covers.

**STEP 25**

Reinstall the storage pocket and screws.  
Reinstall the jack.

**STEP 26**

Reinstall the cargo sill panel and the upper  
cargo door trim panel.

**CONGRATULATIONS!**

You have completed the installation for this model! Enjoy your new Stealthbox®!

**MID/HIGH FREQUENCY DRIVER FITMENT**

A variety of JL Audio coaxial and component systems will fit in the factory speaker locations of your vehicle.

Location / OEM Speaker Size	Suggested JL Audio Speaker Models	
	Coaxial Models	Component Models
Front Doors / 6 x 9-inch	C1-690x, C1-690tx, C2-690tx	C1-690, C3-650 <sup>(1)</sup> , C7-650cw <sup>(1,2)</sup>
Rear Doors / 6.5-inch	C1-650x <sup>(1)</sup> , C2-650x <sup>(1)</sup>	C1-650 <sup>(1)</sup> , C2-650 <sup>(1)</sup> , C3-650 <sup>(1)</sup> , C7-650cw <sup>(1,2)</sup>

1 - Installation may require adaptor, 2 - Component woofer only

**JL AUDIO®** | How we play.®    

(954) 443-1100

[www.jlaudio.com](http://www.jlaudio.com)

All specifications are subject to change without notice. "JL Audio" and "How we play" are registered trademarks of JL Audio, Inc. "Ahead of the Curve" and its respective logo are trademarks of JL Audio, Inc.

Printed in USA • ©2023 JL Audio, Inc. • For more detailed information please visit us online at [www.jlaudio.com](http://www.jlaudio.com).

JLA-SKU# 94688 • ver. 01.31.2023 • 10369 NORTH COMMERCE PARKWAY • MIRAMAR, FLORIDA • 33025 • USA



\*011556\*