

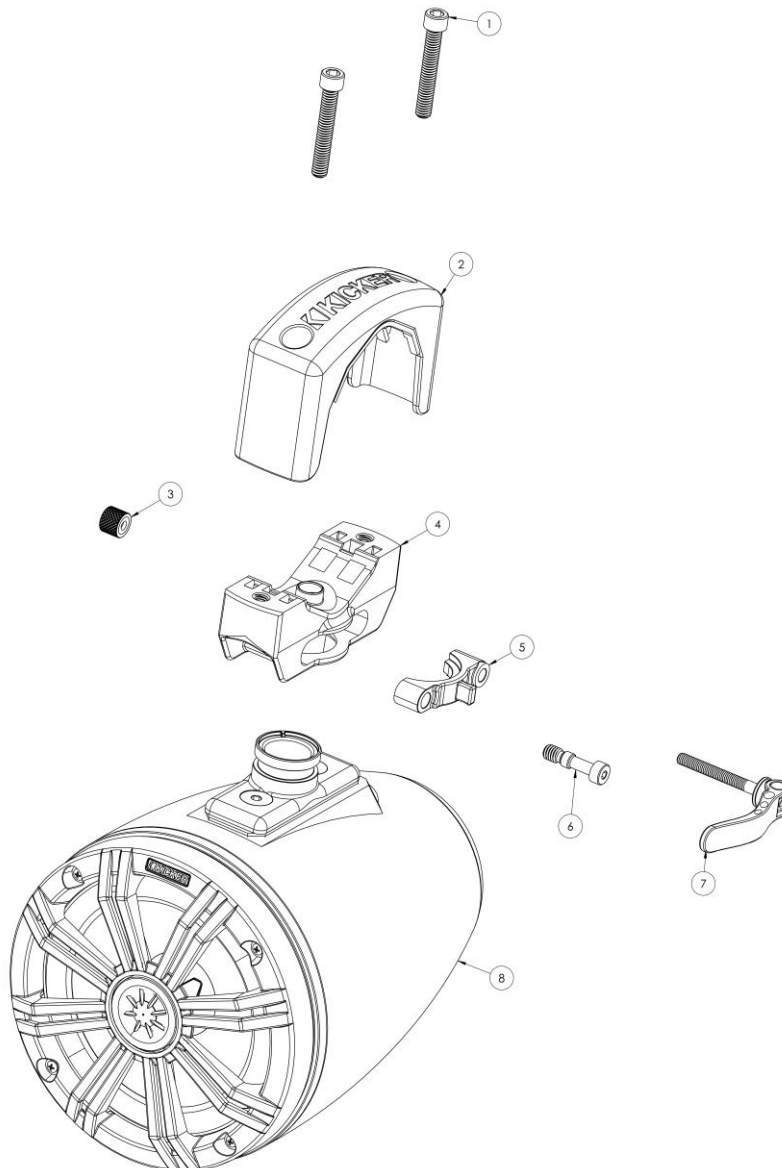

45KMTC INSTALLATION GUIDE

PARTS LIST – 45KMTC65

ITEM NO.	DESCRIPTION	QTY.
1	MOUNTING BOLT	4
2	UPPER MOUNT	2
3	FINGER NUT	2
4	LOWER MOUNT	2
5	LOCK CLAMP	2
6	RETAINING BOLT	2
7	CAM BOLT	2
8	6.5" KMTC ENCLOSURE ASSEMBLY	2





PARTS LIST – 45KMTC8

ITEM NO.	DESCRIPTION	QTY.
1	MOUNTING BOLT	4
2	UPPER MOUNT	2
3	FINGER NUT	2
4	LOWER MOUNT	2
5	LOCK CLAMP	2
6	RETAINING BOLT	2
7	CAM BOLT	2
8	8" KMTC ENCLOSURE ASSEMBLY	2

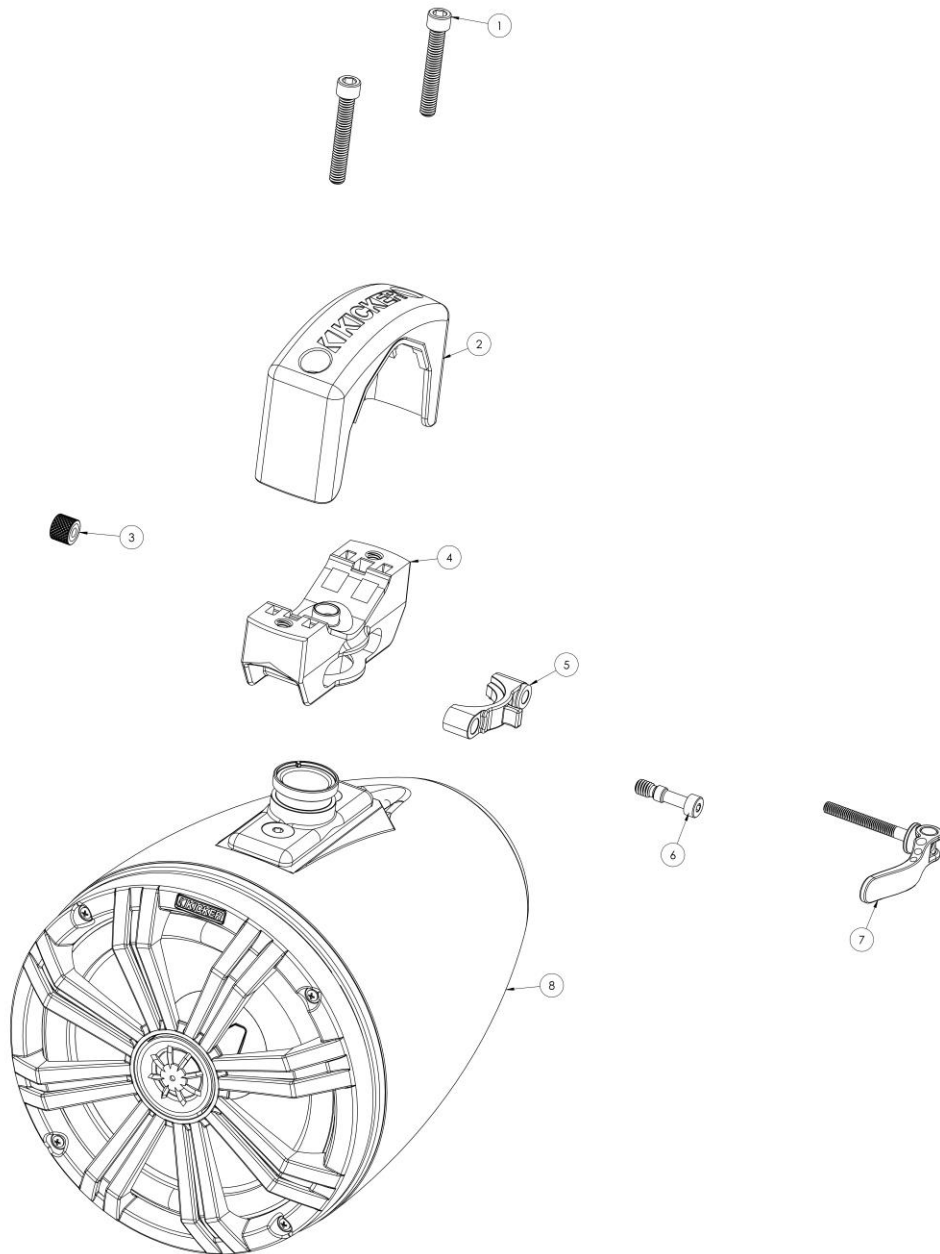



PARTS LIST – 45KMTDC65

ITEM NO.	DESCRIPTION	QTY.
1	MOUNTING BOLT	4
2	UPPER MOUNT	2
3	FINGER NUT	2
4	LOWER MOUNT	2
5	LOCK CLAMP	2
6	RETAINING BOLT	2
7	CAM BOLT	2
8	DUAL 6.5" KMTDC ENCLOSURE ASSEMBLY	2

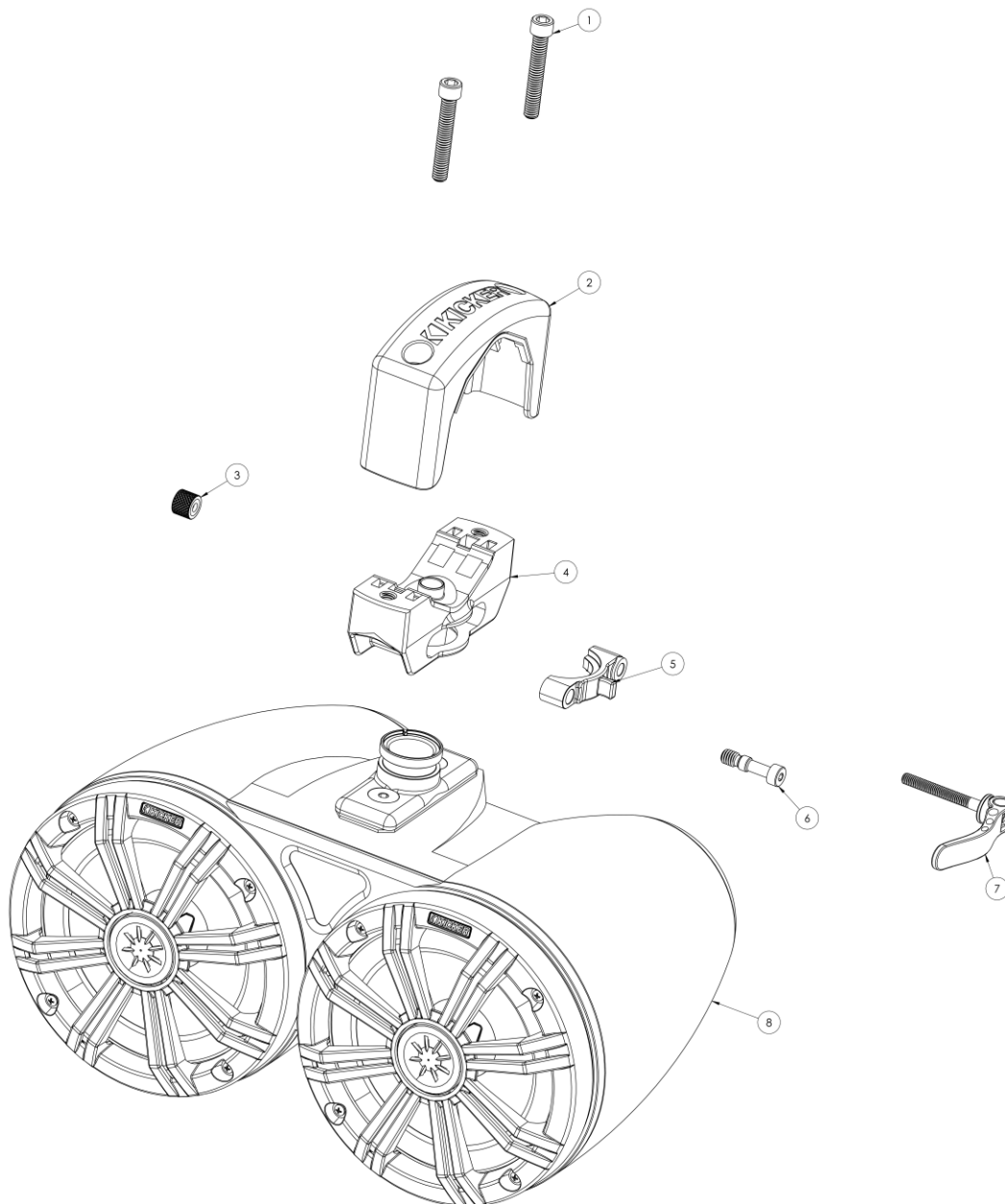



Kicker KMTC marine enclosures have badges that may be rotated to a preferred orientation. The speaker grille may also be rotated in increments of 45 degrees. Disassembly of the enclosure is required to rotate the badge. This document will address how to rotate the badge for the following models:

- 45KMTC65
- 45KMTC8
- 45KMTDC65

PART IDENTIFICATION

Below is a list describing part names used when rotating the enclosure badge.

- (1) Badge Trim Ring
- (2) Badge
- (3) Enclosure Housing
- (4) Short Screw
- (5) Speaker
- (6) Grille
- (7) Long Screw

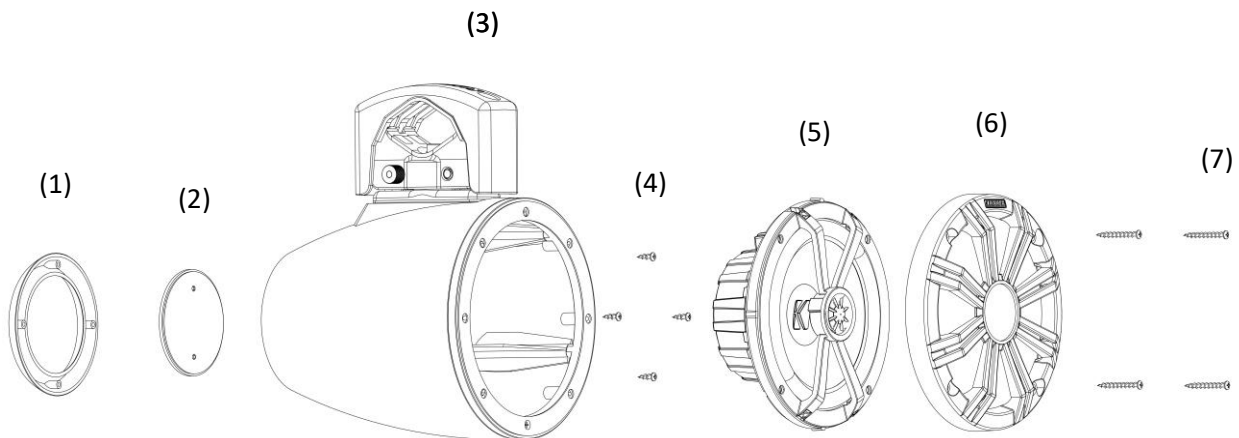

READ AND UNDERSTAND ALL INSTRUCTIONS BEFORE INSTALLATION



ROTATING THE ENCLOSURE BADGE



DANGER! Electrical hazard. Burns, electric shock, or damage to equipment may occur during connection of electrical wires. Always disconnect the vehicle's power source before making wire connections.

1. If the enclosure is mounted to a vehicle, remove the enclosure from the vehicle.
2. Remove the four screws that secure the grille and speaker to the enclosure assembly.

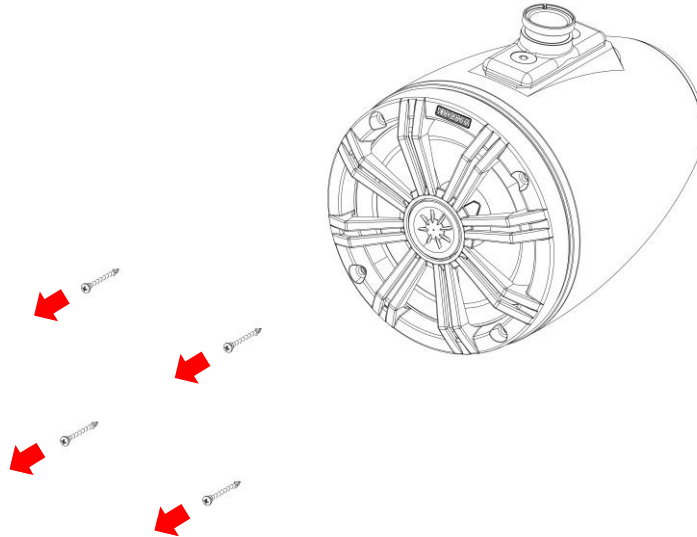

3. Remove the grille and then the speaker. Use care to remove the speaker and LED wires from the foam gasket on top of the enclosure.

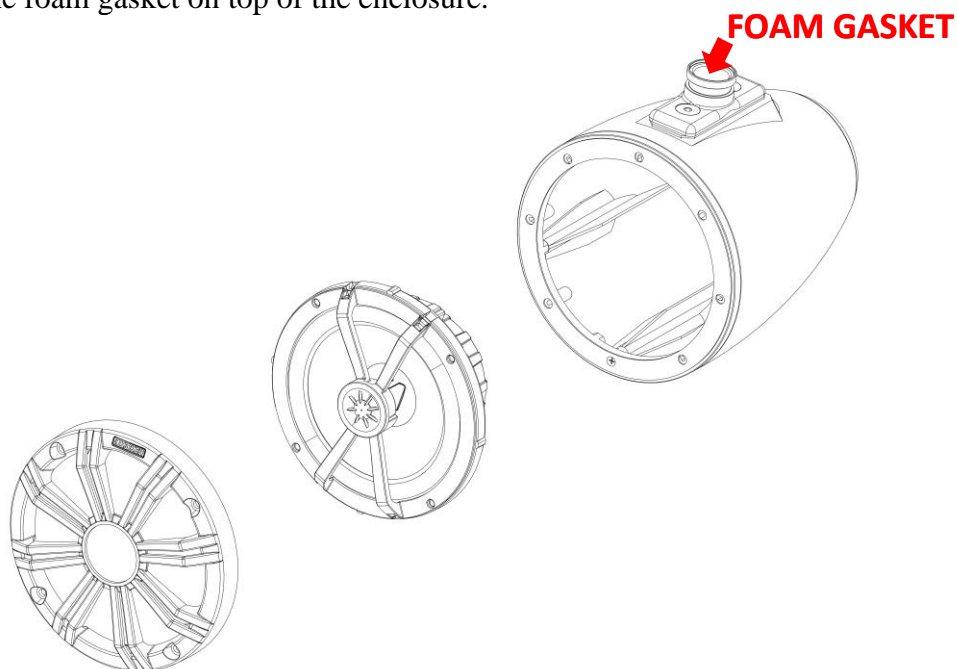



4. If any poly-fill is present, remove it from inside the enclosure.
5. Remove the four short screws located at the back of the inside of the enclosure.

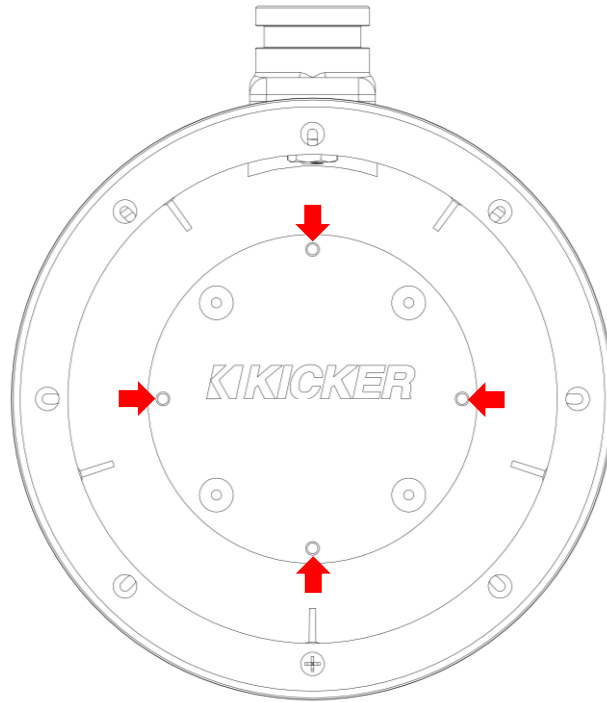

6. Pull the badge trim ring off of the enclosure.

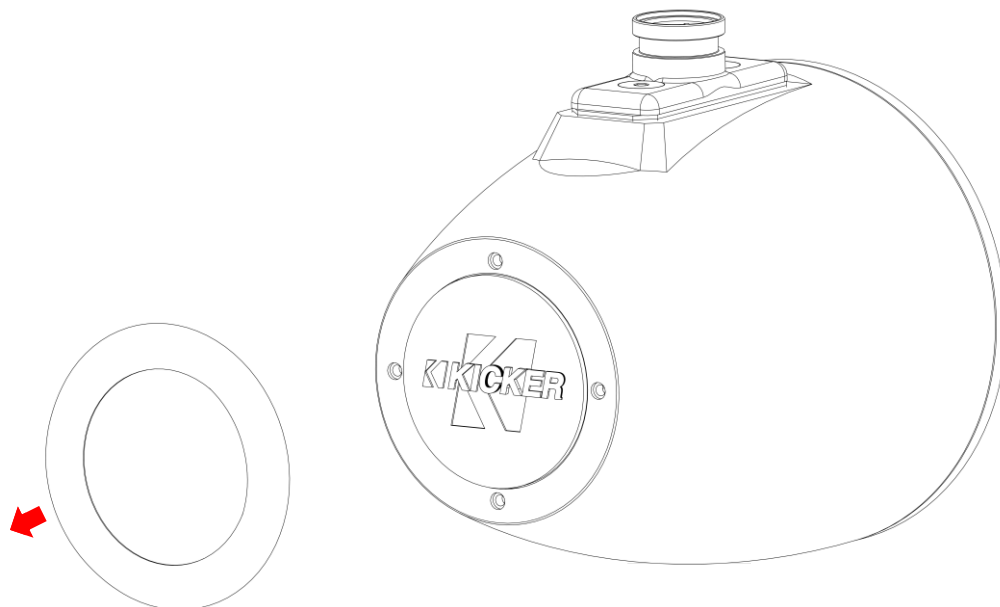



7. Pull the badge from the enclosure. Rotate the badge to the desired position and place it back onto the enclosure.

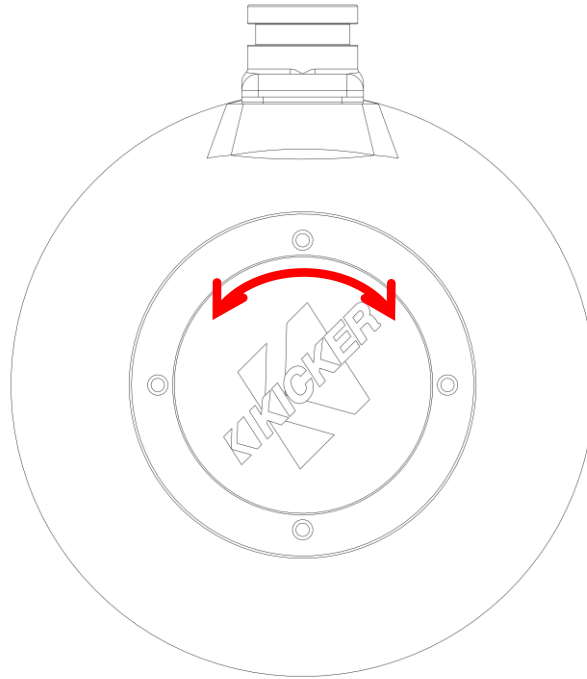

8. Install the badge trim ring.

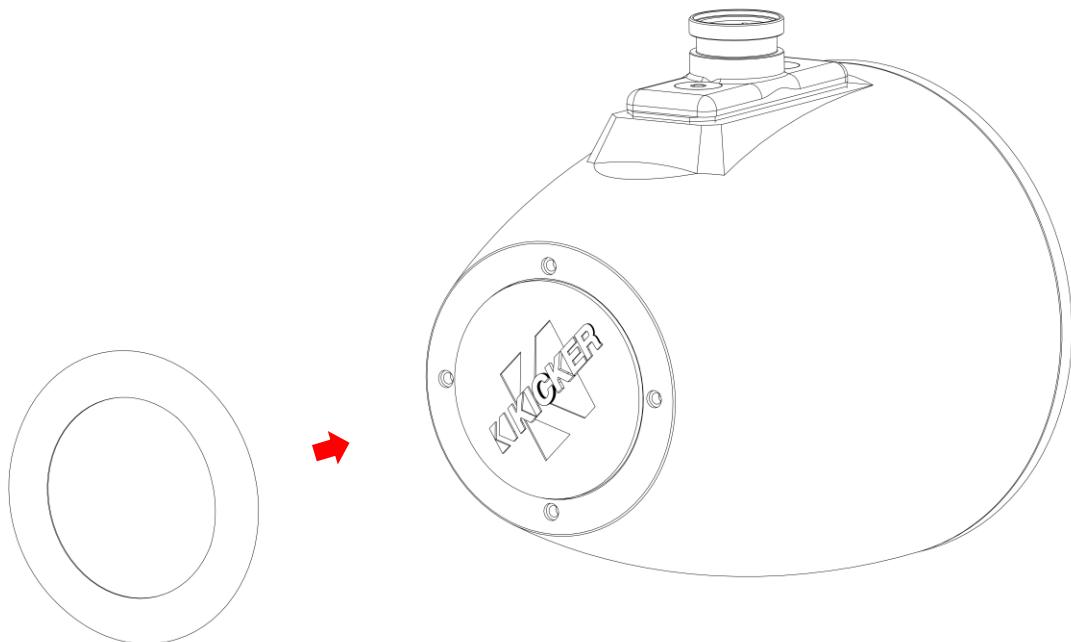



9. Orient the enclosure with the badge trim ring down and secure the trim ring with the four short screws.

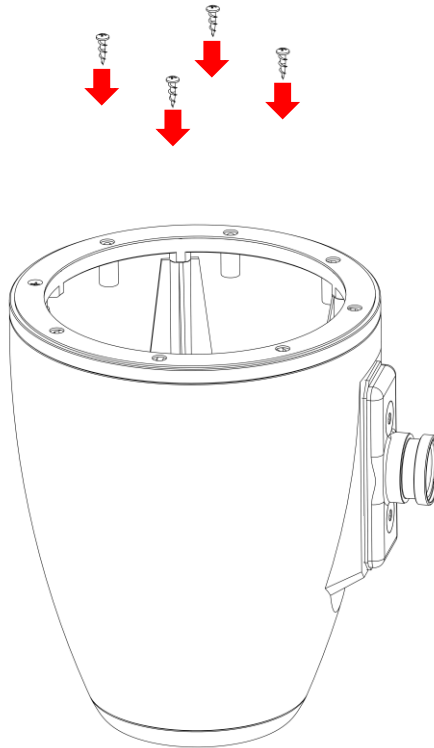

10. Coat the top of the screws and the surrounding area of the enclosure with a dab of silicone to prevent the screws from backing-out.
11. If the enclosure came with poly-fill, place the poly-fill into enclosure.
12. Route speaker wires and LED wires through the gasket.



13. Set speaker in enclosure and rotate in 45 degree increments to the desired orientation.

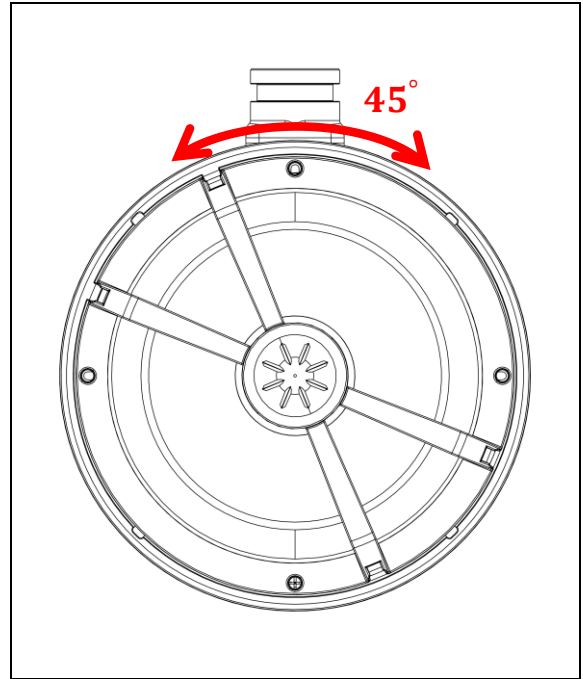
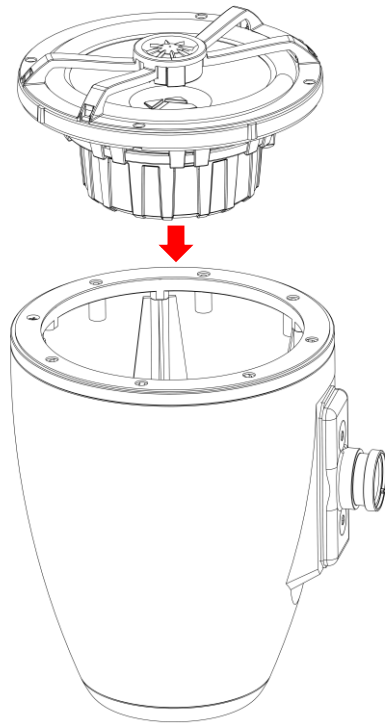

14. Place the grille on the speaker with the “KICKER” in the desired orientation.

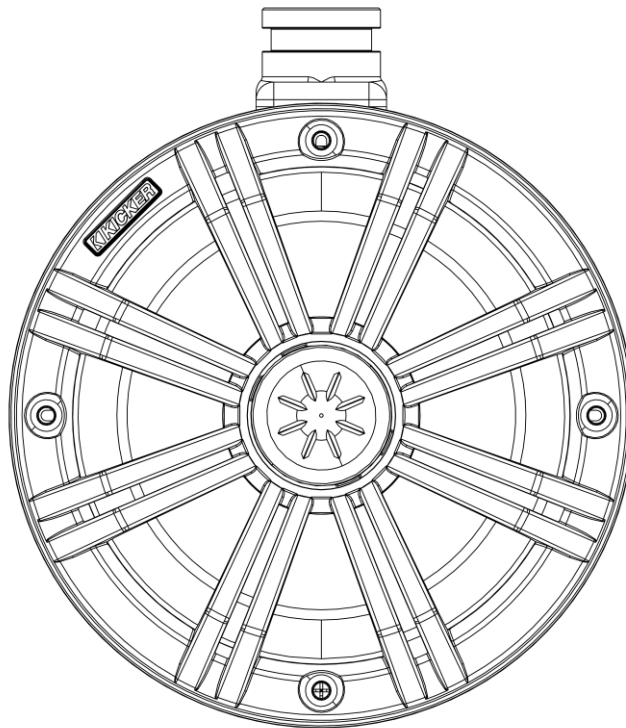



15. Secure the speaker and grille to the enclosure using the four long screws.

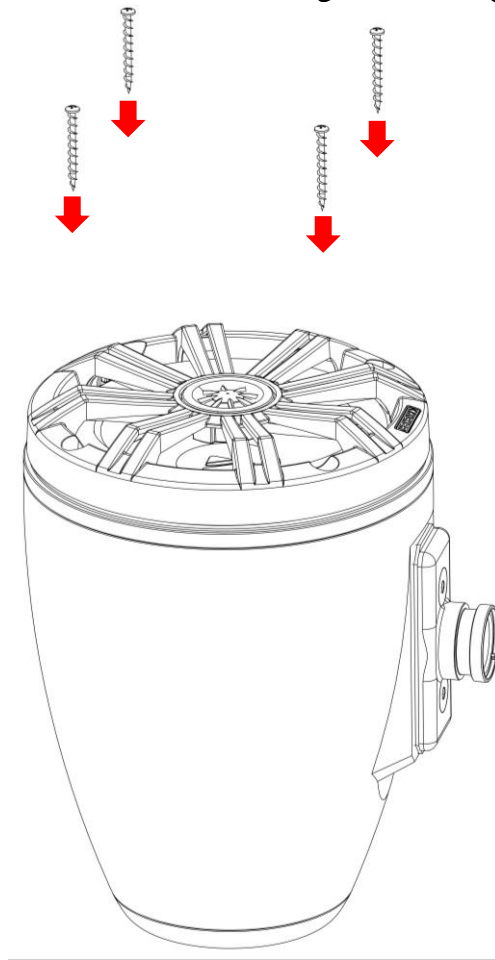

16. Install the enclosure onto the vehicle. (See “Mounting the Enclosure” - page 11)



MOUNTING THE ENCLOSURE

45KMTC mounting systems allow the enclosure to rotate 360 degrees about the mounting clamp for optimized sound targeting. A cam bolt provides toolless locking and unlocking of the lock clamp for quick and easy rotation of the enclosure. **MOCK-UP ALL ENCLOSURES BEFORE DRILLING HOLES.**

1. Push wires into the enclosure until wire ends are flush with the top of the hole in clamp. **DO NOT** push wires entirely into enclosure.

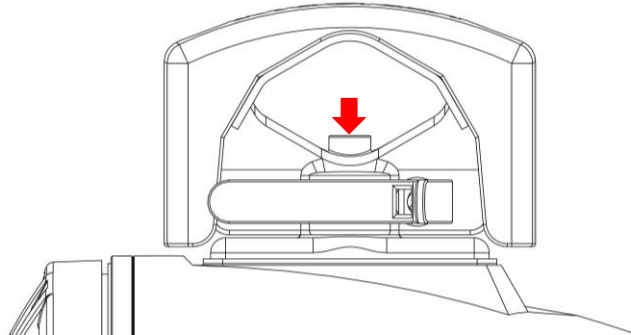

2. Apply anti-seize to the threads of all mounting bolts. Mount all enclosures to the tower tube and. Do not fully tighten clamp.

NOTICE!

Do not overtighten the mounting bolt during mock-up. Damage to the lower mounting clamp will occur. Tighten bolts only enough to hold the enclosure in desired position so that tubing can be marked for drilling.

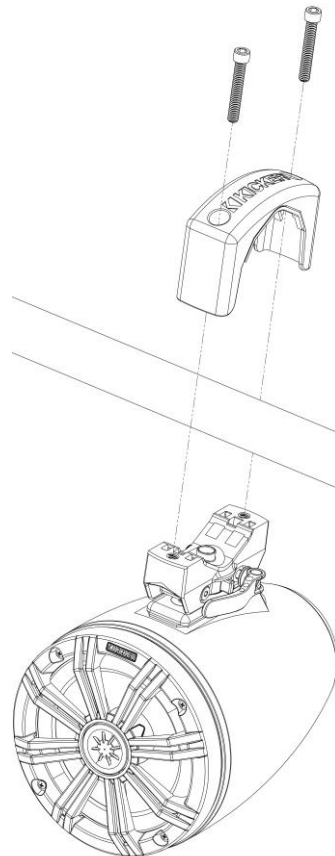



3. Rotate the enclosures up or down and position all enclosure to the desired orientation. Tighten the clamps only enough to prevent rotation of the enclosure.

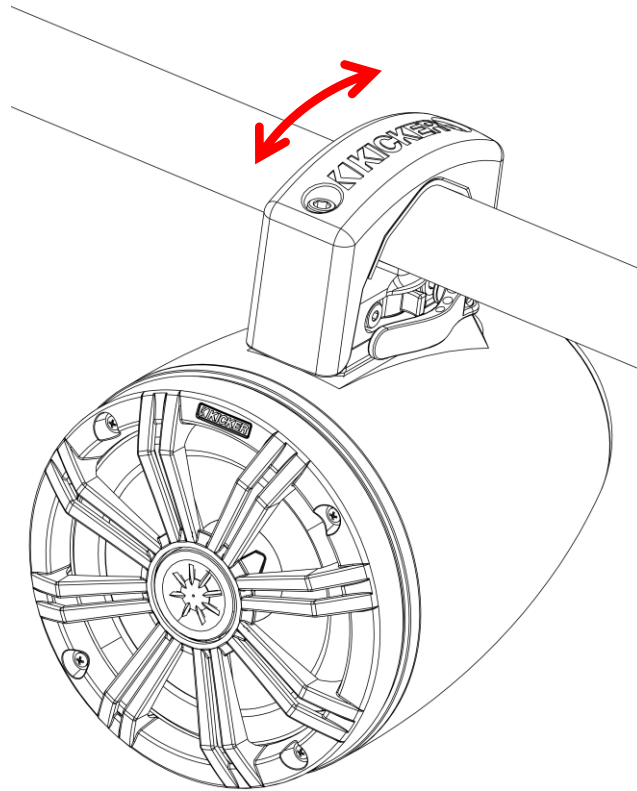

4. Release the clamp on the cam bolt and unthread the finger nut from the cam bolt.

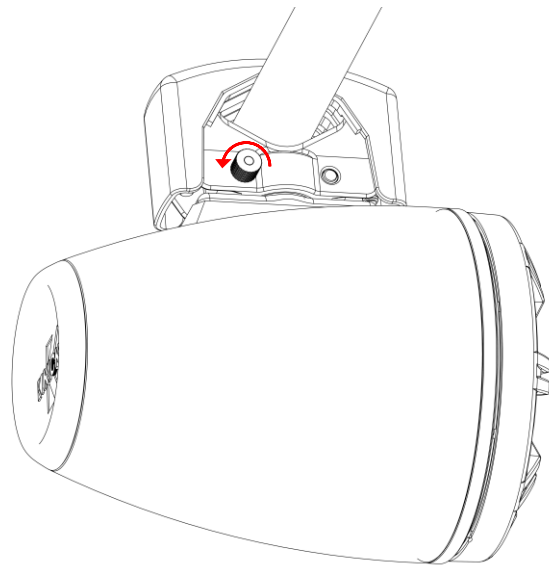
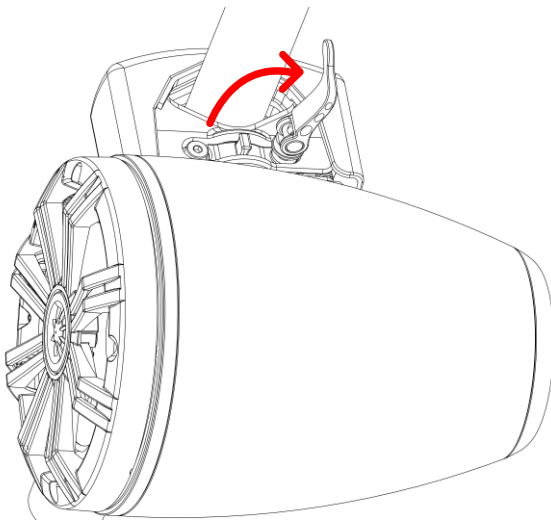



5. While securely holding the enclosure remove the retaining bolt and the lock clamp.

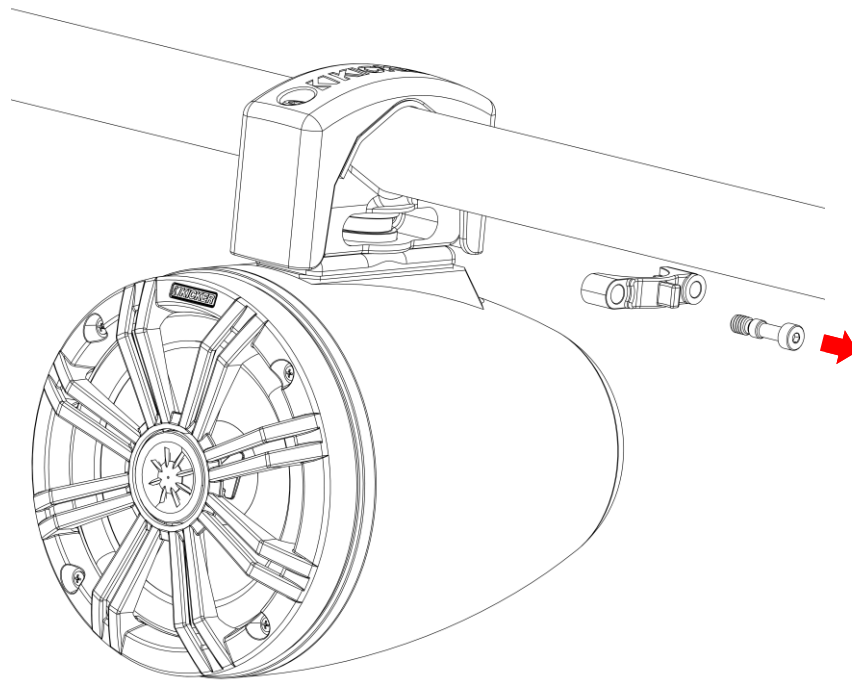

6. Remove the enclosure from the clamp. Gently pull wires back out of the enclosure to original length.

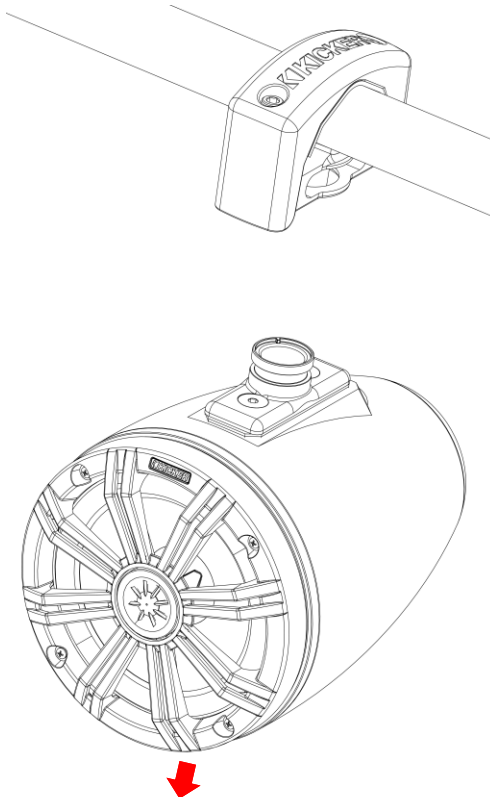



7. Mark the location of the hole in the clamp.

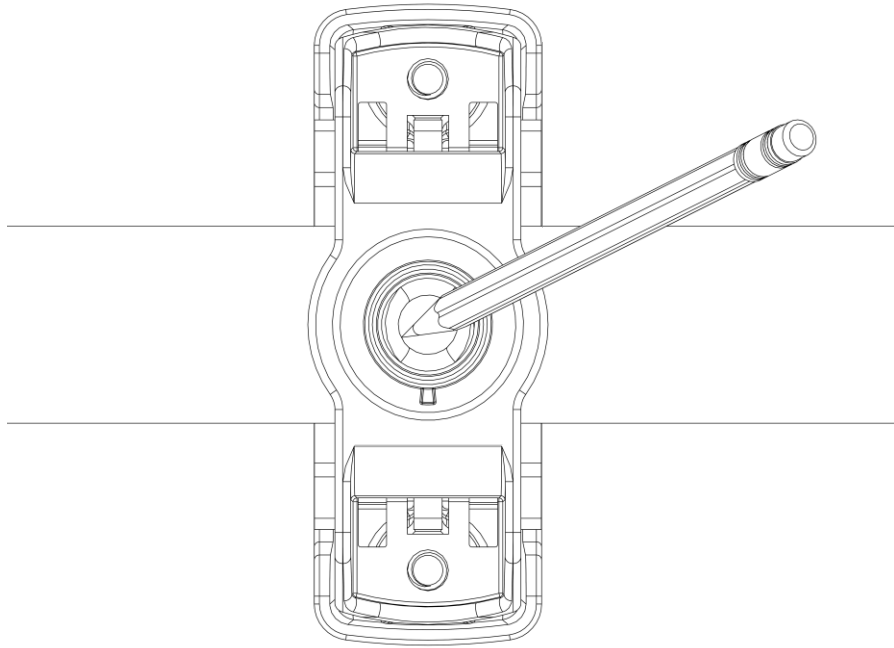

8. Remove the clamp from the tube. Drill a 5/8" hole in the tube where marked.

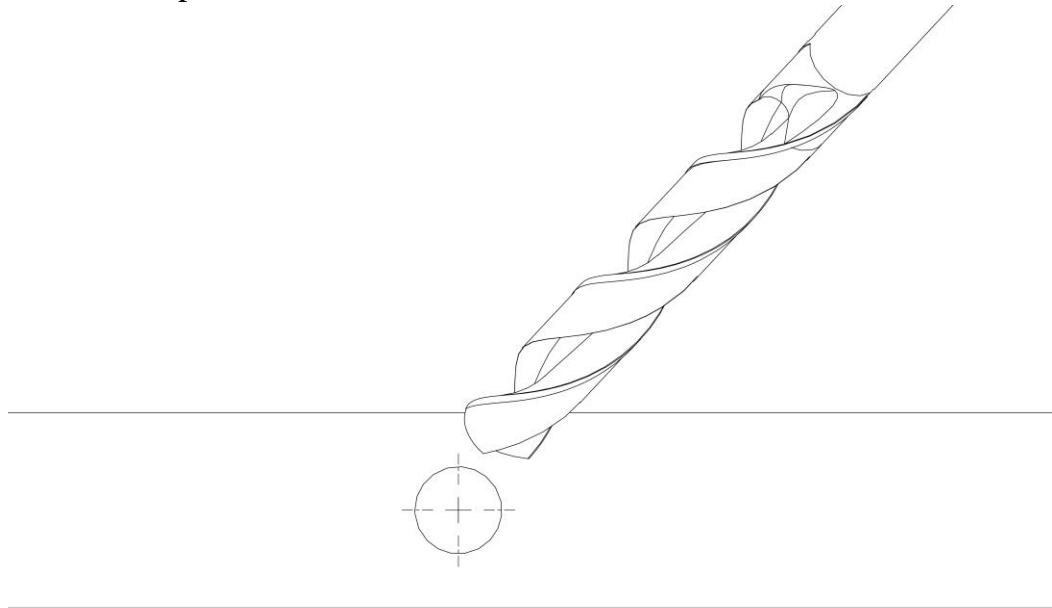



9. Locate clamp on tube so that wire will route through clamp and into hole in tube.

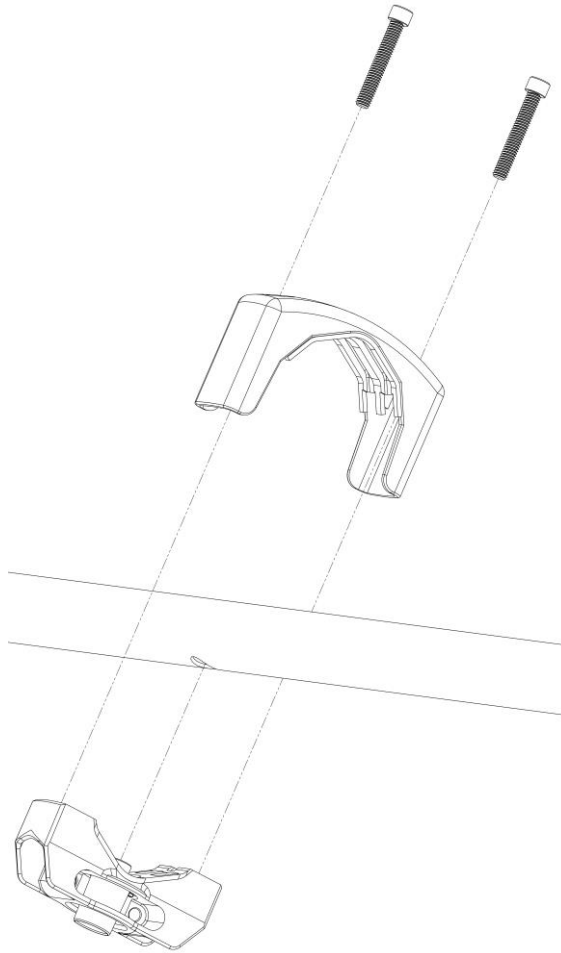

10. Install clamp and torque mounting bolts to 12ft-lbs.

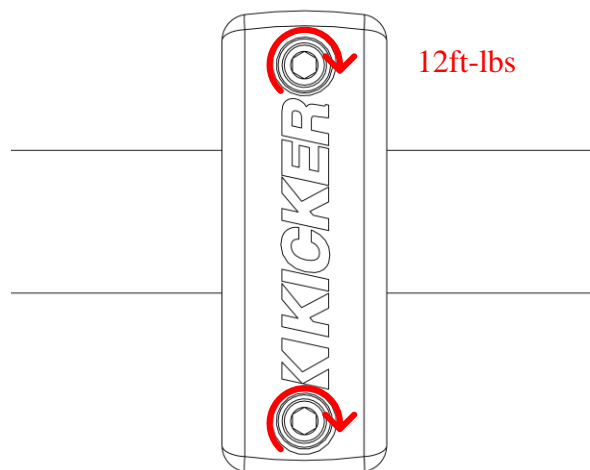



11. Wire the enclosure to the vehicle harness. (See “Wiring the Enclosure” - page 18)
12. Tuck wiring into the tube and engage the enclosure into the clamp.

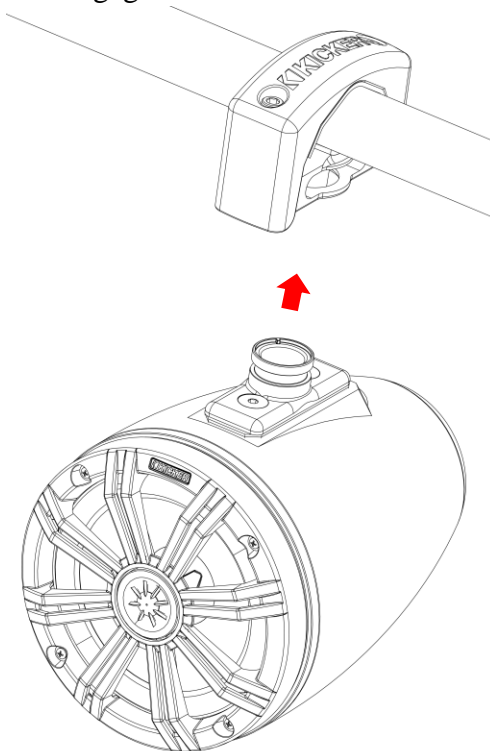

13. Install the lock clamp and retaining bolt.

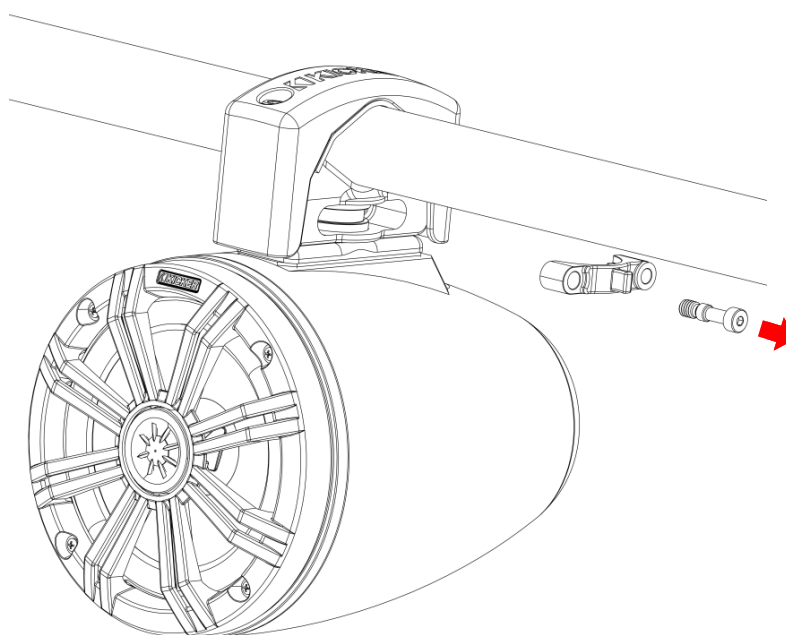



14. Thread the finger nut onto the cam bolt and lock the cam bolt. Repeat this step until enclosure no longer rotates.

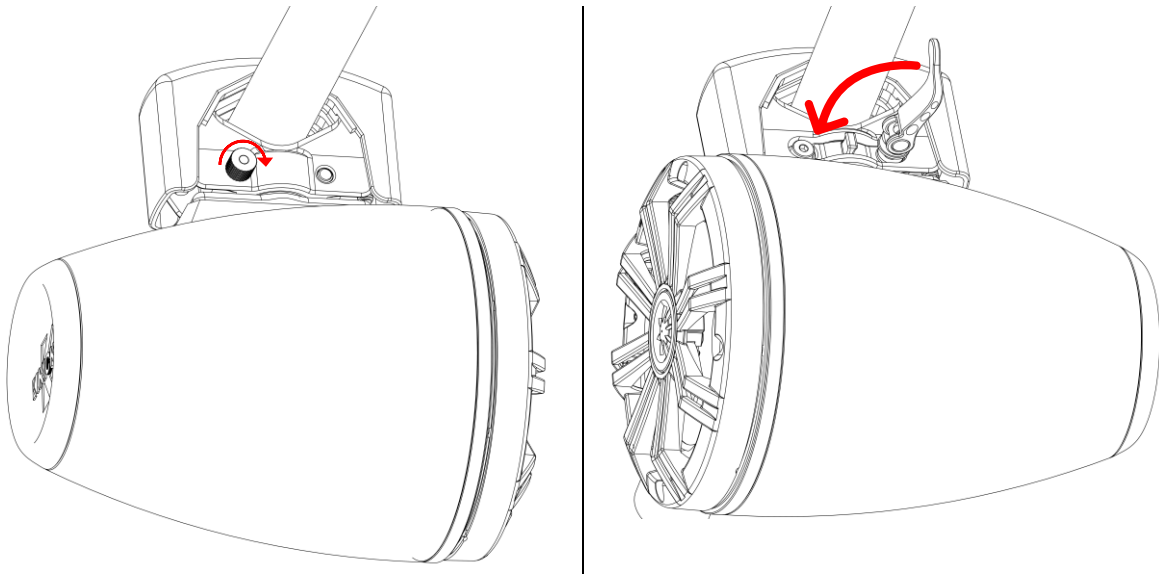



WIRING THE ENCLOSURE

1. Connect the speaker's wide spade terminal to the positive output of the amplifier channel.
2. Connect the speaker's narrow spade terminal to the negative output of the amplifier channel.
3. Connect the black LED wire to the positive terminal of the battery.
 - Place a 2-amp fuse (not included) no further than 7" away from the battery terminal.
 - Place a switch (not included) on the black LED wire between the fuse and the speaker so the LEDs can be turned off.
4. The red, green, and blue wires connect to the negative terminal of the battery. Connect one ground wire, any combination two ground wires, or all three ground wires to illuminate the LED lights a desired color.

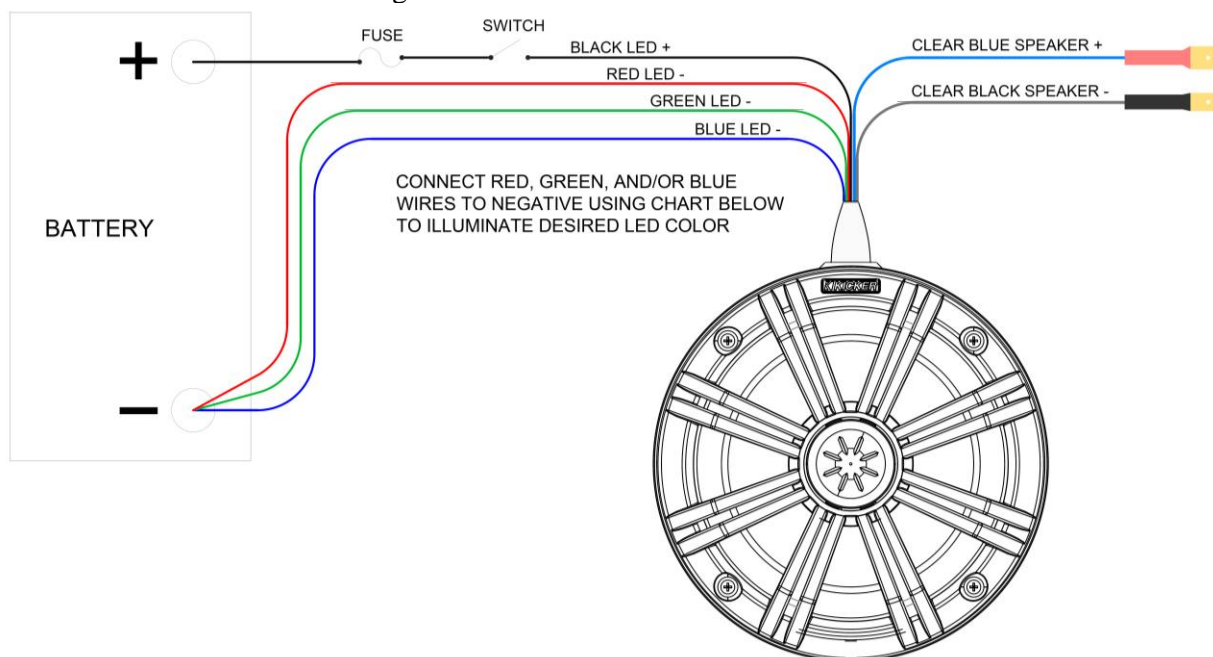

WIRE COLORS CONNECTED TO NEGATIVE	COLOR OF LED
RED	RED
GREEN	GREEN
BLUE	BLUE
RED and GREEN	LIME GREEN
RED and BLUE	MAGENTA
BLUE and GREEN	AQUAMARINE
RED and BLUE and GREEN	BLUE-WHITE

KMTC

***Loaded Marine Cans
Owner's Manual***

KMTC65 | KMTDC65 KMTC8

Manual del Propietario | **Español**
Gabinete de torre KICKER MARINE

Benutzerhandbuch | **Deutsch**
KICKER MARINE Can-Gehäuse

Manuel d'utilisation | **Française**
Boîtiers pour haut-parleurs verticaux
KICKER MARINE

MODEL: KMTC65 | KMTDC65 | KMTC8

Authorized KICKER Dealer: _____

Purchase Date: _____

Serial Number: _____

The KICKER KMTC Loaded Marine Cans are the perfect way to bring your music out into the marine or power sports environment. The KMTC65 and KMTC8 come loaded with the KICKER KM65 and KM8 LED speakers. The injection-molded ABS enclosures are UV treated, splash resistant, and weather resilient. Mount the KMTC Loaded Marine Cans in your boat or get creative with a pair of them in the garage, on your 4x4 or Side-by-Side's roll bars, or in any other bar-mounted application.

Model:	KMTC65	KMTDC65	KMTC8
Rated Impedance [Ω]	4	4	4
Sensitivity [1W, 1m]	90	93	92
Peak Power Handling [Watts]	195	390	300
Continuous Power Handling [Watts RMS]	65	130	150
Enclosure Diameter/Width [in, cm]	7, 17.8	14-1/16, 35.7	8-3/16, 20.8
Enclosure Depth [in, cm]	9-11/16, 24.6	9-11/16, 24.6	11-5/16, 28.7
Enclosure Height (from bottom of roll bar) [in, cm]	8-1/4, 21	8-1/4, 21	9-7/16, 24
Enclosure Height (bracket top to enclosure bottom) [in, cm]	10-1/4, 26	10-1/4, 26	11-1/2, 29.2

INSTALLATION

Step 1: Determine the location and placement of the KMTC cans onto the pipe or tube to which you are mounting. Spreading the KMTC Loaded Marine Cans apart will provide better stereo performance, and is usually preferable. When determining the best locations for mounting, be careful to look for obstacles or obstructions that could complicate mounting the KMTC. Please keep in mind the routing of your speaker wires as this can affect where you finally mount your cans. You will need to mark and drill a wire routing hole in the pipe 5/8" (16mm) in diameter. The placement of the hole must line up with the final position of the lower mounting bracket so that the wiring coming from the lower mounting bracket can be run through; ie the hole should be 90° from the direction the speakers will be aimed and in-line with the wiring coming from the lower mounting bracket. If the speakers will be level with the horizon, you should drill a hole directly in the bottom of the tube.

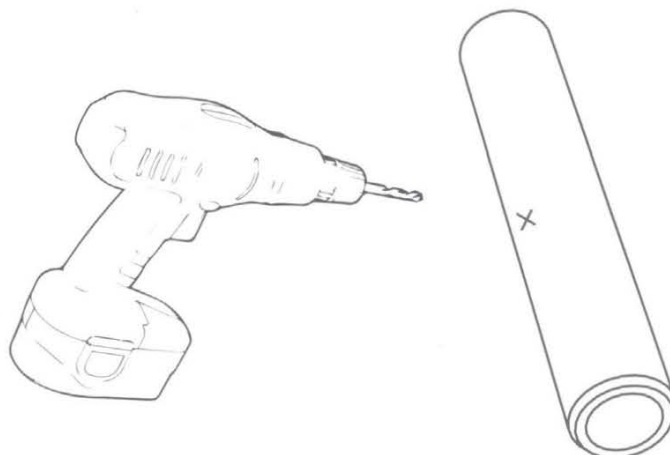

Step 2: Thread the speaker and LED wires through the bottom of the lower mounting bracket and out of the plastic liner hole in the center.

lower mounting bracket

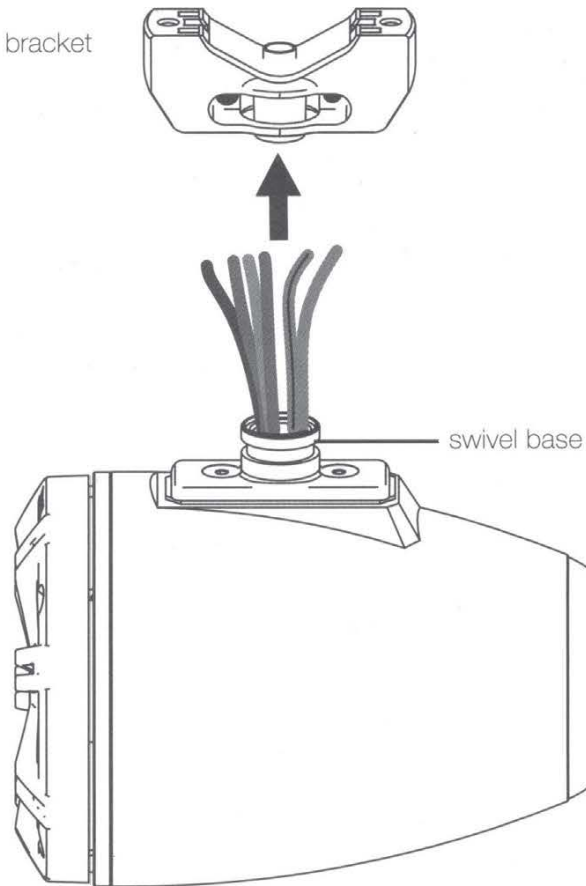

IMPORTANT: You must apply a thin layer of the included anti-seize compound to **ALL** threaded fasteners before installation.

Step 3: The mounting hardware design provides versatility in angular positioning to direct the speaker's output to the ideal listening position using the quick adjust swivel lever. With the lower mounting bracket in place, install the swivel clamp and tightly secure it using the included swivel bolt, making sure the clamp engages with the groove in the swivel base.

lower mounting bracket

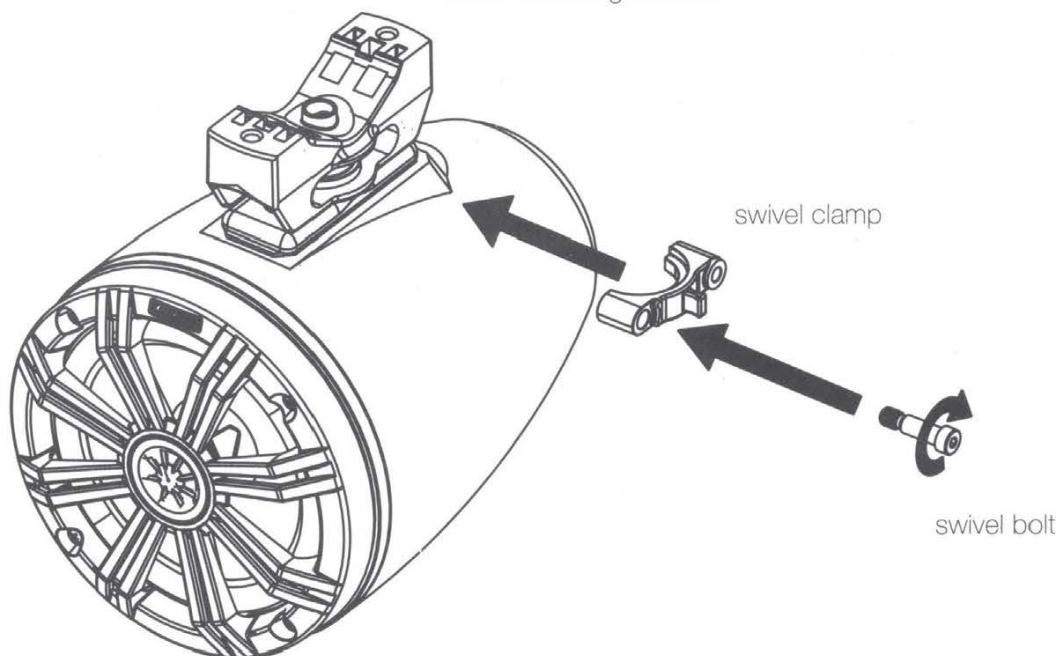

Step 4: Partially install the swivel lever, adjusting it to be loose (open) when the lever is parallel to the tube, then finish tightly securing the swivel lever to the enclosure using the included thumbscrew. When the swivel lever is locked in place, or closed, the bracket rotation assembly will be clamped tight.

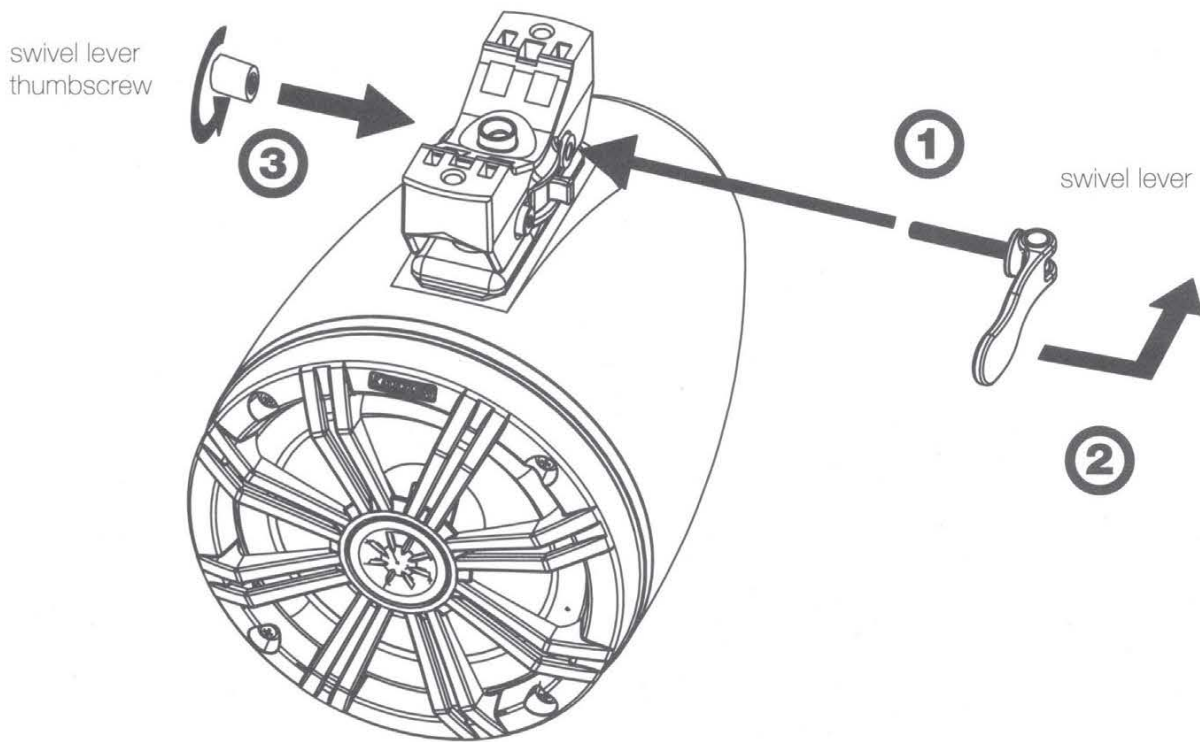

Step 5: Extend the speaker and LED wiring through the hole you have drilled and connect them to your source unit or amplifier. KICKER recommends you solder the connections and secure them with heat shrink.

When hard-wiring the RGB lighting, the black lead is +12V and the red, green, and blue leads are ground. Splice and combine the ground wires to yield a different color. There are seven colors available, depending on your wiring configuration. KICKER recommends using the KMLC lighting controller (sold separately) for more colors, patterns, and special effects.

Black : +12V
Red : Ground
Green : Ground
Blue : Ground
Transparent Blue : Speaker +
Transparent Gray : Speaker -

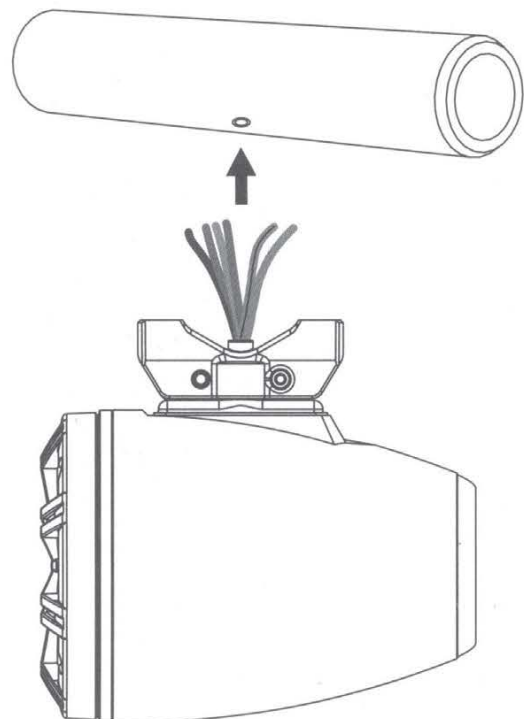

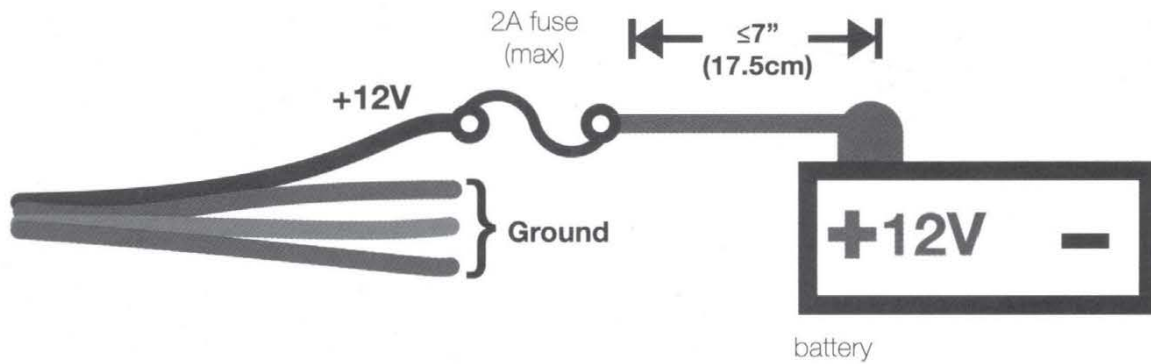

Step 6: Secure the enclosure to the tower tube with the upper and lower mounting brackets. With the wiring clearance hole you drilled and the wiring shroud on the lower mounting bracket lined up, position the enclosure assembly so that it is tightly against the tower tube. Once in position, install the upper mounting bracket using the included stainless steel socket-head cap screws. You will need to choose the appropriate length fastener based on the size of the tower tube to which you're mounting. Ensure the enclosure is secure by increasing the tension of the swivel lever thumbscrew attached to the swivel lever.

With the enclosure securely mounted, you may finish by opening the swivel lever and swiveling the assembly left or right. When you are satisfied with the orientation, close the swivel lever to lock the enclosure in place. If the enclosure is not locked tightly enough, tighten the thumbscrew.

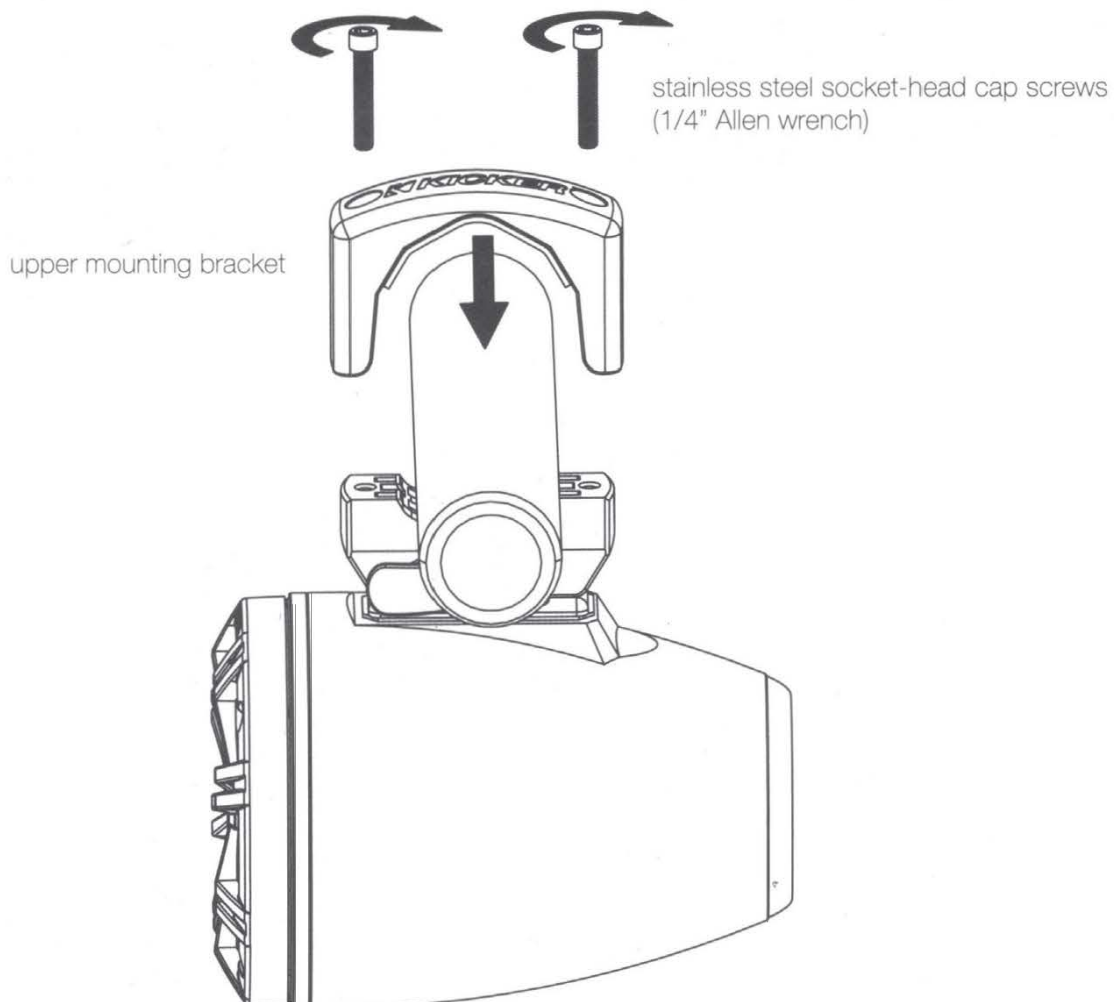

ACOUSTICS LIMITED WARRANTY

When purchased from an Authorized KICKER Dealer, KICKER warrants this product to be free from defects in material and workmanship under normal use for a period of ONE (1) YEAR from date of original purchase. If this product is identified as "Refurbished" or "B Goods", the warranty is limited to a period of THREE (3) MONTHS from date of original purchase. In all cases you must have the original receipt. Should service be necessary under this warranty for any reason due to manufacturing defect or malfunction during the warranty period, KICKER will repair or replace (at its discretion) the defective merchandise with equivalent merchandise. Warranty replacements may have cosmetic scratches and blemishes. Discontinued products may be replaced with more current equivalent products. This warranty is valid only for the original purchaser and is not extended to owners of the product subsequent to the original purchaser. Any applicable implied warranties are limited in duration to a period of the express warranty as provided herein beginning with the date of the original purchase at retail, and no warranties, whether express or implied, shall apply to this product thereafter. Some states do not allow limitations on implied warranties; therefore, these exclusions may not apply to you. This warranty gives you specific legal rights; however you may have other rights that vary from state to state.

WHAT TO DO IF YOU NEED WARRANTY OR SERVICE:

Defective merchandise should be returned to your local Authorized Stillwater Designs (KICKER) Dealer for warranty service. Assistance in locating an Authorized Dealer can be found at www.kicker.com or by contacting Stillwater Designs directly. You can confirm that a dealer is authorized by asking to see a current authorized dealer window decal.

If it becomes necessary for you to return defective merchandise directly to Stillwater Designs (KICKER), call the KICKER Customer Service Department at (405) 624-8510 for a Return Merchandise Authorization (RMA) number. Package only the defective items in a package that will prevent shipping damage, and return to:

Stillwater Designs, 3100 North Husband St, Stillwater, OK 74075

The RMA number must be clearly marked on the outside of the package. Please return only defective component systems. The return of functioning items increases your return freight charges. Non-defective items will be returned freight collect to you. For example, if a subwoofer is defective, only return the defective subwoofer, not the entire enclosure. Include a copy of the original receipt with the purchase date clearly visible, and a "proof-of-purchase" statement listing the Customer's name, Dealer's name and invoice number, and product purchased. Warranty expiration on items without proof-of-purchase will be determined from the type of sale and manufacturing date code. Freight must be prepaid; items sent freight-collect, or COD, will be refused.

WHAT IS NOT COVERED?

This warranty is valid only if the product is used for the purpose for which it was designed. It does not cover:

- o Damage due to improper installation
- o Subsequent damage to other components
- o Damage caused by exposure to moisture, excessive heat, chemical cleaners, and/or UV radiation
- o Damage through negligence, misuse, accident or abuse. Repeated returns for the same damage may be considered abuse
- o Any cost or expense related to the removal or reinstallation of product
- o Speakers damaged due to amplifier clipping or distortion
- o Items previously repaired or modified by any unauthorized repair facility
- o Return shipping on non-defective items
- o Products with tampered or missing barcode labels
- o Products with tampered or missing serial numbers
- o Products returned without a Return Merchandise Authorization (RMA) number
- o Products purchased from an UNAUTHORIZED dealer
- o Freight Damage
- o The cost of shipping product to KICKER
- o Service performed by anyone other than KICKER



HOW LONG WILL IT TAKE?

KICKER strives to maintain a goal of one-week service for all acoustics (subwoofers, midrange drivers, tweeters, crossovers, etc) returns. Delays may be incurred if lack of replacement inventory or parts is encountered. Failure to follow these steps may void your warranty. Any questions can be directed to the KICKER Customer Service Department at (405) 624-8510. Contact your International KICKER dealer or distributor concerning specific procedures for your country's warranty policies.

Note: All specifications and performance figures are subject to change. Please visit **www.kicker.com** for the most current information.

INTERNATIONAL WARRANTY

Contact your International KICKER dealer or distributor concerning specific procedures for your country's warranty policies.

Our goods come with guarantees that cannot be excluded under the **Australian Consumer Law**. You are entitled to a replacement or refund for a major failure and for compensation for any other reasonably foreseeable loss or damage. You are also entitled to have the goods repaired or replaced if the goods fail to be of acceptable quality and the failure does not amount to a major failure.

WARNING: KICKER products are capable of producing sound levels that can permanently damage your hearing! Turning up a system to a level that has audible distortion is more damaging to your ears than listening to an undistorted system at the same volume level. The threshold of pain is always an indicator that the sound level is too loud and may permanently damage your hearing. Please use common sense when controlling volume.

GARANTÍA INTERNACIONAL

Versión Español

Comuníquese con su concesionario o distribuidor KICKER internacional para obtener información sobre procedimientos específicos relacionados con las normas de garantía de su país.

ADVERTENCIA: Los excitadores KICKER son capaces de producir niveles de sonido que pueden dañar permanentemente el oído. Subir el volumen del sistema hasta un nivel que produzca distorsión es más dañino para el oído que escuchar un sistema sin distorsión al mismo volumen. El dolor es siempre una indicación de que el sonido es muy fuerte y que puede dañar permanentemente el oído. Sea precavido cuando controle el volumen.

La frase "combustible para vivir la vida Livin' Loud™ a todo volumen" se refiere al entusiasmo por la vida que la marca KICKER de estéreos de automóvil representa y a la recomendación a nuestros clientes de que vivan lo mejor posible ("a todo volumen") en todo sentido. La línea de altavoces y amplificadores KICKER es la mejor del mercado de audio de automóviles y por lo tanto representa el "combustible" para vivir a todo volumen en el área de "estéreos de automóvil" de la vida de nuestros clientes. Recomendamos a todos nuestros clientes que obedezcan todas las reglas y reglamentos locales sobre ruido en cuanto a los niveles legales y apropiados de audición fuera del vehículo.

INTERNATIONALE GARANTIE

Deutsche Version

Nehmen Sie mit Ihren internationalen KICKER-Fachhändler oder Vertrieb Kontakt auf, um Details über die Garantieleistungen in Ihrem Land zu erfahren.

WARNUNG: KICKER-Treiber können einen Schallpegel erzeugen, der zu permanenten Gehörschäden führen kann! Wenn Sie ein System auf einen Pegel stellen, der hörbare Verzerrungen erzeugt, schadet das Ihren Ohren mehr, als ein nicht verzerrtes System auf dem gleichen Lautstärkepegel. Die Schmerzschwelle ist immer eine Anzeige dafür, dass der Schallpegel zu laut ist und zu permanenten Gehörschäden führen kann. Seien Sie bei der Lautstärkeeinstellung bitte vernünftig!

Der Slogan "Treibstoff für Livin' Loud" bezieht sich auf die mit den KICKER-Autostereosystemen assoziierte Lebensfreude und die Tatsache, dass wir unsere Kunden ermutigen, in allen Aspekten ihres Lebens nach dem Besten ("Livin' Loud") zu streben. Die Lautsprecher und Verstärker von KICKER sind auf dem Markt für Auto-Soundsysteme führend und stellen somit den "Treibstoff" für das Autostereoerlebnis unserer Kunden dar. Wir empfehlen allen unseren Kunden, sich bezüglich der zugelassenen und passenden Lautstärkepegel außerhalb des Autos an die örtlichen Lärmvorschriften zu halten.

GARANTIE INTERNATIONALE

Versión Française

Pour connaître les procédures propres à la politique de garantie de votre pays, contactez votre revendeur ou distributeur International KICKER.

AVERTISSEMENT: Les haut-parleurs KICKER ont la capacité de produire des niveaux sonores pouvant endommager l'ouïe de façon irréversible ! L'augmentation du volume d'un système jusqu'à un niveau présentant une distorsion audible endommage davantage l'ouïe que l'écoute d'un système sans distorsion au même volume. Le seuil de la douleur est toujours le signe que le niveau sonore est trop élevé et risque d'endommager l'ouïe de façon irréversible. Réglez le volume en faisant preuve de bon sens!

L'expression "carburant pour vivre plein pot" fait référence au dynamisme de la marque KICKER d'équipements audio pour véhicules et a pour but d'encourager nos clients à faire le maximum ("vivre plein pot") dans tous les aspects de leur vie. Les haut-parleurs et amplificateurs KICKER sont les meilleurs dans le domaine des équipements audio et représentent donc pour nos clients le "carburant pour vivre plein pot" dans l'aspect "installation audio de véhicule" de leur vie. Nous encourageons tous nos clients à respecter toutes les lois et réglementations locales relatives aux niveaux sonores acceptables à l'extérieur des véhicules.

