

LPH Harness Instruction Guide

**L.O.C PRO
ADVANCED**

Wiring Connection Chart (All Models)

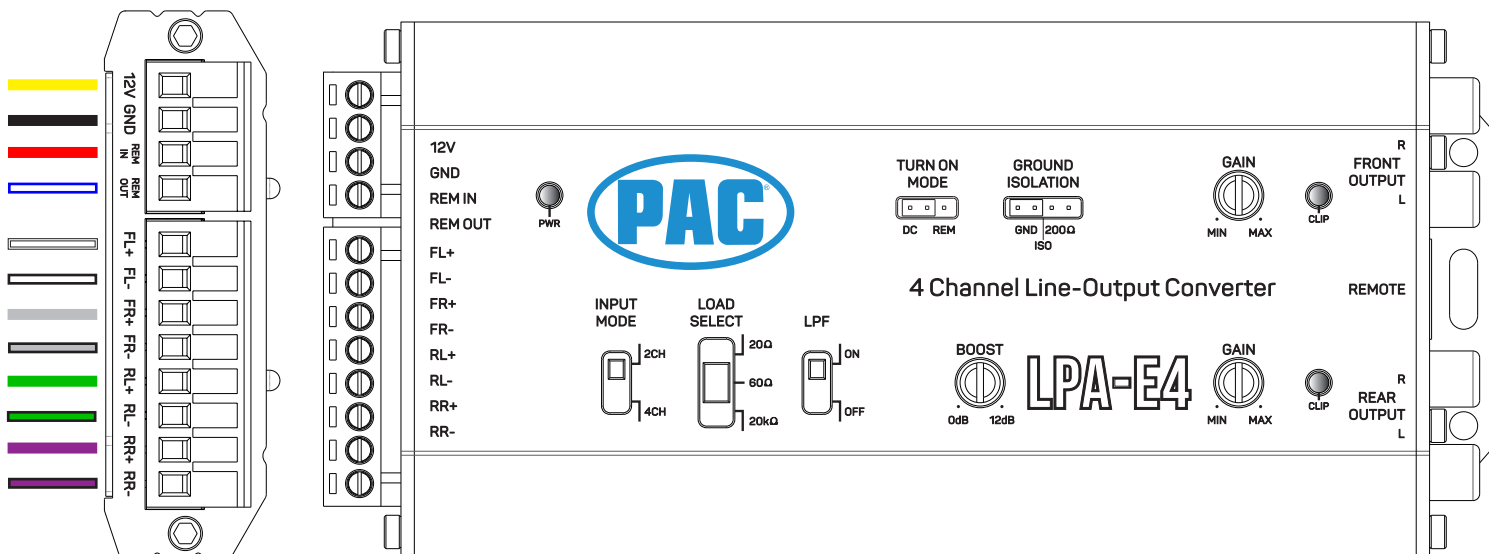

MODELS:

- LPA-E4
- LPA2.4 / LPA2.2
- LPA1.4 / LPA1.2

Important Note: This harness is provided with a inline fuse installed. Please remove prior to install and reinsert once finished.

If your vehicle does not provide ACC source your harness will not have a "RED" wire to connect.

It will use DC Offset to turn on as well as trigger the "REM OUT" on the LPA. On LPA-E4 there will be a jumper that you can move based on your application.

This harness is designed to work on **OEM NON-AMPLIFIED** systems.

Connect the RED BUTT Connector to the aftermarket system turn on for your amplifiers.

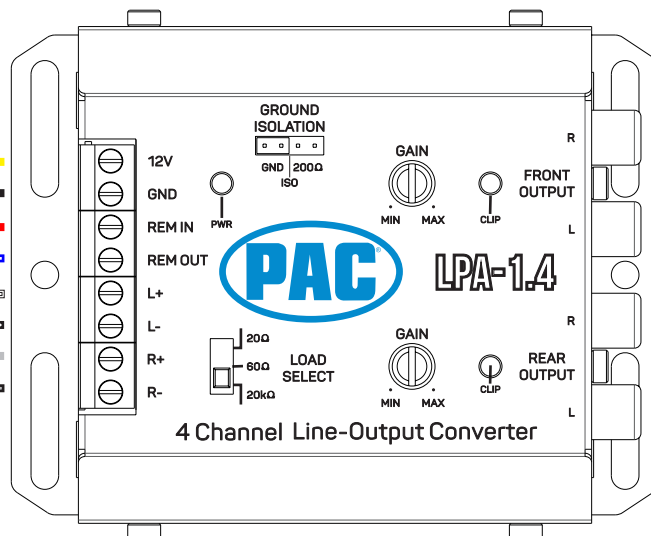
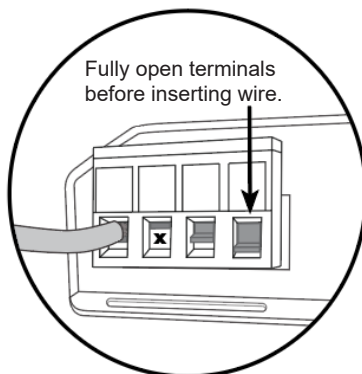
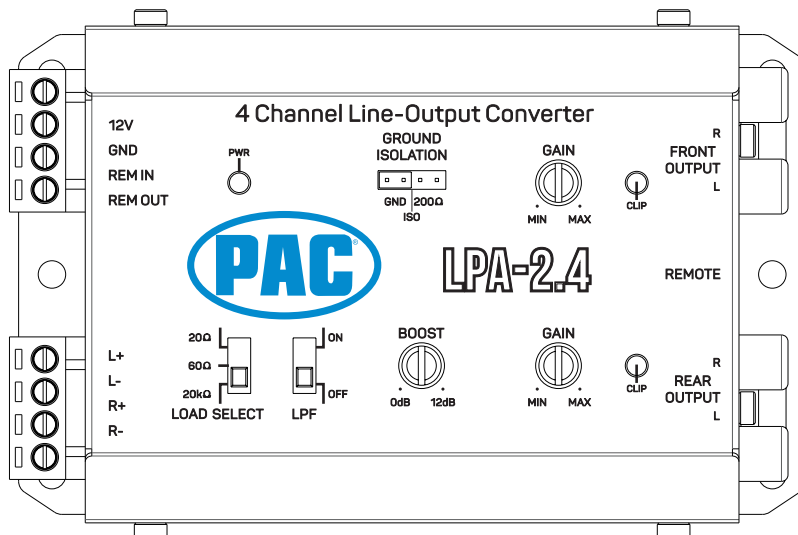
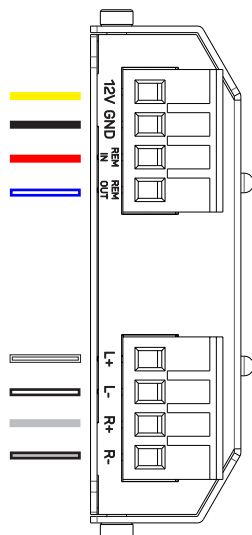

LPH Harness Instruction Guide

**L.O.C PRO
ADVANCED**

Example Installation - 4-Channel Amplifier - (HARNESS CUT REQUIRED)

- Cut the harness close as possible to the "CUT HERE AND INSULATE" label. You must insulate wires to prevent damage to OEM radio.
- The cut speaker wires will need to be connected to your aftermarket amplifier. (REFER TO LABEL ON HARNESS)
- Please refer to the chart on the first page for wiring your loose wires to your LPA.
- This harness is designed to work on **OEM NON-AMPLIFIED** systems.

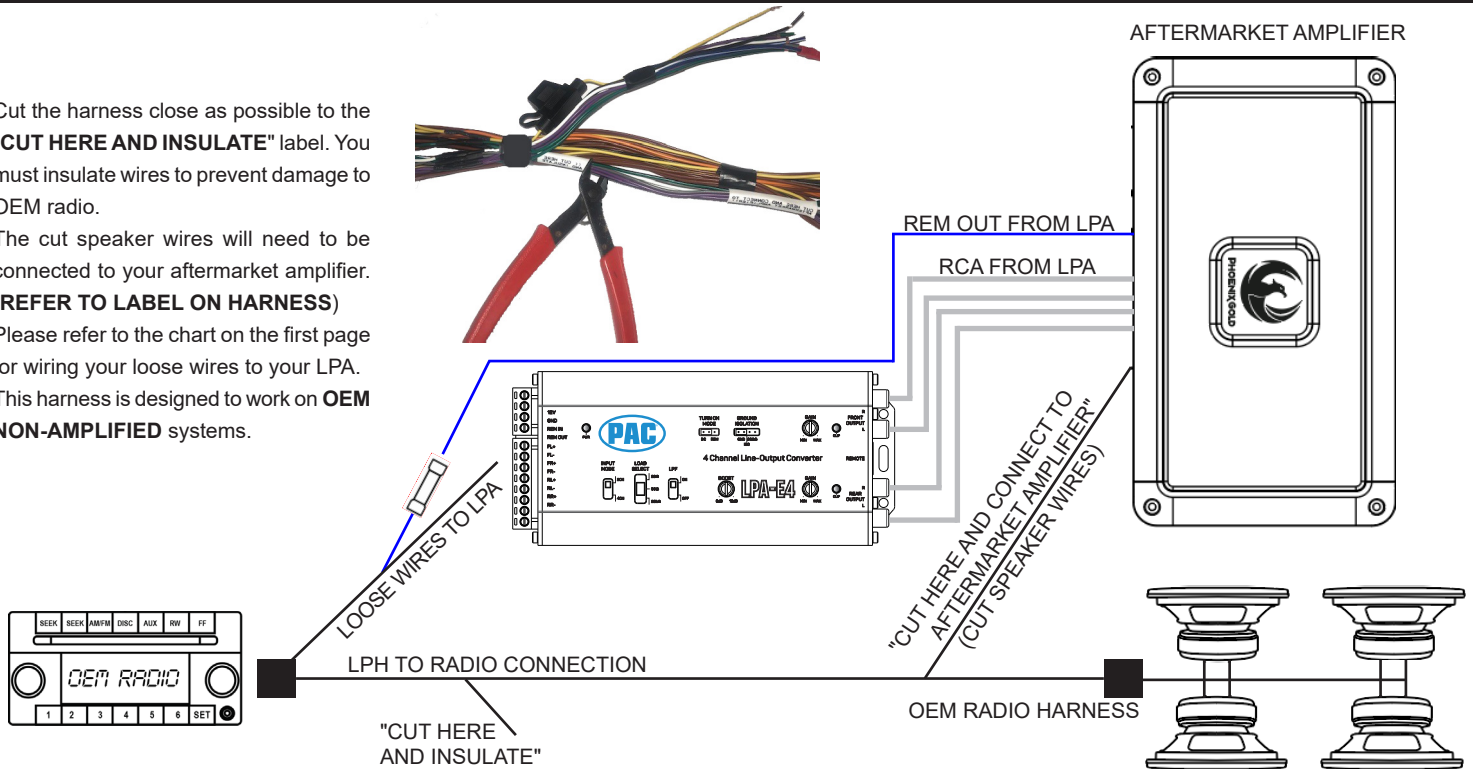

Example Installation - Mono Amplifier - (HARNESS CUT NOT REQUIRED)

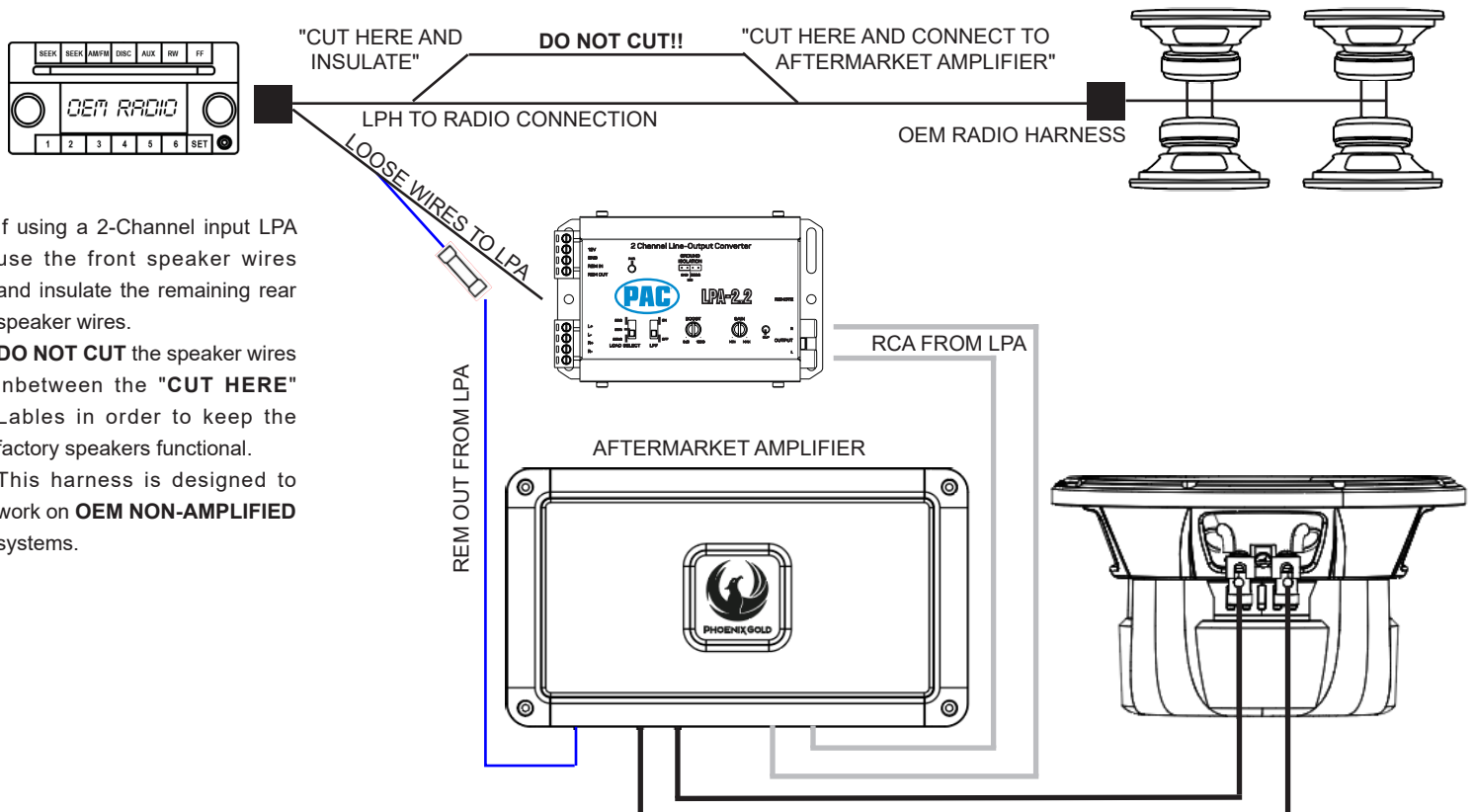

- If using a 2-Channel input LPA use the front speaker wires and insulate the remaining rear speaker wires.
- **DO NOT CUT** the speaker wires inbetween the "CUT HERE" Labels in order to keep the factory speakers functional.
- This harness is designed to work on **OEM NON-AMPLIFIED** systems.



ANC vs Amplifier

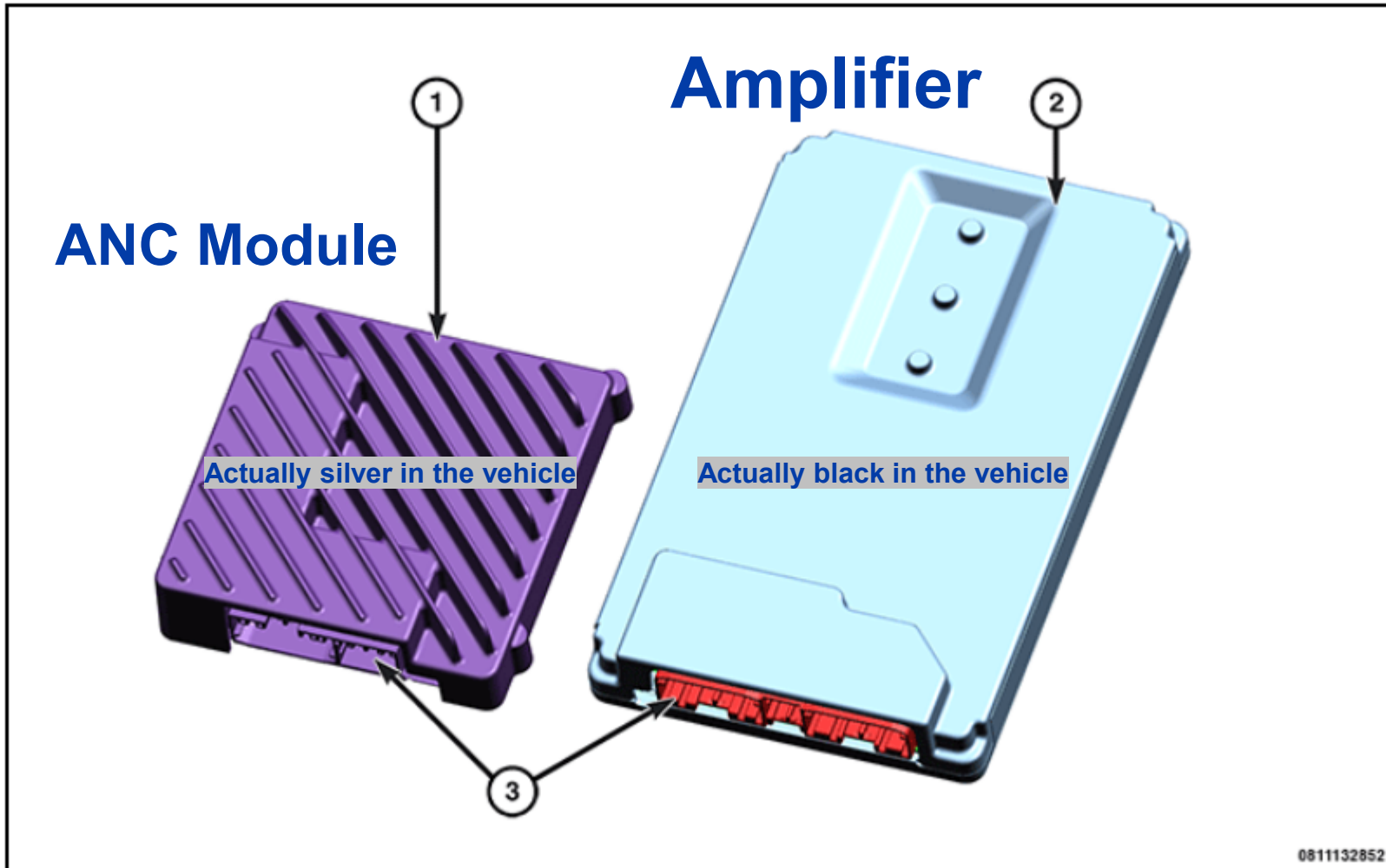

- **Amp is larger/Black**
- **ANC is small/Silver**
- **Amp has 3 plugs**
- **ANC has 2 plugs**

ANC / Amp Location 2019+ RAM 1500

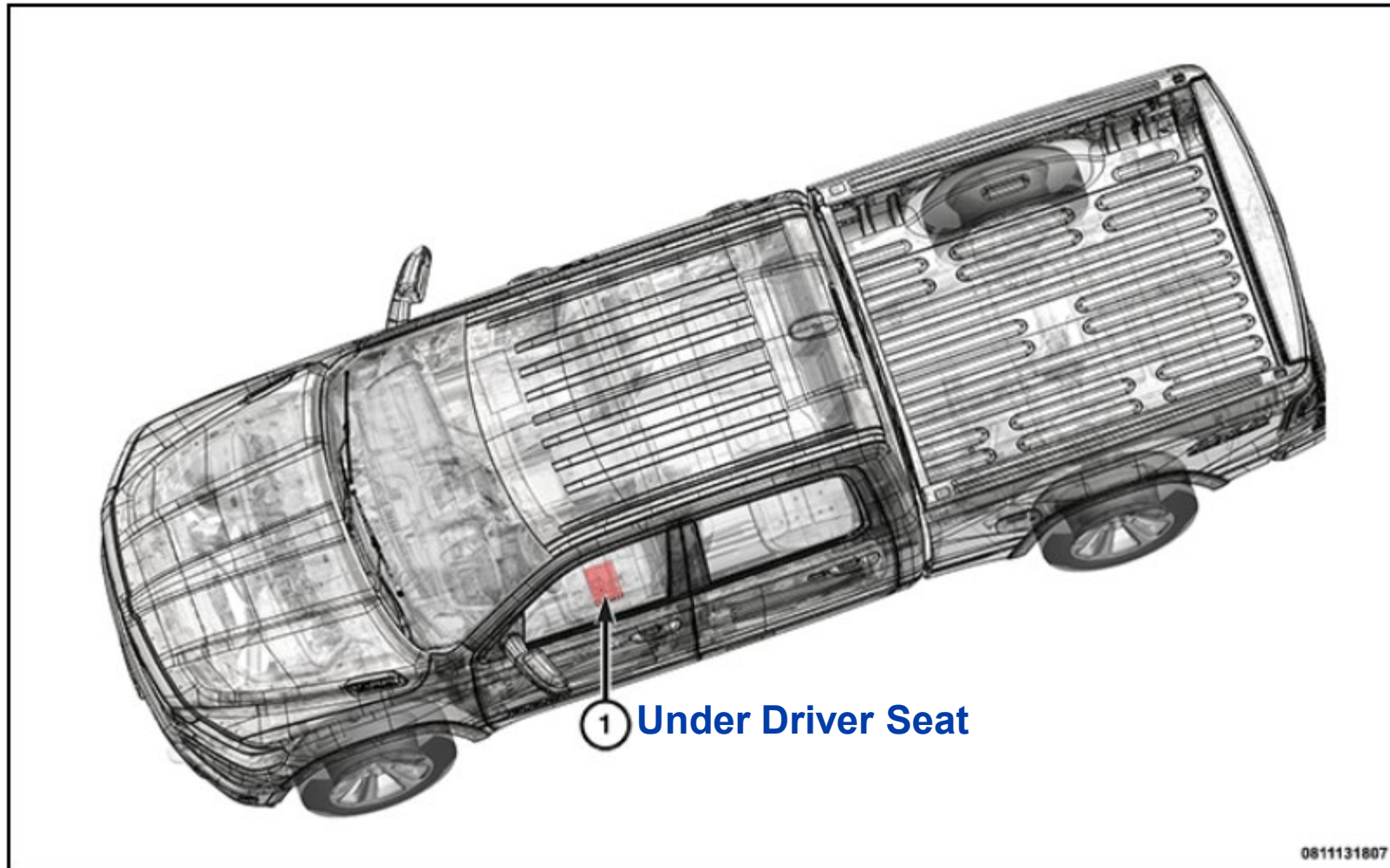

ANC / Amp Location 2019+ RAM 2500/3500

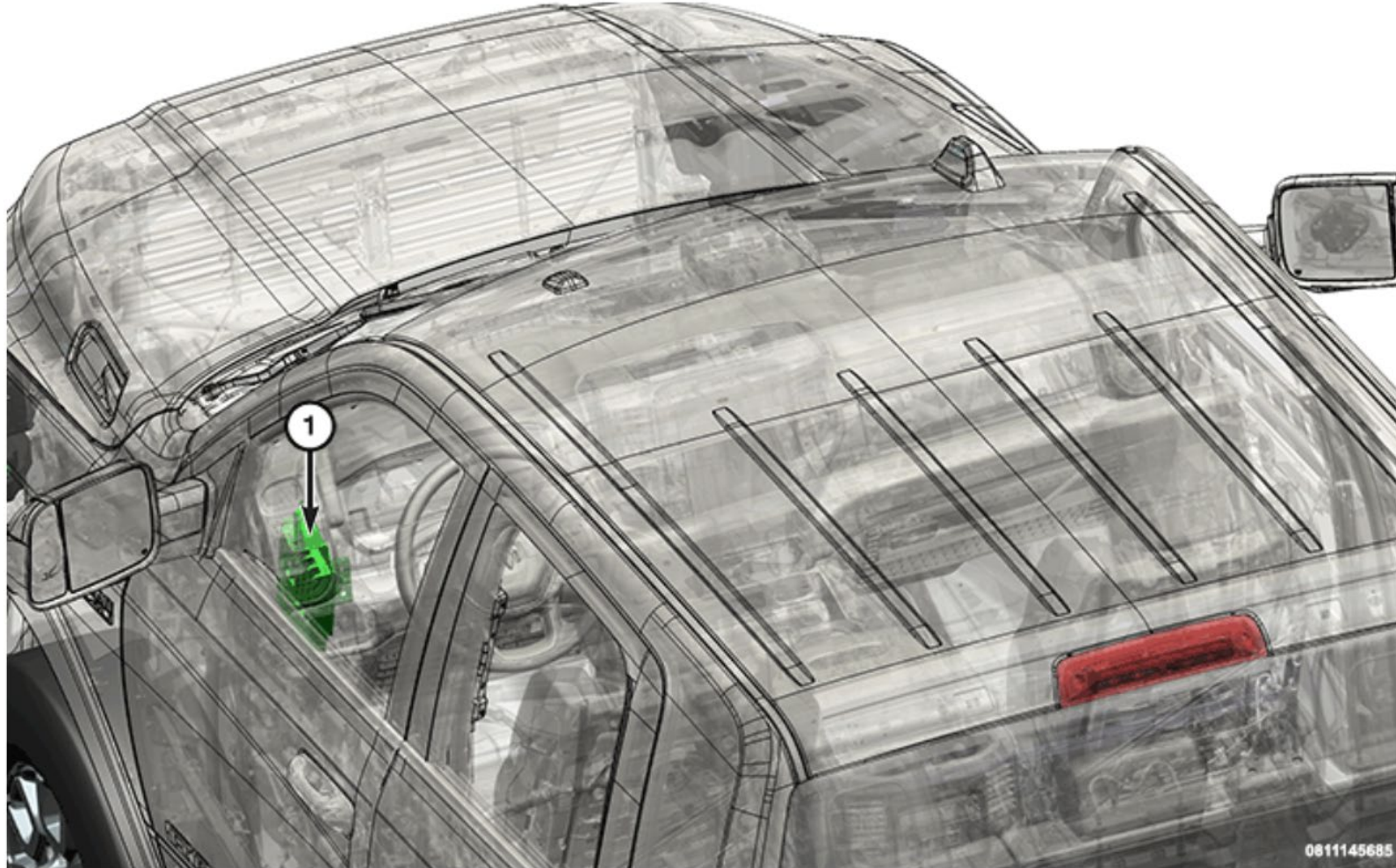

Under Driver Dash

ANC / Amp Location Jeep Cherokee

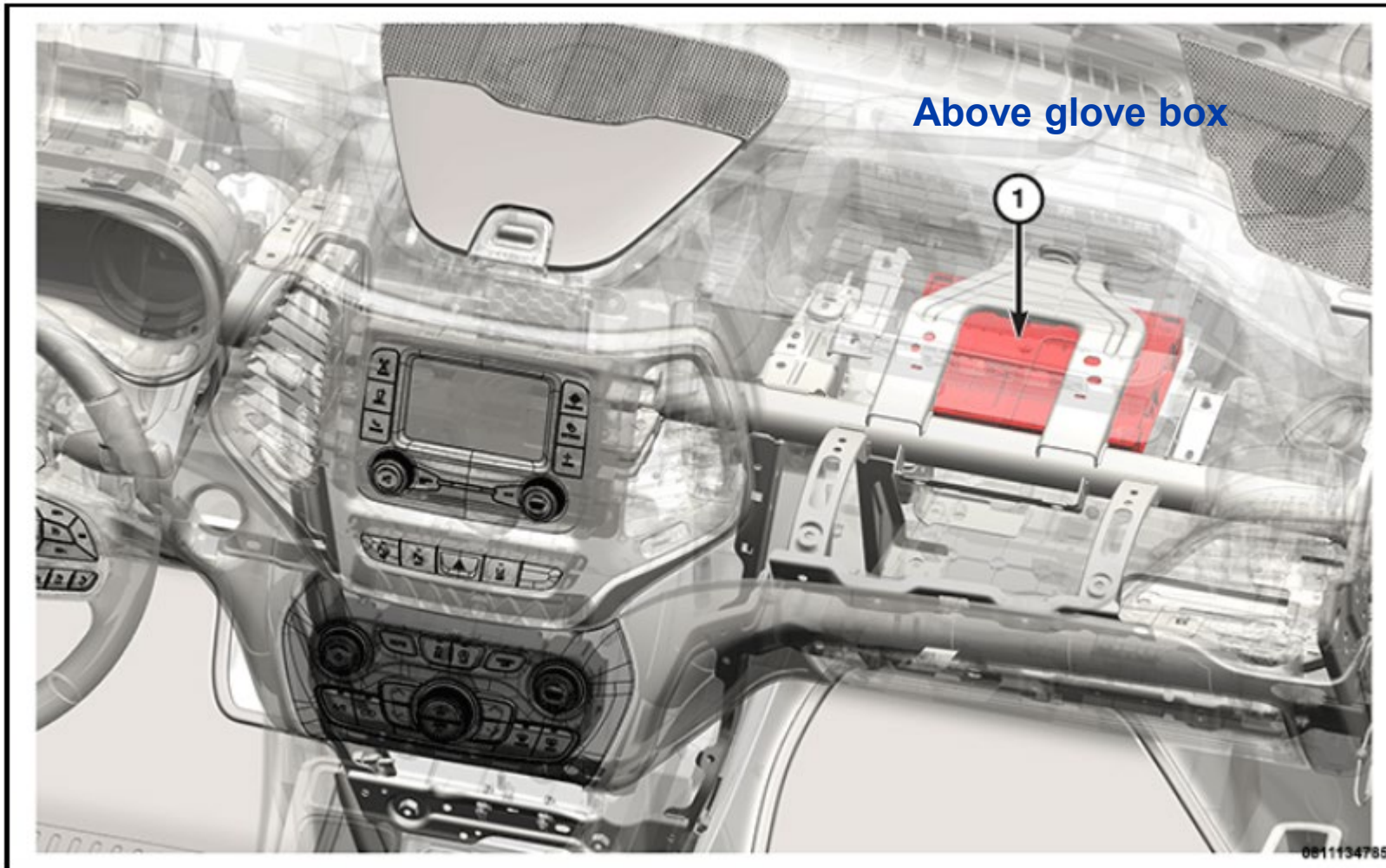

ANC / Amp Location Chrysler Pacifica

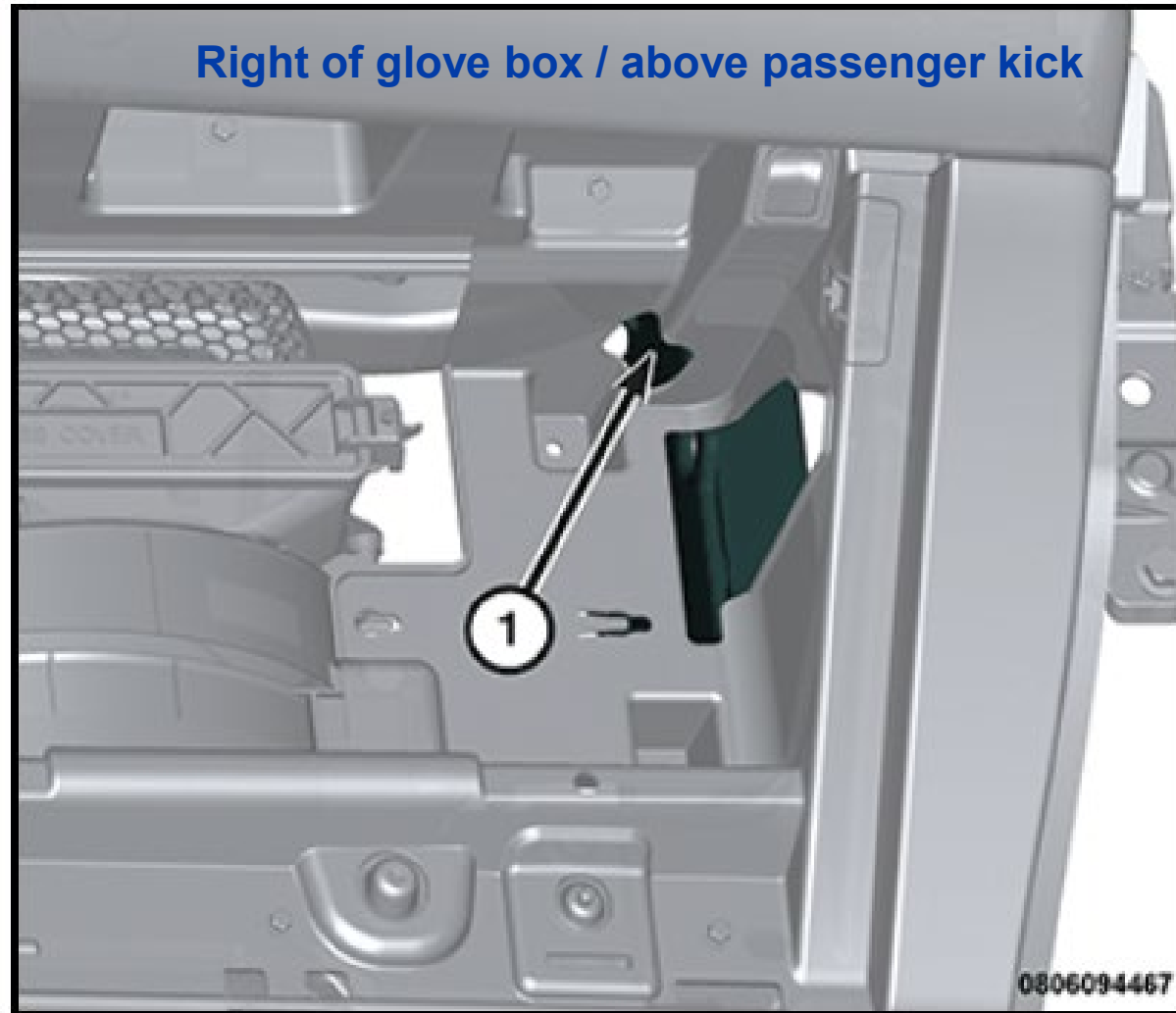

ANC Location 2015-2016 Grand Cherokee

Behind Right Quarter Trim Panel

