

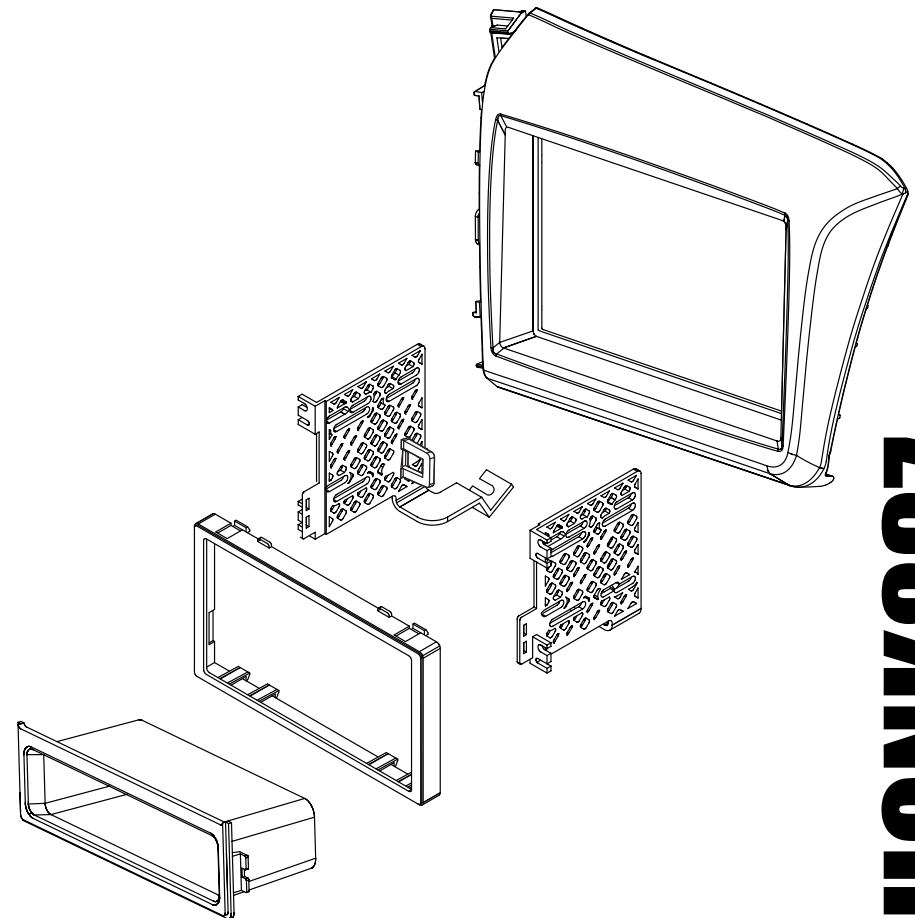

**American
International**
Car Stereo Installation Kits & Accessories



HONK837 Mounting Kit



www.bestkits.com www.aampglobal.com www.aius.net

2500 East Francis Street Ontario, CA 91761, U.S.A.

Sales: (800) 477-2267

Intl: (727) 572-9255

Support: 888-228-5560

VEHICLE APPLICATION

Honda

2012 CIVIC

DASH DISASSEMBLY INSTRUCTIONS

1. Remove small cover located under the HVAC (2 screws).
2. Remove the 2 screws holding the factory radio mounting brackets.
3. Carefully remove the factory dash panel located above the instrument cluster, far enough to allow the factory radio to be removed.
4. Remove the factory radio.

KIT PREPARATION

1. Attach the metal panel fastener clips (included with kit) (5) to each mounting tab on the back side of the main panel.
2. Remove the 4 tabs shown (shaded) below from the trim ring.

Figure A

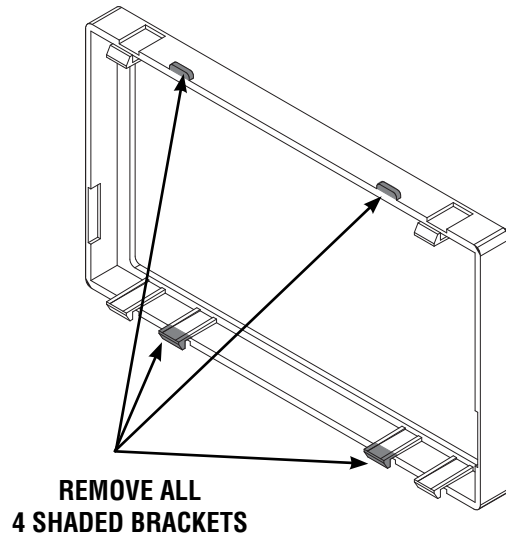

SINGLE ISO INSTALLATION INSTRUCTIONS

1. Insert pocket into lower section of kit from rear & lock into slots of mounting brackets.
2. Insert trim into the main frame.
3. Install brackets to rear of main frame (Do Not Overtighten) using 4 screws supplied
4. Insert ISO mountable radio between ISO mount brackets and loosely attach to sides of radio using screws provided with radio when possible or screws supplied with kit.
5. Slide radio forward or backward for desired look and tighten screws.
6. Install clips provided with kit to lower bracket location. Once kit is installed use the 5/8 screws also provided with the kit to securely mount the brackets to the sub-dash (Suggested).

Figure B

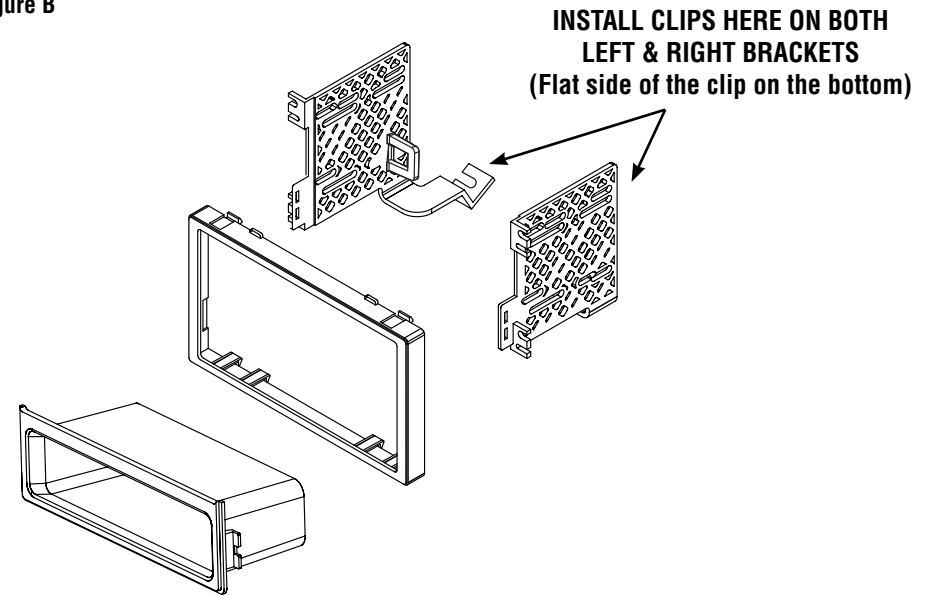

DOUBLE DIN INSTALLATION INSTRUCTIONS

1. Insert trim into the main frame.
2. Install brackets to rear of main frame (Do Not Overtighten) using 4 screws supplied
3. Insert ISO mountable radio between ISO mount brackets and loosely attach to sides of radio using screws provided with radio when possible or screws supplied with kit.
4. Slide radio forward or backward for desired look and tighten screws.
5. Install clips provided with kit to lower bracket location. Once kit is installed use the 5/8 screws also provided with the kit to securely mount the brackets to the sub-dash (Suggested).

Figure C

