



## BR-DS10U

2021-Up Ford Bronco  
Subwoofer Enclosure, 10" - Unloaded

### WARRANTY INFORMATION:

All SSV Works enclosures are covered by a limited lifetime warranty against defects in material or workmanship. All SSV Works Electronics are covered by a limited 1 year warranty against defects in material or workmanship. All SSV Works Speakers are covered by a limited 1 year warranty against defects in material or workmanship. Labor for replacement of defective components is not covered. Contact SSV Works for further warranty information.



Please read and understand these instructions completely before installation to avoid possible injury, or damage to the accessory or vehicle.



# BRONCO SUB WOOFER ENCLOSURE PARTS LIST

## PARTS LIST IMAGES



Bronco Sub Enclosure



Body Bracket, 4-Door, Soft Top [B-MB3145]



Body Bracket, 4-Door, Hard Top [B-MB3144]



Spacer [B-MB3143]



Upper Housing Bracket [B-MB3141]



Lower Housing Bracket [B-MB3142]

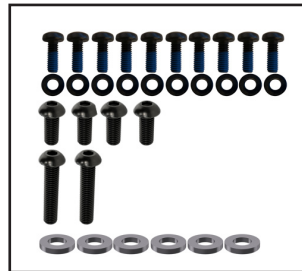

Hardware Pack [B-HP3146]



Hardware Pack, #7x1.25" (x8) [B-HP#7-8]

# BRONCO SUBWOOFER ENCLOSURE ASSEMBLY

## TOOLS NEEDED FOR INSTALLATION

- T30 Torx Wrench

- Phillips Screw Driver

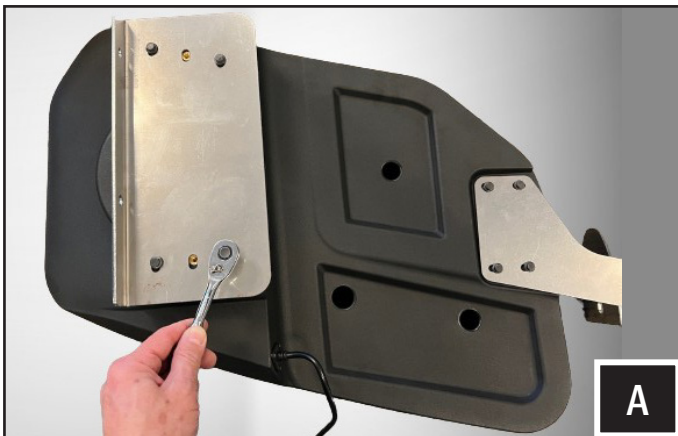

A. Attach the upper and lower housing brackets to the subwoofer enclosure using (10) M6x1x16mm screws and washers.



B. Install the subwoofer and grill using (18) #7x1.25" screws included in the kit. Note that the subwoofer enclosure is mounted in the vehicle vertically. Align the subwoofer and grill logo accordingly.



# BRONCO SUBWOOFER ENCLOSURE INSTALLATION

## TOOLS NEEDED FOR INSTALLATION

- 5mm Hex Driver

- 13mm & 15mm Socket Wrench



A. Working at the driver side cargo space, remove the plastic panel under the window. Plastic panel will not be used and should be set aside.

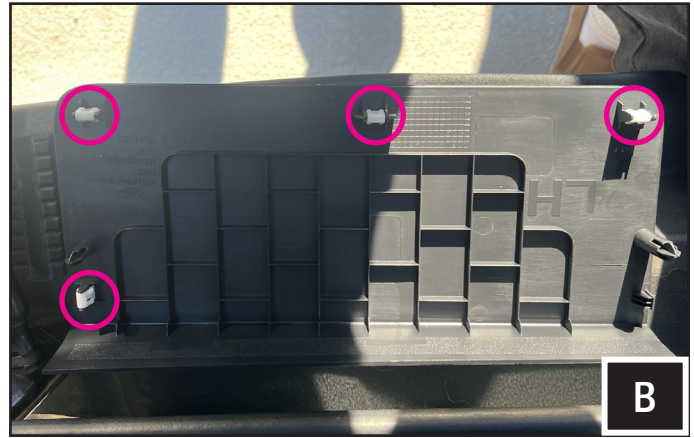

B. The plastic panel is held in place by (4) clips.



C. Install the body bracket to the factory weld nuts using the (2) M8x1.25x20 button head screws and washers included in kit. The Bronco sub kit includes a body bracket for hard top and soft top models. See C1 & C2 for bracket differentiation.

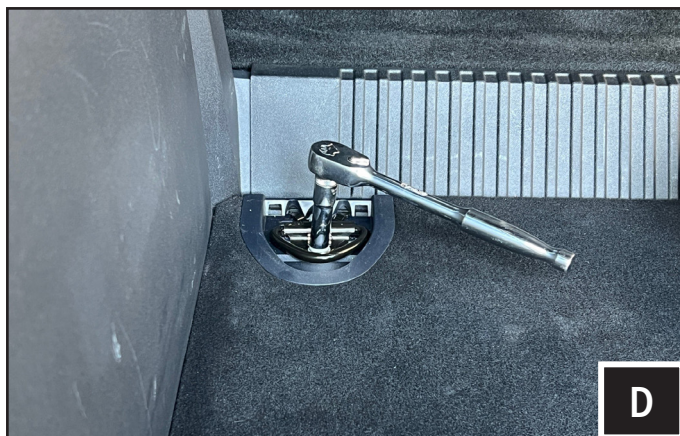
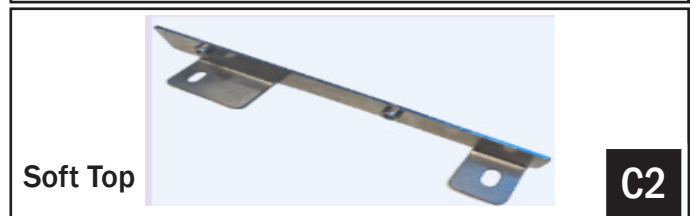

D. Remove the factory driver side tie down anchor using a 12mm socket wrench.



E. Line up the spacer (B-MB3143) to the factory threads.



## BRONCO SUBWOOFER ENCLOSURE INSTALLATION



F. Mount the Bronco sub enclosure upright and line up the upper bracket screw holes to the body bracket pem nuts. Use (2) M8x1.25x20 button head screws and washers included in kit

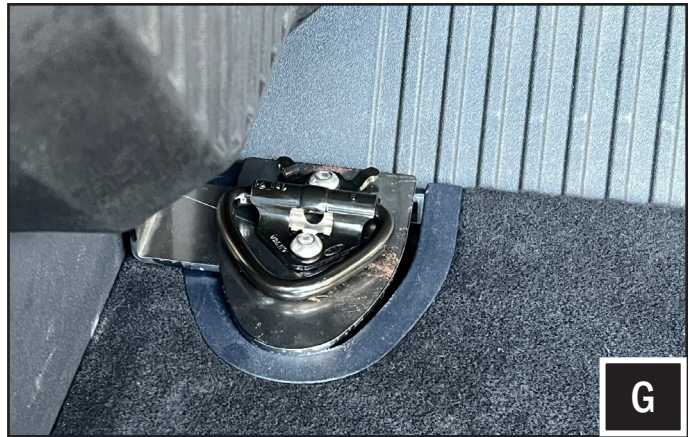

G. Line up the lower housing bracket and factory tie down anchor above the spacer. Use (2) M8x1.25x40 button head bolts and washers to firmly secure the Bronco subwoofer enclosure.



G. Line up the lower housing bracket and factory tie down anchor above the spacer. Use (2) M8x1.25x40 button head bolts and washers to firmly secure the Bronco subwoofer enclosure.



H. Run the subwoofer audio wiring (not included) from the subwoofer to the amplifier location.



Completed installation of the Bronco Subwoofer Enclosure.



# BRONCO SUBWOOFER WIRING DIAGRAM

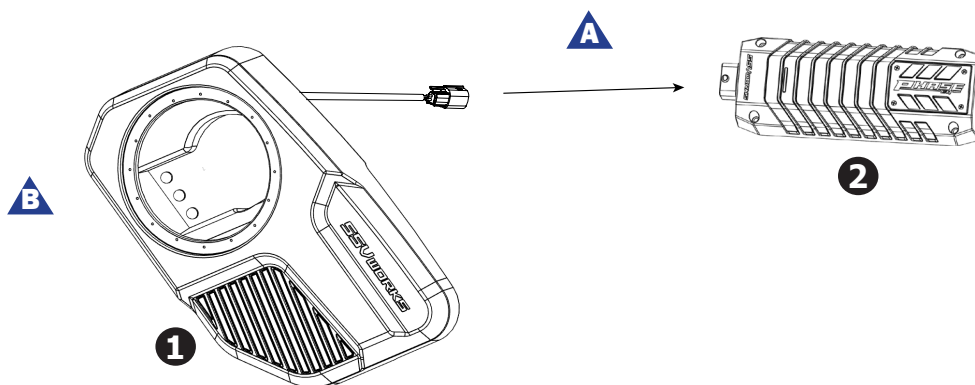

	Description	Part #
1	Bronco Subwoofer Enclosure	
2	Amplifier	

Detail	Description
A	Connect Subwoofer to Amplifier

**THANK YOU!**

We are committed to your satisfaction and we know you will enjoy our products. If you have questions or need any assistance, please let us know.

[SSVWORKS.COM](https://SSVWORKS.COM)  
 1-818-991-1778 EXT 2  
[SUPPORT@SSVWORKS.COM](mailto:SUPPORT@SSVWORKS.COM)

Returns must be made within 30 days of purchase date. Claims for missing items or items damaged in transit must be received within five business days of receipt of merchandise. All returns must be in original packaging and in re-sellable condition. Shipping fees are not refundable.