



## DF-US10U

2018-Up CanAm Defender  
Underseat Subwoofer Enclosure  
10" - Unloaded

### WARRANTY INFORMATION:

All SSV Works enclosures are covered by a limited lifetime warranty against defects in material or workmanship. All SSV Works Electronics are covered by a limited 1 year warranty against defects in material or workmanship. All SSV Works Speakers are covered by a limited 1 year warranty against defects in material or workmanship. Labor for replacement of defective components is not covered. Contact SSV Works for further warranty information.



Please read and understand these instructions completely before installation to avoid possible injury, or damage to the accessory or vehicle.



4 DOOR



2 DOOR



# UNDER REAR SEAT SUB WOOFER ENCLOSURE PARTS LIST

## PARTS LIST IMAGES



DF-US10U Enclosure



Bracket Pack (B-MBP3315)

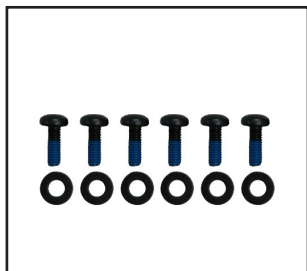

M6x1 x 16, Torx Pan Head  
Screws and Washers, 6 pack  
[B-HP1317]

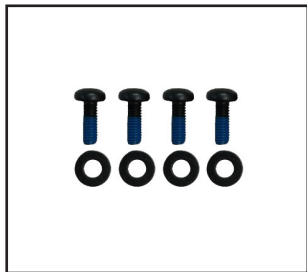

M6x1 x 16, Torx Pan Head  
Screws and Washers, 4 pack  
[B-HP1330]



M6x1 x 60mm Screw  
[B-S3366]  
(for 2 Door Models)



Plastic Thread Forming Screw  
[B-S3367]



EPDM Spacer [B-W3324]  
(for 2 Door Models)



M6 Extruded U-Nut [B-N1271]  
(x2)



28mm Vibration Pads  
[B-G2771] (x6)

# UNDERSEAT SUBWOOFER ENCLOSURE ASSEMBLY

## TOOLS NEEDED FOR INSTALLATION

- T30 Torx Driver

- Phillips Screw Driver

### INSTALLATION NOTE:

**The SSV Works DF-US10 Defender Subwoofer Enclosure can be mounted under the driver seat on 2 door models and under the driver side front and rear seats on 4 door models.**

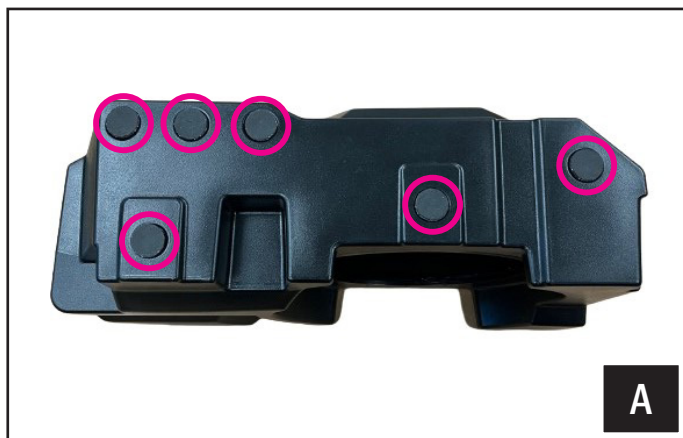

A. Stick the 6 vibration pads to the bottom side of the enclosure.

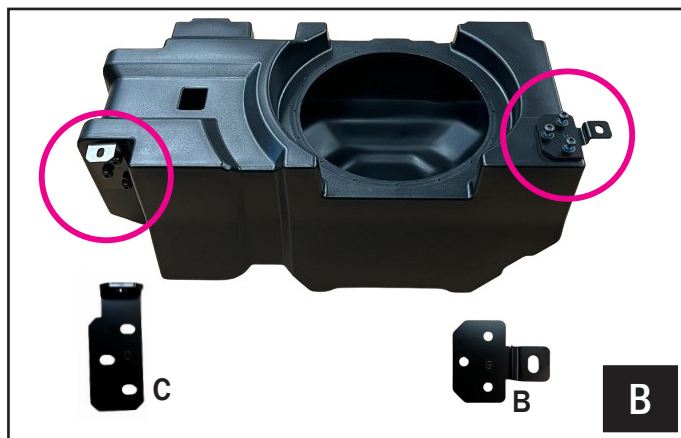

B. Install brackets B and C using the M6x1 x 16 Pan Head screws (6) included in the kit. *Do not completely tighten bracket C yet.*



C. Install the subwoofer using the #7x1.25" [B-S1179] screws included in the kit.



# UNDERSEAT SUBWOOFER ENCLOSURE INSTALLATION (4 Door Models)

## TOOLS NEEDED FOR INSTALLATION

- T30 Torx Driver

- Philips Screw Driver

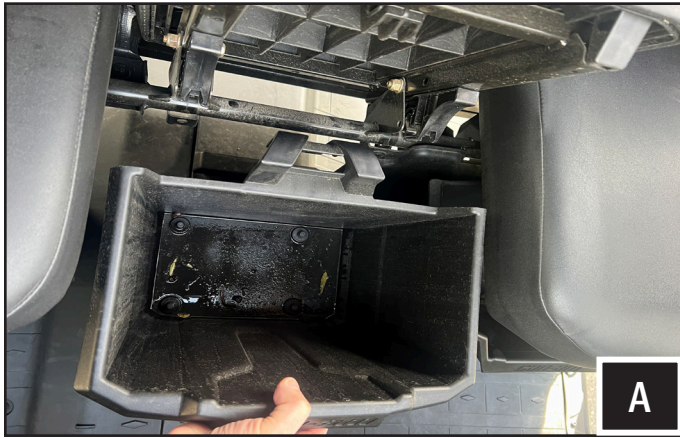

A. Lift middle seat and remove underseat storage bin.



B. Remove the driver side underseat storage bin by removing the 2 screws fastened to the floor.

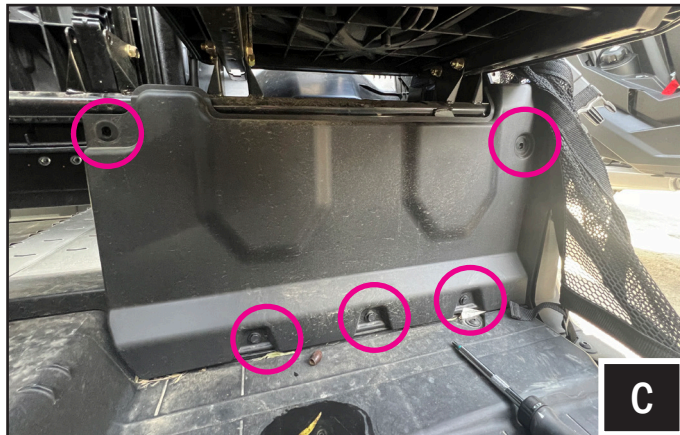

C. Remove the (3) panel clips and (2) screws holding the underseat panel.



D. Remove the T-30 Torx floor screw.



E. Mount bracket A on the floor using the factory screw removed on step D.



F. Fasten the front end of bracket A using the thread forming screw (B-S3367) included in the kit.



## UNDERSEAT SUBWOOFER ENCLOSURE INSTALLATION (4 Door Models)



G. Place the Defender sub enclosure under the seat and run the cable towards the amplifier location.

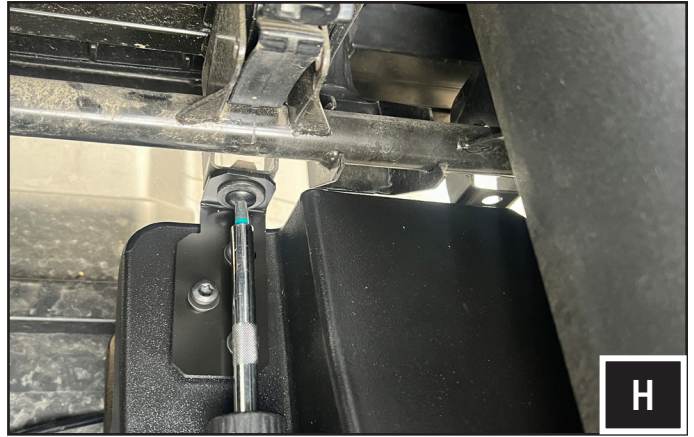

H. Use the factory screw to fasten bracket C to the U-Nut. Do not completely tighten yet.



I. Use the factory screw to fasten bracket B to the other U-Nut on the right side of the vehicle. Do not completely tighten yet.



J. Use (2) of the supplied screws [B-HPM616-4] to fasten bracket A to the Defender sub enclosure. Do not completely tighten yet.



K. Once all the screws are lined up, tighten all 4 screws to secure the Defender sub enclosure to the vehicle.



L. Hook back the middle seat storage bin. This completes the installation of the Defender Subwoofer Enclosure.



## UNDERSEAT SUBWOOFER ENCLOSURE INSTALLATION (4 Door Models)

*Note that the DF-US10 Defender subwoofer enclosure can also be installed under the driver side rear seat on 4 door models. Follow the installation steps outlined for the 2 door models.*



## UNDERSEAT SUBWOOFER ENCLOSURE INSTALLATION (2 Door Models)

### TOOLS NEEDED FOR INSTALLATION

- T30 Torx Driver

- Philips Screw Driver



A. Lift driver seat. Note that the vehicle in this installation did not have an underseat storage bin.

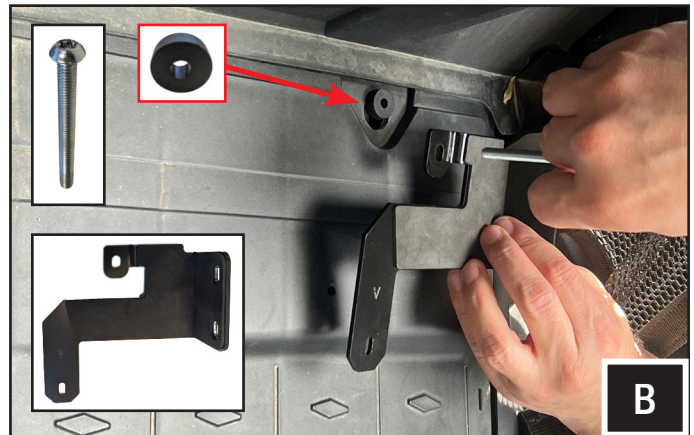

B. Fasten bracket A to the floor using the M6x60mm (B-S3366) screw and rubber spacer (B-W3324) included in the kit.

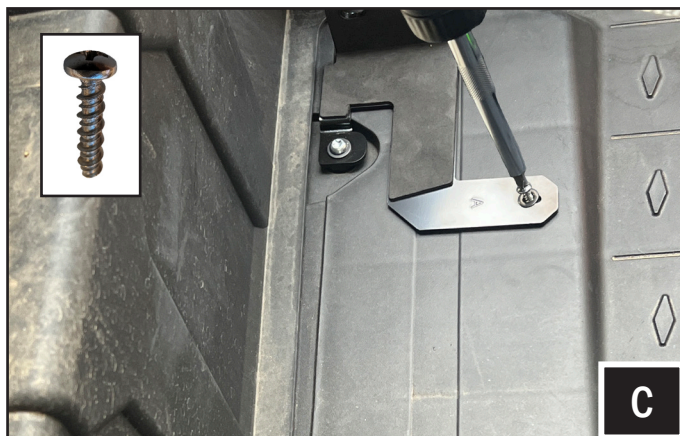

C. Fasten the front end of bracket A using the thread forming screw (B-S3367) included in the kit.

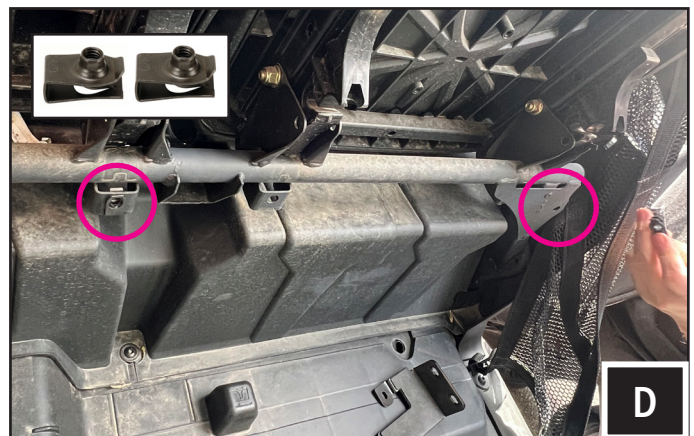

D. Slide the U-Nuts, included in the kit, to the factory mounting holes. Follow steps G to K on page 5 to complete the installation.



# UNDERSEAT SUBWOOFER WIRING DIAGRAM

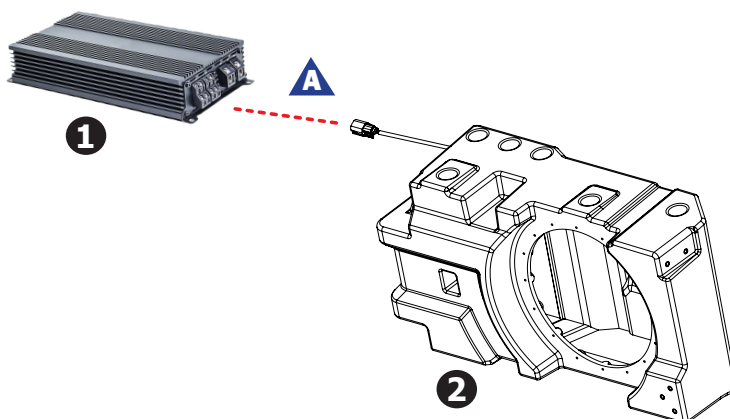

	Description	Part #
1	Amplifier (not included)	
2	Defender Underseat Subwoofer Enclosure	DF-US10U

Detail	Description
A	Connect DF-US10U to the amplifier

**THANK YOU!**

We are committed to your satisfaction and we know you will enjoy our products. If you have questions or need any assistance, please let us know.

 [SSVWORKS.COM](https://SSVWORKS.COM)  
 1-818-991-1778 EXT 2  
 [SUPPORT@SSVWORKS.COM](mailto:SUPPORT@SSVWORKS.COM)

Returns must be made within 30 days of purchase date. Claims for missing items or items damaged in transit must be received within five business days of receipt of merchandise. All returns must be in original packaging and in re-sellable condition. Shipping fees are not refundable.