



SSV WORKS, 201 N. Rice Ave Unit A, Oxnard, CA 93030  
www.SSVworks.com | Phone: 818-991-1778 | Fax: 866-293-6751

# RG4-1KRC

Polaris Ranger with Ride Command  
Underseat 10" Subwoofer

## WARRANTY INFORMATION:

All SSV Works enclosures are covered by a limited lifetime warranty against defects in material or workmanship. All SSV Works Electronics are covered by a limited 1 year warranty against defects in material or workmanship. All Kicker Speakers are covered by a limited 1 year warranty against defects in material or workmanship. All Kicker Amplifiers are covered by a limited 2 year warranty against defects in material or workmanship. Labor for replacement of defective components is not covered. Contact SSV Works for further warranty information.



Please read and understand these instructions completely before installation to avoid possible injury, or damage to the accessory or vehicle.

## TOOLS NEEDED FOR INSTALLATION

- T-40/30/25 Torx Driver    - Drill    - 3/32" Bit    - 9/16" Bit    - 13/64" Bit    - Uni-Bit  
- Phillips Screwdriver    - 4mm Allen Key    - Panel Removal Tool

## PARTS LIST IMAGES



1. Amp Power Wire x1



2. Fuse Holder with 40A Fuse



3. Battery Terminal Cable



4. Mounting Plate with Amp



5. Zip Ties



6. RG4-US10 Enclosure

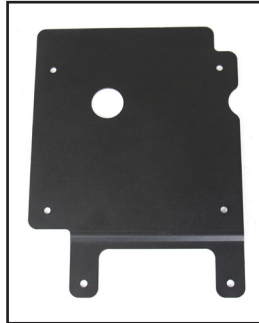

7. Enclosure Bracket A

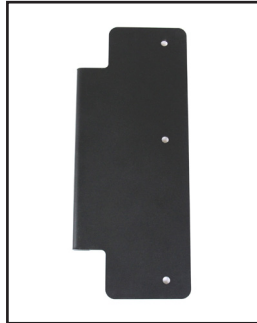

8. Enclosure Bracket B



9. M6 Flathead 4mm Hex Screws x4



10. M6 Allen Torx Screws x2

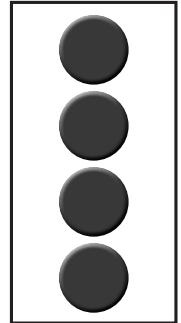

11. Foam Circles x4



A. Remove hood by turning locking pins and lifting up.

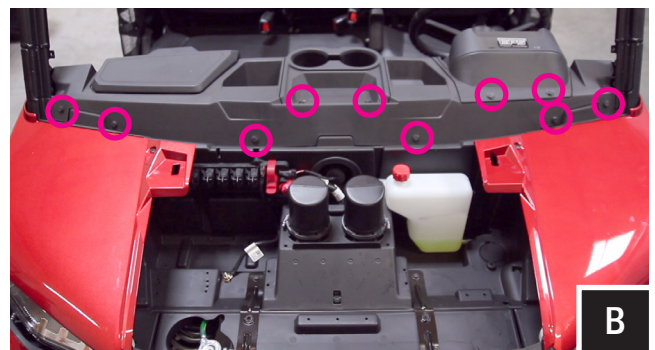

B. Use a panel tool to extract push pins circled in pink.



C. With push pins extracted, lift to remove the cup holder.

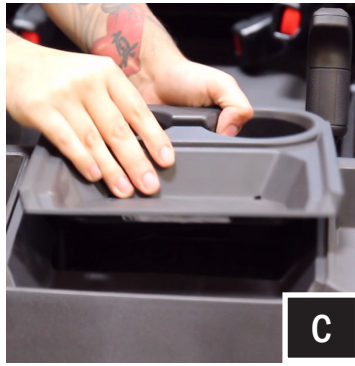

C



D. Lift and disconnect gauge cluster for removal.

D

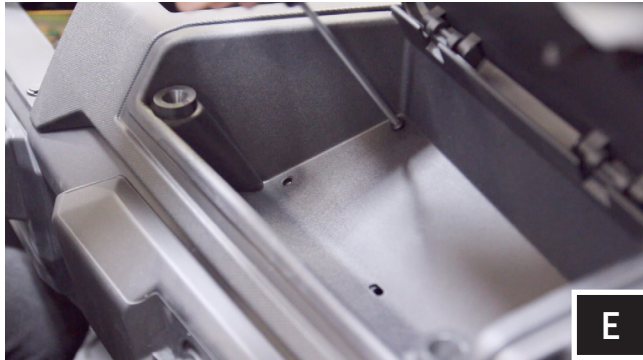

E. Unscrew (4) torx screws located in upper glove box and remove box.

E



F. Extract push pins that are now exposed from removing the upper glove box.

F



G. Extract push pins exposed from cup holder removal.

G

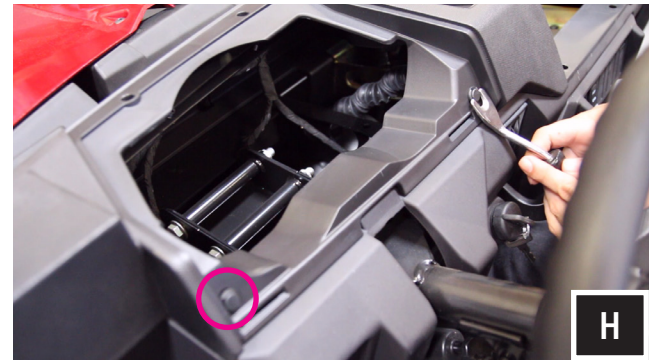

H. Extract push pins exposed from gauge cluster removal.

H



I. Extract push pins located above driver and passenger side cup holders.

I



J. Lift to remove the dash.

J



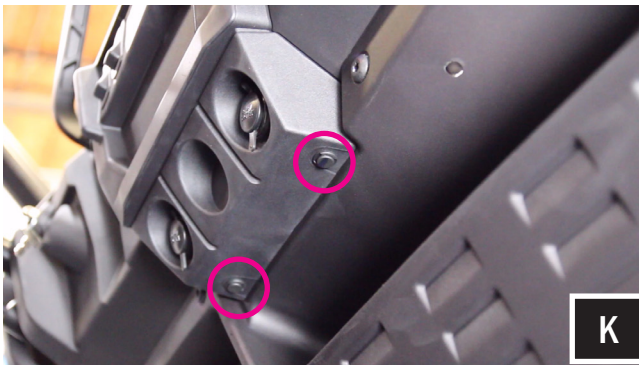

K. Extract push pins located beneath 12v sockets.



L. Remove front dash panel and disconnect the 12v socket harness.

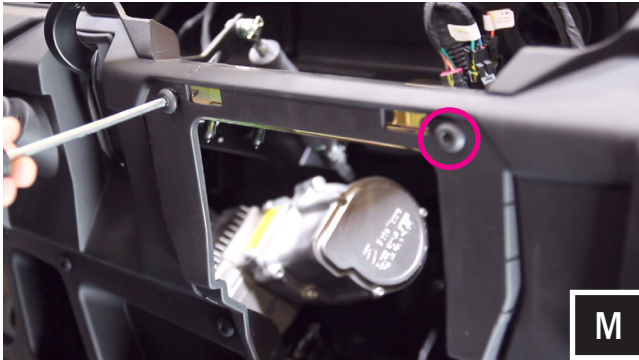

M. Unscrew (2) torx screws that were behind the front dash panel.

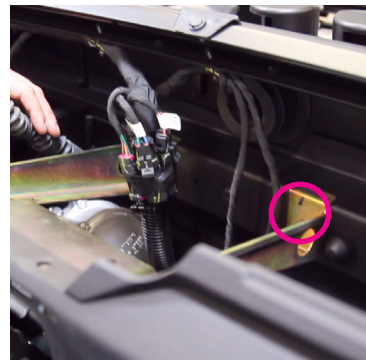

N. Unscrew the two (2) torx screws connecting the dash bracket at the rear of the dash cavity. Remove the under dash bracket.  
NOTE: IT WILL NOT BE RE-INSTALLED.

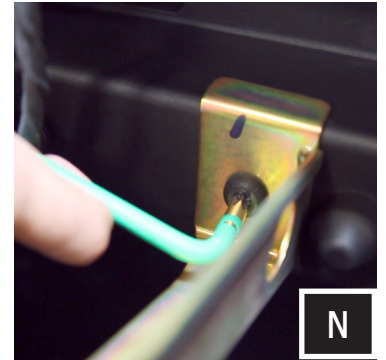

## MRB3/AMP MOUNTING PLATE AND DASH CONTROLLER INSTALLATION



O. Move the factory wiring to the rear of the dash cavity. Place the mounting plate in the former location of the factory bracket.

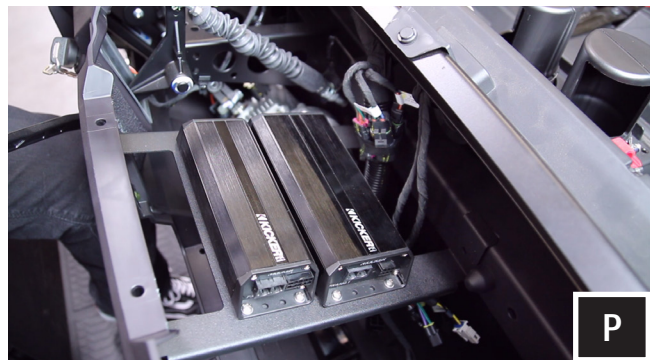

P. With the mounting plate set in place, check for any pinched wiring.

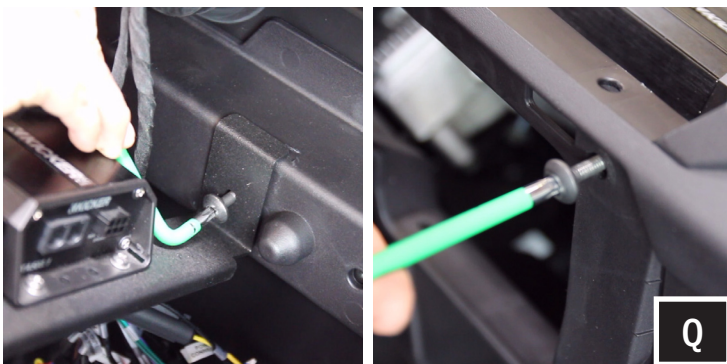

Q. Fasten down the plate with the factory hardware.

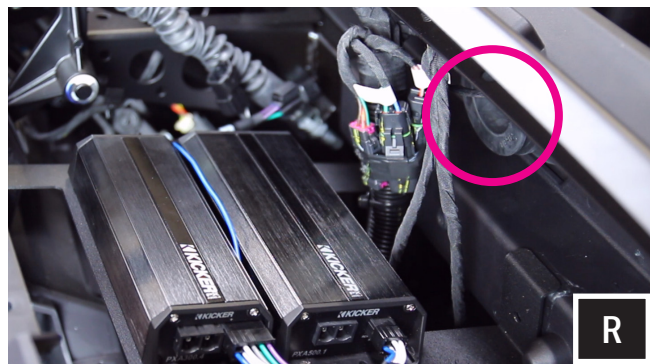

R. Route amp power/ground and H1151 cables from the exterior of the vehicle through the firewall grommet into the dash cavity. (grommet circled in pink)



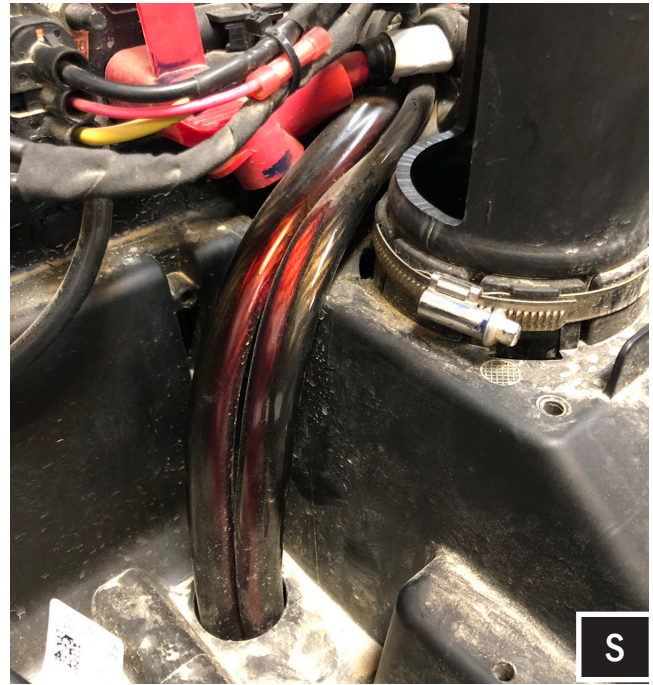

S

S. With the cables now through the firewall, route cables down the front of the machine to be pulled through into the cabin of the machine.  
NOTE: A 1" hole may need to be drilled to run the cables down the front of the chassis.



T

T. Flip up passenger seat and remove center tray to access battery. Disconnect the negative battery cable from the battery.



U

U. Using a panel removal tool, extract the (8) push pins to remove the center driveline center column cover.



V

V. Feed power/ground and H1151 harness down towards the center console until you get the wires to the inside of the vehicle.



W

W. Follow the air ducts and factory wiring and feed cables towards the battery compartment. (use provided zip ties to secure cables to factory wiring, away from the drive shaft).

**NOTE: To avoid subwoofer damage, do not face the subwoofer down or rest the enclosure on the subwoofer when installing bracket to the bottom of the enclosure.**



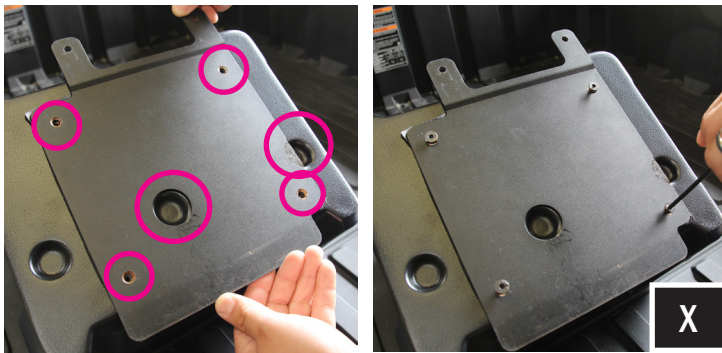

**X.** Align bracket A's holes with the dimples/recess' circled in pink on the bottom of the enclosure. Using four (4) flathead 4mm screws, mount the A bracket to the bottom of the enclosure. After the bracket is secure, cover the screw heads with the (4) foam circles.



**Y.** Located on the floorboard to the right of the battery compartment, remove the (3) T40 torx screws circled in pink.



**Z.** Place SSV bracket B over the factory screw holes and refasten down with the (3) factory T40 torx screws removed in the previous step.

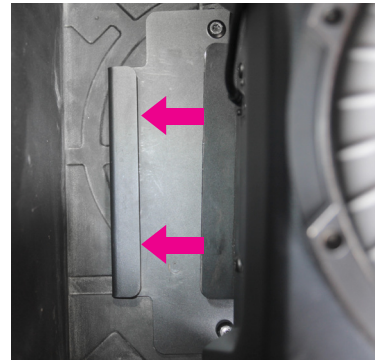

**A1.** With the bracket secured to the floorboard, place the enclosure in front of the floorboard bracket. To allow proper engagement, tilt the enclosure back slightly and slide its bottom bracket into the floorboard bracket catch.



**B1.** With the brackets seated into one another, use the front mounting tabs as a template to mark with a scribe or punch the needed placement to drill pilot holes.

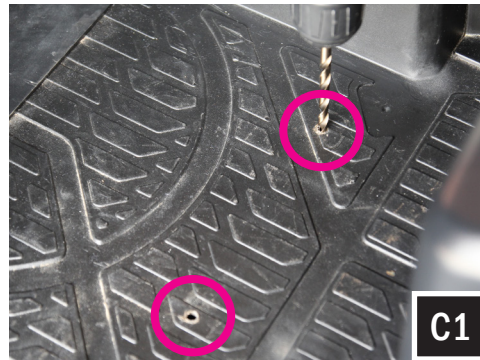

**C1.** Once marked, remove the enclosure. Using a 13/64" drill bit, drill pilot holes at your marked points. Be sure to penetrate through the chassis lying beneath the floorboard.



**D1.** Re-install the sub-enclosure. Secure the front mounting tabs with the kit provide T30 torx self-tapping screws.



**E1.** Connect sub to harness B-H1151 from the battery compartment.



**F1.** Connect the dash end of the B-H1151 harness to the amp.



# CONNECTING POWER & GROUND CABLE TO BATTERY

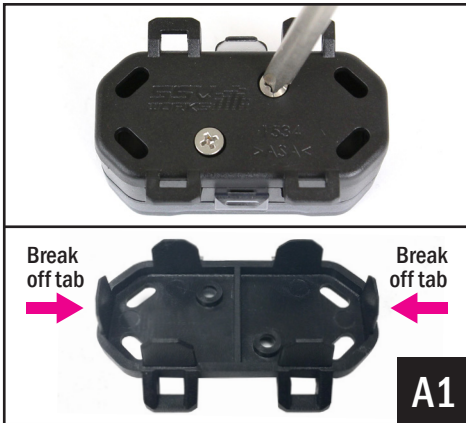

A1. Remove the bottom cover of the fuse holder by extracting the 2 screws. Break off the right and left side tabs on the bottom cover.



A2. Extract both fuse holder screws.

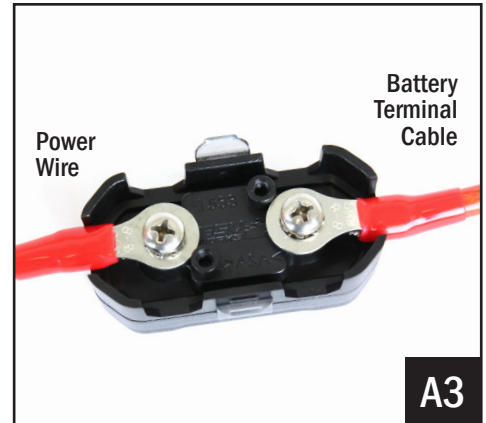

A3. Attach both the Power Wire and Battery Terminal Cable to the fuse holder. Reattach the bottom cover.



B. Unscrew the factory nut on the negative battery terminal. Install the 2 ground cables to the screw on the ground battery terminal. Re-install the factory nut.



C. Unscrew the factory nut on the positive battery terminal. Install the 2 power cables to the screw on the positive battery terminal. Re-install the factory nut.



D. Remove the top of the fuse holder and extract the 2 screws. Insert the 40A fuse, screw the 2 screws back in and reattach the fuse holder top.



E. Zip tie all of the electrical cabling (factory and audio) along the center column away from the drive shaft.

**THIS CONCLUDES THE INSTALLATION PROCESS. REPLACE THE FACTORY PANELS AND SEATS. QUESTIONS? PLEASE CONTACT SSV WORKS AT 818-991-1778 OR EMAIL [SUPPORT@SSVWORKS.COM](mailto:SUPPORT@SSVWORKS.COM)**