



SSV WORKS, 201 N. Rice Ave Unit A, Oxnard, CA 93030  
www.SSVworks.com | Phone: 818-991-1778 | Fax: 866-293-6751

# SW-E12

12 OUTPUT

ELECTRONIC ACCESSORIES

SMART SWITCHER

## WARRANTY INFORMATION:

All SWITCH Works Electronics are covered by a limited 1 year warranty against defects in material or workmanship. Contact SSV Works for further warranty information.



Please read and understand these instructions completely before installation to avoid possible injury, or damage to the accessory or vehicle.



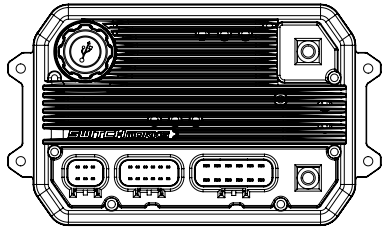

**SWITCH Works 12 Circuit  
Brain Module**

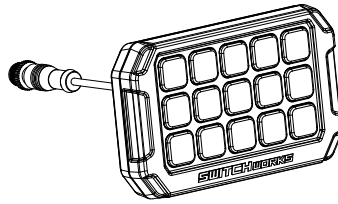

**LCD Touch Button  
Controller**

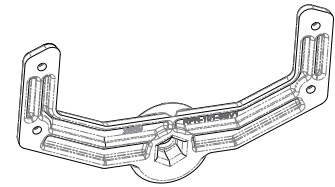

**Controller Mounting  
Bracket**

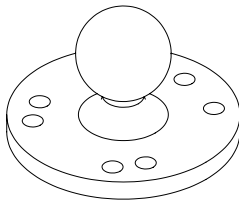

**RAM Mount 1"  
Ball Base**

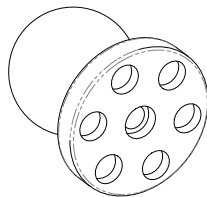

**RAM Mount  
Ball Adapter**

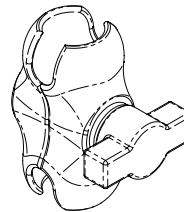

**RAM Mount Double  
Socket Arm**

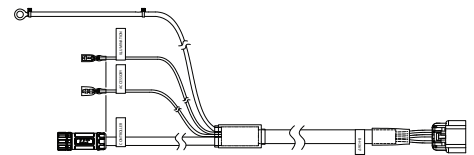

**Brain Module Power  
Harness (B-H3617)**

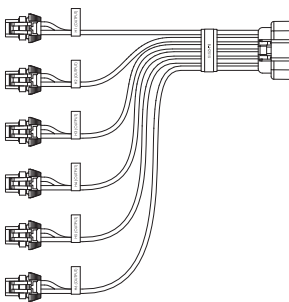

**High Current  
Output Harness**

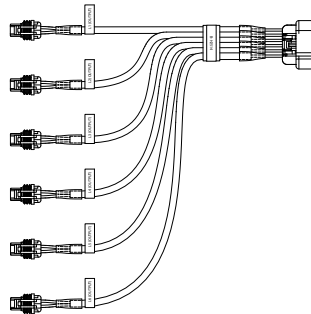

**Low Current  
Output Harness**

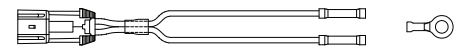

**High Current Pigtail  
& Ring Terminal (x6)**

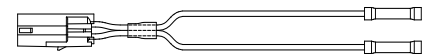

**Low Current  
Pigtail (x6)**

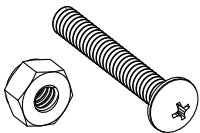

**1 3/8" Pan Head  
Screw & Locknut**



**Flat Head, Thread  
Cut Screw (x4)**

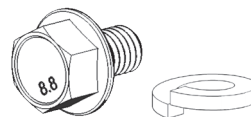

**M8 Flange Bolt &  
SS Split Washer (x2)**

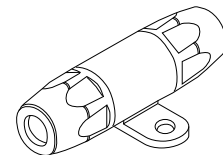

**Fuse holder with 100A  
mini ANL fuse**

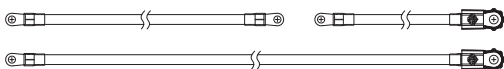

**#4 AWG Power/Ground Cable Set  
3 ft or 10 ft**

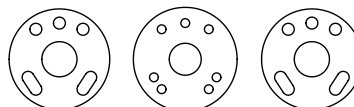

**Faceplate & Gasket Pack**

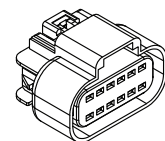

**Dummy Plug**

**\*\*Optional accessories such as a 2nd LCD Controller, "Y" Cable Splitters, and Extension Cables for controller are available. Please contact Customer Service at 818-991-1778 for more information.**



To make programming the SWITCH Works module easier, we recommend mapping your accessories with the cheat sheet below. Determine which accessory you're connecting to each individual output; which button you want to control the output (button used is not determined by output location); and, which function you want to achieve for the output (ON/OFF, Strobe, etc.).

HIGH CURRENT OUTPUT	DEVICE	BUTTON #	OUTPUT FUNCTION
H1			
H2			
H3			
H4			
H5			
H6			
LOW CURRENT OUTPUTS	DEVICE	BUTTON	OUTPUT FUNCTION
L1			
L2			
L3			
L4			
L5			
L6			

**Note: The Alpha12 Electronic Smart Switcher has an option to combine 2 High Level or 2 Low Level outputs to double the current output. Example: H1 + H2 = 50 amps, L1 + L2 = 10 amps. Limit to only 1 combined output for low or high current.**

**Skip step 1 and 2 if using vehicle specific kit.**

**1. Attach the RAM Mount ball adapter to the Controller Mounting Bracket and secure with the 1 3/8" pan head screw and locknut.**

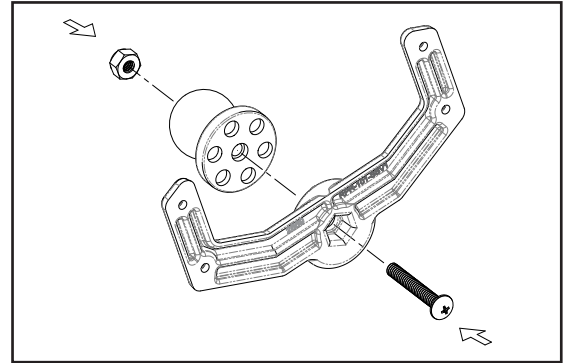

**2. Attach the Controller Mounting Bracket to the LCD Touch Button Controller using the 4 flat head, thread cut screws provided.**

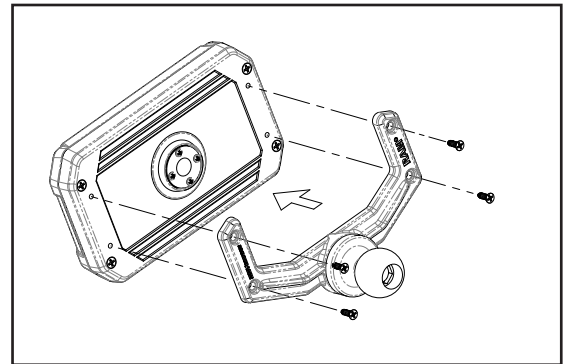

**3. Attach the rubber gaskets to the RAM Mount base and metal faceplate included in the kit. Hold the RAM mount base to the desired mounting location and drill 3 holes. Insert the provided screws into the RAM mount base and thread through the supplied metal faceplate.**

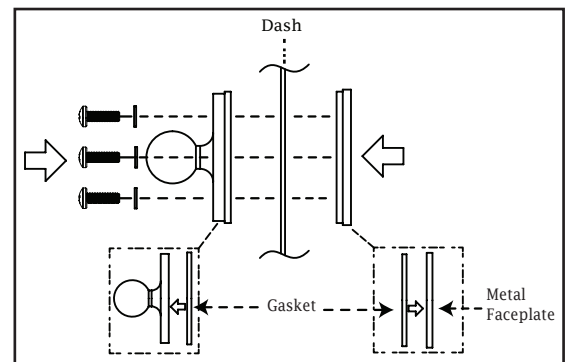



**4. Insert the LCD Touch Screen Controller with mounted RAM mount ball adapter and the RAM mount base to the RAM mount Double Socket Arm and tighten the T-knob.**

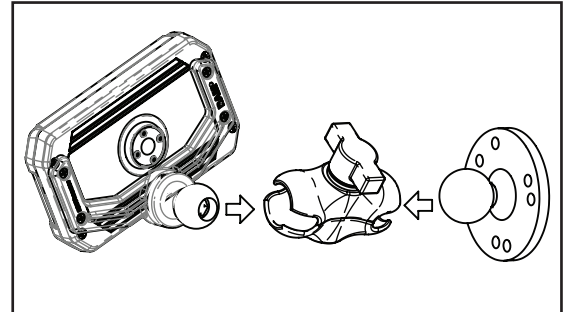

**5. Cut the 4AWG power and ground wires to the required length to reach the battery. Install the fuse holder provided in the kit to the 4 AWG power wire. Wait to connect the power and ground wires to the battery until all other installations steps are completed.**

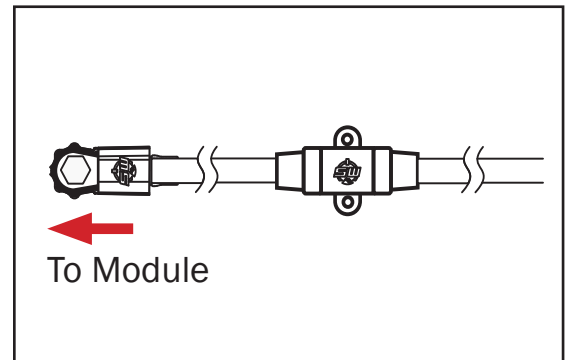

**6. Connect the 4AWG power, ground wires and the B-H3617 (relay harness) to the brain module using the M8 flange bolt and split washer.**

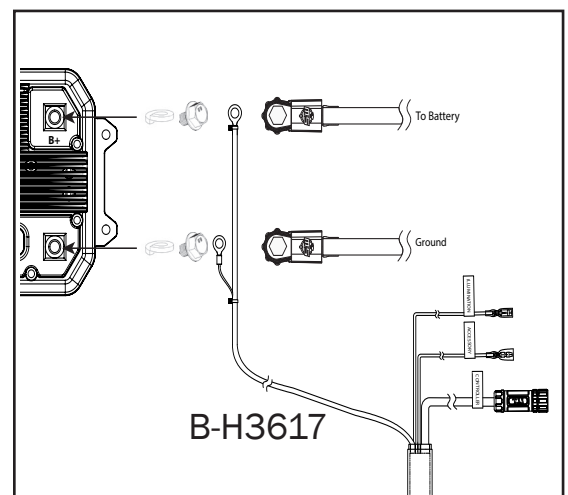

**7. Plug the B-H3617 harness to the SWITCH Works Brain.**

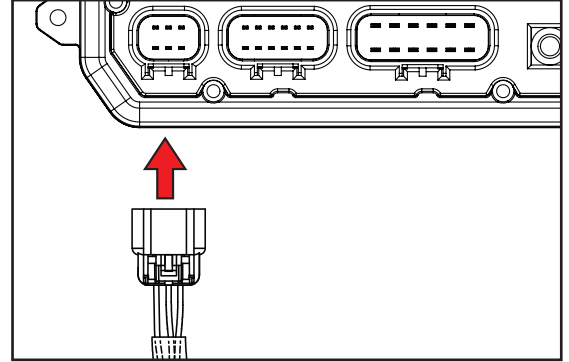

**8. Plug the LCD Touch Button Controller to the B-H3617 harness.**

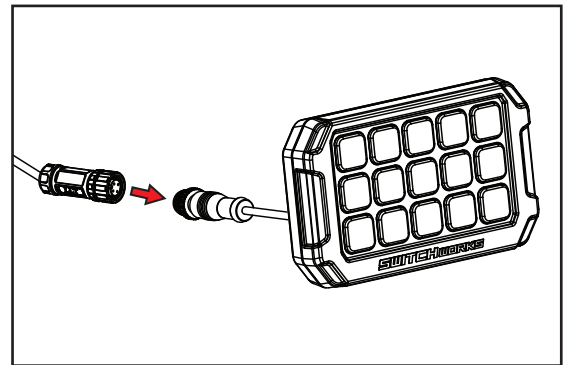

**9. Tap ACC wire to a switched 12 volt power source. Tap Illumination wire to headlight power for dimming function or tap to one of the Low Current Outputs for a manual dimming function.**

**NOTE: LCD Touch Button Controller MUST be connected before applying ACC power to the switcher.**

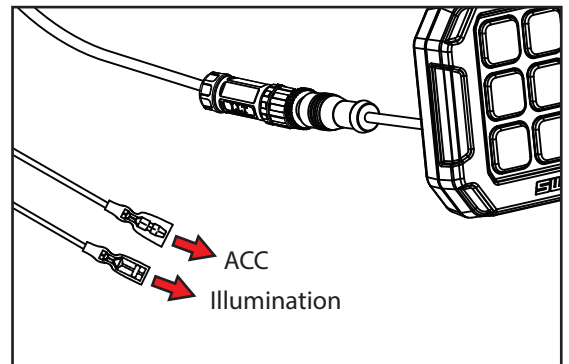

**10. Splice your devices to the to the high current and low current harnesses accordingly. Then plug in the harnesses to the module.**

**High Current: 25 amps each x6**

**Low Current: 5 amps each x6**

**NOTE: If outputs L1-L6 are not going to be used plug in the dummy connector included in the accessory box.**

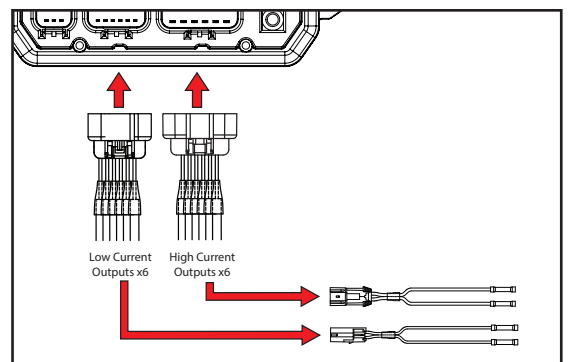

**\*When all other Installation steps are completed, connect power and ground wires to the Battery.**

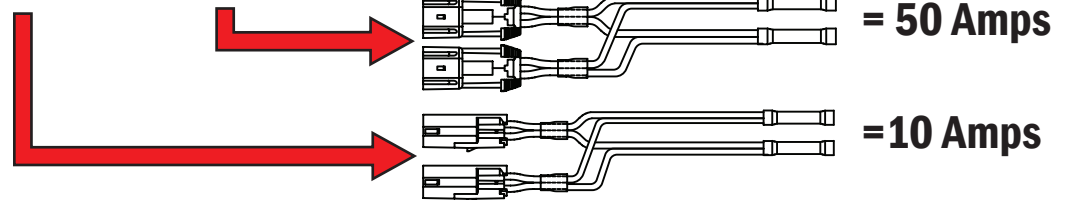
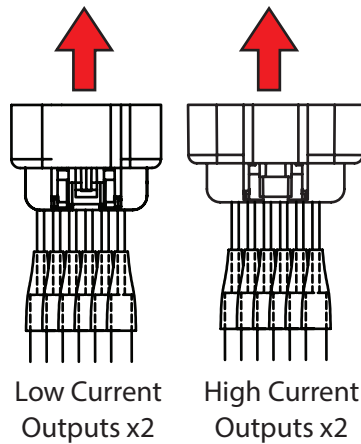
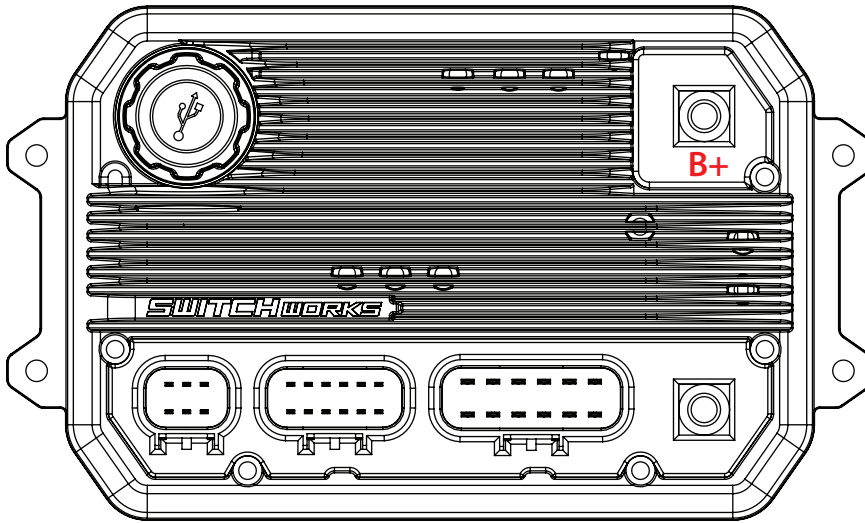

**11. The ALPHA12 Electronic Smart Switcher has an option to combine 2 High Level or 2 Low Level outputs to double the current output. Use 2 of the High or Low Level pigtails and combine the wires to double the current output. Limit to only 1 combined outputs for High or Low Current.**



## SWITCH Works LCD Touch Controller Button Layout

The SWITCH Works LCD Touch Controller features 60 user programmable buttons and 64 icons to choose from to control electrical devices. Unit is defaulted to 1 page of 12 buttons from the factory. Additional button pages can be turned on in GENERAL menu. See section on GENERAL SETTINGS. Press MENU button to enter settings.

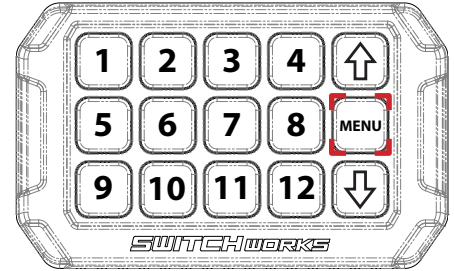

**Note:** Any prior settings will default back to factory settings if the system firmware is updated. Take note of the prior settings before proceeding with a firmware update.

## OUTPUT SETTINGS

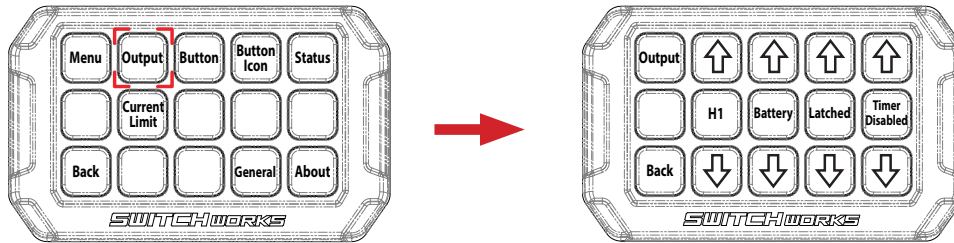

Program the function of each added accessory/output by selecting OUTPUT. Select number (H1 to H6 and L1 to L6) and set the power source and function for each output.

**NOTE:** Buttons are pre-programmed out-of-the-box. You must turn off pre-programmed outputs before customizing your accessories.

Output	Description	Devices
H1	High Current Output 1	<b>Light Bars, Sound System, Horn, etc.</b> <b>(25 amps max each output)</b>  <b>Combine 2 Outputs (max)</b> <b>Output 1 + Output 6 = 50 amps</b> <b>(We recommend combining the outputs that are furthest apart for heat dissipation)</b>
H2	High Current Output 2	
H3	High Current Output 3	
H4	High Current Output 4	
H5	High Current Output 5	
H6	High Current Output 6	
L1	Low Current Output 1	<b>Dome Light, Turn Signals, Rock Lights, Low Current LEDs, etc.</b> <b>(5 amps max each output)</b>  <b>Combine 2 Outputs (max)</b> <b>Output 1 + Output 6 = 10 amps</b> <b>(We recommend combining the outputs that are furthest apart for heat dissipation)</b>
L2	Low Current Output 2	
L3	Low Current Output 3	
L4	Low Current Output 4	
L5	Low Current Output 5	
L6	Low Current Output 6	

## OUTPUT SETTINGS

Select OUTPUT number (H1 to H6 and L1 to L6) and set the power source and function for each output.

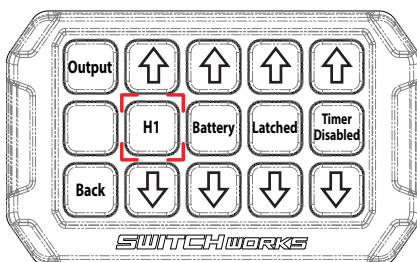

Output	Power Source	Description
High Current H1 to H6 (25 amps each)	Battery	Output stays on with ignition (ACC) off (press any of the top buttons to wake up the controller after it has gone to sleep mode)
	Ignition	Output turns on with ignition (ACC) on
Low Current L1 to L6 (5 amps each)	Ign. Memory	Saves last device status (defaults to OFF)
	<b>Function</b>	
	Latched	Press ON, Press OFF
	Latch Flash	Press to FLASH, Press OFF
	Latch Strobe	Press to STROBE, Press OFF
	Hold Strobe	Press ON, Press OFF, Press & Hold to Strobe
	Dimmer	Press ON, Press OFF, Press & Hold for Dimmer Function
	Moment	Press & Hold for ON, Release for OFF
	Moment Flash	Momentary FLASH
	Moment Strobe	Momentary STROBE
	Timer Disabled	Timed Output (On for 30s, 1m to 5m) (not available in Momentary functions)

## BUTTON SETTINGS

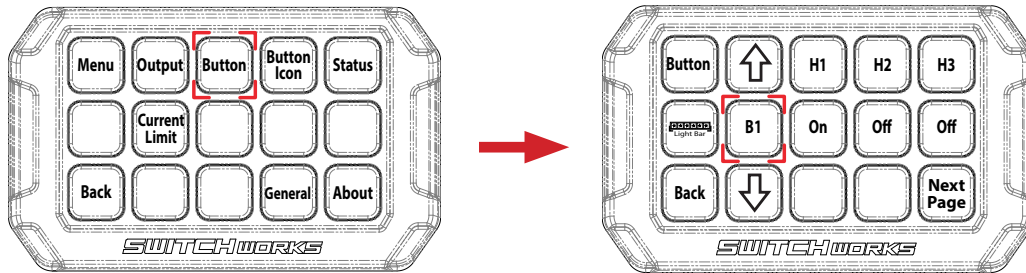

Function												
Button Number	H1	H2	H3	H4	H5	H6	L1	L2	L3	L4	L5	L6
B1	On	Off	Off	Off	Off	Off	Off	Off	Off	Off	Off	Off
B2	Off	On	Off	Off	Off	Off	Off	Off	Off	Off	Off	Off

Select button number and set the output you want each button to turn ON or OFF. Note that a button can be set to control more than one output. An example is to turn all High Current outputs (H1 to H6) On or Off using one button.

## BUTTON ICONS

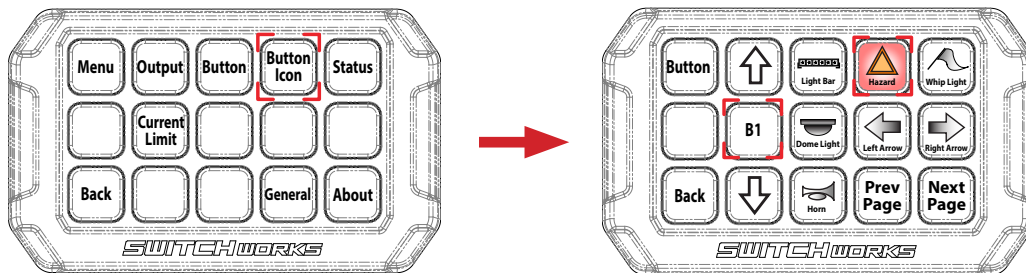

Select the icon for each button used. Icon turns colored when selected. Press the BACK button once all icons have been assigned to the buttons. Custom icons can be loaded via the SSV Works SSI Configurator App. Download the app at [ssvworks.com](http://ssvworks.com).

## STATUS - Module

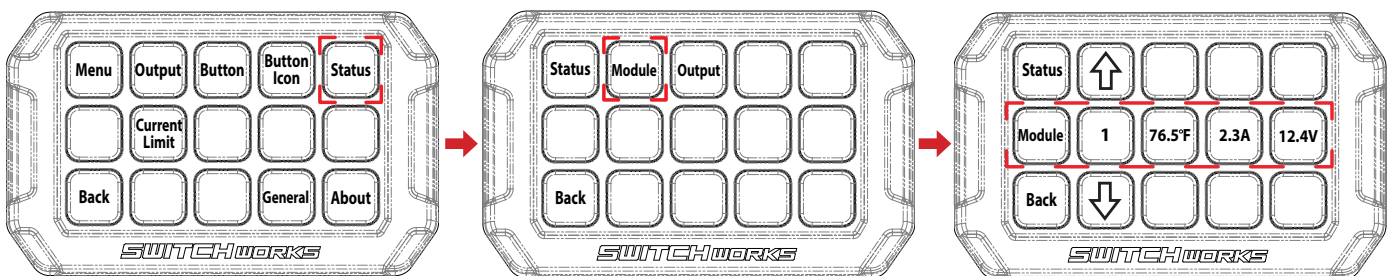

The SWITCH Works LCD Touchscreen controller is capable of controlling two brain modules. Select module 1 or 2 (If two brains are connected) to show TEMPERATURE, total CURRENT DRAW and VOLTAGE.

## STATUS - Output

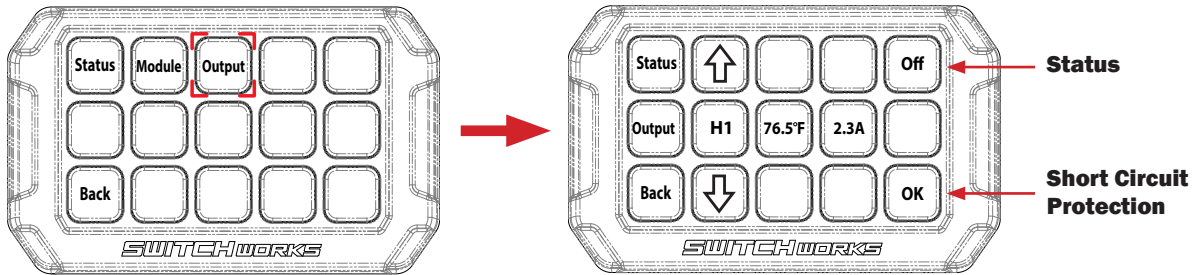

The SWITCH Works LCD Touchscreen controller can show TEMPERATURE, CURRENT DRAW, STATUS (On/Off) and SHORT CIRCUIT Protection Status of each used output.

## CURRENT LIMIT

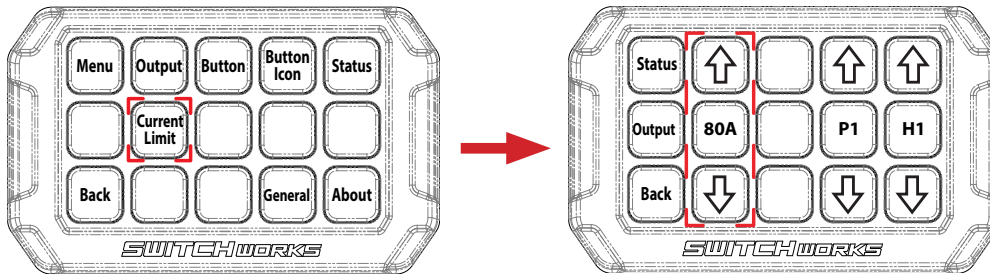

Set the maximum current output of the SWITCH Works switcher module. The module is defaulted to 80 amps. Adjust the module current output to match the total current draw of all devices connected.

**NOTE:** Adjust the current output based on the vehicle's electrical current capacity.

## PRIORITY SHUTDOWN

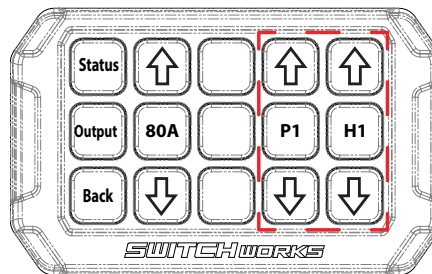

The SWITCH Works controller constantly monitors the current draw and temperature of the system. It offers a Priority Shutdown feature to prevent the system from over-current draw and over heating.

**P1 - Highest Priority - Last output to turn off**

**P12 - Least Priority - First Output to turn off**

Select which output (H1 to H6 and L1 to L6) has the Highest Priority and Least Priority.



**High Current Output 1 will be last to turn off**



**Low Current Output 1 will be first to turn off**

## GENERAL SETTINGS

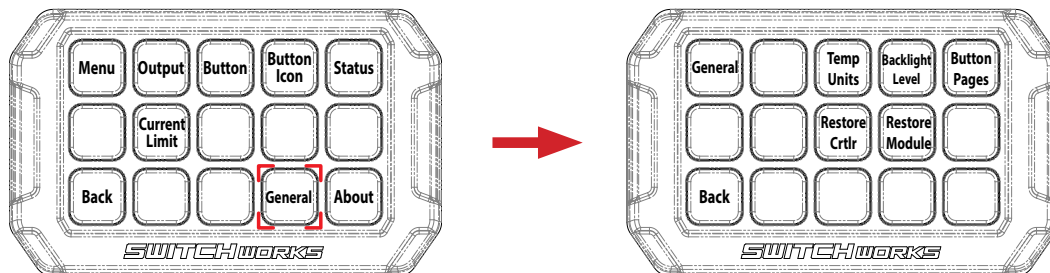

Output	Option	Description
Temp Units	°F	Fahrenheit
	°C	Celsius
Back light Level	Day (10% to 100%)	Set daytime back light level
	Night (10% to 100%)	Set nighttime back light level (Illumination wire must be connected)
Button Pages	1 to 5	Number of button pages to display
Restore Ctrlr	Apply?	Restore LCD controller to factory default
Restore Module	Apply?	Restore Module to factory default
About	Btn Pad	Version number
	SSI	Version number





SWITCH Works is a product by SSV Works. We are committed to your satisfaction and we know you will enjoy our products. If you have questions or need any assistance, please let us know.



 [SSVWORKS.COM](http://SSVWORKS.COM)

 1-818-991-1778 EXT 2

 [SUPPORT@SSVWORKS.COM](mailto:SUPPORT@SSVWORKS.COM)

Returns must be made within 30 days of purchase date. Claims for missing items or items damaged in transit must be received within five business days of receipt of merchandise. All returns must be in original packaging and in re-sellable condition. Shipping fees are not refundable.